

Gear Heirs 10-11 #1

State Well Report Part 1

County: Jones
 Permit #: _____
 Driller: John W Thompson
 Date drilling completed: 7-17-09

Mississippi Department of Environmental Quality
 Office of Land and Water Resources
 P.O. Box 10631
 Jackson, MS 39289-0631
 (601)961-5210
 (601)354-6938 (fax)

For Office Use Only:
 Aquifer: _____
 Well #: J147
 L. S. Elevation: _____
 E-log #: _____

State Law requires that this report be prepared by the driller in detail and filed with the Department within 30 days of completion of drilling of the well.

Well Owner Information	Well Location
Owner Name: <u>Bean Resources</u>	Latitude: <u>31° 35' 08"</u> Longitude: <u>89° 17' 36"</u>
Mailing Address: <u>P.O. Box 52768</u> <u>Lafayette LA 70505</u>	Method of Lat/Long (circle one): <u>Conventional Survey</u> USGS quad, Hand-held GPS, Survey-grade GPS
City: _____ State: _____ Zip Code: _____	<u>NE 1/4 SW 10</u> Sec <u>10</u> Twn <u>7N</u> Rng <u>13W</u>
Telephone No. () _____	Distance: <u>4</u> Miles Direction: <u>W</u> of Nearest Town: <u>Ellisville</u>

Well Data

Purpose of Well (circle one) Home Industrial Public Supply Irrigation Fish Culture Other: rig supply

Date well drilling started: 7-17-09 Date well drilling completed: 7-17-09

If flowing, method of flow regulation: Valve _____ Other (describe) _____

Static Water Level: 26 feet above of below (circle one) land surface Date measured: 7-17-09

Method of Measurement (circle one) steel tape electric tape air line other: _____

Hole depth: 280 Well depth: 260 Well grouted to a depth of 20 feet

Type of grout (circle one): Cement Bentonite Mix

Casing length: 260 feet Casing diameter: 4 inches Type of casing: PVC

Screen length: 20 feet Screen diameter: 4 inches Type of screen: PVC Slotted

Screen slot size: .020 inches Setting depth: From 260 feet to 280 feet

Type of completion (circle all applicable): Gravel packed Underreamed Telescoped Open hole Natural Development

Other (describe): _____

Top of lap pipe or reduction in casing: _____ feet. If telescoped or more than one screen, describe on back of page

Logs run (circle all applicable): No log run Electric Gamma Ray Density Sonic Neutron Other: _____

Name of organization running log(s): _____

I certify that the well was drilled, constructed, and completed in accordance with all applicable requirements of the Mississippi Department of Environmental Quality and/or the Mississippi Department of Health regulations and state laws.

John W Thompson 0-679
 Print Name of Water Well Contractor and License No.

John W Thompson
 Signature of Water Well Contractor

RECEIVED
 JUL 20 2009
 BY: OLWR

JT147

If well telescopes please sketch below and show depths

Ground Level

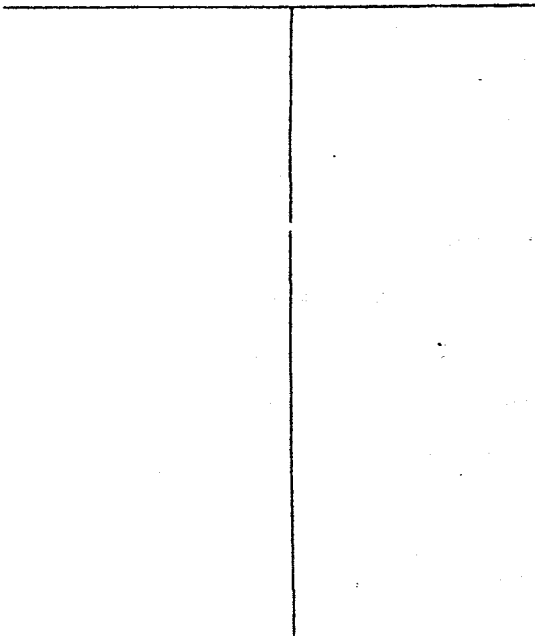

Description of Formations Encountered	From	To
clay	0	180
sand	180	270
clay	270	280

more than one screen, show location of each on sketch

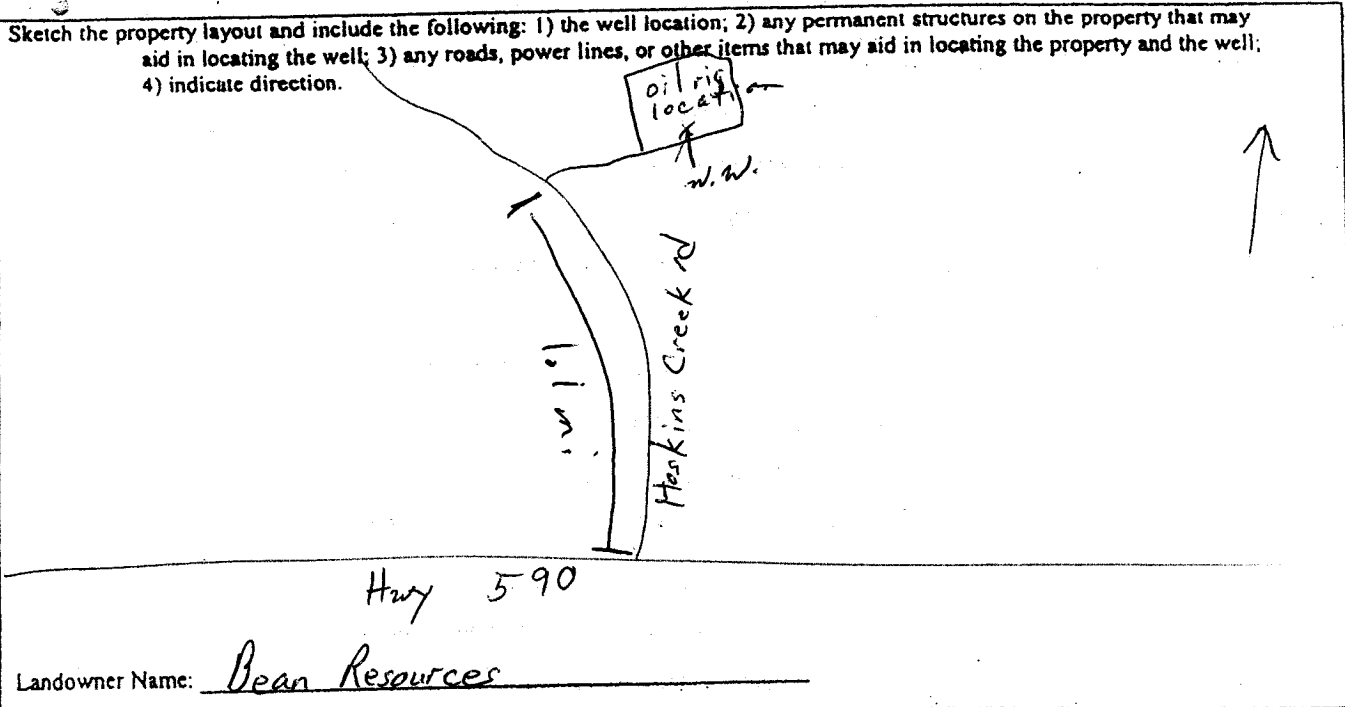

Landowner Name: Bean Resources

John W. Thompson
Signature of Water Well Contractor

STATE WELL REPORT

Part 2

Pump Installer's Completion Report
 Mississippi Department of Environmental Quality
 Office of Land and Water Resources
 P.O. Box 10631
 Jackson, MS 39289-0631
 (601)961-5210
 (601)354-6938 (fax)

For Office Use Only:

Aquifer: _____
 Well #: J1A7
 Elevation: _____

County: Jones
 Permit #: _____
 Driller: John W Thompson
 Date completed: 7-17-09
Copy information from block on Part 1

This part of the report must be completed by a licensed water well contractor or a licensed pump installer. A copy of Part 1 of the report must be attached and both parts filed with the Department at the above address within 30 days of well completion.

Well Owner Information	Well Location
Owner Name: <u>Bear Resources</u>	Latitude: <u>31° 35' 19"</u> Longitude: <u>89° 17' 29"</u>
Mailing Address: <u>P.O. Box 52768</u> <u>Lafayette LA 70505</u>	Method of Lat/Long (check one): Conventional Survey _____ USGS quad _____, Hand-held GPS _____, Survey-grade GPS _____ _____ 1/4 _____ 1/4 Sec <u>10</u> T <u>7N</u> R <u>13W</u>
City _____ State _____ Zip Code _____	Distance _____ Direction _____ Nearest Town _____ <u>4</u> Miles <u>W</u> of <u>Ellisville</u>
Telephone No. () _____	

Pump Type Circle one	Power Type Circle one
Air Lift <input type="checkbox"/> Jet <input type="checkbox"/> <u>Submersible</u>	Diesel Engine <input type="checkbox"/> Gasoline Engine <input type="checkbox"/> Natural Gas <input type="checkbox"/>
Bucket <input type="checkbox"/> Piston <input type="checkbox"/> Turbine <input type="checkbox"/>	Electric Motor <input type="checkbox"/> Hand <input type="checkbox"/> Tractor PTO <input type="checkbox"/>
Centrifugal <input type="checkbox"/> Rotary <input type="checkbox"/> Flowing Well <input type="checkbox"/>	Windmill <input type="checkbox"/> Other (specify): _____
Other (specify): _____	Horse Power Rating of Motor: <u>5</u>
Date Pump Installed: <u>7-17-09</u>	Setting Depth: <u>100</u> feet
Rated Pump Capacity: <u>85</u> Gallons Per Minute	Number of Stages: _____

Pump Test Data	Method of Measuring Water Level Circle one
Date Well Tested: <u>7-17-09</u>	Air Line <input type="checkbox"/> <u>Electric Measuring Line</u> Steel Tape <input type="checkbox"/>
Static Water Level (A): <u>26'</u> Feet Below Land Surface	Other (specify): _____
Pumping Water Level (B): <u>40'</u> Feet Below Land Surface	For flowing well, measured shut in head: _____ feet
Drawdown [(B) - (A)]: <u>14'</u> Feet Below Land Surface	Well yielded <u>100</u> GPM with a drawdown of
Test Pumping Rate: <u>100</u> Gallons Per Minute	<u>14</u> feet after <u>4</u> hours of pumping
Duration of Pump Test (minimum 4 hours): <u>4</u> hours	

I HEREBY CERTIFY that the above statements are true to the best of my knowledge.

John W Thompson 0-679 John W Thompson
 Print Name of Pump Installer and License No. (if applicable) Signature of Pump Installer

Form: OLWR-SWR-1B

RECEIVED

JUL 20 2009

BY: OLWR