

STATE WELL REPORT

318

County: Jones
 Permit #: _____
 Driller: David West
 Date drilling completed: 12-29-20

Part 1
Driller's Log
 Mississippi Department of Environmental Quality
 Office of Land and Water Resources
 P.O. Box 2309
 Jackson, MS 39225-2309
 (601)961-5555
 (601)961-5228 (fax)

For Office Use Only:

Well #: D 232
 Aquifer: _____
 E-Log #: _____

State Law requires that this report be prepared by the license holder responsible for the work and filed with the Department at the above address within 30 days of completion of drilling of the well or borehole.

Well Owner Information <small>(Landowner if borehole is not for a water well)</small>	Well or Borehole Location
Owner Name: <u>Robert Welborn</u>	Latitude: <u>31.795331</u> Longitude: <u>-89.036542</u>
Mailing Address: <u>899 Bonner rd</u>	Method of Lat/Long (check one): Conventional Survey _____
<u>Sandersville</u> MS <u>39477</u>	USGS quad _____, Hand-held GPS <input checked="" type="checkbox"/> , Survey-grade GPS _____
City State Zip Code	<u>NW</u> ¼ <u>NE</u> ¼, Sec <u>31</u> T <u>10N</u> R <u>10W</u>
Telephone No. <u>(601) 540-8068</u>	<u>3</u> Miles <u>N</u> of <u>Sandersville</u>
	(Distance) (Direction) (Nearest Town)

Well / Borehole Data

Date drilling started: 12-28-20 Date drilling completed: 12-29-20 Hole depth: 315' Hole diameter: 6 1/2"

Location of the source of any surface water used for drilling: Well water

Method of dosing and volume of Chlorine used in drilling and development: Tab's 50ppm

Logs run (check all applicable): log run Electric Gamma Ray Density Sonic Neutron Other: _____

Name of organization running log(s): _____

Purpose of borehole (check one): Water Well Geotechnical/Geological Investigation Ground Source Heat Pump
 Seismic Survey Other (describe) _____

If drilling is not related to water well construction, skip the remainder of this block

Purpose of Well (check all applicable): Home Industrial Public Supply Irrigation Fish Culture

Other (describe): _____

If a flowing well, method of flow regulation: Valve _____ Other (describe) _____

Static Water Level: 94 feet above or below land surface Date measured: 12-29-20
(check one)

Method of measurement (check one) Steel tape Electric tape Air line Other (describe): Sonar

Well depth: 315' Well grouted to a depth of: 20 feet Type of grout (check one) Neat Cement Bentonite Mix

Casing length: 290 feet Casing diameter: 4 inches Type of casing: PVC

Screen length: 25 feet Screen diameter: 4 inches Type of screen: PVC

Screen slot size: .016 inches Setting depth: From 289 feet to 312 feet

Type of completion (check all applicable) gravel packed Underreamed Open hole Natural Development

Other (describe): _____

Top of lap pipe or reduction in casing: _____ feet

If telescoped or more than one screen, describe on next page

RECEIVED
 JAN 08 2021
 BY OLWR

County: Sones
 Permit #: _____

For Office Use Only:
 Well #: _____

The sketch below only required for water wells

Description of formations encountered must be provided for all wells and boreholes, unless specifically exempted by regulations

If well telescopes, show depths on sketch.

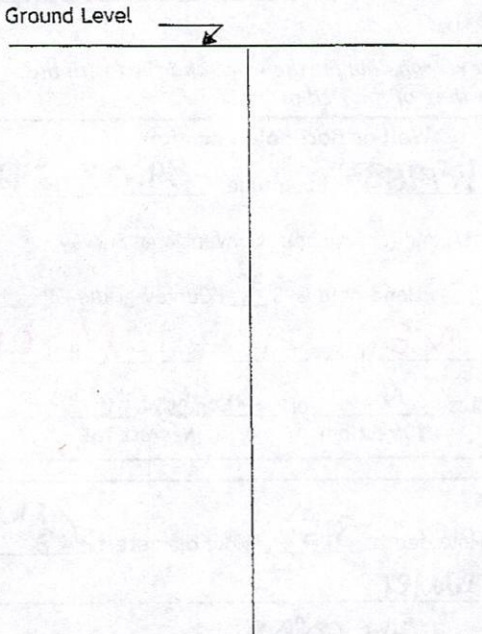

Description of Formations Encountered	From (depth)	To (depth)
Clay	Ground level	38
Sand	38	45
Clay	45	130
Sand	130	168
Broken Sand/clay	168	176
Clay	176	268
Row broken / broken sand	268	287
Row Solid	287	290
Row Broken	290	300
Clay	300	303
Row Broken	303	305
Clay	305	308
Row	308	309
Clay	309	312
Row	312	315
Clay	315	

If more than one screen, show location of each on sketch

- Sketch the property layout and include the following:
- 1) the well location
 - 2) any permanent structures on the property that may aid in locating the well
 - 3) any roads, power lines, or other items that may aid in locating the property and the well
 - 4) north arrow

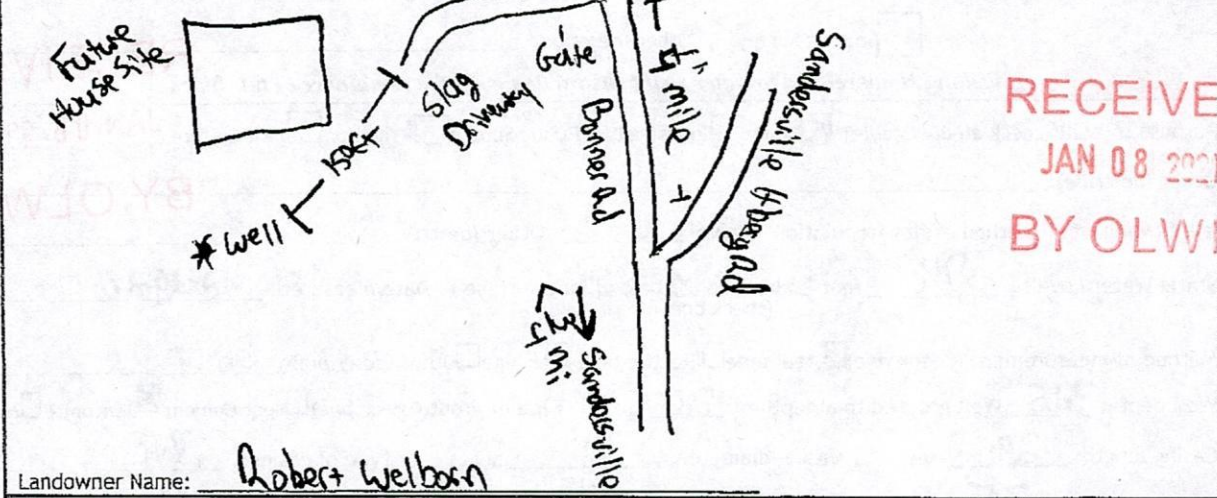

RECEIVED
 JAN 08 2020
 BY OLWR

Landowner Name: Robert Welborn

I HEREBY CERTIFY that the well/borehole was drilled, constructed, and completed in accordance with all applicable requirements of the Mississippi Department of Environmental Quality and the Mississippi Department of Health regulations, if applicable, and state laws.

Oswald West 0-692 12-30-20 Dustin W

STATE WELL REPORT

Part 2

Pump Installer's Completion Report
 Mississippi Department of Environmental Quality
 Office of Land and Water Resources
 P.O. Box 2309
 Jackson, MS 39225-2309
 (601)961-5210
 (601) 360-0535 (fax)

County: Jones
 Permit #: _____
 Driller: David West
 Date completed: 12-29-20
Copy information from block on Part 1

For Office Use Only:

Well #: D 232
 Aquifer: _____

This part of the report must be completed by a licensed water well contractor or a licensed pump installer. A copy of Part 1 of the report must be attached and both parts filed with the Department at the above address within 30 days of well completion.

Well Owner Information	Well Location
Owner Name: <u>Robert Welborn</u>	Latitude: <u>31.79531</u> Longitude: <u>-89.036542</u>
Mailing Address: <u>899 Bonner Rd.</u>	Method of Lat/Long (check one): Conventional Survey _____, USGS quad _____, Hand-held GPS <input checked="" type="checkbox"/> , Survey-grade GPS _____
<u>Sandersville</u> MS <u>39477</u>	NW 1/4 NE 1/4, Sec <u>31</u> T <u>10N</u> R <u>10W</u>
City State Zip Code	<u>3/4</u> Miles <u>N</u> of <u>Sandersville</u>
Telephone No. (601) <u>540-8068</u>	(Distance) (Direction) (Nearest Town)

Pump Type (check one)

Submersible Turbine Air Lift Centrifugal Flowing Well Jet Piston Rotary Other (describe): _____

Date Pump Installed: 12-30-20 Rated Pump Capacity: 25 Gallons Per Minute

Is This Pump (check one): New Repaired Replacement

Power Type (check one)

Electric Diesel Gasoline Natural Gas Tractor PTO Windmill Other (describe): _____

Horse Power Rating of Motor: 2 Setting Depth: 200 feet Number of Stages: _____

Pump Test Data for Non Flowing Well

Date Well Tested: _____ Duration of Pump Test (minimum 4 hours): _____ hours

Static Water Level (A): _____ Feet Below Land Surface Pumping Water Level (B): _____ Feet Below Land Surface

Drawdown [(B) - (A)]: _____ Feet Below Land Surface Test Pumping Rate: _____ Gallons Per Minute

Method of measurement (check one): Steel tape Electric tape Air line Other (describe): _____

Pump Test Data for Flowing Well

Measured shut in head: _____ feet.

Well yielded _____ GPM with a drawdown of _____ feet after _____ hours of pumping

Meter Installation

Meter Manufacturer: _____ Meter Serial Number: _____

Meter Model Number/Name: _____ Type of Meter: _____

Totalizer Register Unit and Multiplier Factor (AF x .001, gal x 1000, etc): _____

Installation Date: _____ Meter installed by: _____

Is This Meter (check one): New Repaired Replacement

Important: By submitting the above information you are certifying that this meter was installed to manufacturer standards. For agricultural wells, a list of approved meters is on the MDEQ website.

I HEREBY CERTIFY that the above statements are true to the best of my knowledge.

David West 0-672 12-30-20 David West
 Print Name of Pump Installer and License No. (if applicable) Date Signature of Pump Installer