

RECEIVED

JUN 10 2019

311 BY OLWR

STATE WELL REPORT

Part 1

Driller's Log

Mississippi Department of Environmental Quality
Office of Land and Water Resources
P.O. Box 2309
Jackson, MS 39225-2309
(601)961-5555
(601)961-5228 (fax)

County: Jones
Permit #:
Driller: David West
Date drilling completed: 5-9-2019

For Office Use Only:
Well #: C 251
Aquifer:
E-Log #:

State Law requires that this report be prepared by the license holder responsible for the work and filed with the Department at the above address within 30 days of completion of drilling of the well or borehole.

Well Owner Information (Landowner if borehole is not for a water well)
Owner Name: Rex Heidelberg
Mailing Address: 36 Johnny Boykin Rd
Lawel MS
City State Zip Code
Telephone No. (601) 218-4419
Well or Borehole Location
Latitude: 31° 45' 48.9" Longitude: -89° 08' 20.07"
Method of Lat/Long (check one): Conventional Survey
USGS quad SE 1/4 NW 1/4, Sec 7 T 9N R 11W
1 Miles N of Lawel, MS
(Distance) (Direction) (Nearest Town)

Well / Borehole Data
Date drilling started: 5-9-2019 Date drilling completed: 5-9-2019 Hole depth: 122' Hole diameter: 6 1/2"
Location of the source of any surface water used for drilling: well water
Method of dosing and volume of Chlorine used in drilling and development: Tabs 50ppm
Logs run (check all applicable): [X] log run [ ] Electric [ ] Gamma Ray [ ] Density [ ] Sonic [ ] Neutron Other:
Name of organization running log(s):
Purpose of borehole (check one): Water Well [X] Geotechnical/Geological Investigation [ ] Ground Source Heat Pump [ ] Seismic Survey Other (describe)
If drilling is not related to water well construction, skip the remainder of this block
Purpose of Well (check all applicable): [ ] Home [ ] Industrial [ ] Public Supply [X] Irrigation [ ] Fish Culture
Other (describe):
If a flowing well, method of flow regulation: Valve Other (describe)
Static Water Level: 56 feet [ ] above or [X] below land surface Date measured: 5-9-2019
Method of measurement (check one) [ ] Steel tape [ ] Electric tape [ ] Air line [ ] other (describe): Sonar
Well depth: 122' Well grouted to a depth of: 20 feet Type of grout (check one) [ ] Neat Cement [X] Bentonite [ ] Mix
Casing length: 112 feet Casing diameter: 4 inches Type of casing: PVC
Screen length: 10 feet Screen diameter: 4 inches Type of screen: PVC
Screen slot size: .088 inches Setting depth: From 112 feet to 122 feet
Type of completion (check all applicable) [X] gravel packed [ ] Underreamed [ ] Open hole [ ] Natural Development
Other (describe):
Top of lap pipe or reduction in casing: feet
If telescoped or more than one screen, describe on next page



County: Jones  
 Permit #: \_\_\_\_\_

**For Office Use Only:**  
 Well #: \_\_\_\_\_

The sketch below only required for water wells  
If well telescopes, show depths on sketch.

Description of formations encountered must be provided for all wells and boreholes, unless specifically exempted by regulations

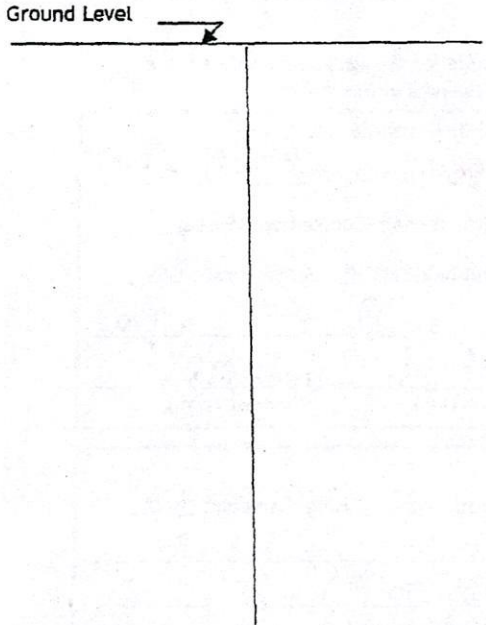

Description of Formations Encountered	From (depth)	To (depth)
Clay	Ground level	26
Sandy Clay	26	48
Sand	48	61
Clay	61	90
Sand	90	120

If more than one screen, show location of each on sketch

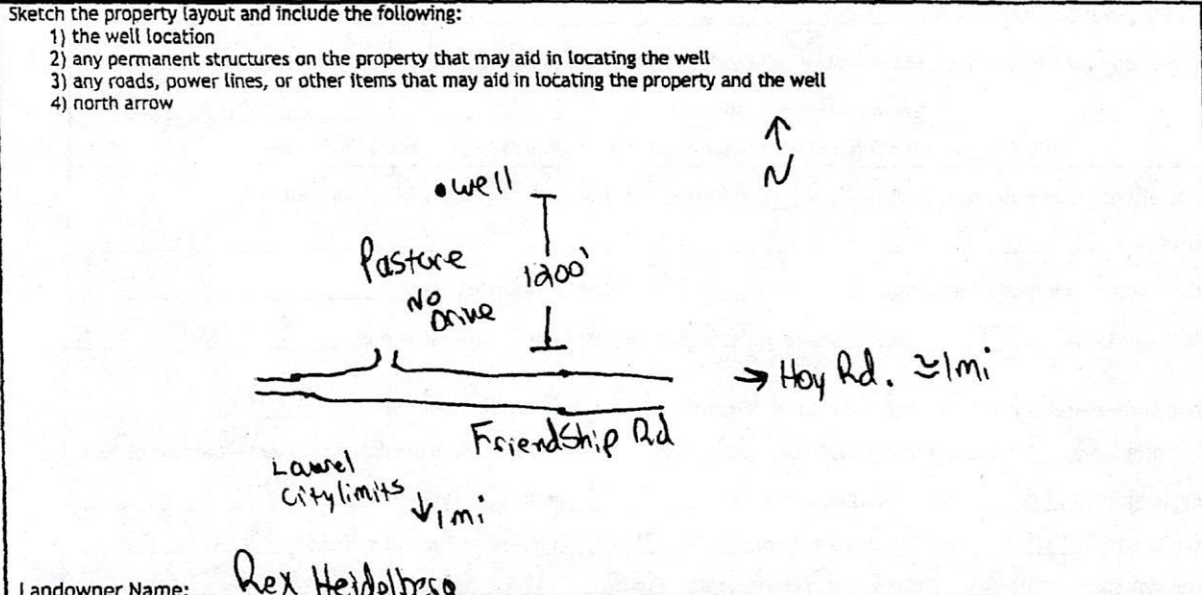

Landowner Name: Rex Heidelberg

I HEREBY CERTIFY that the well/borehole was drilled, constructed, and completed in accordance with all applicable requirements of the Mississippi Department of Environmental Quality and the Mississippi Department of Health regulations, if applicable, and state laws.

David West 0672      6-7-2019      David West  
 Print Name of Responsible Licensee and License No.      Date      Signature of Licensee