

# State Well Report

## Part I

Mississippi Department of Environmental Quality  
 Office of Land and Water Resources  
 P.O. Box 10631  
 Jackson, MS 39289-0631  
 (601)961-5210  
 (601)354-6938 (fax)

### For Office Use Only:

Aquifer: C 239  
 Well #: \_\_\_\_\_  
 L. S. Elevation: \_\_\_\_\_  
 E-log #: \_\_\_\_\_

County: Jones  
 Permit #: \_\_\_\_\_  
 Driller: David West  
 Date drilling completed: 3-23-2011

State Law requires that this report be prepared by the driller in detail and filed with the Department within 30 days of completion of drilling of the well.

Well Owner Information	Well Location
Owner Name: <u>Bobby Sherman</u>	Latitude: <u>31° 45' 00"</u> - Longitude: <u>89° 03' 50"</u>
Mailing Address: <u>115 Sherman Road</u>	Method of Lat/Long (circle one): <u>Conventional Survey</u>
<u>Laurel, MS 39448</u>	USGS quad, Hand-held GPS, Survey-grade GPS
City: _____ State: _____ Zip Code: _____	<u>SW 1/4 NW 1/4 Sec 18 Twn 9N Rng 10W</u>
Telephone No. <u>(601) 425-4736</u>	Distance: <u>2</u> Miles Direction: <u>South</u> of Nearest Town: <u>Sandscville</u>

### Well Data

Purpose of Well (circle one): Home Industrial Public Supply Irrigation Fish Culture Other: \_\_\_\_\_

Date well drilling started: 3-23-2011 Date well drilling completed: 3-23-2011

If flowing, method of flow regulation: Valve \_\_\_\_\_ Other (describe) \_\_\_\_\_

Static Water Level: 30' feet above or below (circle one) land surface Date measured: 3-23-2011

Method of Measurement (circle one) steel tape electric tape air line other: \_\_\_\_\_

Hole depth: 51' Well depth: 51' Well grouted to a depth of 10 feet

Type of grout (circle one): Cement Bentonite Mix

Casing length: 41 feet Casing diameter: 4 inches Type of casing: PVC

Screen length: 10 feet Screen diameter: 4 inches Type of screen: PVC

Screen slot size: .010 inches Setting depth: From \_\_\_\_\_ feet to \_\_\_\_\_ feet

Type of completion (circle all applicable): Gravel packed Underreamed Telescoped Open hole Natural Development

Other (describe): \_\_\_\_\_

Top of lap pipe or reduction in casing: \_\_\_\_\_ feet. If telescoped or more than one screen, describe on back of page

Logs run (circle all applicable): No log run Electric Gamma Ray Density Sonic Neutron Other: \_\_\_\_\_

Name of organization running log(s): \_\_\_\_\_

I certify that the well was drilled, constructed, and completed in accordance with all applicable requirements of the Mississippi Department of Environmental Quality and/or the Mississippi Department of Health regulations and state laws.

David West 0672  
 Print Name of Water Well Contractor and License No.

David West  
 Signature of Water Well Contractor

If well telescopes please sketch below and show depths.

C 239

Ground Level

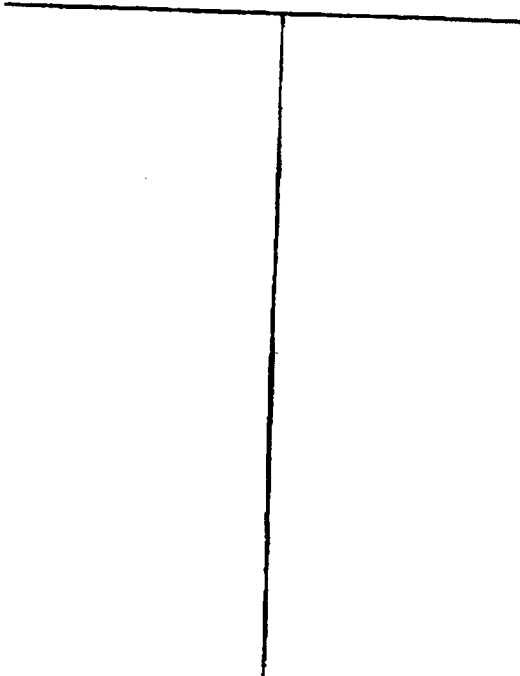

Description of Formations Encountered	From	To
Sand	0	51

If more than one screen, show location of each on sketch

Sketch the property layout and include the following: 1) the well location; 2) any permanent structures on the property that may aid in locating the well; 3) any roads, power lines, or other items that may aid in locating the property and the well; 4) indicate direction.

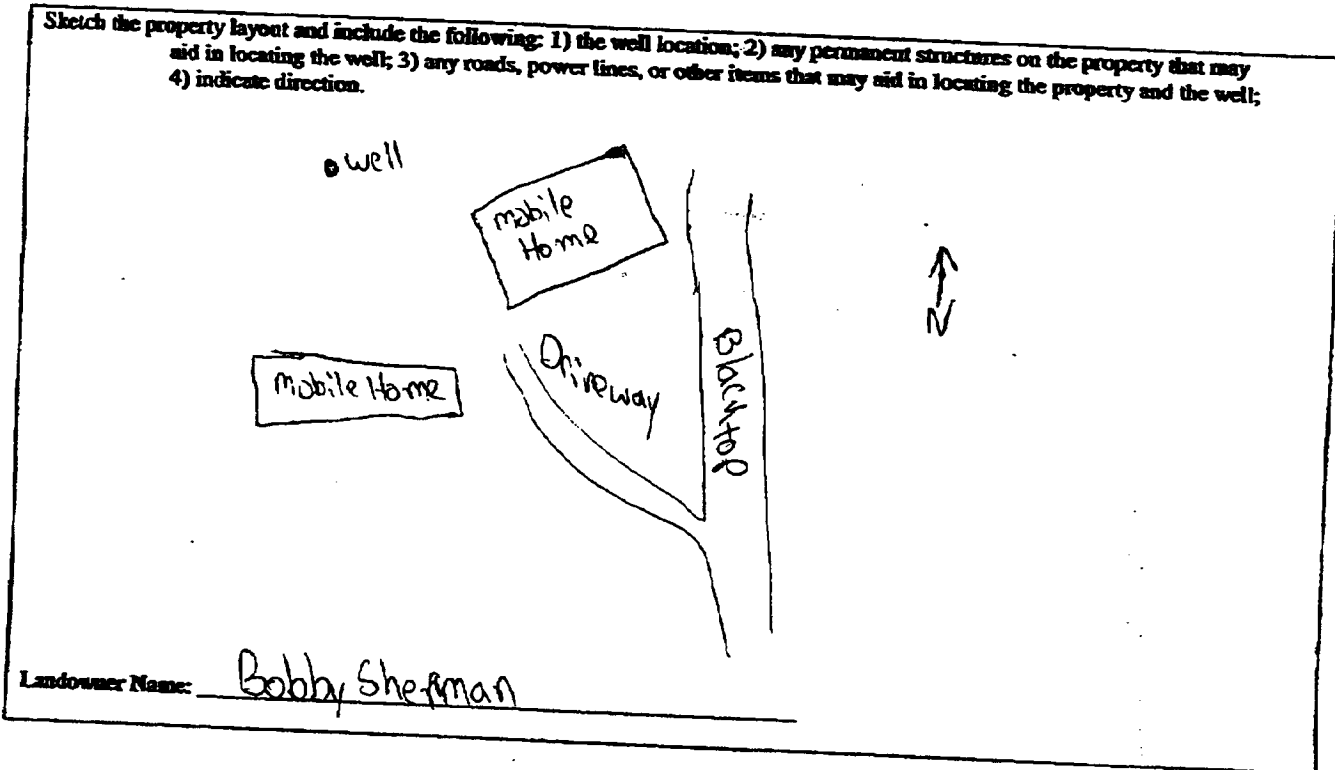

Landowner Name: Bobby Sherman

Dev A W  
Signature of Water Well Contractor

# STATE WELL REPORT

## Part 2

**Pump Installer's Completion Report**  
 Mississippi Department of Environmental Quality  
 Office of Land and Water Resources  
 P.O. Box 10631  
 Jackson, MS 39289-0631  
 (601)961-5210  
 (601)354-6938 (fax)

County: Jones  
 Permit #: \_\_\_\_\_  
 Driller: David West  
 Date completed: 3-23-2011

**For Office Use Only:**  
 Aquifer: \_\_\_\_\_  
 Well #: \_\_\_\_\_  
 Elevation: \_\_\_\_\_

This report should be prepared by the pump installer in detail and filed with the Department within 30 days of the installation of pump.

Well Owner Information	Well Location
Owner Name: <u>Bobby Sherman</u>	Latitude: <u>31°45'00"</u> Longitude: <u>89°03'50"</u>
Mailing Address: <u>115 Sherman Rd</u>	Method of Lat/Long (circle one): <u>Conventional Survey</u>
<u>Laurel MS 39443</u>	USGS quad, Hand-held GPS, Survey-grade GPS
City State Zip Code	<u>SW 1/4 NW 1/4 Sec 18 Twn 9N Rng 10W</u>
Telephone No. <u>(601) 425-4736</u>	Distance Direction Nearest Town
	<u>2 Miles South of Sandersville</u>

Pump Type Circle one	Power Type Circle one
Air Lift Jet <input checked="" type="radio"/> <u>Submersible</u>	Diesel Engine Gasoline Engine Natural Gas
Bucket Piston Turbine	<input checked="" type="radio"/> <u>Electric Motor</u> Hand Tractor PTO
Centrifugal Rotary Flowing Well	Windmill Other (specify): _____
Other (specify): _____	Horse Power Rating of Motor: <u>1/2</u>
Date Pump Installed: <u>3-23-2011</u>	Setting Depth: <u>40</u> feet
Rated Pump Capacity: <u>10</u> Gallons Per Minute	Number of Stages: _____

Pump Test Data	Method of Measuring Water Level Circle one
Date Well Tested: _____	Air Line Electric Measuring Line Steel Tape
Static Water Level (A): _____ Feet Below Land Surface	Other (specify): _____
Pumping Water Level (B): _____ Feet Below Land Surface	For flowing well, measured shut in head: _____ feet
Drawdown [(B) - (A)]: _____ Feet Below Land Surface	Well yielded _____ GPM with a drawdown of _____ feet after _____ hours of pumping
Test Pumping Rate: _____ Gallons Per Minute	
Duration of Pump Test (minimum 4 hours): _____ hours	

I HEREBY CERTIFY that the above statements are true to the best of my knowledge.

David West 0672  
 Print Name of Pump Installer and License No. (if applicable)

David West  
 Signature of Pump Installer