

313

# STATE WELL REPORT

## Part 1

### Driller's Log

Mississippi Department of Environmental Quality  
 Office of Land and Water Resources  
 P.O. Box 2309  
 Jackson, MS 39225-2309  
 (601)961-5210  
 (601)360-0535 (fax)

County: Jones  
 Permit #: \_\_\_\_\_  
 Driller: Keith Parker  
 Date drilling completed: \_\_\_\_\_

**For Office Use Only:**  
 Well #: A 143  
 Aquifer: \_\_\_\_\_  
 E-Log #: \_\_\_\_\_

*State Law requires that this report be prepared by the license holder responsible for the work and filed with the Department at the above address within 30 days of completion of drilling of the well or borehole.*

Well Owner Information <i>(Landowner if borehole is not for a water well)</i>	Well or Borehole Location
Owner Name: <u>Frederick Frazier</u>	Latitude: <u>31.7419</u> Longitude: <u>-89.3393</u>
Mailing Address: <u>379 Mt Williams rd</u>	Method of Lat/Long (check one): Conventional Survey _____
<u>Taylorsville MS 39168</u>	USGS quad _____, Hand-held GPS <input checked="" type="checkbox"/> , Survey-grade GPS _____
City State Zip Code	<u>SW</u> ¼ <u>SE</u> ¼, Sec <u>18</u> T <u>9N</u> R <u>13W</u>
Telephone No. <u>(601) 692-5368</u>	<u>5</u> Miles <u>West</u> of <u>5050</u>
	(Distance) (Direction) (Nearest Town)

**Well / Borehole Data**

Date drilling started: 3-18 Date drilling completed: 3-25 Hole depth: 150 Hole diameter: 6 1/2

Location of the source of any surface water used for drilling: \_\_\_\_\_

Method of dosing and volume of Chlorine used in drilling and development: 1 gal per 1000

Logs run (circle all applicable):  No log run  Electric  Gamma Ray  Density  Sonic  Neutron  Other: \_\_\_\_\_

Name of organization running log(s): \_\_\_\_\_

Purpose of borehole (circle one):  Water Well  Geotechnical/Geological Investigation  Ground Source Heat Pump  
 Seismic Survey  Other (describe) \_\_\_\_\_

*If drilling is not related to water well construction, skip the remainder of this block*

Purpose of Well (circle all applicable):  Home  Industrial  Public Supply  Irrigation  Fish Culture

Other (describe): CATTLE FARM

If a flowing well, method of flow regulation: Valve \_\_\_\_\_ Other (describe) \_\_\_\_\_

Static Water Level: 60 feet [above or below] land surface Date measured: \_\_\_\_\_  
(circle one)

Method of measurement (circle one): Steel tape  Electric tape  Air line  Other (describe): \_\_\_\_\_

Well depth: 150 Well grouted to a depth of: 10 feet Type of grout (circle one):  Neat Cement  Bentonite  Mix

Casing length: 140 feet Casing diameter: 4 inches Type of casing: PVC

Screen length: 10 feet Screen diameter: 4 inches Type of screen: PVC

Screen slot size: 8 inches Setting depth: From 140 feet to 150 feet

Type of completion (circle all applicable): Gravel packed  Underreamed  Open hole  Natural Development

Other (describe): \_\_\_\_\_

Top of lap pipe or reduction in casing: 2 feet

*If telescoped or more than one screen, describe on next page*

RECEIVED  
 JUN 25 2020  
 BY OLWR

# STATE WELL REPORT

## Part 2

### Pump Installer's Completion Report

Mississippi Department of Environmental Quality  
Office of Land and Water Resources  
P.O. Box 2309  
Jackson, MS 39225-2309  
(601)961-5210  
(601) 360-0535 (fax)

County: JONES  
Permit #:  
Driller: Keith Parker  
Date completed: 3-27-20  
*Copy information from block on Part 1*

**For Office Use Only:**

Well #: A 143  
Aquifer: \_\_\_\_\_

*This part of the report must be completed by a licensed water well contractor or a licensed pump installer. A copy of Part 1 of the report must be attached and both parts filed with the Department at the above address within 30 days of well completion.*

Well Owner Information	Well Location
Owner Name: <u>Frederick Frazier</u>	Latitude: <u>31.7419</u> Longitude: <u>-89.3393</u>
Mailing Address: <u>379 Mt Williams rd</u>	Method of Lat/Long (check one): Conventional Survey _____, USGS quad _____, Hand-held GPS _____, Survey-grade GPS _____
<u>Taylorville</u> <u>MS</u> <u>39168</u> City State Zip Code	<u>SW</u> $\frac{1}{4}$ <u>SE</u> $\frac{1}{4}$ , Sec <u>18</u> T <u>9N</u> R <u>13W</u>
Telephone No. <u>(601) 692-5368</u>	<u>5</u> Miles <u>West</u> of <u>5050</u> (Distance) (Direction) (Nearest Town)

**Pump Type (circle one)**

Submersible Turbine Air Lift Centrifugal Flowing Well Jet Piston Rotary Other (describe): \_\_\_\_\_

Date Pump Installed: 3-25-20 Rated Pump Capacity: 20 Gallons Per Minute

Is This Pump (circle one):  New Repaired Replacement

**Power Type (circle one)**

Electric Diesel Gasoline Natural Gas Tractor PTO Windmill Other (describe): \_\_\_\_\_

Horse Power Rating of Motor: 2 Setting Depth: 100 feet Number of Stages: 7

**Pump Test Data for Non Flowing Well**

Date Well Tested: 3-25-20 Duration of Pump Test (minimum 4 hours): 8 hours

Static Water Level (A): 60 Feet Below Land Surface Pumping Water Level (B): 80 Feet Below Land Surface

Drawdown [(B) - (A)]: 70 Feet Below Land Surface Test Pumping Rate: 20 Gallons Per Minute

Method of measurement (circle one): Steel tape  Electric tape Air line Other (describe): \_\_\_\_\_

**Pump Test Data for Flowing Well**

Measured shut in head: 60 feet.

Well yielded 20 GPM with a drawdown of 20 feet after 8 hours of pumping

**Meter Installation**

Meter Manufacturer: \_\_\_\_\_ Meter Serial Number: \_\_\_\_\_

Meter Model Number/Name: \_\_\_\_\_ Type of Meter: \_\_\_\_\_

Totalizer Register Unit and Multiplier Factor (AF x .001, gal x 1000, etc): \_\_\_\_\_

Installation Date: \_\_\_\_\_ Meter installed by: \_\_\_\_\_

Is This Meter (circle one): New Repaired Replacement

RECEIVED  
JUN 25 2020  
BY OLWR

*Important: By submitting the above information you are certifying that this meter was installed to manufacturer standards. For agricultural wells, a list of approved meters is on the MDEQ website.*

I HEREBY CERTIFY that the above statements are true to the best of my knowledge.

Keith Parker 7402 Keith Parker  
Print Name of Pump Installer and License No. (if applicable) Date Signature of Pump Installer

County: JONES  
 Permit #: \_\_\_\_\_

**For Office Use Only:**  
 Well #: \_\_\_\_\_

The sketch below only required for water wells

Description of formations encountered must be provided for all wells and boreholes, unless specifically exempted by regulations

If well telescopes, show depths on sketch.

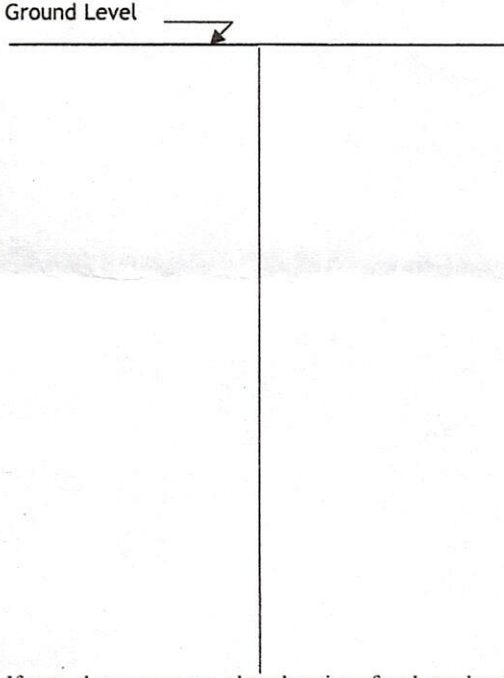

Description of Formations Encountered	From (depth)	To (depth)
Top Soil	0	10
SAND	10	14
CLAY	14	70
SAND	70	75
CLAY	75	100
<del>CLAY</del> SAND	100	122
CLAY	122	125
SAND + Pea GRAVEL	125	150

If more than one screen, show location of each on sketch

Sketch the property layout and include the following:

- 1) the well location
- 2) any permanent structures on the property that may aid in locating the well
- 3) any roads, power lines, or other items that may aid in locating the property and the well
- 4) north arrow

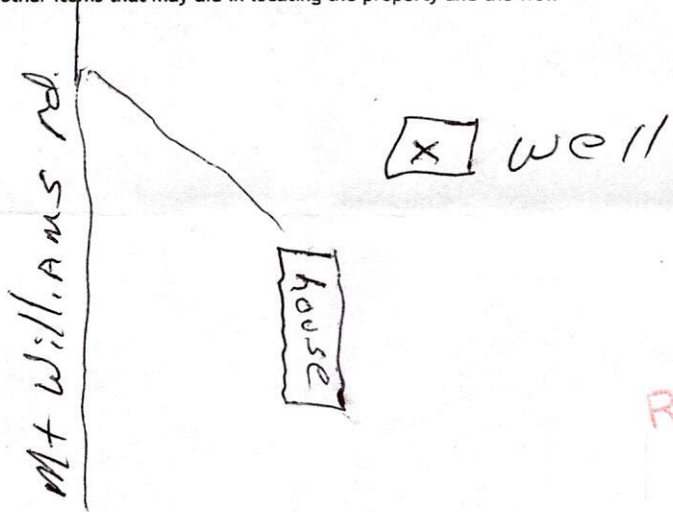

RECEIVED  
 JUN 25 2020  
 BY OLWR

Landowner Name: \_\_\_\_\_

I HEREBY CERTIFY that the well/borehole was drilled, constructed, and completed in accordance with all applicable requirements of the Mississippi Department of Environmental Quality and the Mississippi Department of Health regulation, if applicable, and state laws.

Keith Parker 7402  
 Print Name of Responsible Licensee and License No.

Date

Keith Parker  
 Signature of Licensee