

Well #2

STATE WELL REPORT

338

County: Jasper
 Permit #: _____
 Driller: Rand West
 Date drilling completed: 3-15-2019

**Part 1
 Driller's Log**
 Mississippi Department of Environmental Quality
 Office of Land and Water Resources
 P.O. Box 2309
 Jackson, MS 39225-2309
 (601)961-5555
 (601)961-5228 (fax)

For Office Use Only:
 Well #: P77
 Aquifer: _____
 E-Log #: _____

State Law requires that this report be prepared by the license holder responsible for the work and filed with the Department at the above address within 30 days of completion of drilling of the well or borehole.

Well Owner Information <i>(Landowner if borehole is not for a water well)</i>	Well or Borehole Location
Owner Name: <u>Aylan Shipp</u>	Latitude: <u>31-54-51.6</u> Longitude: <u>89-02-12.2</u>
Mailing Address: <u>149 Pine Dr.</u>	Method of Lat/Long (check one): Conventional Survey _____ USGS quad _____, Hand-held GPS _____, Survey-grade GPS _____
<u>Lourel</u> <u>MS</u> <u>39443</u>	<u>SU 1/4 NE 1/4, Sec 23 T 1 N R 10W 12E</u>
City State Zip Code	<u>2</u> Miles <u>NNW</u> of <u>Heidelberg</u>
Telephone No. <u>(601) 422-3204</u>	(Distance) (Direction) (Nearest Town)

Well / Borehole Data

Date drilling started: 3-11-2019 Date drilling completed: 3-15-2019 Hole depth: 662' Hole diameter: 6"

Location of the source of any surface water used for drilling: Creek on Hwy 52B

Method of dosing and volume of Chlorine used in drilling and development: Tabs 50PPM

Logs run (check all applicable): log run Electric Gamma Ray Density Sonic Neutron Other: _____

Name of organization running log(s): _____

Purpose of borehole (check one): Water Well Geotechnical/Geological Investigation Ground Source Heat Pump
 Seismic Survey Other (describe) _____

If drilling is not related to water well construction, skip the remainder of this block

RECEIVED
 MAR 29 2019
 BY OLWR

Purpose of Well (check all applicable): Home Industrial Public Supply Irrigation Fish Culture
 Other (describe): Poultry Farm

If a flowing well, method of flow regulation: Valve _____ Other (describe) _____

Static Water Level: 136 feet above or below land surface Date measured: 3-15-2019
 (check one)

Method of measurement (check one) Steel tape Electric tape Air line other (describe): Sonar

Well depth: 662' Well grouted to a depth of: 50 feet Type of grout (check one) Neat Cement Bentonite Mix

Casing length: 622 feet Casing diameter: 4 inches Type of casing: PVC

Screen length: 40 feet Screen diameter: 4 inches Type of screen: PVC

Screen slot size: .010 inches Setting depth: From 622 feet to 662 feet

Type of completion (check all applicable) gravel packed Underreamed Open hole Natural Development

Other (describe): _____

Top of lap pipe or reduction in casing: _____ feet

If telescoped or more than one screen, describe on next page

Well #2

County: Jasper
 Permit #: _____

For Office Use Only:

Well #: P77

The sketch below only required for water wells

If well telescopes, show depths on sketch.

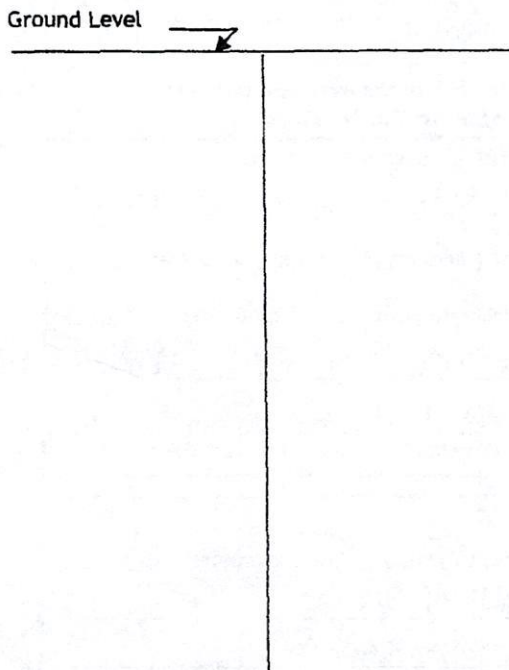

Description of formations encountered must be provided for all wells and boreholes, unless specifically exempted by regulations

Description of Formations Encountered	From (depth)	To (depth)
Clay	Ground level	85
Sandy	85	91
Clay	91	280
Moody's Branch	280	307
Clay	307	340
Sand w/ clay breaks	340	528
Rock	528	531
Clay w/ rocks	531	590
Sand	590	619
Good Sand	619	662

If more than one screen, show location of each on sketch

Sketch the property layout and include the following:

- 1) the well location
- 2) any permanent structures on the property that may aid in locating the well
- 3) any roads, power lines, or other items that may aid in locating the property and the well
- 4) north arrow

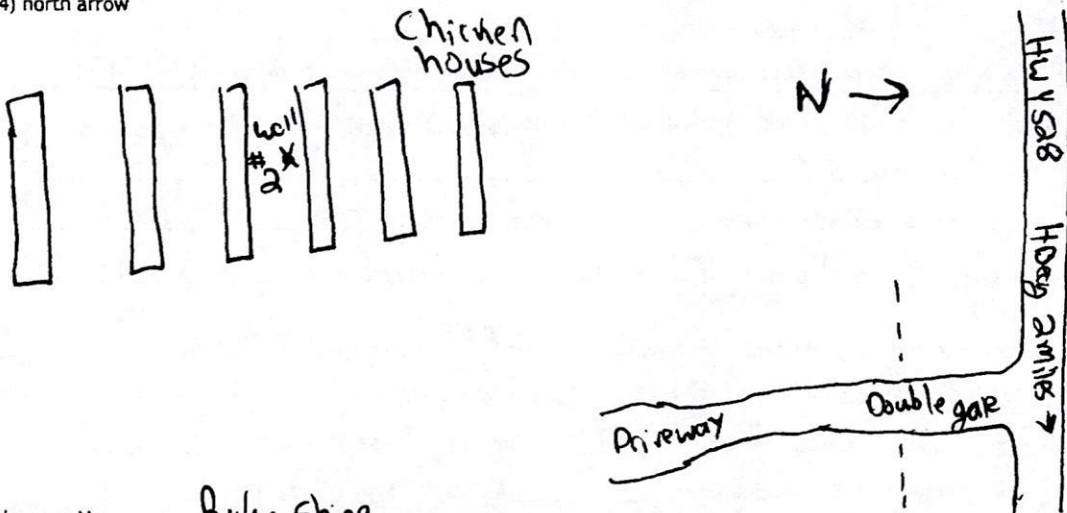

Landowner Name: Rylan Shipp

I HEREBY CERTIFY that the well/borehole was drilled, constructed, and completed in accordance with all applicable requirements of the Mississippi Department of Environmental Quality and the Mississippi Department of Health regulations, if applicable, and state laws.

Dan West 0672

Print Name of Responsible Licensee and License No.

3-26-2019

Date

[Signature]

Signature of Licensee

Well #2

STATE WELL REPORT

Part 2

Pump Installer's Completion Report
 Mississippi Department of Environmental Quality
 Office of Land and Water Resources
 P.O. Box 2309
 Jackson, MS 39225-2309
 (601)961-5210
 (601) 360-0535 (fax)

For Office Use Only:

Well #: P77

Aquifer: _____

County: 205/pc
 Permit #: _____
 Driller: David West
 Date completed: 3-15-2019
 Copy information from block on Part 1

This part of the report must be completed by a licensed water well contractor or a licensed pump installer. A copy of Part 1 of the report must be attached and both parts filed with the Department at the above address within 30 days of well completion.

Well Owner Information			Well Location		
Owner Name: <u>Rylan Shipp</u>			Latitude: _____	Longitude: _____	
Mailing Address: <u>149 Pine Dr.</u>			Method of Lat/Long (check one): Conventional Survey _____		
<u>Laurel</u>	<u>MS</u>	<u>39443</u>	USGS quad _____, Hand-held GPS _____, Survey-grade GPS _____		
City	State	Zip Code	<u>SW 1/4 NE 1/4, Sec 23 T1N R10W</u>		
Telephone No. (<u>601</u>) <u>422-3204</u>			<u>2</u> Miles <u>NNW</u> of <u>Heidelberg</u>		
			(Distance) (Direction) (Nearest Town)		

Pump Type (check one)
 Submersible Turbine Air Lift Centrifugal Flowing Well Jet Piston Rotary Other (describe): _____
 Date Pump Installed: 3-21-2019 Rated Pump Capacity: 65 Gallons Per Minute
 Is This Pump (check one): New Repaired Replacement

Power Type (check one)
 Electric Diesel Gasoline Natural Gas Tractor PTO Windmill Other (describe): _____
 Horse Power Rating of Motor: 5 Setting Depth: 189 feet Number of Stages: _____

Pump Test Data for Non Flowing Well
 Date Well Tested: _____ Duration of Pump Test (minimum 4 hours): _____ hours
 Static Water Level (A): _____ Feet Below Land Surface Pumping Water Level (B): _____ Feet Below Land Surface
 Drawdown [(B) - (A)]: _____ Feet Below Land Surface Test Pumping Rate: _____ Gallons Per Minute
 Method of measurement (check one): Steel tape Electric tape Air line Other (describe): _____

Pump Test Data for Flowing Well
 Measured shut in head: _____ feet.
 Well yielded _____ GPM with a drawdown of _____ feet after _____ hours of pumping

Meter Installation
 Meter Manufacturer: _____ Meter Serial Number: _____
 Meter Model Number/Name: _____ Type of Meter: _____
 Totalizer Register Unit and Multiplier Factor (AF x .001, gal x 1000, etc): _____
 Installation Date: _____ Meter installed by: _____
 Is This Meter (check one): New Repaired Replacement
Important: By submitting the above information you are certifying that this meter was installed to manufacturer standards. For agricultural wells, a list of approved meters is on the MDEQ website.

RECEIVED
 MAR 29 2019
 BY OLWR

I HEREBY CERTIFY that the above statements are true to the best of my knowledge.
David West 0692 3-26-2019 [Signature]
 Print Name of Pump Installer and License No. (if applicable) Date Signature of Pump Installer