

A1

STATE WELL REPORT

Part 1

Driller's Log

Mississippi Department of Environmental Quality
 Office of Land and Water Resources
 P.O. Box 2309
 Jackson, MS 39225-2309
 (601)961-5210
 (601)360-0535 (fax)

For Office Use Only:

Well #: H25
 Aquifer: _____
 E-Log #: _____

County: Jasper
 Permit #: _____
 Driller: West Water Well
 Date drilling completed: 12-13-14

State Law requires that this report be prepared by the license holder responsible for the work and filed with the Department at the above address within 30 days of completion of drilling of the well or borehole.

Well Owner Information <i>(Landowner if borehole is not for a water well)</i>	Well or Borehole Location
Owner Name: <u>Chris Mathis</u>	Latitude: <u>32-07-18</u> Longitude: <u>88-58-48</u>
Mailing Address: <u>194 CR 18242</u>	Method of Lat/Long (check one): Conventional Survey _____
<u>Roschill</u> MS <u>39356</u>	USGS quad _____, Hand-held GPS _____, Survey-grade GPS _____
City State Zip Code	<u>NW</u> <u>NW</u> <u>NE</u> 1/4 <u>SE</u> 1/4, Sec. <u>26</u> ⁹ T <u>3N</u> R <u>13E</u>
Telephone No. <u>(601) 670-1274</u>	<u>7</u> Miles <u>SE</u> of <u>Rose Hill</u> (Distance) (Direction) (Nearest Town)

Well / Borehole Data

Date drilling started: 12-12-14 Date drilling completed: 12-13-14 Hole depth: 360 Hole diameter: 6 1/2

Location of the source of any surface water used for drilling: _____

Method of dosing and volume of Chlorine used in drilling and development: _____

Logs run (circle all applicable): No log run Electric Gamma Ray Density Sonic Neutron Other: _____

Name of organization running log(s): _____

Purpose of borehole (circle one): Water Well Geotechnical/Geological Investigation Ground Source Heat Pump
 Seismic Survey Other (describe) _____

If drilling is not related to water well construction, skip the remainder of this block

Purpose of Well (circle all applicable): Home Industrial Public Supply Irrigation Fish Culture
 Other (describe): Poultry Farm

If a flowing well, method of flow regulation: Valve _____ Other (describe) _____

Static Water Level: 117 feet [above or below] land surface Date measured: 12-13-14
 (circle one)

Method of measurement (circle one): Steel tape Electric tape Air line Other (describe): _____

Well depth: 360 Well grouted to a depth of: 56 feet Type of grout (circle one): Neat Cement Bentonite Mix

Casing length: 340 feet Casing diameter: 4 inches Type of casing: PVC

Screen length: 20 feet Screen diameter: 4 inches Type of screen: PVC slotted

Screen slot size: .010 inches Setting depth: From 340 feet to 360 feet

Type of completion (circle all applicable): Gravel packed Underreamed Open hole Natural Development
 Other (describe): _____

Top of lap pipe or reduction in casing: _____ feet

If telescoped or more than one screen, describe on next page

County: Jasper
Permit #: _____

For Office Use Only:
Well #: H25

#1

The sketch below only required for water wells
If well telescopes, show depths on sketch.

Description of formations encountered must be provided for all wells and boreholes, unless specifically exempted by regulations

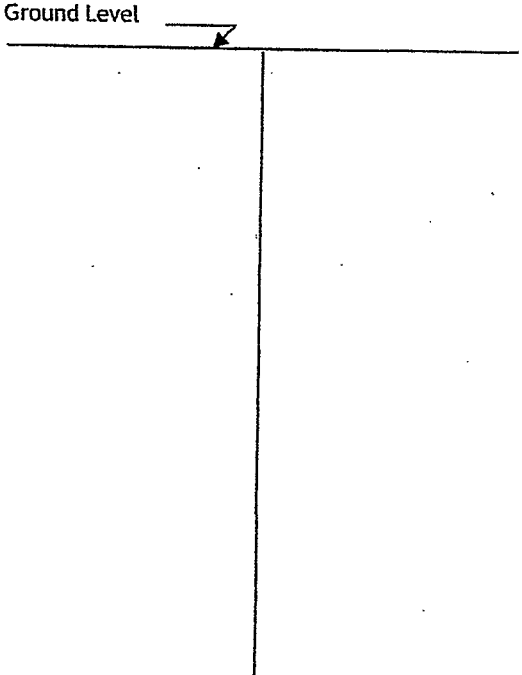

Description of Formations Encountered	From (depth)	To (depth)
SANDY RED CLAY	Ground level	31
SANDY BLUE CLAY	31	294
SAND STRIKE	294	307
SAND	307	360

If more than one screen, show location of each on sketch

- Sketch the property layout and include the following:
- 1) the well location
 - 2) any permanent structures on the property that may aid in locating the well
 - 3) any roads, power lines, or other items that may aid in locating the property and the well
 - 4) north arrow

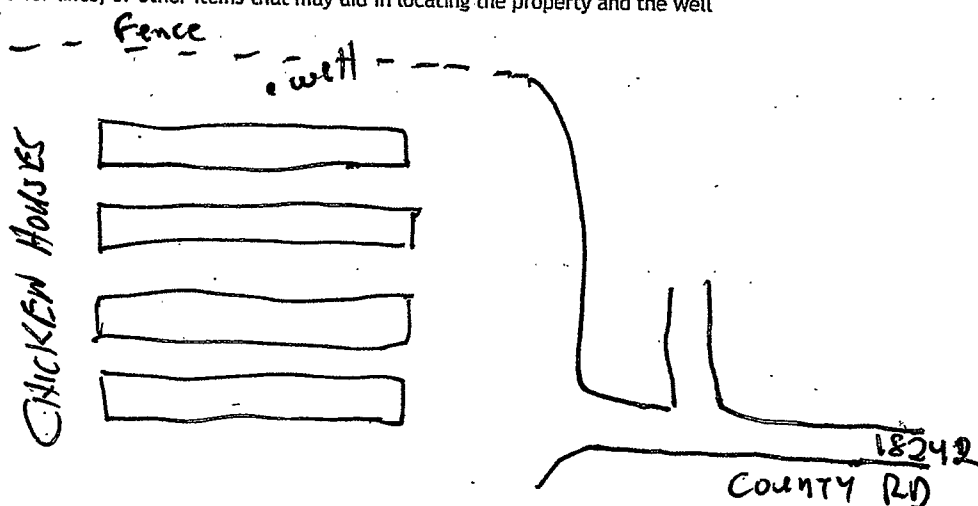

Landowner Name: Chris Mathis

I HEREBY CERTIFY that the well/borehole was drilled, constructed, and completed in accordance with all applicable requirements of the Mississippi Department of Environmental Quality and the Mississippi Department of Health regulations, if applicable, and state laws.

David A. West 0-672 3-30-17 David A. West
Print Name of Responsible Licensee and License No. Date Signature of Licensee

#1

STATE WELL REPORT

Part 2

Pump Installer's Completion Report
 Mississippi Department of Environmental Quality
 Office of Land and Water Resources
 P.O. Box 2309
 Jackson, MS 39225-2309
 (601)961-5210
 (601) 360-0535 (fax)

County: O Jasper
 Permit #: _____
 Driller: West Water Well
 Date completed: 12-13-14
Copy information from block on Part 1

For Office Use Only:
 Well #: H25
 Aquifer: _____

This part of the report must be completed by a licensed water well contractor or a licensed pump installer. A copy of Part 1 of the report must be attached and both parts filed with the Department at the above address within 30 days of well completion.

Well Owner Information			Well Location	
Owner Name: <u>Chris Mathis</u>	Latitude: <u>32-07-18</u>		Longitude: <u>88-58-48</u>	
Mailing Address: <u>194 CR 18242</u>	Method of Lat/Long (check one): Conventional Survey _____			
<u>Rose Hill</u> MS <u>39356</u>	USGS quad _____, Hand-held GPS _____, Survey-grade GPS _____			
City State Zip Code	<u>NENW</u> <u>SE</u> <u>26</u> <u>9</u> <u>T 3N R 13E</u>			
Telephone No. <u>(601) 670-1274</u>	<u>7</u> Miles <u>SE</u> of <u>Rose Hill</u>		(Distance) (Direction) (Nearest Town)	

Pump Type (circle one)
 Submersible Turbine Air Lift Centrifugal Flowing Well Jet Piston Rotary Other (describe): _____
 Date Pump Installed: 12-14-14 Rated Pump Capacity: 50 Gallons Per Minute
 Is This Pump (circle one): New Repaired Replacement

Power Type (circle one)
 Electric Diesel Gasoline Natural Gas Tractor PTO Windmill Other (describe): _____
 Horse Power Rating of Motor: 5 Setting Depth: 180 feet Number of Stages: _____

Pump Test Data for Non Flowing Well
 Date Well Tested: _____ Duration of Pump Test (minimum 4 hours): _____ hours
 Static Water Level (A): _____ Feet Below Land Surface Pumping Water Level (B): _____ Feet Below Land Surface
 Drawdown [(B) - (A)]: _____ Feet Below Land Surface Test Pumping Rate: _____ Gallons Per Minute
 Method of measurement (circle one): Steel tape Electric tape Air line Other (describe): _____

Pump Test Data for Flowing Well
 Measured shut in head: _____ feet.
 Well yielded _____ GPM with a drawdown of _____ feet after _____ hours of pumping

Meter Installation
 Meter Manufacturer: _____ Meter Serial Number: _____
 Meter Model Number/Name: _____ Type of Meter: _____
 Totalizer Register Unit and Multiplier Factor (AF x .001, gal x 1000, etc): _____
 Installation Date: _____ Meter installed by: _____
 Is This Meter (circle one): New Repaired Replacement

Important: By submitting the above information you are certifying that this meter was installed to manufacturer standards. For agricultural wells, a list of approved meters is on the MDEQ website.

I HEREBY CERTIFY that the above statements are true to the best of my knowledge.
David A West 0-672 3-30-17 David A West
 Print Name of Pump Installer and License No. (if applicable) Date Signature of Pump Installer