

STATE WELL REPORT

Part 1

Driller's Log

Mississippi Department of Environmental Quality
Office of Land and Water Resources
P.O. Box 2309
Jackson, MS 39225-2309
(601)961-5210
(601)360-0535 (fax)

For Office Use Only:

Well #: 0622
Aquifer: _____
E-Log #: _____

County: Jackson
Permit #: MS-6W-17334 ✓
Driller: Lynan Well
Date drilling completed: 3/9/2017

State Law requires that this report be prepared by the license holder responsible for the work and filed with the Department at the above address within 30 days of completion of drilling of the well or borehole.

Well Owner Information <small>(Landowner if borehole is not for a water well)</small>	Well or Borehole Location
Owner Name: <u>Utility Services LLC</u>	Latitude: 30° 23' 02.07" N <u>30° 23' 04.42" N</u> Longitude: 88° 43' 02.33" W <u>88° 42' 58.02" W</u>
Mailing Address: <u>8717 Edgewater Blvd</u>	Method of Lat/Long (check one): Conventional Survey _____, USGS quad _____, Hand-held GPS <input checked="" type="checkbox"/> , Survey-grade GPS _____
<u>Ocean Springs</u> <u>MS</u> <u>39564</u>	<u>NE</u> ¹ / ₄ <u>NE</u> ¹ / ₄ , Sec <u>06</u> T <u>8S</u> R <u>5W</u>
City State Zip Code	_____ Miles _____ of _____ (Distance) (Direction) (Nearest Town)
Telephone No. <u>(228) 872-4904</u>	

Corrected from original

Well / Borehole Data

Date drilling started: 2/15/17 Date drilling completed: 3/9/17 Hole depth: 340 Hole diameter: 18"
Location of the source of any surface water used for drilling: NA
Method of dosing and volume of Chlorine used in drilling and development: Bleach
Logs run (circle all applicable): No log run Electric Gamma Ray Density Sonic Neutron Other: _____
Name of organization running log(s): _____
Purpose of borehole (circle one): Water Well Geotechnical/Geological Investigation Ground Source Heat Pump
 Seismic Survey Other (describe) _____

If drilling is not related to water well construction, skip the remainder of this block

Purpose of Well (circle all applicable): Home Industrial Public Supply Irrigation Fish Culture
Other (describe): _____
If a flowing well, method of flow regulation: Valve _____ Other (describe) _____
Static Water Level: 45 feet [above or below] land surface Date measured: 3/9/17
(circle one)
Method of measurement (circle one): Steel tape Electric tape Air line Other (describe): _____
Well depth: 340 Well grouted to a depth of: 290 feet Type of grout (circle one): Neat Cement Bentonite Mix
Casing length: 285 feet Casing diameter: 12 inches Type of casing: Steel
Screen length: 50 feet Screen diameter: 6x8 inches Type of screen: municipal
Screen slot size: .012 inches Setting depth: From 290 feet to 340 feet
Type of completion (circle all applicable): Gravel packed Underreamed Open hole Natural Development
Other (describe): _____
Top of lap pipe or reduction in casing: 220 feet

If telescoped or more than one screen, describe on next page

RECEIVED
MAR 13 2017
BY OLWR

STATE WELL REPORT

Part 2

Pump Installer's Completion Report
Mississippi Department of Environmental Quality
Office of Land and Water Resources
P.O. Box 2309
Jackson, MS 39225-2309
(601)961-5210
(601) 360-0535 (fax)

For Office Use Only:

Well #: 0622
Aquifer:

County: Jackson
Permit #: MSGW-17334N
Driller: Lyman Well
Date completed: 5-30-17
Copy information from block on Part 1

This part of the report must be completed by a licensed water well contractor or a licensed pump installer. A copy of Part 1 of the report must be attached and both parts filed with the Department at the above address within 30 days of well completion.

Well Owner Information: Utility Services LLC, 8717 Edgewater Blvd, Ocean Springs MS 39564, Telephone No. (228) 872-4904
Well Location: Latitude: 30°23'02.07"N, Longitude: 88°43'03.33"W, Method of Lat/Long: Conventional Survey, USGS quad NE 1/4 NE 1/4, Sec 06 T 85 R 7W

RECEIVED JUN 01 2017 BY OLWR

Pump Type (circle one): Turbine
Date Pump Installed: 5/15/17
Rated Pump Capacity: 500 Gallons Per Minute
Is This Pump (circle one): New

Power Type (circle one): Electric
Horse Power Rating of Motor: 50
Setting Depth: 200 feet
Number of Stages: 6

Pump Test Data for Non Flowing Well
Date Well Tested: 5-30-17
Duration of Pump Test (minimum 4 hours): 4 hours
Static Water Level (A): 50 Feet Below Land Surface
Pumping Water Level (B): 140 Feet Below Land Surface
Drawdown [(B) - (A)]: 90 Feet Below Land Surface
Test Pumping Rate: 500 Gallons Per Minute
Method of measurement (circle one): Electric tape

Pump Test Data for Flowing Well
Measured shut in head: NA feet
Well yielded NA GPM with a drawdown of NA feet after NA hours of pumping

Meter Installation
Meter Manufacturer:
Meter Serial Number:
Meter Model Number/Name:
Type of Meter:
Totalizer Register Unit and Multiplier Factor (AF x .001, gal x .1000, etc):
Installation Date:
Meter installed by:
Is This Meter (circle one): New

Important: By submitting the above information you are certifying that this meter was installed to manufacturer standards. For agricultural wells, a list of approved meters is on the MDEQ website.

I HEREBY CERTIFY that the above statements are true to the best of my knowledge.
Print Name of Pump Installer and License No. (if applicable): Josh Ladner 0-640
Date: 5/30/17
Signature of Pump Installer: [Signature]



HOOBSON ESTIMATES #2

RECEIVED

MAR 13 2007

BY OLWR

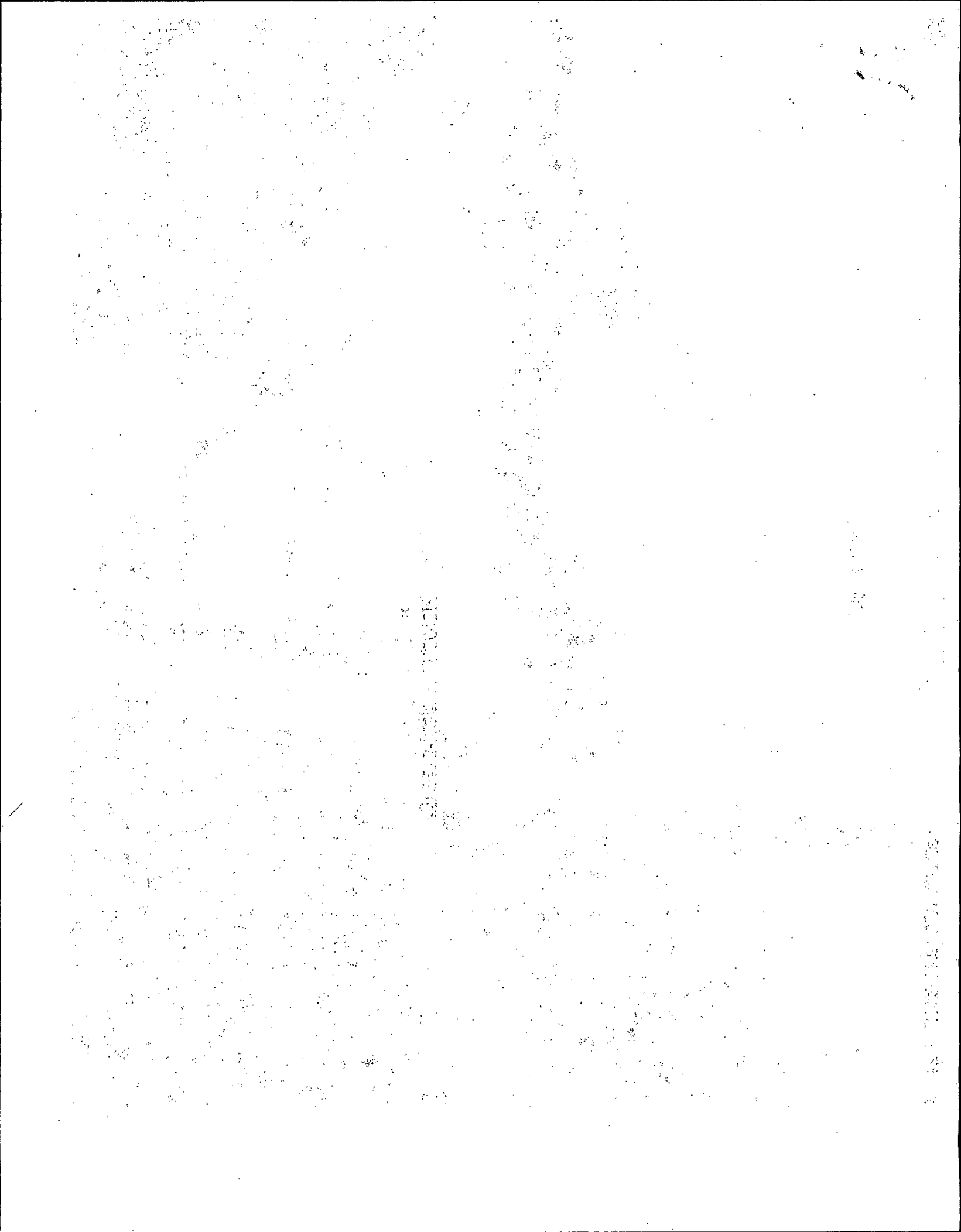

(LATIMER)



GAUTIER NORTH QUADRANGLE
MISSISSIPPI
TOPOGRAPHIC SERIES

(THREE
RIVERS)

088° 44' 05.8553" W
030° 24' 28.2901" N

088° 41' 48.6998" W
030° 24' 28.2901" N

(VANCLEAVE)

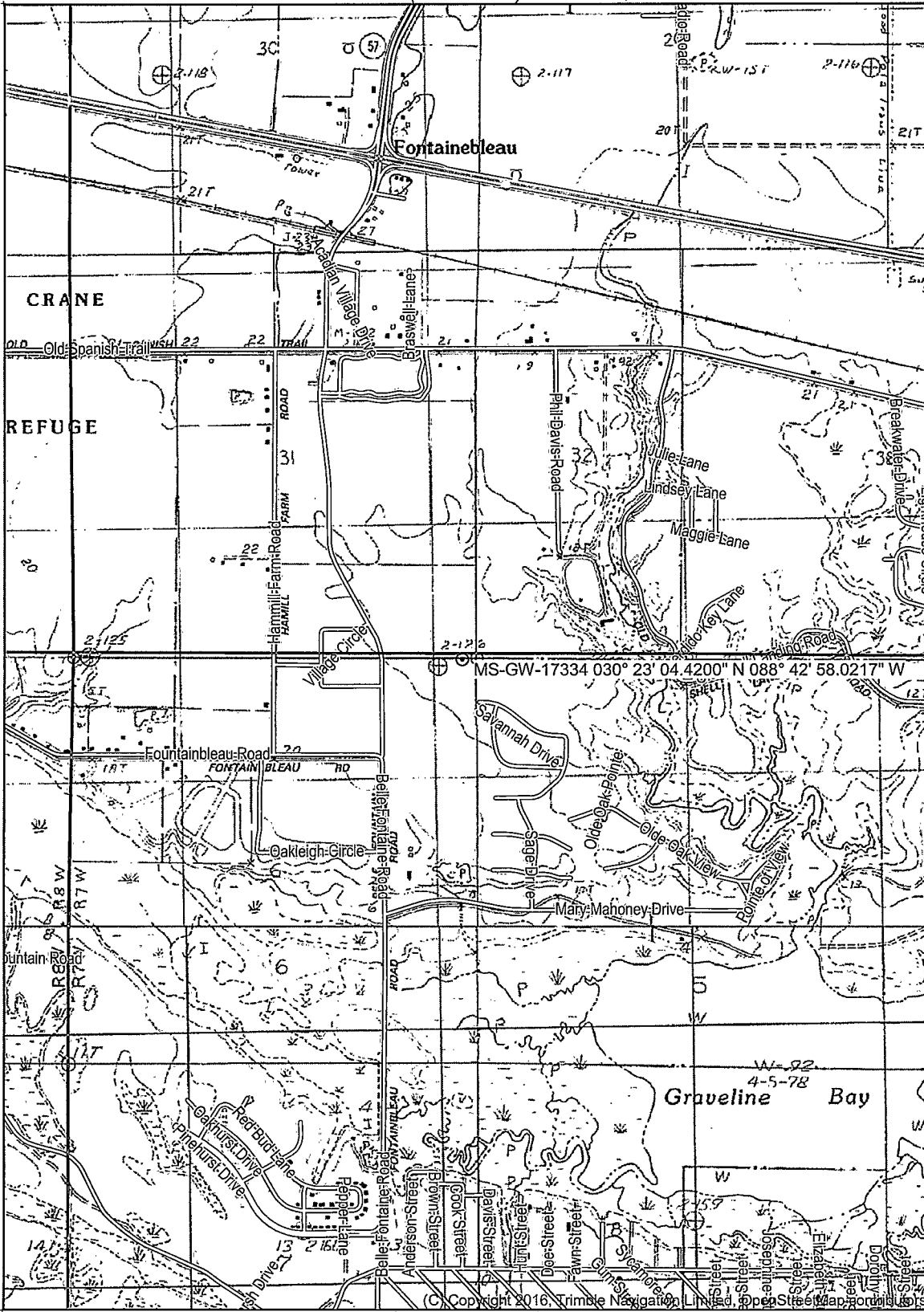

(OCEAN
SPRINGS)

(PASCAGOULA
NORTH)

MS-GW-17334 030° 23' 04.4200" N 088° 42' 58.0217" W

030° 21' 40.6876" N
088° 44' 05.8553" W

030° 21' 40.6876" N
088° 41' 48.6998" W

(DEER ISLAND)

(PASCAGOULA
SOUTH)

Declination



GN 0.86° W
MN 1.79° W

(GAUTIER SOUTH)
SCALE 1:24000

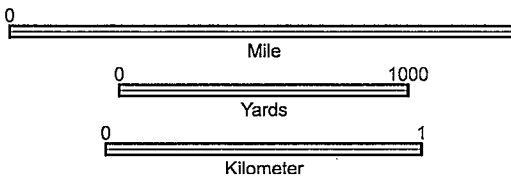

CONTOUR INTERVAL 5 FT

Produced by Trimble Terrain Navigator Pro
Topography based on USGS 1:24,000
Maps

North American 1983 Datum (NAD83)

To place on the predicted North American
1927 move the projection lines 22M N and
2M W

30088-D6-TM-024
GAUTIER NORTH, MS
JAN 1, 1982

(C) Copyright 2016, Trimble Navigation Limited. OpenStreetMap, Portland, OR

Printed: Fri Feb 09, 2018

Phil Davis Road

age Circle

MS-GW-17334 030° 23' 04.4200" N 088° 42' 58.0217

Village Circle

Olde Magnolia Drive

Fontainebleau Road

Savannah Drive

Belle Fontaine Road

Sage Drive

