

# STATE WELL REPORT

## Part 1

### Driller's Log

Mississippi Department of Environmental Quality  
Office of Land and Water Resources  
P.O. Box 2309  
Jackson, MS 39225-2309  
(601)961-5210  
(601)360-0535 (fax)

County: Jackson  
 Permit #: \_\_\_\_\_  
 Driller: Coast Water Wells Inc  
 Date drilling completed: 7-13-16

**For Office Use Only:**

Well #: N1118  
 Aquifer: \_\_\_\_\_  
 E-Log #: \_\_\_\_\_

*State Law requires that this report be prepared by the license holder responsible for the work and filed with the Department at the above address within 30 days of completion of drilling of the well or borehole.*

Well Owner Information <small>(Landowner if borehole is not for a water well)</small>	Well or Borehole Location
Owner Name: <u>John Mavar</u>	Latitude: <u>30° 22' 12.72"</u> Longitude: <u>088° 46' 43.08"</u>
Mailing Address: <u>11017 Pointe Aux Chenes</u>	Method of Lat/Long (check one): Conventional Survey _____, USGS quad _____, Hand-held GPS <input checked="" type="checkbox"/> , Survey-grade GPS _____
<u>Ocean Springs, Ms 39564</u>	NE <u>50</u> 1/4 SW <u>50</u> 1/4, Sec <u>310</u> T <u>85</u> R <u>8w</u>
City _____ State _____ Zip Code _____	<u>2</u> Miles <u>SE</u> of <u>Ocean Springs</u>
Telephone No. <u>601 875-9083</u>	(Distance) (Direction) (Nearest Town)

**Well / Borehole Data**

Date drilling started: 7-11-16 Date drilling completed: 7-13-16 Hole depth: 390 FT Hole diameter: 4" X 2"

Location of the source of any surface water used for drilling: N/A

Method of dosing and volume of Chlorine used in drilling and development: 1 gal per 1000 drilling 2 gal in well

Logs run (circle all applicable):  No log run  Electric  Gamma Ray  Density  Sonic  Neutron Other: \_\_\_\_\_

Name of organization running log(s): \_\_\_\_\_

Purpose of borehole (circle one):  Water Well  Geotechnical/Geological Investigation  Ground Source Heat Pump

Seismic Survey Other (describe) \_\_\_\_\_

*If drilling is not related to water well construction, skip the remainder of this block*

Purpose of Well (circle all applicable):  Home  Industrial  Public Supply  Irrigation  Fish Culture

Other (describe): \_\_\_\_\_

If a flowing well, method of flow regulation: Valve \_\_\_\_\_ Other (describe) \_\_\_\_\_

Static Water Level: 55 feet [above or (below) land surface] (circle one) Date measured: 7-13-16

Method of measurement (circle one): Steel tape  Electric tape  Air line  Other (describe): \_\_\_\_\_

Well depth: 390 FT Well grouted to a depth of: \_\_\_\_\_ feet Type of grout (circle one): Neat Cement  Bentonite  Mix

Casing length: 170 feet Casing diameter: 4" X 2" inches Type of casing: PVC

Screen length: 20 feet Screen diameter: 2 inches Type of screen: PVC

Screen slot size: .006 inches Setting depth: From 370 feet to 390 feet

Type of completion (circle all applicable): Gravel packed  Underreamed  Open hole  Natural Development

Other (describe): \_\_\_\_\_

Top of lap pipe or reduction in casing: 200 feet

*If telescoped or more than one screen, describe on next page*

Received

JUL 20 2016  
Form: OLWR-SWR-1A (4/13)  
By OLWR

County: Jackson  
Permit #: \_\_\_\_\_

**For Office Use Only:**  
Well #: N1118

The sketch below only required for water wells  
If well telescopes, show depths on sketch.

Description of formations encountered must be provided for all wells  
and boreholes, unless specifically exempted by regulations

Ground Level →

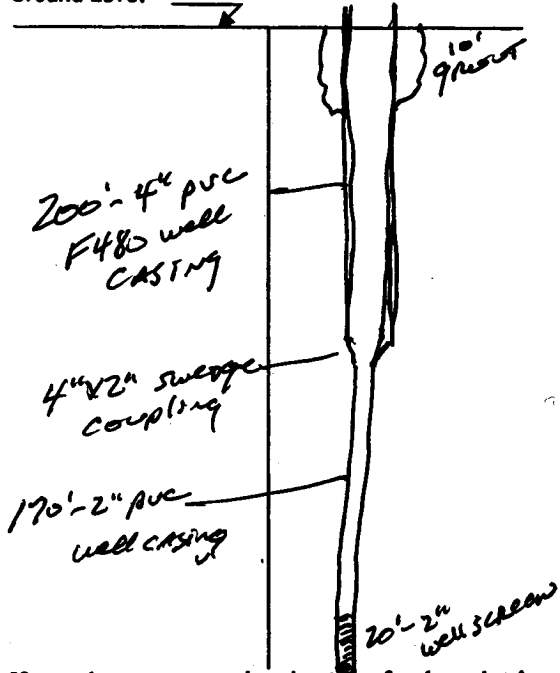

Description of Formations Encountered	From (depth)	To (depth)
Top soil	Ground level	2
White coarse sand	2	25
Blue clay	25	45
White coarse sand	45	191
Blue clay	191	360
Gray coarse sand	360	390

If more than one screen, show location of each on sketch

Sketch the property layout and include the following:

- 1) the well location
- 2) any permanent structures on the property that may aid in locating the well
- 3) any roads, power lines, or other items that may aid in locating the property and the well
- 4) north arrow

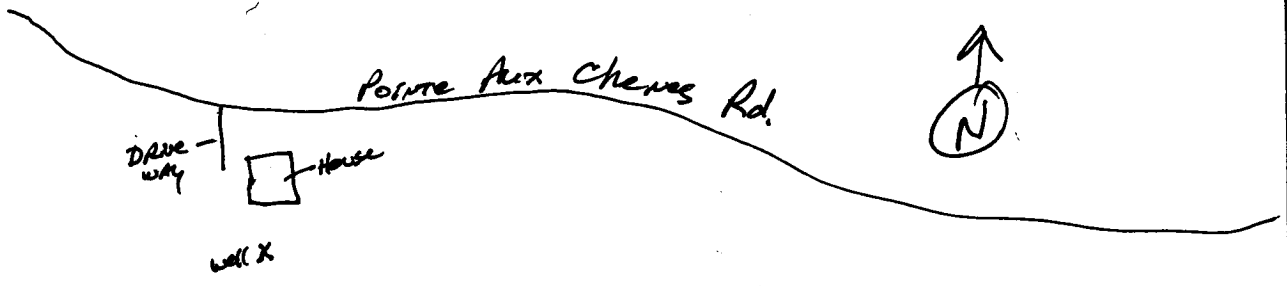

Landowner Name: John Mawar

I HEREBY CERTIFY that the well/borehole was drilled, constructed, and completed in accordance with all applicable requirements of the Mississippi Department of Environmental Quality and the Mississippi Department of Health regulations, if applicable, and state laws.

Jack Riddell 0-472 7/15/16

Jack Riddell JUL 20 2016  
Signature of Licensee

Print Name of Responsible Licensee and License No.

Date

# STATE WELL REPORT

## Part 2

**Pump Installer's Completion Report**  
 Mississippi Department of Environmental Quality  
 Office of Land and Water Resources  
 P.O. Box 2309  
 Jackson, MS 39225-2309  
 (601)961-5210  
 (601) 360-0535 (fax)

County: JACKSON  
 Permit #: \_\_\_\_\_  
 Driller: Coast Water Wells Svc.  
 Date completed: 7-13-16  
Copy information from block on Part 1

**For Office Use Only:**

Well #: N1118  
 Aquifer: \_\_\_\_\_

*This part of the report must be completed by a licensed water well contractor or a licensed pump installer. A copy of Part 1 of the report must be attached and both parts filed with the Department at the above address within 30 days of well completion.*

<p style="text-align: center;"><b>Well Owner Information</b></p> <p>Owner Name: <u>John Marar</u>                  Mailing Address: <u>11017 Pointe Aux Chenes RD</u>  <u>Ocean Springs, MS 39564</u>                  City State Zip Code                  Telephone No. <u>(228) 875-9083</u></p>	<p style="text-align: center;"><b>Well Location</b></p> <p>Latitude: <u>30° 22' 12.72"</u> Longitude: <u>088° 46' 43.08"</u>                  Method of Lat/Long (check one): Conventional Survey _____                  USGS quad _____, Hand-held GPS <input checked="" type="checkbox"/>, Survey-grade GPS _____  <u>SW 1/4 SW 1/4, Sec 3 T. 8s R. 8w</u>  <u>2</u> Miles <u>SE</u> of <u>Ocean Springs</u>                  (Distance) (Direction) (Nearest Town)</p>
---	---

**Pump Type (circle one)**

Submersible  Turbine  Air Lift  Centrifugal  Flowing Well  Jet  Piston  Rotary  Other (describe): \_\_\_\_\_

Date Pump Installed: 7-14-16 Rated Pump Capacity: 19 Gallons Per Minute

Is This Pump (circle one):  New  Repaired  Replacement

**Power Type (circle one)**

Electric  Diesel  Gasoline  Natural Gas  Tractor PTO  Windmill  Other (describe): \_\_\_\_\_

Horse Power Rating of Motor: 1 1/2 HP Setting Depth: 120 FT DP feet Number of Stages: 9

**Pump Test Data for Non Flowing Well**

Date Well Tested: 7-14-16 Duration of Pump Test (minimum 4 hours): 5 hours

Static Water Level (A): 55 Feet Below Land Surface Pumping Water Level (B): N/A Feet Below Land Surface

Drawdown [(B) - (A)]: N/A Feet Below Land Surface Test Pumping Rate: 21.5 Gallons Per Minute

Method of measurement (circle one): Steel tape  Electric tape   Air line  Other (describe): \_\_\_\_\_

**Pump Test Data for Flowing Well**

Measured shut in head: \_\_\_\_\_ feet. N/A

Well yielded \_\_\_\_\_ GPM with a drawdown of \_\_\_\_\_ feet after \_\_\_\_\_ hours of pumping

**Meter Installation**

Meter Manufacturer: \_\_\_\_\_ Meter Serial Number: \_\_\_\_\_

Meter Model Number/Name: \_\_\_\_\_ Type of Meter: \_\_\_\_\_

Totalizer Register Unit and Multiplier Factor (AF x .001, gal x 1000, etc): \_\_\_\_\_

Installation Date: \_\_\_\_\_ Meter installed by: \_\_\_\_\_

Is This Meter (circle one):  New  Repaired  Replacement

*Important: By submitting the above information you are certifying that this meter was installed to manufacturer standards. For agricultural wells, a list of approved meters is on the MDEQ website.*

I HEREBY CERTIFY that the above statements are true to the best of my knowledge.

Jack Riddell 0-472 7/15/16 [Signature]  
 Print Name of Pump Installer and License No. (if applicable) Date Signature of Pump Installer

Form: OLWR-SWR-1B (4/11)  
 JUL 20 2016

By OLWR