

State Well Report

Part 1

Mississippi Department of Environmental Quality
Office of Land and Water Resources
P.O. Box 10631
Jackson, MS 39289-0631
(601) 961-5210
(601) 354-6938 (fax)

County: Jackson
 Permit #: _____
 Driller: Coast Water Well Serv.
 Date drilling completed: 11-16-10

For Office Use Only:

Aquifer: N 1068
 Well #: _____
 L. S. Elevation: _____
 E-log #: _____

State Law requires that this report be prepared by the driller in detail and filed with the Department within 30 days of completion of drilling of the well.

Well Owner Information	Well Location
Owner Name: <u>Stan Ellis</u>	Latitude: <u>30.22.46.71</u> Longitude: <u>088.45.16.50</u>
Mailing Address: <u>1300 Bailey Lane</u>	Method of Lat/Long (circle one): Conventional Survey, ⁴⁷ ¹⁶
<u>Ocean Springs, MS 39565</u> City State Zip Code	USGS quad, <u>Hand-held GPS</u> , Survey-grade GPS
Telephone No. <u>(228) 326-8255</u>	<u>SW</u> 1/4 <u>NE</u> 1/4 Sec <u>2</u> Twn <u>T8S</u> Rng <u>R8W</u>
	Distance Direction Nearest Town <u>2</u> Miles <u>SE</u> of <u>Ocean Springs</u>

Well Data

Purpose of Well (circle one) Home Industrial Public Supply Irrigation Fish Culture Other: _____

Date well drilling started: 11-16-10 Date well drilling completed: 11-16-10

If flowing, method of flow regulation: Valve N/A Other (describe) _____

Static Water Level: 30 feet above or below (circle one) land surface Date measured: 11-16-10

Method of Measurement (circle one) steel tape electric tape air line other: _____

Hole depth: 177 FT. Well depth: 177 FT. Well grouted to a depth of 10 feet

Type of grout (circle one): Cement Bentonite Mix

Casing length: 167 feet Casing diameter: 2 inches Type of casing: PVC

Screen length: 10 feet Screen diameter: 2 inches Type of screen: PVC

Screen slot size: .004 inches Setting depth: From 167 feet to 177 feet

Type of completion (circle all applicable): Gravel packed Underreamed Telescoped Open hole Natural Development

Other (describe): _____

Top of lap pipe or reduction in casing: N/A feet. If telescoped or more than one screen, describe on back of page

Logs run (circle all applicable) No log run Electric Gamma Ray Density Sonic Neutron Other: _____

Name of organization running log(s): N/A

I certify that the well was drilled, constructed, and completed in accordance with all applicable requirements of the Mississippi Department of Environmental Quality and/or the Mississippi Department of Health regulations and state laws.

Jack Ridgdell 0-472
 Print Name of Water Well Contractor and License No.

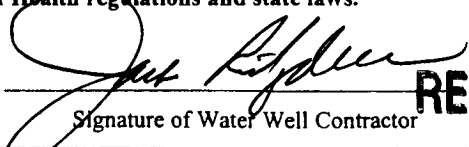

 Signature of Water Well Contractor

RECEIVED
 NOV 24 2010
 BY: OLWR

N1068

If well telescopes please sketch below and show depths.

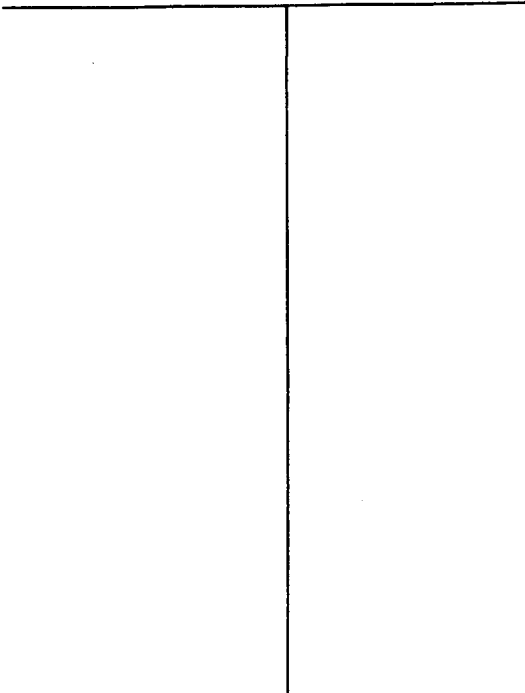
Ground Level



Description of Formations Encountered	From	To
Top Soil	0	1
orange clay	1	14
White Coarse Sand	14	30
Blue clay	30	65
Gray medium Sand	65	80
Blue clay	80	164
Gray medium Sand	164	177

If more than one screen, show location of each on sketch

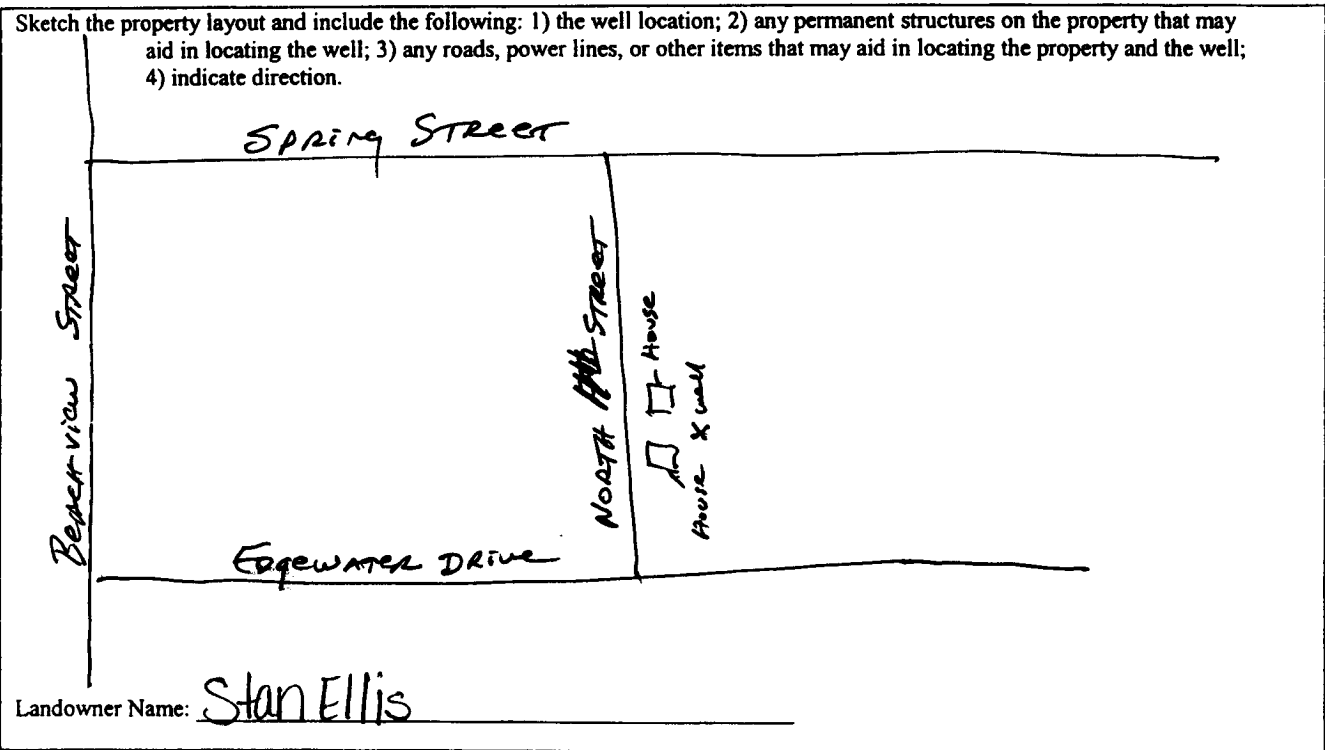

Jack Ridgwell
 Signature of Water Well Contractor

RECEIVED
 NOV 24 2010
 BY: OLWR

STATE WELL REPORT

Part 2

Pump Installer's Completion Report
 Mississippi Department of Environmental Quality
 Office of Land and Water Resources
 P.O. Box 10631
 Jackson, MS 39289-0631
 (601) 961-5210
 (601) 354-6938 (fax)

For Office Use Only:

Aquifer: N 1068
 Well #: _____
 Elevation: _____

County: Jackson
 Permit #: _____
 Driller: Coastwater Well Serv.
 Date completed: 11-16-10

This report should be prepared by the pump installer in detail and filed with the Department within 30 days of the installation of pump.

Well Owner Information	Well Location
Owner Name: <u>Stan Ellis</u>	Latitude: <u>30° 22' 46.74"</u> Longitude: <u>088° 45' 16.50"</u>
Mailing Address: <u>1300 Bailey Lane</u>	Method of Lat/Long (circle one): Conventional Survey, USGS quad, <u>Hand-held GPS</u> , Survey-grade GPS
<u>Ocean Springs, MS 39565</u> City State Zip Code	<u>SW</u> ¼ <u>NE</u> ¼ Sec <u>2</u> Twn <u>T8S</u> Rng <u>R8W</u>
Telephone No. <u>228 326-8255</u>	Distance Direction Nearest Town <u>2</u> Miles <u>SE</u> of <u>Ocean Springs</u>

Pump Type Circle one	Power Type Circle one
Air Lift <input checked="" type="radio"/> <u>Jet</u> <input type="radio"/> Submersible	Diesel Engine <input type="radio"/> Gasoline Engine <input type="radio"/> Natural Gas <input type="radio"/>
Bucket <input type="radio"/> Piston <input type="radio"/> Turbine <input type="radio"/>	<input checked="" type="radio"/> <u>Electric Motor</u> <input type="radio"/> Hand <input type="radio"/> Tractor PTO <input type="radio"/>
Centrifugal <input type="radio"/> Rotary <input type="radio"/> Flowing Well <input type="radio"/>	Windmill <input type="radio"/> Other (specify): _____
Other (specify): _____	Horse Power Rating of Motor: <u>2 HP</u>
Date Pump Installed: <u>3-24-11</u>	Setting Depth: <u>60 FT. Drop Pipe</u> feet
Rated Pump Capacity: <u>13</u> Gallons Per Minute	Number of Stages: <u>3</u>

Pump Test Data	Method of Measuring Water Level Circle one
Date Well Tested: <u>3-24-11</u>	<input checked="" type="radio"/> <u>Air Line</u> <input type="radio"/> Electric Measuring Line <input type="radio"/> Steel Tape
Static Water Level (A): <u>30</u> Feet Below Land Surface	Other (specify): _____
Pumping Water Level (B): <u>N/A</u> Feet Below Land Surface	For flowing well, measured shut in head: <u>N/A</u> feet
Drawdown [(B) - (A)]: <u>N/A</u> Feet Below Land Surface	Well yielded <u>24</u> GPM with a drawdown of
Test Pumping Rate: <u>13</u> Gallons Per Minute	<u>N/A</u> feet after <u>N/A</u> hours of pumping
Duration of Pump Test (minimum 4 hours): <u>4</u> hours	

I HEREBY CERTIFY that the above statements are true to the best of my knowledge

Jack Ridgell 0-472
 Print Name of Pump Installer and License No. (if applicable)

Jack Ridgell
 Signature of Pump Installer

RECEIVED
 APR 13 2011
 BY: OLIVE