

# State Well Report

## Part 1

Mississippi Department of Environmental Quality  
 Office of Land and Water Resources  
 P.O. Box 10631  
 Jackson, MS 39289-0631  
 (601) 961-5210  
 (601) 354-6938 (fax)

### For Office Use Only:

Aquifer: N 1061  
 Well #: \_\_\_\_\_  
 L. S. Elevation: \_\_\_\_\_  
 E-log #: \_\_\_\_\_

County: Jackson  
 Permit #: \_\_\_\_\_  
 Driller: Coast Water Wells SRV.  
 Date drilling completed: 10/2/09

State Law requires that this report be prepared by the driller in detail and filed with the Department within 30 days of completion of drilling of the well.

Well Owner Information	Well Location
Owner Name: <u>Candy Holm</u>	Latitude: <u>30° 26' 58"</u> Longitude: <u>088° 47' 27"</u>
Mailing Address: <u>11303 Wilford Oliver Rd.</u>	Method of Lat/Long (circle one): Conventional Survey, <u>58</u>
<u>Oceansprings, MS 39564</u>	USGS quad: <u>(Hand-held GPS)</u> Survey-grade GPS
City State Zip Code	<u>SW 1/4 SW 1/4 Sec 91 T7S R8W</u>
Telephone No. <u>228 324-0317</u>	Distance <u>2</u> Miles Direction <u>NORTH</u> of Nearest Town <u>Oceansprings</u>

**Well Data**

Purpose of Well (circle one) Home Industrial Public Supply Irrigation Fish Culture Other: \_\_\_\_\_

Date well drilling started: 10/2/09 Date well drilling completed: 10/2/09

If flowing, method of flow regulation: Valve N/A Other (describe) \_\_\_\_\_

Static Water Level: 15 feet above or below (circle one) land surface Date measured: 10/2/09

Method of Measurement (circle one) steel tape electric tape air line other: \_\_\_\_\_

Hole depth: 170 FT. Well depth: 170 FT. Well grouted to a depth of 10 feet

Type of grout (circle one): Cement Bentonite Mix

Casing length: 160 feet Casing diameter: 2 inches Type of casing: PVC

Screen length: 10 feet Screen diameter: 2 inches Type of screen: PVC

Screen slot size: .006 inches Setting depth: From 160 feet to 170 feet

Type of completion (circle all applicable): Gravel packed Underreamed Telescoped Open hole Natural Development

Other (describe): \_\_\_\_\_

Top of lap pipe or reduction in casing: N/A feet. If telescoped or more than one screen, describe on back of page

Logs run (circle all applicable): No log run Electric Gamma Ray Density Sonic Neutron Other: \_\_\_\_\_

Name of organization running log(s): N/A

I certify that the well was drilled, constructed, and completed in accordance with all applicable requirements of the Mississippi Department of Environmental Quality and/or the Mississippi Department of Health regulations and state laws.

Jack Ridgdell 0-472

Print Name of Water Well Contractor and License No.

Jack Ridgdell

Signature of Water Well Contractor

RECEIVED

OCT 09 2009

BY: OLWR

N 1061

If well telescopes please sketch below and show depths.

Ground Level

Description of Formations Encountered	From	To
Top Soil	0	2
Orange clay	2	20
BRN coarse Sand	20	45
Blue clay	45	148
Gray medium Sand	148	170

If more than one screen, show location of each on sketch

Sketch the property layout and include the following: 1) the well location; 2) any permanent structures on the property that may aid in locating the well; 3) any roads, power lines, or other items that may aid in locating the property and the well; 4) indicate direction.

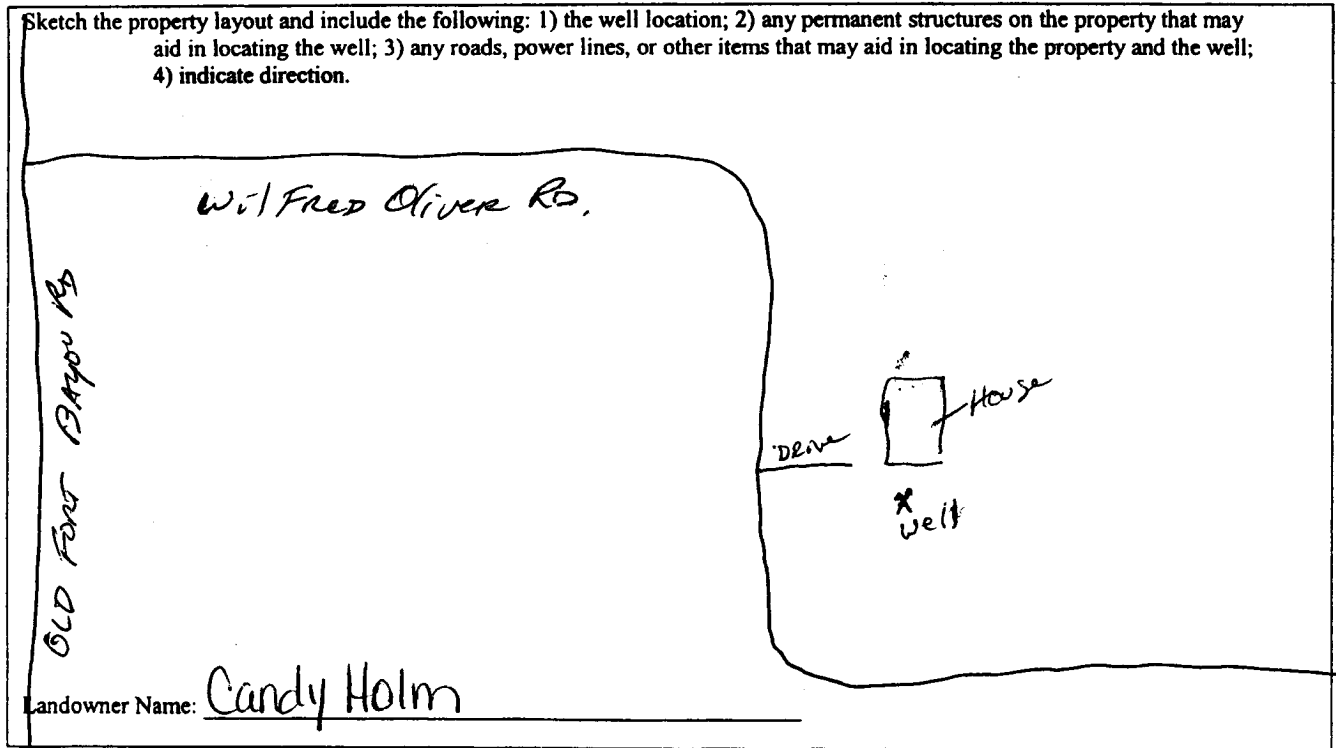

Landowner Name: Candy Holm

*Jack R. Miller*  
Signature of Water Well Contractor

RECEIVED  
OCT 09 2009  
BY: OLWR

# STATE WELL REPORT

## Part 2

**Pump Installer's Completion Report**  
 Mississippi Department of Environmental Quality  
 Office of Land and Water Resources  
 P.O. Box 10631  
 Jackson, MS 39289-0631  
 (601) 961-5210  
 (601) 354-6938 (fax)

For Office Use Only:

Aquifer: N 1061  
 Well #: \_\_\_\_\_  
 Elevation: \_\_\_\_\_

County: Jackson  
 Permit #: \_\_\_\_\_  
 Driller: Coast Water Wells Serv.  
 Date completed: 10/2/09

**This report should be prepared by the pump installer in detail and filed with the Department within 30 days of the installation of pump.**

Well Owner Information	Well Location
Owner Name: <u>Candy Holm</u>	Latitude: <u>30° 26' 58"</u> Longitude: <u>088° 47' 970"</u>
Mailing Address: <u>11303 Wilford Oliver Rd.</u>	Method of Lat/Long (circle one): Conventional Survey, USGS quad, <u>Hand-held GPS</u> , Survey-grade GPS
<u>Ocean Springs, MS 39564</u> City State Zip Code	<u>SW 1/4 SW 1/4 Sec 9 Twn 77S Rng R 8W</u>
Telephone No. <u>208 324-0317</u>	Distance Direction Nearest Town <u>2 Miles NORTH of Ocean Springs</u>

Pump Type Circle one	Power Type Circle one
Air Lift <input type="radio"/> <u>Jet</u> <input type="radio"/> Submersible	Diesel Engine <input type="radio"/> Gasoline Engine <input type="radio"/> Natural Gas
Bucket <input type="radio"/> Piston <input type="radio"/> Turbine	<u>Electric Motor</u> <input type="radio"/> Hand <input type="radio"/> Tractor PTO
Centrifugal <input type="radio"/> Rotary <input type="radio"/> Flowing Well	Windmill <input type="radio"/> Other (specify): _____
Other (specify): _____	Horse Power Rating of Motor: <u>1HP</u>
Date Pump Installed: <u>10/5/09</u>	Setting Depth: <u>40FT. Droppipe</u> feet
Rated Pump Capacity: <u>9.5</u> Gallons Per Minute	Number of Stages: <u>2</u>

Pump Test Data	Method of Measuring Water Level Circle one
Date Well Tested: <u>10/5/09</u>	<u>Air Line</u> <input type="radio"/> Electric Measuring Line <input type="radio"/> Steel Tape <input type="radio"/>
Static Water Level (A): <u>15</u> Feet Below Land Surface	Other (specify): _____
Pumping Water Level (B): <u>N/A</u> Feet Below Land Surface	For flowing well, measured shut in head: <u>N/A</u> feet
Drawdown [(B) - (A)]: <u>N/A</u> Feet Below Land Surface	Well yielded <u>23</u> GPM with a drawdown of
Test Pumping Rate: <u>9.5</u> Gallons Per Minute	<u>N/A</u> feet after <u>N/A</u> hours of pumping
Duration of Pump Test (minimum 4 hours): <u>4</u> hours	

I HEREBY CERTIFY that the above statements are true to the best of my knowledge.

Jack Ridgdell 0-472 Jack Ridgdell  
 Print Name of Pump Installer and License No. (if applicable) Signature of Pump Installer

**RECEIVED**  
 OCT 09 2009  
 BY: OLWR