

# STATE WELL REPORT

## Part 1

### Driller's Log

Mississippi Department of Environmental Quality  
Office of Land and Water Resources  
P.O. Box 2309  
Jackson, MS 39225-2309  
(601)961-5210  
(601)360-0535 (fax)

#### For Office Use Only:

Well #: 6217  
Aquifer: \_\_\_\_\_  
E-Log #: \_\_\_\_\_

County: Jackson  
Permit #: \_\_\_\_\_  
Driller: Coastwater Well Service  
Date drilling completed: 9-10-19

*State Law requires that this report be prepared by the license holder responsible for the work and filed with the Department at the above address within 30 days of completion of drilling of the well or borehole.*

Well Owner Information <small>(Landowner if borehole is not for a water well)</small>	Well or Borehole Location
Owner Name: <u>David + Karen Affolter</u>	Latitude: <u>30° 32' 57.42"</u> Longitude: <u>088° 32' 6.66"</u>
Mailing Address: <u>14225 Wolfridge Road</u>	Method of Lat/Long (check one): Conventional Survey _____, USGS quad _____, Hand-held GPS <input checked="" type="checkbox"/> , Survey-grade GPS _____
<u>Miss Point, MS 391562</u>	<u>NW 1/4 SE 1/4, Sec 1 T 6S R 6W</u>
City State Zip Code	<u>5</u> Miles <u>SW</u> of <u>Big Point</u>
Telephone No. <u>228 990-3400</u>	(Distance) (Direction) (Nearest Town)

Well / Borehole Data
Date drilling started: <u>9-10-19</u> Date drilling completed: <u>9-10-19</u> Hole depth: <u>205 FT</u> Hole diameter: <u>2"</u>
Location of the source of any surface water used for drilling: <u>N/A</u>
Method of dosing and volume of Chlorine used in drilling and development: <u>1 gal Per 1000 drilling 2 gal in well</u>
Logs run (circle all applicable): <input checked="" type="checkbox"/> No log run <input type="checkbox"/> Electric <input type="checkbox"/> Gamma Ray <input type="checkbox"/> Density <input type="checkbox"/> Sonic <input type="checkbox"/> Neutron <input type="checkbox"/> Other: _____
Name of organization running log(s): _____
Purpose of borehole (circle one): <input checked="" type="checkbox"/> Water Well <input type="checkbox"/> Geotechnical/Geological Investigation <input type="checkbox"/> Ground Source Heat Pump <input type="checkbox"/> Seismic Survey <input type="checkbox"/> Other (describe) _____
<i>If drilling is not related to water well construction, skip the remainder of this block</i>
Purpose of Well (circle all applicable): <input checked="" type="checkbox"/> Home <input type="checkbox"/> Industrial <input type="checkbox"/> Public Supply <input type="checkbox"/> Irrigation <input type="checkbox"/> Fish Culture
Other (describe): _____
If a flowing well, method of flow regulation: Valve _____ Other (describe) _____
Static Water Level: <u>30</u> feet [above or below] land surface Date measured: <u>9-10-19</u> <small>(circle one)</small>
Method of measurement (circle one): Steel tape <input type="checkbox"/> Electric tape <input type="checkbox"/> <input checked="" type="checkbox"/> Air line <input type="checkbox"/> Other (describe): _____
Well depth: <u>205 FT</u> Well grouted to a depth of: <u>10</u> feet Type of grout (circle one): Neat Cement <input type="checkbox"/> <input checked="" type="checkbox"/> Bentonite <input type="checkbox"/> Mix
Casing length: <u>195</u> feet Casing diameter: <u>2</u> inches Type of casing: <u>PVC</u>
Screen length: <u>10</u> feet Screen diameter: <u>2</u> inches Type of screen: <u>PVC</u>
Screen slot size: <u>.004</u> inches Setting depth: From <u>195</u> feet to <u>205</u> feet
Type of completion (circle all applicable): Gravel packed <input type="checkbox"/> Underreamed <input type="checkbox"/> Open hole <input type="checkbox"/> <input checked="" type="checkbox"/> Natural Development
Other (describe): _____
Top of lap pipe or reduction in casing: <u>N/A</u> feet
<i>If telescoped or more than one screen, describe on next page</i>



County: Jackson  
 Permit #: \_\_\_\_\_

For Office Use Only:  
 Well #: L217

**The sketch below only required for water wells**  
**If well telescopes, show depths on sketch.**

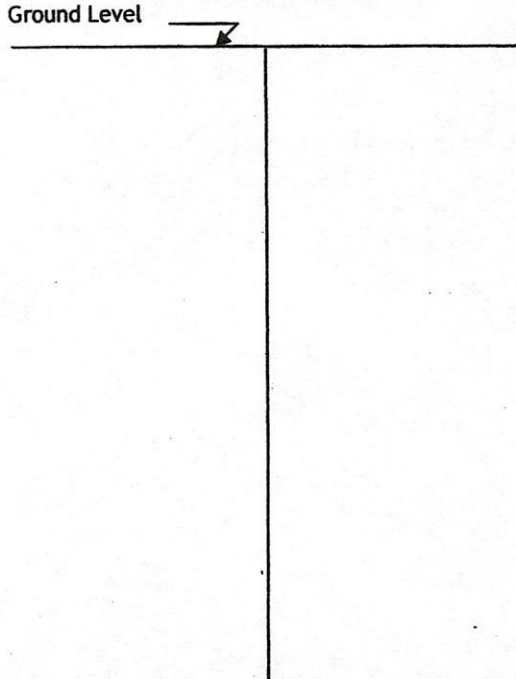

**Description of formations encountered must be provided for all wells and boreholes, unless specifically exempted by regulations**

Description of Formations Encountered	From (depth)	To (depth)
Top Soil	Ground level	2
Orange Clay	2	15
Orange Coarse Sand	15	30
Orange Clay	30	50
Orange Coarse Sand	50	85
Blue Clay	85	170
Gray medium to Coarse Sand	170	205

If more than one screen, show location of each on sketch

Sketch the property layout and include the following:

- 1) the well location
- 2) any permanent structures on the property that may aid in locating the well
- 3) any roads, power lines, or other items that may aid in locating the property and the well
- 4) north arrow

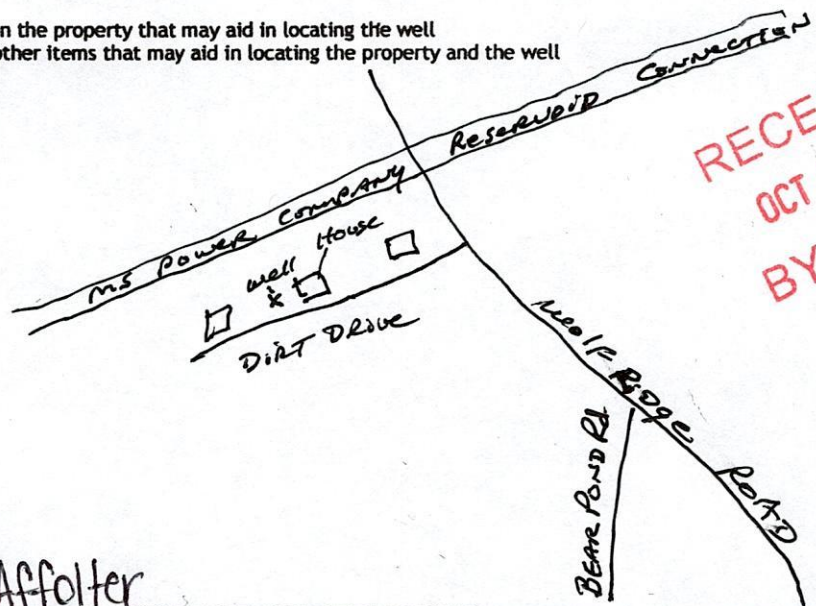

RECEIVED  
 OCT 11 2019  
 BY OLWR

Landowner Name: David Affolter

I HEREBY CERTIFY that the well/borehole was drilled, constructed, and completed in accordance with all applicable requirements of the Mississippi Department of Environmental Quality and the Mississippi Department of Health regulations, if applicable, and state laws.

Jack Ridgell 0-472      9/17/19  
 Print Name of Responsible Licensee and License No.      Date

[Signature]  
 Signature of Licensee



# STATE WELL REPORT

## Part 2

**Pump Installer's Completion Report**  
 Mississippi Department of Environmental Quality  
 Office of Land and Water Resources  
 P.O. Box 2309  
 Jackson, MS 39225-2309  
 (601)961-5210  
 (601) 360-0535 (fax)

County: Jackson  
 Permit #: \_\_\_\_\_  
 Driller: Coastwater Wells v.c.  
 Date completed: 9-10-19  
*Copy information from block on Part 1*

**For Office Use Only:**

Well #: L217  
 Aquifer: \_\_\_\_\_

*This part of the report must be completed by a licensed water well contractor or a licensed pump installer. A copy of Part 1 of the report must be attached and both parts filed with the Department at the above address within 30 days of well completion.*

Well Owner Information	Well Location
Owner Name: <u>David Affolter</u>	Latitude: <u>30° 32' 57.42"</u> Longitude: <u>088° 32' 6.66"</u>
Mailing Address: <u>14225 Wolfridge Road</u>	Method of Lat/Long (check one): Conventional Survey _____, USGS quad _____, Hand-held GPS <input checked="" type="checkbox"/> , Survey-grade GPS _____
<u>Miss Point, Ms 39562</u>	<u>NW</u> ¼ <u>SE</u> ¼, Sec <u>1</u> T <u>6S</u> R <u>6W</u>
City _____ State _____ Zip Code _____	<u>5</u> Miles <u>SW</u> of <u>Big Point</u>
Telephone No. <u>(228) 990-3400</u>	(Distance) _____ (Direction) _____ (Nearest Town)

**Pump Type (circle one)**

Submersible Turbine Air Lift Centrifugal Flowing Well  Jet Piston Rotary Other (describe): \_\_\_\_\_

Date Pump Installed: 9-11-19 Rated Pump Capacity: 9.5 Gallons Per Minute

Is This Pump (circle one):  New Repaired Replacement

**Power Type (circle one)**

Electric  Diesel Gasoline Natural Gas Tractor PTO Windmill Other (describe): \_\_\_\_\_

Horse Power Rating of Motor: 1HP Setting Depth: 40 FT DP feet Number of Stages: 2

**Pump Test Data for Non Flowing Well**

Date Well Tested: 9-11-19 Duration of Pump Test (minimum 4 hours): 5 hours

Static Water Level (A): 30 Feet Below Land Surface Pumping Water Level (B): N/A Feet Below Land Surface

Drawdown [(B) - (A)]: N/A Feet Below Land Surface Test Pumping Rate: 9.5 Gallons Per Minute

Method of measurement (circle one): Steel tape Electric tape  Air line Other (describe): \_\_\_\_\_

**Pump Test Data for Flowing Well**

Measured shut in head: \_\_\_\_\_ feet. N/A

Well yielded \_\_\_\_\_ GPM with a drawdown of \_\_\_\_\_ feet after \_\_\_\_\_ hours of pumping

**Meter Installation**

Meter Manufacturer: \_\_\_\_\_ N/A Meter Serial Number: \_\_\_\_\_

Meter Model Number/Name: \_\_\_\_\_ Type of Meter: \_\_\_\_\_

Totalizer Register Unit and Multiplier Factor (AF x .001, gal x 1000, etc): \_\_\_\_\_

Installation Date: \_\_\_\_\_ Meter installed by: \_\_\_\_\_

Is This Meter (circle one): New Repaired Replacement

*Important: By submitting the above information you are certifying that this meter was installed to manufacturer standards. For agricultural wells, a list of approved meters is on the MDEQ website.*

RECEIVED  
 OCT 11 2019  
 BY OLWR

I HEREBY CERTIFY that the above statements are true to the best of my knowledge.

Jack Ridgell 0-472 9/17/19 \_\_\_\_\_

Print Name of Pump Installer and License No. (if applicable) Date Signature of Pump Installer