

STATE WELL REPORT

Part 2

Pump Installer's Completion Report
 Mississippi Department of Environmental Quality
 Office of Land and Water Resources
 P.O. Box 2309
 Jackson, MS 39225-2309
 (601)961-5210
 (601) 360-0535 (fax)

County: JACKSON
 Permit #: _____
 Driller: Coast Water Well SVC
 Date completed: 3/27/17
Copy information from block on Part 1

For Office Use Only:

Well #: K775
 Aquifer: _____

This part of the report must be completed by a licensed water well contractor or a licensed pump installer. A copy of Part 1 of the report must be attached and both parts filed with the Department at the above address within 30 days of well completion.

<p style="text-align: center;">Well Owner Information</p> <p>Owner Name: <u>Clayton Homes/Beth Durand</u> Mailing Address: <u>11720 Paige Bayou ROAD</u> <u>Vancleave, Ms 39565</u> City State Zip Code Telephone No. <u>601 831-8088</u></p>	<p style="text-align: center;">Well Location</p> <p>Latitude: <u>30°30'49.80"</u> Longitude: <u>088°39'56.82"</u> Method of Lat/Long (check one): Conventional Survey _____, USGS quad _____, Hand-held GPS <input checked="" type="checkbox"/>, Survey-grade GPS _____ <u>SE NE 1/4 SE NE 1/4, Sec 15 T 6 S R 7 W</u> <u>1 1/2</u> Miles <u>SE</u> of <u>Vancleave</u> (Distance) (Direction) (Nearest Town)</p>
--	--

Pump Type (circle one)

Submersible Turbine Air Lift Centrifugal Flowing Well Jet Piston Rotary Other (describe): _____

Date Pump Installed: 4-8-17 Rated Pump Capacity: 9 Gallons Per Minute

Is This Pump (circle one): New Repaired Replacement

Power Type (circle one)

Electric Diesel Gasoline Natural Gas Tractor PTO Windmill Other (describe): _____

Horse Power Rating of Motor: 1HP Setting Depth: 40FT DP feet Number of Stages: 2

Pump Test Data for Non Flowing Well

Date Well Tested: 4-8-17 Duration of Pump Test (minimum 4 hours): 4 hours

Static Water Level (A): 15 Feet Below Land Surface Pumping Water Level (B): N/A Feet Below Land Surface

Drawdown [(B) - (A)]: N/A Feet Below Land Surface Test Pumping Rate: 9 Gallons Per Minute

Method of measurement (circle one): Steel tape Electric tape Air line Other (describe): _____

Pump Test Data for Flowing Well

Measured shut in head: _____ feet.

Well yielded _____ GPM with a drawdown of N/A feet after _____ hours of pumping

Meter Installation

Meter Manufacturer: _____ Meter Serial Number: RECEIVED

Meter Model Number/Name: _____ Type of Meter: APR 20 2017

Totalizer Register Unit and Multiplier Factor (AF x .001, gal x 1000, etc): _____

Installation Date: _____ Meter installed by: BY OLWR

Is This Meter (circle one): New Repaired Replacement

Important: By submitting the above information you are certifying that this meter was installed to manufacturer standards. For agricultural wells, a list of approved meters is on the MDEQ website.

I HEREBY CERTIFY that the above statements are true to the best of my knowledge.

Jack Ridadell 0-472 4/10/17 Jude Keffner
 Print Name of Pump Installer and License No. (if applicable) Date Signature of Pump Installer

STATE WELL REPORT

Part 1

Driller's Log

Mississippi Department of Environmental Quality
 Office of Land and Water Resources
 P.O. Box 2309
 Jackson, MS 39225-2309
 (601)961-5210
 (601)360-0535 (fax)

For Office Use Only:

Well #: K 775
 Aquifer: _____
 E-Log #: _____

County: JACKSON
 Permit #: _____
 Driller: East Water Well SVC
 Date drilling completed: 3-27-17

State Law requires that this report be prepared by the license holder responsible for the work and filed with the Department at the above address within 30 days of completion of drilling of the well or borehole.

<p>Well Owner Information (Landowner if borehole is not for a water well) Owner Name: <u>Clayton Homes/Beth Durand</u> Mailing Address: <u>11720 Paige Bayou Road</u> <u>Vancleave, MS 39565</u> City State Zip Code Telephone No. <u>(628) 831-8088</u></p>	<p>Well or Borehole Location Latitude: <u>30°30'49.80"</u> Longitude: <u>88°39'56.82"</u> Method of Lat/Long (check one): Conventional Survey _____ USGS quad _____, Hand-held GPS <input checked="" type="checkbox"/>, Survey-grade GPS <input checked="" type="checkbox"/> <u>SE</u> $\frac{1}{4}$ <u>SE</u> $\frac{1}{4}$, Sec <u>15</u> T <u>22</u> S R <u>7</u> W <u>1 1/2</u> Miles <u>SE</u> of <u>Vancleave</u> (Distance) (Direction) (Nearest Town)</p>
---	--

Well / Borehole Data

Date drilling started: 3/27/17 Date drilling completed: 3/27/17 Hole depth: 123 FT Hole diameter: 2"

Location of the source of any surface water used for drilling: N/A

Method of dosing and volume of Chlorine used in drilling and development: 1 gal Per 1000 Drilling 2 gal in Well

Logs run (circle all applicable): No log run Electric Gamma Ray Density Sonic Neutron Other: _____

Name of organization running log(s): _____

Purpose of borehole (circle one): Water Well Geotechnical/Geological Investigation Ground Source Heat Pump
 Seismic Survey Other (describe) _____

If drilling is not related to water well construction, skip the remainder of this block

Purpose of Well (circle all applicable): Home Industrial Public Supply Irrigation Fish Culture

Other (describe): _____

If a flowing well, method of flow regulation: Valve _____ Other (describe) _____

Static Water Level: 15 feet [above or below] and surface Date measured: 3/27/17

Method of measurement (circle one): Steel tape Electric tape Air line Other (describe) _____

Well depth: 123 FT Well grouted to a depth of: 10 feet Type of grout (circle one): Neat Cement Bentonite Mix

Casing length: 113 feet Casing diameter: 2 inches Type of casing: PVC

Screen length: 10 feet Screen diameter: 2 inches Type of screen: PVC

Screen slot size: .006 inches Setting depth: From 113 feet to 123 feet

Type of completion (circle all applicable): Gravel packed Underreamed Open hole Natural Development

Other (describe): _____

Top of lap pipe or reduction in casing: N/A feet

If telescoped or more than one screen, describe on next page

RECEIVED
 APR 10 2017

County: JACKSON
Permit #: _____

For Office Use Only:
Well #: K775

The sketch below only required for water wells

If well telescopes, show depths on sketch.

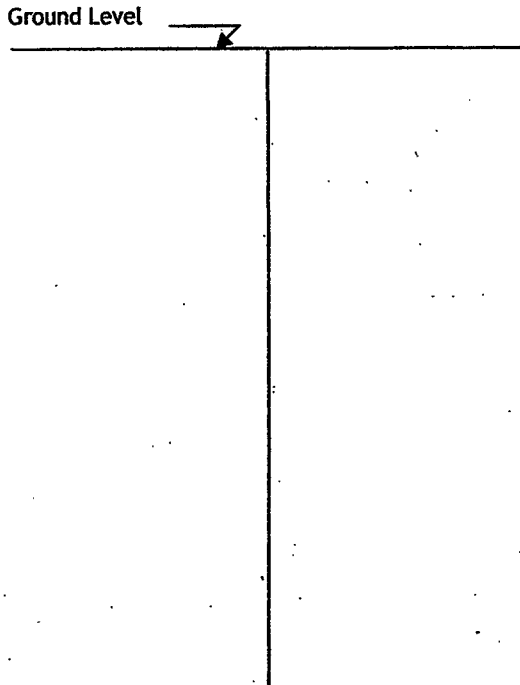

Description of formations encountered must be provided for all wells and boreholes, unless specifically exempted by regulations

Description of Formations Encountered	From (depth)	To (depth)
Top Soil	Ground level	2
Orange Clay	2	15
Brown Coarse Sand	15	40
Orange and Blue Clay	40	105
Brown Coarse Sand	105	123

If more than one screen, show location of each on sketch

- Sketch the property layout and include the following:
- 1) the well location
 - 2) any permanent structures on the property that may aid in locating the well
 - 3) any roads, power lines, or other items that may aid in locating the property and the well
 - 4) north arrow

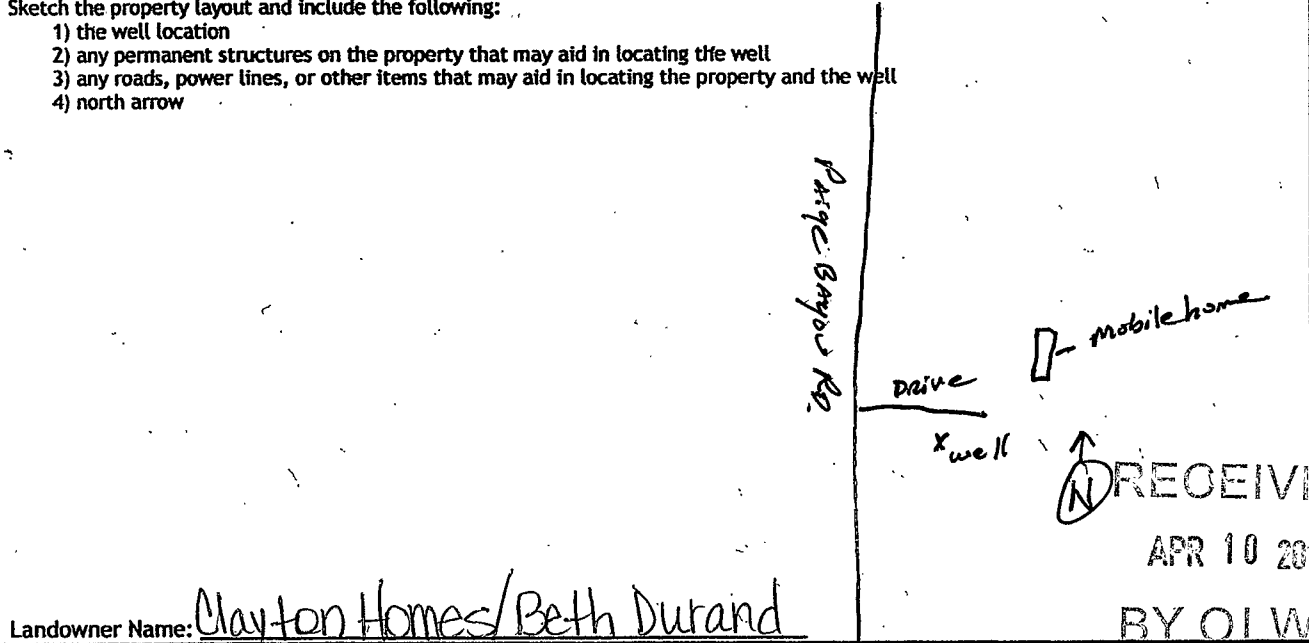

RECEIVED
APR 10 2017
BY OLWR

I HEREBY CERTIFY that the well/borehole was drilled, constructed, and completed in accordance with all applicable requirements of the Mississippi Department of Environmental Quality and the Mississippi Department of Health regulations, if applicable, and state laws.

Jack Ridgell Q-472 3/28/17
Print Name of Responsible Licensee and License No. Date Signature of Licensee