

# State Well Report

## Part 1

Mississippi Department of Environmental Quality  
Office of Land and Water Resources  
P.O. Box 10631  
Jackson, MS 39289-0631  
(601)961-5210  
(601)354-6938 (fax)

County: Jackson  
 Permit #: \_\_\_\_\_  
 Driller: Coastwater Wells Serv.  
 Date drilling completed: 8-9-07

**For Office Use Only:**

Aquifer: \_\_\_\_\_  
 Well #: K-576  
 L. S. Elevation: \_\_\_\_\_  
 E-log #: \_\_\_\_\_

**State Law requires that this report be prepared by the driller in detail and filed with the Department within 30 days of completion of drilling of the well.**

Well Owner Information	Well Location
Owner Name: <u>Robert Henning</u>	Latitude: <u>30° 31' 40"</u> Longitude: <u>088° 40' 864"</u>
Mailing Address: <u>4400 Barge Landing Rd</u>	Method of Lat/Long (circle one): <u>27</u> Conventional Survey, <u>52</u>
<u>Vanceleave, Ms 39565</u>	USGS quad: <u>Hand-held GPS</u> Survey-grade GPS
City: _____ State: _____ Zip Code: _____	<u>SW 1/4 NW 1/4 Sec 15 Twn T6S Rng R7W</u>
Telephone No. <u>228 355-1049</u>	Distance <u>1/2</u> Miles _____ Direction _____ of <u>VANCELEAVE</u> Nearest Town

**Well Data**

Purpose of Well (circle one) Home Industrial Public Supply Irrigation Fish Culture Other: \_\_\_\_\_

Date well drilling started: 8-8-07 Date well drilling completed: 8-9-07

If flowing, method of flow regulation: Valve N/A Other (describe) \_\_\_\_\_

Static Water Level: 30 feet above or below (circle one) land surface Date measured: 8-9-07

Method of Measurement (circle one) steel tape electric tape air line other: \_\_\_\_\_

Hole depth: 270 FT Well depth: 270 FT Well grouted to a depth of 10 feet

Type of grout (circle one): Cement Bentonite Mix

Casing length: 260 feet Casing diameter: 2 inches Type of casing: PVC

Screen length: 10 feet Screen diameter: 2 inches Type of screen: PVC

Screen slot size: .006 inches Setting depth: From 260 feet to 270 feet

Type of completion (circle all applicable): Gravel packed Underreamed Telescoped Open hole Natural Development

Other (describe): \_\_\_\_\_

Top of lap pipe or reduction in casing: N/A feet. If telescoped or more than one screen, describe on back of page

Logs run (circle all applicable): No log run Electric Gamma Ray Density Sonic Neutron Other: \_\_\_\_\_

Name of organization running log(s): N/A

I certify that the well was drilled, constructed, and completed in accordance with all applicable requirements of the Mississippi Department of Environmental Quality and/or the Mississippi Department of Health regulations and state laws.

Jack Ridgell 0-472  
 Print Name of Water Well Contractor and License No.

[Signature]  
 Signature of Water Well Contractor

RECEIVED  
 AUG 27 2007  
 BY: OLWR

K-576

If well telescopes please sketch below and show depths.

Ground Level

Description of Formations Encountered	From	To
Topsoil	0	2
Orange Clay	2	10
White Coarse Sand	10	80
Blue Clay	80	235
Gray Medium Sand	235	270

If more than one screen, show location of each on sketch

Sketch the property layout and include the following: 1) the well location; 2) any permanent structures on the property that may aid in locating the well; 3) any roads, power lines, or other items that may aid in locating the property and the well; 4) indicate direction.

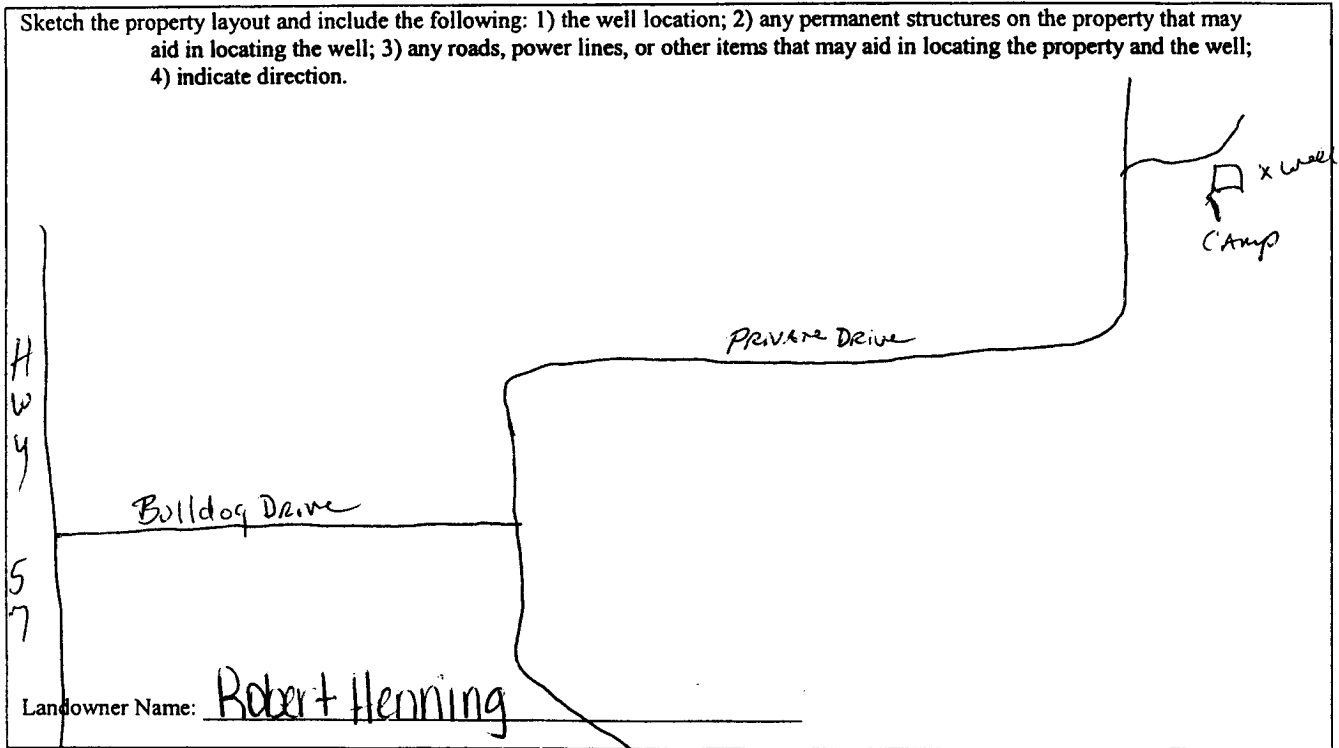

Landowner Name: Robert Henning

Joseph R. Hill  
 Signature of Water Well Contractor

RECEIVED  
 AUG 27 2007  
 BY: OLWR

# STATE WELL REPORT

## Part 2

**Pump Installer's Completion Report**  
 Mississippi Department of Environmental Quality  
 Office of Land and Water Resources  
 P.O. Box 10631  
 Jackson, MS 39289-0631  
 (601)961-5210  
 (601)354-6938 (fax)

For Office Use Only:

Aquifer: \_\_\_\_\_

Well #: K-576

Elevation: \_\_\_\_\_

County: Jackson  
 Permit #: \_\_\_\_\_  
 Driller: Coast Water Well Serv.  
 Date completed: 8-9-07

**This report should be prepared by the pump installer in detail and filed with the Department within 30 days of the installation of pump.**

Well Owner Information	Well Location
Owner Name: <u>Robert Henning</u>	Latitude: <u>30°31'460"</u> Longitude: <u>088°40'864"</u>
Mailing Address: <u>4400 Barge Landing Rd.</u>	Method of Lat/Long (circle one): Conventional Survey,
<u>Vanceleave, MS 39565</u>	USGS quad, <u>Hand-held GPS</u> , Survey-grade GPS
City State Zip Code	<u>SW 1/4 NW 1/4 Sec 15 Twn 76S Rng R7W</u>
Telephone No. <u>228-355-1049</u>	Distance Direction Nearest Town
	<u>1.1</u> Miles _____ of <u>Vanceleave</u>

Pump Type Circle one	Power Type Circle one
Air Lift <input type="radio"/> Jet <input checked="" type="radio"/> Submersible	Diesel Engine Gasoline Engine Natural Gas
Bucket <input type="radio"/> Piston <input type="radio"/> Turbine	<input checked="" type="radio"/> Electric Motor <input type="radio"/> Hand <input type="radio"/> Tractor PTO
Centrifugal <input type="radio"/> Rotary <input type="radio"/> Flowing Well	Windmill Other (specify): _____
Other (specify): _____	Horse Power Rating of Motor: <u>1 HP</u>
Date Pump Installed: <u>8-11-07</u>	Setting Depth: <u>60 FT. DROPPING</u> feet
Rated Pump Capacity: <u>8.5</u> Gallons Per Minute	Number of Stages: <u>2</u>

Pump Test Data	Method of Measuring Water Level Circle one
Date Well Tested: <u>8-11-07</u>	<input checked="" type="radio"/> Air Line <input type="radio"/> Electric Measuring Line <input type="radio"/> Steel Tape
Static Water Level (A): <u>30</u> Feet Below Land Surface	Other (specify): _____
Pumping Water Level (B): <u>N/A</u> Feet Below Land Surface	For flowing well, measured shut in head: <u>N/A</u> feet
Drawdown [(B) - (A)]: <u>N/A</u> Feet Below Land Surface	Well yielded <u>8.5</u> GPM with a drawdown of
Test Pumping Rate: <u>8.5</u> Gallons Per Minute	<u>N/A</u> feet after <u>N/A</u> hours of pumping
Duration of Pump Test (minimum 4 hours): <u>4</u> hours	

I HEREBY CERTIFY that the above statements are true to the best of my knowledge.

Jack Ridgell 0-472  
 Print Name of Pump Installer and License No. (if applicable)

[Signature]  
 Signature of Pump Installer

**RECEIVED**

AUG 27 2007

BY: OLWR