

STATE WELL REPORT

Part 1

Driller's Log

Mississippi Department of Environmental Quality
 Office of Land and Water Resources
 P.O. Box 2309
 Jackson, MS 39225-2309
 (601)961-5210
 (601)360-0535 (fax)

County: Jackson
 Permit #: _____
 Driller: Coast Water Wells Inc
 Date drilling completed: 11-15-16

For Office Use Only:
 Well #: J 636
 Aquifer: _____
 E-Log #: _____

State Law requires that this report be prepared by the license holder responsible for the work and filed with the Department at the above address within 30 days of completion of drilling of the well or borehole.

| Well Owner Information (Landowner if borehole is not for a water well) | Well or Borehole Location |
|---|--|
| Owner Name: <u>Brandon Fisher</u> | Latitude: <u>30°30'27.54"</u> Longitude: <u>088°44'18.30"</u> |
| Mailing Address: <u>Southern Bay Lane</u> | Method of Lat/Long (check one): Conventional Survey _____, USGS quad _____, Hand-held GPS <input checked="" type="checkbox"/> , Survey-grade GPS _____ |
| <u>Vandœuvre, MS 39565</u> | NW <input checked="" type="checkbox"/> NE <input checked="" type="checkbox"/> SW <input checked="" type="checkbox"/> SE <input checked="" type="checkbox"/> 1/4, Sec <u>24</u> T <u>65</u> R <u>8W</u> |
| City State Zip Code | <u>3</u> Miles <u>WSW</u> of <u>Vandœuvre</u> |
| Telephone No. <u>(251) 510-1138</u> | (Distance) (Direction) (Nearest Town) |

Well / Borehole Data

Date drilling started: 11-14-16 Date drilling completed: 11-15-16 Hole depth: 378 FT Hole diameter: 2"

Location of the source of any surface water used for drilling: N/A

Method of dosing and volume of Chlorine used in drilling and development: 1 gal Per 1000 Drilling 2 gal in well

Logs run (circle all applicable): No log run Electric Gamma Ray Density Sonic Neutron Other: _____

Name of organization running log(s): _____

Purpose of borehole (circle one): Water Well Geotechnical/Geological Investigation Ground Source Heat Pump
 Seismic Survey Other (describe) _____

If drilling is not related to water well construction, skip the remainder of this block

Purpose of Well (circle all applicable): Home Industrial Public Supply Irrigation Fish Culture

Other (describe): _____

If a flowing well, method of flow regulation: Valve _____ Other (describe) _____

Static Water Level: 110 feet [above or (below) land surface Date measured: 11-15-16
 (circle one)

Method of measurement (circle one): Steel tape Electric tape Air line Other (describe): _____

Well depth: 378 FT Well grouted to a depth of: 10 feet Type of grout (circle one): Neat Cement Bentonite Mix

Casing length: 363 feet Casing diameter: 2 inches Type of casing: PVC

Screen length: 15 feet Screen diameter: 2 inches Type of screen: PVC

Screen slot size: .006 inches Setting depth: From 363 feet to 378 feet

Type of completion (circle all applicable): Gravel packed Underreamed Open hole Natural Development

Other (describe): _____

Top of lap pipe or reduction in casing: N/A feet

If telescoped or more than one screen, describe on next page

RECEIVED
 Form: OLWR-SWR-1A (4/13)

DEC 02 2016
 BY OLWR

County: Jackson
 Permit #: _____

For Office Use Only:
 Well #: 5636

The sketch below only required for water wells
If well telescopes, show depths on sketch.

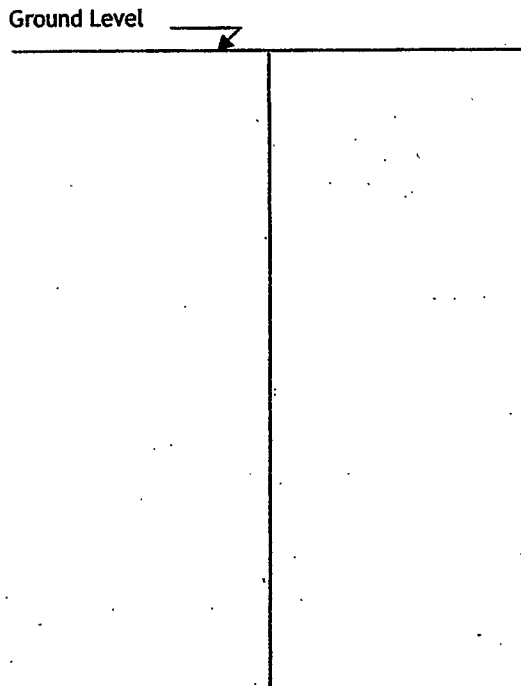

Description of formations encountered must be provided for all wells and boreholes, unless specifically exempted by regulations

| Description of Formations Encountered | From (depth) | To (depth) |
|---------------------------------------|--------------|------------|
| Top Soil | Ground level | 2 |
| Orange Clay | 2 | 18 |
| Orange Coarse Sand | 18 | 32 |
| Orange Clay w/str. of sand | 32 | 100 |
| Blue Clay | 100 | 341 |
| Gray Medium to coarse sand | 341 | 378 |
| | | |
| | | |
| | | |
| | | |
| | | |
| | | |
| | | |
| | | |
| | | |
| | | |
| | | |
| | | |
| | | |
| | | |
| | | |
| | | |
| | | |
| | | |
| | | |
| | | |
| | | |
| | | |
| | | |
| | | |
| | | |

If more than one screen, show location of each on sketch

- Sketch the property layout and include the following:
- 1) the well location
 - 2) any permanent structures on the property that may aid in locating the well
 - 3) any roads, power lines, or other items that may aid in locating the property and the well
 - 4) north arrow

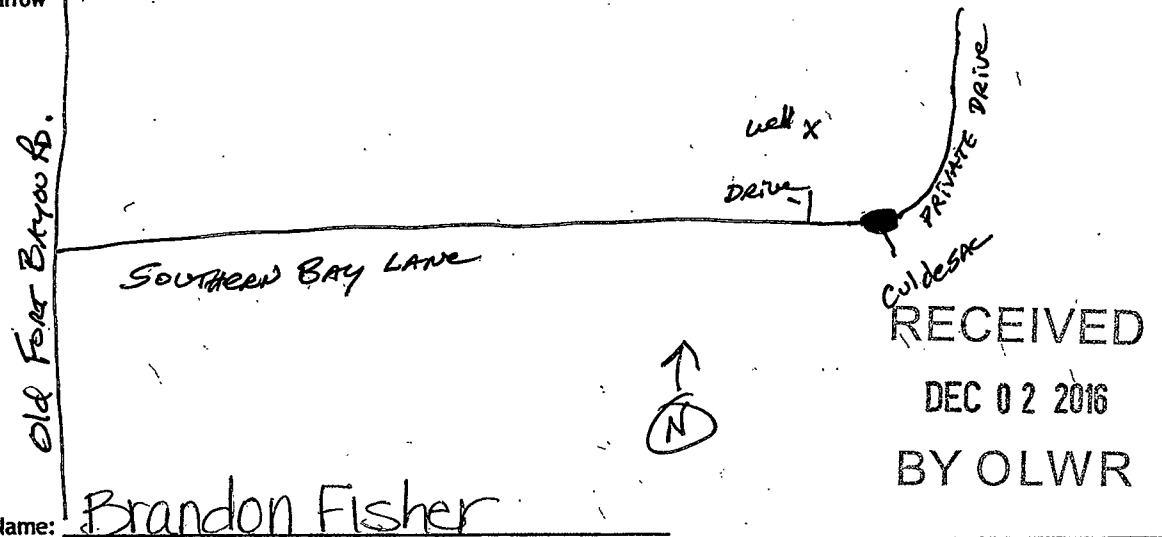

Landowner Name: Brandon Fisher

I HEREBY CERTIFY that the well/borehole was drilled, constructed, and completed in accordance with all applicable requirements of the Mississippi Department of Environmental Quality and the Mississippi Department of Health regulations, if applicable, and state laws.

Jack Ridgedell 0-472 11/15/16 *Janie Ridgedell*
 Print Name of Responsible Licensee and License No. Date Signature of Licensee

STATE WELL REPORT

Part 2

County: Jackson
 Permit #: _____
 Driller: Coast Water Well, Svc
 Date completed: 11-15-16
Copy information from block on Part 1

Pump Installer's Completion Report
 Mississippi Department of Environmental Quality
 Office of Land and Water Resources
 P.O. Box 2309
 Jackson, MS 39225-2309
 (601)961-5210
 (601) 360-0535 (fax)

For Office Use Only:

Well #: _____
 Aquifer: _____

This part of the report must be completed by a licensed water well contractor or a licensed pump installer. A copy of Part 1 of the report must be attached and both parts filed with the Department at the above address within 30 days of well completion.

| Well Owner Information | Well Location |
|---|--|
| Owner Name: <u>Brandon Fisher</u> | Latitude: <u>30° 30' 27.5" N</u> Longitude: <u>088° 44' 18.26" W</u> |
| Mailing Address: <u>Southern Bay Lane</u> | Method of Lat/Long (check one): Conventional Survey _____, USGS quad _____, Hand-held GPS <input checked="" type="checkbox"/> , Survey-grade GPS _____ |
| <u>Vancleave, MS 39565</u> | <u>NE 1/4 SW 1/4, Sec 24 T. 6S R. 8W</u> |
| City: _____ State: _____ Zip Code: _____ | <u>3</u> Miles <u>WSW</u> of <u>Vancleave</u> |
| Telephone No. <u>(251) 510-1138</u> | (Distance) (Direction) (Nearest Town) |

Pump Type (circle one)

Submersible Turbine Air Lift Centrifugal Flowing Well Jet Piston Rotary Other (describe): _____

Date Pump Installed: 12/8/16 Rated Pump Capacity: 7.5 Gallons Per Minute

Is This Pump (circle one): New Repaired Replacement

Power Type (circle one)

Electric Diesel Gasoline Natural Gas Tractor PTO Windmill Other (describe): _____

Horse Power Rating of Motor: 2 HP Setting Depth: 130 FT DP feet Number of Stages: 3

Pump Test Data for Non Flowing Well

Date Well Tested: 12/8/16 Duration of Pump Test (minimum 1 hour): 6 hours

Static Water Level (A): 110 Feet Below Land Surface Pumping Water Level (B): N/A Feet Below Land Surface

Drawdown [(B) - (A)]: N/A Feet Below Land Surface Test Pumping Rate: 7.5 Gallons Per Minute

Method of measurement (circle one): Steel tape Electric tape Air line Other (describe): _____

Pump Test Data for Flowing Well

Measured shut in head: _____ feet. N/A

Well yielded _____ GPM with a drawdown of _____ feet after _____ hours of pumping

Meter Installation

Meter Manufacturer: _____ Meter Serial Number: _____

Meter Model Number/Name: _____ Type of Meter: _____

Totalizer Register Unit and Multiplier Factor (AF x .001, gal x 1000, etc): _____

Installation Date: _____ Meter installed by: _____

Is This Meter (circle one): New Repaired Replacement

Important: By submitting the above information you are certifying that this meter was installed to manufacturer standards. For agricultural wells, a list of approved meters is on the MDEQ website.

I HEREBY CERTIFY that the above statements are true to the best of my knowledge.

Jack Ridgell 0-472 12/12/16 Jack Ridgell

Print Name of Pump Installer and License No. (if applicable) Date Signature of Pump Installer

Form: OLWR-SWR-1B (4/13/06)

BY OLWR