

STATE WELL REPORT

Part 1

Driller's Log

Mississippi Department of Environmental Quality
Office of Land and Water Resources
P.O. Box 2309
Jackson, MS 39225-2309
(601)961-5210
(601)360-0535 (fax)

For Office Use Only:

Well #: F538
Aquifer: _____
E-Log #: _____

County: Jackson
Permit #: _____
Driller: Coast Water Well Svc
Date drilling completed: 12-15-16

State Law requires that this report be prepared by the license holder responsible for the work and filed with the Department at the above address within 30 days of completion of drilling of the well or borehole.

Well Owner Information <small>(Landowner if borehole is not for a water well)</small>	Well or Borehole Location
Owner Name: <u>Norvin Seymour</u>	Latitude: <u>30°35'16.62"</u> Longitude: <u>088°39'16.62"</u>
Mailing Address: <u>16800 McGregor Road</u>	Method of Lat/Long (check one): Conventional Survey _____, USGS quad _____, Hand-held GPS <input checked="" type="checkbox"/> , Survey-grade GPS _____
<u>Vandœuvre, MS 39565</u>	<u>NW 1/4 NE 1/4, Sec 26 T5 S R 7 W</u>
City: _____ State: _____ Zip Code: _____	<u>4 1/2</u> Miles <u>NNE</u> of <u>Vandœuvre</u>
Telephone No. <u>(228) 217-1328</u>	(Distance) (Direction) (Nearest Town)

Well / Borehole Data
Date drilling started: <u>12-14-16</u> Date drilling completed: <u>12-15-16</u> Hole depth: <u>298 FT</u> Hole diameter: <u>2"</u>
Location of the source of any surface water used for drilling: <u>N/A</u>
Method of dosing and volume of Chlorine used in drilling and development: <u>1 GAL per 1000 Drilling 2 GAL in Well</u>
Logs run (circle all applicable): <input checked="" type="checkbox"/> No log run <input type="checkbox"/> Electric <input type="checkbox"/> Gamma Ray <input type="checkbox"/> Density <input type="checkbox"/> Sonic <input type="checkbox"/> Neutron Other: _____
Name of organization running log(s): _____
Purpose of borehole (circle one): <input checked="" type="checkbox"/> Water Well <input type="checkbox"/> Geotechnical/Geological Investigation <input type="checkbox"/> Ground Source Heat Pump <input type="checkbox"/> Seismic Survey Other (describe) _____
<i>If drilling is not related to water well construction, skip the remainder of this block</i>
Purpose of Well (circle all applicable): <input checked="" type="checkbox"/> Home <input type="checkbox"/> Industrial <input type="checkbox"/> Public Supply <input type="checkbox"/> Irrigation <input type="checkbox"/> Fish Culture
Other (describe): _____
If a flowing well, method of flow regulation: Valve _____ Other (describe) _____
Static Water Level: <u>130</u> feet [above or <input checked="" type="checkbox"/> below] land surface Date measured: <u>12-15-16</u> <small>(circle one)</small>
Method of measurement (circle one): Steel tape <input type="checkbox"/> Electric tape <input type="checkbox"/> Air line <input checked="" type="checkbox"/> Other (describe): _____
Well depth: <u>298 FT</u> Well grouted to a depth of: <u>10</u> feet Type of grout (circle one): Neat Cement <input type="checkbox"/> Bentonite <input checked="" type="checkbox"/> Mix
Casing length: <u>283</u> feet Casing diameter: <u>2</u> inches Type of casing: <u>PVC</u>
Screen length: <u>15</u> feet Screen diameter: <u>2</u> inches Type of screen: <u>PVC</u>
Screen slot size: <u>.006</u> inches Setting depth: From <u>283</u> feet to <u>298</u> feet
Type of completion (circle all applicable): Gravel packed <input type="checkbox"/> Underreamed <input type="checkbox"/> Open hole <input checked="" type="checkbox"/> Natural Development
Other (describe): _____
Top of lap pipe or reduction in casing: <u>N/A</u> feet
<i>If telescoped or more than one screen, describe on next page</i>

RECEIVED

DEC 27 2016

County: Jackson
 Permit #: _____

For Office Use Only:
 Well #: F538

The sketch below only required for water wells

If well telescopes, show depths on sketch.

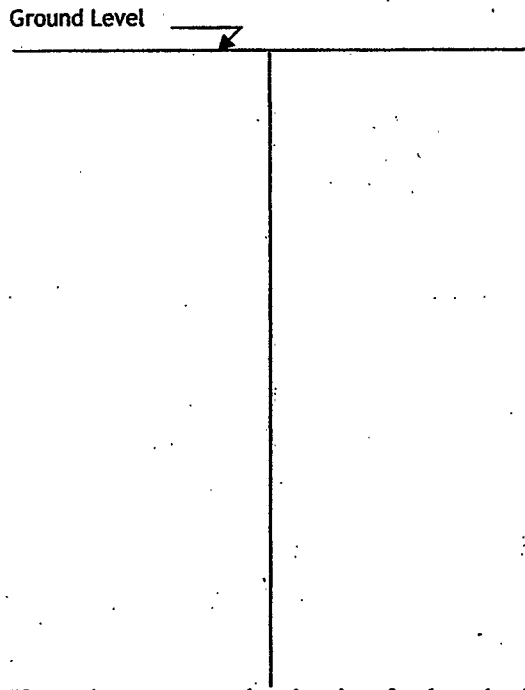

Description of formations encountered must be provided for all wells and boreholes, unless specifically exempted by regulations

Description of Formations Encountered	From (depth)	To (depth)
Top Soil	Ground level	2
Orange Clay	2	20
Orange Coarse Sand	20	62
Orange Clay	62	130
Blue Clay	130	268
Gray Medium to Coarse Sand	268	298

If more than one screen, show location of each on sketch

Sketch the property layout and include the following:

- 1) the well location
- 2) any permanent structures on the property that may aid in locating the well
- 3) any roads, power lines, or other items that may aid in locating the property and the well
- 4) north arrow

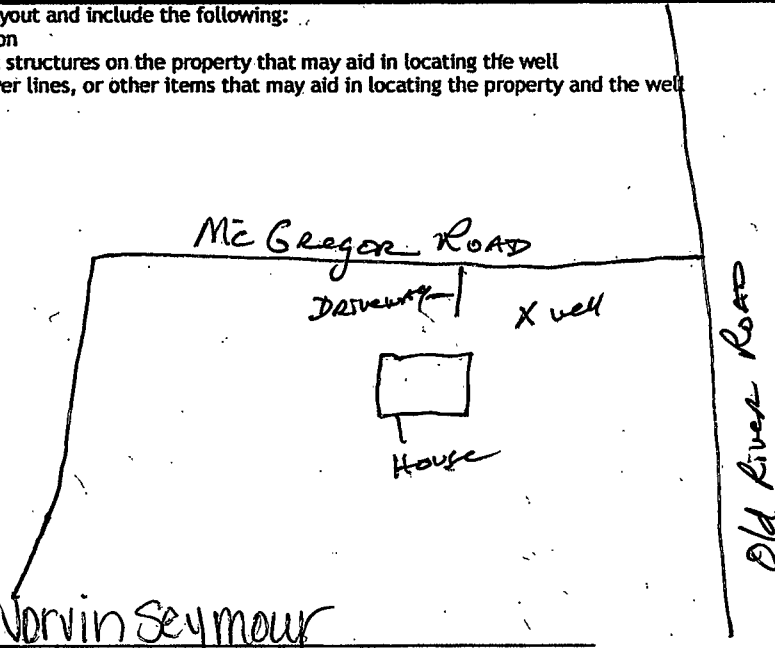

Landowner Name: Norvin Seymour

I HEREBY CERTIFY that the well/borehole was drilled, constructed, and completed in accordance with all applicable requirements of the Mississippi Department of Environmental Quality and the Mississippi Department of Health regulations, if applicable, and state laws.

Jack Kidadell 0472 12/19/16
 Print Name of Responsible Licensee and License No. Date

Jan Phillips
 Signature of Licensee

RECEIVED
 DEC 27 2016

STATE WELL REPORT

Part 2

Pump Installer's Completion Report
Mississippi Department of Environmental Quality
Office of Land and Water Resources
P.O. Box 2309
Jackson, MS 39225-2309
(601)961-5210
(601) 360-0535 (fax)

County: Jackson
Permit #: _____
Driller: Coast Water Well, Inc
Date completed: 12-15-16
Copy information from block on Part 1

For Office Use Only:
Well #: F538
Aquifer: _____

This part of the report must be completed by a licensed water well contractor or a licensed pump installer. A copy of Part 1 of the report must be attached and both parts filed with the Department at the above address within 30 days of well completion.

Well Owner Information	Well Location
Owner Name: <u>Norvin Seymour</u>	Latitude: <u>30° 35' 16.62"</u> Longitude: <u>088° 39' 16.62"</u>
Mailing Address: <u>16800 McGregor RD</u>	Method of Lat/Long (check one): Conventional Survey _____, USGS quad _____, Hand-held GPS <input checked="" type="checkbox"/> , Survey-grade GPS _____
<u>Vance, MS 39565</u>	<u>NW 1/4 NE 1/4, Sec 26 T 5 S R 7 W</u>
City: _____ State: _____ Zip Code: _____	<u>4 1/2</u> Miles <u>NNE</u> of <u>Vance</u>
Telephone No. <u>(601) 217-1328</u>	(Distance) (Direction) (Nearest Town)

Pump Type (circle one)
Submersible Turbine Air Lift Centrifugal Flowing Well Jet Piston Rotary Other (describe): _____
Date Pump Installed: 12-15-16 Rated Pump Capacity: 6 Gallons Per Minute
Is This Pump (circle one): New Repaired Replacement EXISTING
Power Type (circle one)
 Electric Diesel Gasoline Natural Gas Tractor PTO Windmill Other (describe): _____
Horse Power Rating of Motor: 2 HP Setting Depth: 140 FT DP feet Number of Stages: 3

Pump Test Data for Non Flowing Well
Date Well Tested: 12/15/16 Duration of Pump Test (minimum 4 hours): 6 hours
Static Water Level (A): 130 Feet Below Land Surface Pumping Water Level (B): N/A Feet Below Land Surface
Drawdown [(B) - (A)]: N/A Feet Below Land Surface Test Pumping Rate: 6 Gallons Per Minute
Method of measurement (circle one): Steel tape Electric tape Air line Other (describe): _____

Pump Test Data for Flowing Well
Measured shut in head: _____ feet.
Well yielded _____ GPM with a drawdown of N/A feet after _____ hours of pumping

Meter Installation
Meter Manufacturer: _____ Meter Serial Number: _____
Meter Model Number/Name: N/A Type of Meter: _____
Totalizer Register Unit and Multiplier Factor (AF x .001, gal x 1000, etc): _____
Installation Date: _____ Meter installed by: _____
Is This Meter (circle one): New Repaired Replacement
Important: By submitting the above information you are certifying that this meter was installed to manufacturer standards. For agricultural wells, a list of approved meters is on the MDEQ website.

I HEREBY CERTIFY that the above statements are true to the best of my knowledge.
Jack Ridgell 0472 12/19/16 [Signature]
Print Name of Pump Installer and License No. (if applicable) Date Signature of Pump Installer

RECEIVED
DEC 27 2016
BY OLWR