

County: Jackson
 Permit #: 0-780
 Driller: W. Gael Pierce
 Date drilling completed: 3-19-07

State Well Report
Part 1 - Driller's Log
 Mississippi Department of Environmental Quality
 Office of Land and Water Resources
 P.O. Box 10631
 Jackson, MS 39289-0631
 (601)961-5210
 (601)354-6938 (fax)

For Office Use Only:
 Aquifer: _____
 Well #: D-260
 L. S. Elevation: _____
 E-log #: _____

State Law requires that this report be prepared by the license holder responsible for the work and filed with the Department at the above address within 30 days of completion of drilling of the well or borehole.

Information on Well Owner <i>(Landowner if borehole is not for a water well)</i>	Well or Borehole Location
Owner Name: <u>Steven Breunford</u>	Latitude: <u>38° 28' 852"</u> Longitude: <u>30° 40' 426"</u>
Mailing Address: <u>Lot 15 Alamosa Ave</u> <u>Willoughby Broad Drive</u> <u>Humbly MS 39562</u>	Method of Lat/Long (circle one): <u>51</u> Conventional Survey, <u>25</u>
City: <u>Humbly</u> State: <u>MS</u> Zip Code: <u>39562</u>	USGS quad, Hand-held GPS, Survey-grade GPS <u>NE 1/4 NE 1/4 Sec 28 Twn 45 Rng 5W</u>
Telephone No. <u>(228) 219-0950</u>	Distance: <u>2</u> Miles Direction: <u>NE</u> of Nearest Town: <u>Humbly</u>

Well / Borehole Data

Date drilling started: 3-19-07 Date drilling completed: 3-19 Hole depth: 60 Hole diameter: 2

Location of the source of any surface water used for drilling: Aquifer, up
 Method of dosing and volume of Chlorine used in drilling and development: equal chlorine 2000 water

Logs run (circle all applicable): No log run Electric Gamma Ray Density Sonic Neutron Other: _____
 Name of organization running log(s): _____

Purpose of borehole (check one): Water Well Geotechnical/Geological Investigation _____ Ground Source Heat Pump _____
 Seismic Survey _____ Other (describe) _____
If drilling is not related to water well construction, skip the remainder of this block

Purpose of Well (check one): Home Industrial _____ Public Supply _____ Irrigation _____ Fish Culture _____ Other: _____

If a flowing well, method of flow regulation: Valve _____ Other (describe) _____

Static Water Level: 5 feet above or below (circle one) land surface Date measured: 3-19-07

Method of Measurement (circle one) steel tape electric tape air line other: _____

Well depth: 60 Well grouted to a depth of 10 feet Type of grout (circle one): Neat Cement Bentonite Mix

Casing length: 50 feet Casing diameter: 2 inches Type of casing: Sch 40 Plastic

Screen length: 10 feet Screen diameter: 2 inches Type of screen: Sch 80

Screen slot size: 6 inches Setting depth: From 0 feet to 60 feet
50 FT casing 10 FT Screen

Type of completion (circle all applicable): Gravel packed Underreamed Telescoped Open hole Natural Development
 Other (describe): _____

Top of lap pipe or reduction in casing: _____ feet. *If telescoped or more than one screen, describe on next page*

RECEIVED
APR 05 2007
BY: OLWR

The sketch below only required for water wells

If well telescopes, show depths on sketch.

Ground Level 

Description of formations encountered must be provided for all wells and boreholes, unless specifically exempted by regulation.

Description of Formations Encountered From (depth) To (depth)
Ground Level

Description of Formations Encountered	From (depth)	To (depth)
well	0	60

If more than one screen, show location of each on sketch

Sketch the property layout and include the following: 1) the well location; 2) any permanent structures on the property that may aid in locating the well; 3) any roads, power lines, or other items that may aid in locating the property and the well; 4) a north arrow.

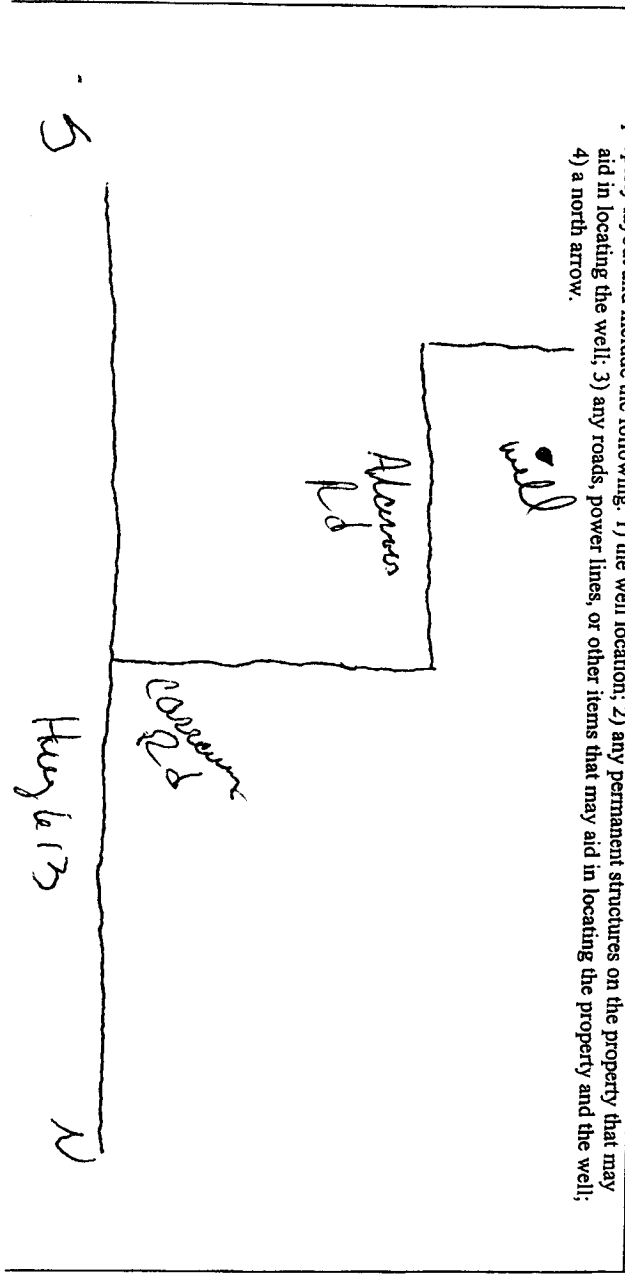

RECEIVED
APR 05 2007
BY: OLWR

STATE WELL REPORT

Part 2

Pump Installer's Completion Report
 Mississippi Department of Environmental Quality
 Office of Land and Water Resources
 P.O. Box 10631
 Jackson, MS 39289-0631
 (601)961-5210
 (601)354-6938 (fax)

County: Jackson
 Permit #: 0-780
 Driller: W. Joel Pierce
 Date completed: 3-19-07
Copy information from block on Part 1

For Office Use Only:

Aquifer: _____
 Well #: D-260
 Elevation: _____

This part of the report must be completed by a licensed water well contractor or a licensed pump installer. A copy of Part 1 of the report must be attached and both parts filed with the Department at the above address within 30 days of well completion.

Well Owner Information	Well Location
Owner Name: <u>Steven Breunford</u>	Latitude: <u>88-28-852</u> Longitude: <u>30-40-426</u>
Mailing Address: <u>Lot 15 Alamosa Dr</u>	Method of Lat/Long (check one): Conventional Survey <u>SI</u> <u>25</u>
<u>Hubly</u> <u>ms</u> <u>39562</u>	USGS quad _____, Hand-held GPS <input checked="" type="checkbox"/> , Survey-grade GPS _____
City State Zip Code	<u>NE 1/4 NE 1/4 Sec 28 T 45 R 5W</u>
Telephone No. <u>(228) 219-0950</u>	Distance Direction Nearest Town <u>2 Miles NE of Hubly</u>

Pump Type Circle one	Power Type Circle one
Air Lift <input type="checkbox"/> Jet <input checked="" type="checkbox"/> Submersible <input type="checkbox"/>	Diesel Engine <input type="checkbox"/> Gasoline Engine <input type="checkbox"/> Natural Gas <input type="checkbox"/>
Bucket <input type="checkbox"/> Piston <input type="checkbox"/> Turbine <input type="checkbox"/>	<input checked="" type="checkbox"/> Electric Motor <input type="checkbox"/> Hand <input type="checkbox"/> Tractor PTO <input type="checkbox"/>
Centrifugal <input type="checkbox"/> Rotary <input type="checkbox"/> Flowing Well <input type="checkbox"/>	Windmill <input type="checkbox"/> Other (specify): _____
Other (specify): _____	Horse Power Rating of Motor: <u>1</u>
Date Pump Installed: <u>3-19-07</u>	Setting Depth: <u>40 FT Jet Line</u> feet
Rated Pump Capacity: <u>10</u> Gallons Per Minute	Number of Stages: <u>2</u>

RECEIVED
 APR 05 2007
 BY: OLWR

Pump Test Data	Method of Measuring Water Level Circle one
Date Well Tested: <u>3-19-07</u>	<input checked="" type="checkbox"/> Air Line <input type="checkbox"/> Electric Measuring Line <input type="checkbox"/> Steel Tape
Static Water Level (A): <u>5</u> Feet Below Land Surface	Other (specify): _____
Pumping Water Level (B): <u>40</u> Feet Below Land Surface	For flowing well, measured shut in head: _____ feet
Drawdown [(B) - (A)]: <u>3</u> Feet Below Land Surface	Well yielded <u>7</u> GPM with a drawdown of
Test Pumping Rate: <u>7</u> Gallons Per Minute	<u>3</u> feet after <u>48</u> hours of pumping
Duration of Pump Test (minimum 4 hours): <u>48</u> hours	

I HEREBY CERTIFY that the above statements are true to the best of my knowledge.

JOEL PIERCE 0-780 _____
 Print Name of Pump Installer and License No. (if applicable) Signature of Pump Installer