

County: Jackson  
 Permit #: 0-780  
 Driller: W. Joel Pierce  
 Date drilling completed: 2-9-07

**State Well Report**  
**Part 1 - Driller's Log**

Mississippi Department of Environmental Quality  
 Office of Land and Water Resources  
 P.O. Box 10631  
 Jackson, MS 39289-0631  
 (601)961-5210  
 (601)354-6938 (fax)

For Office Use Only:  
 Aquifer: \_\_\_\_\_  
 Well #: C-111  
 L. S. Elevation: \_\_\_\_\_  
 E-log #: \_\_\_\_\_

*State Law requires that this report be prepared by the license holder responsible for the work and filed with the Department at the above address within 30 days of completion of drilling of the well or borehole.*

Information on Well Owner <i>(Landowner if borehole is not for a water well)</i>	Well or Borehole Location
Owner Name: <u>Mark Pope</u>	Latitude: <u>33° 31' 16.8"</u> Longitude: <u>30° 40' 26.7"</u>
Mailing Address: <u>2400 Mulberry Lane</u>	Method of Lat/Long (circle one): Conventional Survey, <u>10</u>
<u>OK Sub Division</u>	USGS quad: <u>Hand-held GPS</u> , Survey-grade GPS <u>6W</u>
<u>Henley MS 39562</u>	<u>NW 1/4 SW 1/4 Sec 30</u> Twn <u>45</u> Rng <u>6W</u>
City: _____ State: _____ Zip Code: _____	Distance: <u>3</u> Miles Direction: <u>NE</u> of Nearest Town: <u>Henley</u>
Telephone No.: <u>(228) 218-0196</u>	

**Well / Borehole Data**

Date drilling started: 2-9-07 Date drilling completed: 2-9-07 Hole depth: 380 Hole diameter: 2

Location of the source of any surface water used for drilling: \_\_\_\_\_  
 Method of dosing and volume of Chlorine used in drilling and development: \_\_\_\_\_

Logs run (circle all applicable): No log run Electric Gamma Ray Density Sonic Neutron Other: \_\_\_\_\_  
 Name of organization running log(s): \_\_\_\_\_

Purpose of borehole (check one): Water Well  Geotechnical/Geological Investigation \_\_\_\_\_ Ground Source Heat Pump \_\_\_\_\_  
 Seismic Survey \_\_\_\_\_ Other (describe) \_\_\_\_\_

*If drilling is not related to water well construction, skip the remainder of this block*

Purpose of Well (check one): Home  Industrial \_\_\_\_\_ Public Supply \_\_\_\_\_ Irrigation \_\_\_\_\_ Fish Culture \_\_\_\_\_ Other: \_\_\_\_\_

If a flowing well, method of flow regulation: Valve \_\_\_\_\_ Other (describe) \_\_\_\_\_

Static Water Level: 10 feet above or below (circle one) land surface Date measured: 2-9-07

Method of Measurement (circle one) steel tape electric tape air line other: \_\_\_\_\_

Well depth: 380 Well grouted to a depth of 10 feet Type of grout (circle one): Neat Cement Bentonite Mix

Casing length: 370 feet Casing diameter: 2 inches Type of casing: Sch 40 Plastic

Screen length: 10 feet Screen diameter: 2 inches Type of screen: Sch 80

Screen slot size: 6 slot inches Setting depth: From 0 feet to 380 feet

Type of completion (circle all applicable): Gravel packed Underreamed Telescoped Open hole Natural Development  
370 FT casing 10 FT Screen

Other (describe): \_\_\_\_\_

Top of lap pipe or reduction in casing: \_\_\_\_\_ feet. *If telescoped or more than one screen, describe on next page*

Form: OLWR-SWR-1A

**RECEIVED**  
 FEB 20 2007  
 BY: OLWF

The sketch below only required for water wells

If well telescopes, show depths on sketch.

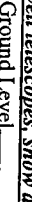

If more than one screen, show location of each on sketch

Description of formations encountered must be provided for all wells and boreholes, unless specifically exempted by regulations

Description of Formations Encountered	From (depth)		To (depth)
	Ground Level		
yellow sand	0	100	
blue clay	100	300	
grey sand	300	380	

Sketch the property layout and include the following: 1) the well location; 2) any permanent structures on the property that may aid in locating the well; 3) any roads, power lines, or other items that may aid in locating the property and the well; 4) a north arrow.

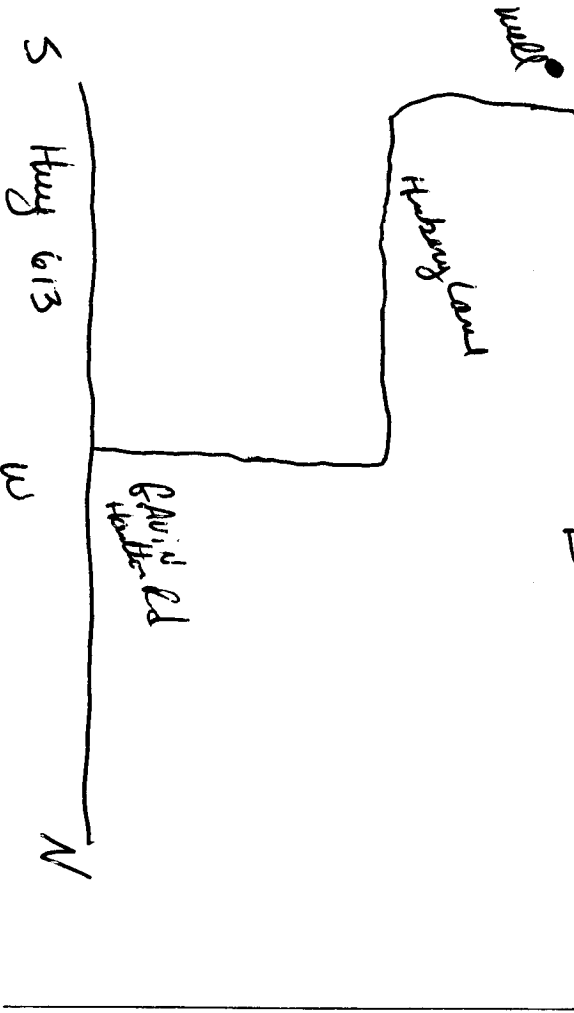

RECEIVED  
 Feb 20 2007  
 BY: OLWR

# STATE WELL REPORT

## Part 2

**Pump Installer's Completion Report**  
 Mississippi Department of Environmental Quality  
 Office of Land and Water Resources  
 P.O. Box 10631  
 Jackson, MS 39289-0631  
 (601)961-5210  
 (601)354-6938 (fax)

County: Jackson  
 Permit #: 0-780  
 Driller: W. Joel Pierce  
 Date completed: 2-9-07  
*Copy information from block on Part 1*

**For Office Use Only:**

Aquifer: \_\_\_\_\_  
 Well #: C-111  
 Elevation: \_\_\_\_\_

*This part of the report must be completed by a licensed water well contractor or a licensed pump installer. A copy of Part 1 of the report must be attached and both parts filed with the Department at the above address within 30 days of well completion.*

Well Owner Information	Well Location
Owner Name: <u>Mark Poppe</u>	Latitude: <u>88-31-168</u> Longitude: <u>30-46-267</u>
Mailing Address: <u>2400 Huckleberry Lane</u> <u>AKS Subdivision</u>	Method of Lat/Long (check one): Conventional Survey _____ USGS quad _____, Hand-held GPS <input checked="" type="checkbox"/> , Survey-grade GPS _____
<u>Humbly</u> <u>MS</u> <u>39562</u> City State Zip Code	<u>NW</u> <u>1/4</u> <u>SW</u> <u>1/4</u> Sec <u>30</u> T <u>45</u> R <u>6W</u>
Telephone No. <u>(228) 218-0196</u>	Distance: <u>3</u> Miles <u>NE</u> of <u>Humbly</u>

Pump Type Circle one	Power Type Circle one
Air Lift <input type="radio"/> Jet <input checked="" type="radio"/> Submersible	Diesel Engine <input type="radio"/> Gasoline Engine <input type="radio"/> Natural Gas
Bucket <input type="radio"/> Piston <input type="radio"/> Turbine	<input checked="" type="radio"/> Electric Motor <input type="radio"/> Hand <input type="radio"/> Tractor PTO
Centrifugal <input type="radio"/> Rotary <input type="radio"/> Flowing Well	Windmill <input type="radio"/> Other (specify): _____
Other (specify): _____	Horse Power Rating of Motor: <u>1hp</u>
Date Pump Installed: <u>2-9-07</u>	Setting Depth: <u>60 FT Set Line</u> feet
Rated Pump Capacity: <u>10</u> Gallons Per Minute	Number of Stages: <u>2</u>

Pump Test Data	Method of Measuring Water Level Circle one
Date Well Tested: <u>2-9-07</u>	<input checked="" type="radio"/> Air Line <input type="radio"/> Electric Measuring Line <input type="radio"/> Steel Tape
Static Water Level (A): <u>10</u> Feet Below Land Surface	Other (specify): _____
Pumping Water Level (B): <u>60</u> Feet Below Land Surface	For flowing well, measured shut in head: _____ feet
Drawdown [(B) - (A)]: <u>3</u> Feet Below Land Surface	Well yielded <u>9</u> GPM with a drawdown of
Test Pumping Rate: <u>10</u> Gallons Per Minute	<u>2</u> feet after <u>36</u> hours of pumping
Duration of Pump Test (minimum 4 hours): <u>36</u> hours	

I HEREBY CERTIFY that the above statements are true to the best of my knowledge.

Joel Pierce - 0-780 Joel Pierce  
 Print Name of Pump Installer and License No. (if applicable) Signature of Pump Installer

Form: OLWR-SWR-1B  
**RECEIVED**  
 FEB 29 2007  
 BY: OLWF