

STATE WELL REPORT

Part 1

Driller's Log

Mississippi Department of Environmental Quality
Office of Land and Water Resources
P.O. Box 2309
Jackson, MS 39225-2309
(601)961-5210
(601)360-0535 (fax)

County: Jackson
Permit #: _____
Driller: Coast Water Wells, Inc.
Date drilling completed: 5-16-14

For Office Use Only:
Well #: A 158
Aquifer: _____
E-Log #: _____

State Law requires that this report be prepared by the license holder responsible for the work and filed with the Department at the above address within 30 days of completion of drilling of the well or borehole.

Well Owner Information (Landowner if borehole is not for a water well)	Well or Borehole Location
Owner Name: <u>Jessica Evans</u>	Latitude: <u>30°43'25.32"</u> Longitude: <u>088°46'54.42"</u>
Mailing Address: <u>26300 Old Biloxi Road</u>	Method of Lat/Long (check one): Conventional Survey _____ USGS quad _____, Hand-held GPS <input checked="" type="checkbox"/> , Survey-grade GPS _____
<u>Vanclave, MS 39565</u>	<u>SW</u> ¼ <u>SW</u> ¼, Sec <u>3</u> T <u>4S</u> R <u>8W</u>
City _____ State _____ Zip Code _____	<u>13.5</u> Miles <u>NW</u> of <u>Vanclave</u>
Telephone No. <u>(601) 291-2710</u>	(Distance) (Direction) (Nearest Town)

Well / Borehole Data	
Date drilling started: <u>5-16-14</u> Date drilling completed: <u>5-16-14</u> Hole depth: <u>260 FT</u> Hole diameter: <u>2"</u>	
Location of the source of any surface water used for drilling: <u>N/A</u>	
Method of dosing and volume of Chlorine used in drilling and development: <u>1 gal per 1000 Drilling - 2 gal in Well</u>	
Logs run (circle all applicable): <input checked="" type="checkbox"/> No log run <input type="checkbox"/> Electric <input type="checkbox"/> Gamma Ray <input type="checkbox"/> Density <input type="checkbox"/> Sonic <input type="checkbox"/> Neutron <input type="checkbox"/> Other: _____	
Name of organization running log(s): _____	
Purpose of borehole (circle one): <input checked="" type="checkbox"/> Water Well <input type="checkbox"/> Geotechnical/Geological Investigation <input type="checkbox"/> Ground Source Heat Pump <input type="checkbox"/> Seismic Survey <input type="checkbox"/> Other (describe) _____	
<i>If drilling is not related to water well construction, skip the remainder of this block</i>	
Purpose of Well (circle all applicable): <input checked="" type="checkbox"/> Home <input type="checkbox"/> Industrial <input type="checkbox"/> Public Supply <input type="checkbox"/> Irrigation <input type="checkbox"/> Fish Culture	
Other (describe): _____	
If a flowing well, method of flow regulation: Valve _____ Other (describe) _____	
Static Water Level: <u>+2</u> feet <input checked="" type="checkbox"/> (above) or <input type="checkbox"/> (below) land surface Date measured: <u>5-16-14</u>	
Method of measurement (circle one): Steel tape <input type="checkbox"/> Electric tape <input type="checkbox"/> <input checked="" type="checkbox"/> Air line <input type="checkbox"/> Other (describe) _____	
Well depth: <u>260 FT</u> Well grouted to a depth of: <u>10</u> feet Type of grout (circle one): Neat Cement <input type="checkbox"/> <input checked="" type="checkbox"/> Bentonite <input type="checkbox"/> Mix	
Casing length: <u>250</u> feet Casing diameter: <u>2</u> inches Type of casing: <u>PVC</u>	
Screen length: <u>10</u> feet Screen diameter: <u>2</u> inches Type of screen: <u>PVC</u>	
Screen slot size: <u>.006</u> inches Setting depth: From <u>250</u> feet to <u>260</u> feet	
Type of completion (circle all applicable): Gravel packed <input type="checkbox"/> Underreamed <input type="checkbox"/> Open hole <input checked="" type="checkbox"/> <input checked="" type="checkbox"/> Natural Development	
Other (describe): _____	
Top of lap pipe or reduction in casing: <u>N/A</u> feet	
<i>If telescoped or more than one screen, describe on next page</i>	

County: JACKSON
 Permit #: _____

For Office Use Only:
 Well #: A 158

The sketch below only required for water wells

If well telescopes, show depths on sketch.

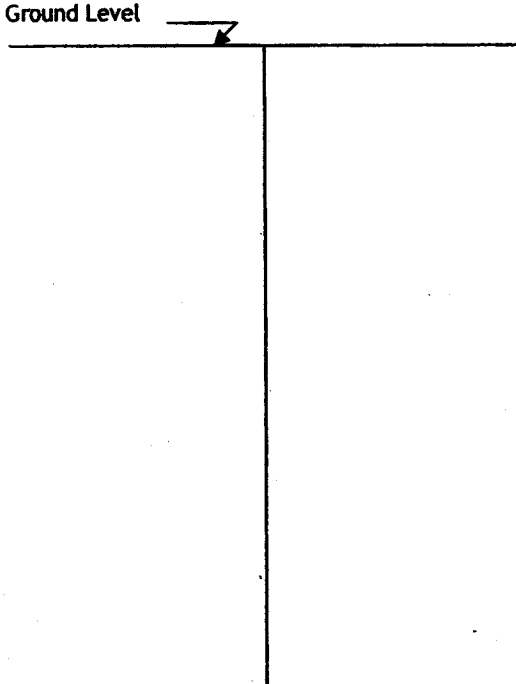

Description of formations encountered must be provided for all wells and boreholes, unless specifically exempted by regulations

Description of Formations Encountered	From (depth)	To (depth)
TOPSOIL	Ground level	2
Orange Clay	2	15
White Coarse sand	15	56
Blue clay w/ streaks of sand	56	220
Gray Coarse sand w/ pebbles	220	260

If more than one screen, show location of each on sketch

- Sketch the property layout and include the following:
- 1) the well location
 - 2) any permanent structures on the property that may aid in locating the well
 - 3) any roads, power lines, or other items that may aid in locating the property and the well
 - 4) north arrow

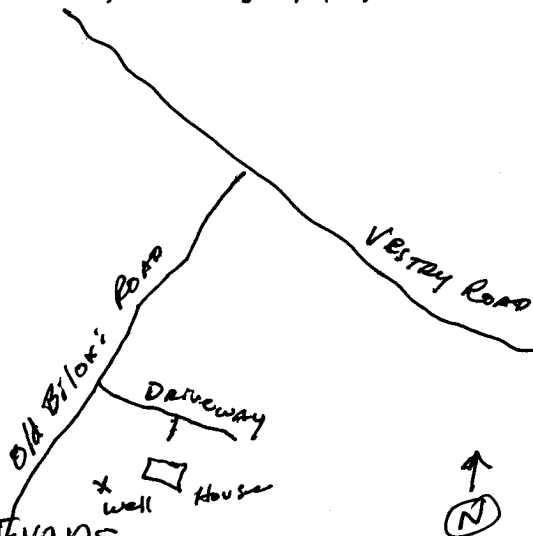

Landowner Name: Jessica Evans

I HEREBY CERTIFY that the well/borehole was drilled, constructed, and completed in accordance with all applicable requirements of the Mississippi Department of Environmental Quality and the Mississippi Department of Health regulations, if applicable, and state laws.

Jack Ridadell 0-472 5/19/14
 Print Name of Responsible Licensee and License No. Date

Signature of Licensee

STATE WELL REPORT

Part 2

Pump Installer's Completion Report
 Mississippi Department of Environmental Quality
 Office of Land and Water Resources
 P.O. Box 2309
 Jackson, MS 39225-2309
 (601)961-5210
 (601) 360-0535 (fax)

County: Jackson
 Permit #: _____
 Driller: Coast Water Wells
 Date completed: 5-16-14
 Copy information from block on Part 1

For Office Use Only:

Well #: A158
 Aquifer: _____

This part of the report must be completed by a licensed water well contractor or a licensed pump installer. A copy of Part 1 of the report must be attached and both parts filed with the Department at the above address within 30 days of well completion.

Well Owner Information	Well Location
Owner Name: <u>Jessica Evans</u>	Latitude: <u>30°43'25.30"</u> Longitude: <u>088°46'54.42"</u>
Mailing Address: <u>26300 Old Biloxi Road</u>	Method of Lat/Long (check one): Conventional Survey _____
<u>Vancleave, MS 39565</u>	USGS quad _____, Hand-held GPS <input checked="" type="checkbox"/> , Survey-grade GPS _____
City: _____ State: _____ Zip Code: _____	<u>SW 1/4 SW 1/4, Sec 3 T 45 R 8W</u>
Telephone No. <u>(228) 297-2770</u>	<u>13.5</u> Miles <u>NW</u> of <u>Vancleave</u>
	(Distance) (Direction) (Nearest Town)

Pump Type (circle one)

Submersible Turbine Air Lift Centrifugal Flowing Well Jet Piston Rotary Other (describe): _____

Date Pump Installed: 5-16-14 Rated Pump Capacity: 10 Gallons Per Minute

Is This Pump (circle one): New Repaired Replacement

Power Type (circle one)

Electric Diesel Gasoline Natural Gas Tractor PTO Windmill Other (describe): _____

Horse Power Rating of Motor: 1HP Setting Depth: 20FT DP feet Number of Stages: 2

Pump Test Data for Non Flowing Well

Date Well Tested: 5-16-14 Duration of Pump Test (minimum 4 hours): 5 hours

Static Water Level (A): +2 Feet Below Land Surface Pumping Water Level (B): N/A Feet Below Land Surface

Drawdown ((B) - (A)): N/A Feet Below Land Surface Test Pumping Rate: 10 Gallons Per Minute

Method of measurement (circle one): Steel tape Electric tape Air line Other (describe): _____

Pump Test Data for Flowing Well

Measured shut in head: 0 feet.

Well yielded _____ GPM with a drawdown of N/A feet after _____ hours of pumping

Jet Pump on well NOT Flowing openly

Meter Installation

Meter Manufacturer: _____ Meter Serial Number: _____

Meter Model Number/Name: _____ Type of Meter: _____

Totalizer Register Unit and Multiplier Factor (AF x .001/gal x 1000, etc): _____

Installation Date: _____ Meter installed by: _____

Is This Meter (circle one): New Repaired Replacement

Important: By submitting the above information you are certifying that this meter was installed to manufacturer standards. For agricultural wells, a list of approved meters is on the MDEQ website.

I HEREBY CERTIFY that the above statements are true to the best of my knowledge.

Jack Bidadell 0-472 5/19/14 Jack Bidadell

Print Name of Pump Installer and License No. (if applicable) Date Signature of Pump Installer