

# State Well Report

## Part 1

Mississippi Department of Environmental Quality  
Office of Land and Water Resources  
P.O. Box 10631  
Jackson, MS 39289-0631  
(601)961-5210  
(601)354-6938 (fax)

**For Office Use Only:**

Aquifer: \_\_\_\_\_  
Well #: A-95  
L. S. Elevation: \_\_\_\_\_  
E-log #: \_\_\_\_\_

County: JACKSON  
Permit #: \_\_\_\_\_  
Driller: Coast Water Wellsrv.  
Date drilling completed: 1-3-07

**State Law requires that this report be prepared by the driller in detail and filed with the Department within 30 days of completion of drilling of the well.**

Well Owner Information	Well Location
Owner Name: <u>Daniel Lawler, JR.</u>	Latitude: <u>30° 42' 153"</u> Longitude: <u>088° 40' 552"</u>
Mailing Address: <u>Hwy 51</u>	Method of Lat/Long (circle one): <u>09</u> Conventional Survey, <u>33</u>
<u>Vanceleave Ms 39565</u>	USGS quad, <u>(Hand-held GPS)</u> , Survey-grade GPS
City State Zip Code	<u>NE 1/4 NW 1/4 Sec 13</u> Twn <u>T45</u> Rng <u>R8W</u>
Telephone No. <u>601-207-4895</u>	Distance Direction Nearest Town
	<u>13</u> Miles <u>NNW</u> of <u>Vanceleave</u>

**Well Data**

Purpose of Well (circle one) Home Industrial Public Supply Irrigation Fish Culture Other: \_\_\_\_\_

Date well drilling started: \_\_\_\_\_ Date well drilling completed: 1-3-07

If flowing, method of flow regulation: Valve N/A Other (describe) \_\_\_\_\_

Static Water Level: 95 feet above or below (circle one) land surface Date measured: 1-3-07

Method of Measurement (circle one) steel tape electric tape air line other: \_\_\_\_\_

Hole depth: 170' Well depth: 170' Well grouted to a depth of 10 feet

Type of grout (circle one): Cement Bentonite Mix

Casing length: 1160 feet Casing diameter: 2 inches Type of casing: PVC

Screen length: 10 feet Screen diameter: 2 inches Type of screen: PVC

Screen slot size: 0.006 inches Setting depth: From 1160 feet to 170 feet

Type of completion (circle all applicable): Gravel packed Underreamed Telescoped Open hole Natural Development

Other (describe): \_\_\_\_\_

Top of lap pipe or reduction in casing: \_\_\_\_\_ feet. If telescoped or more than one screen, describe on back of page

Logs run (circle all applicable) No log run Electric Gamma Ray Density Sonic Neutron Other: \_\_\_\_\_

Name of organization running log(s): N/A

I certify that the well was drilled, constructed, and completed in accordance with all applicable requirements of the Mississippi Department of Environmental Quality and/or the Mississippi Department of Health regulations and state laws.

Jack Bidgdell 0-472  
Print Name of Water Well Contractor and License No.

Jack Bidgdell  
Signature of Water Well Contractor

RECEIVED

JAN 18 2007  
BY: OLWR

A-95

If well telescopes please sketch below and show depths.

Ground Level

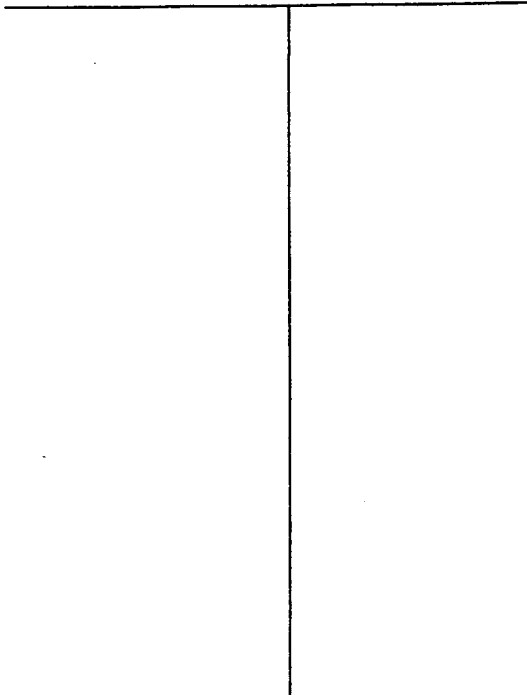

Description of Formations Encountered	From	To
TOP SOIL	0	2
Orange & Blue clay	2	120
Gray medium sand	120	170

If more than one screen, show location of each on sketch

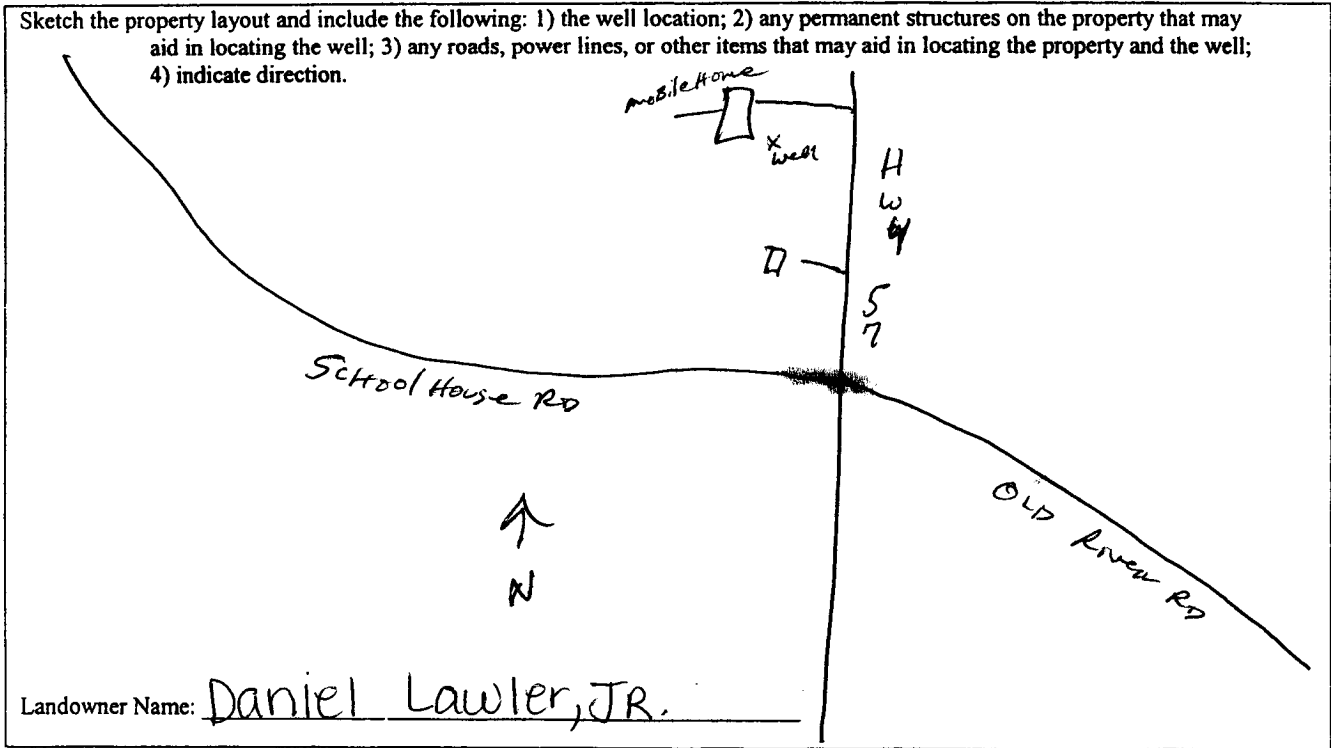

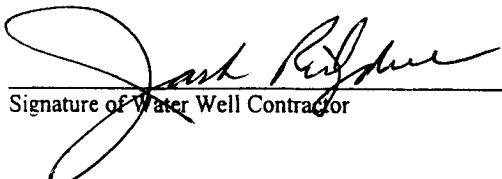
  
Signature of Water Well Contractor

RECEIVED  
JAN 18 2007  
BY: OLWR

# STATE WELL REPORT

## Part 2

**Pump Installer's Completion Report**  
 Mississippi Department of Environmental Quality  
 Office of Land and Water Resources  
 P.O. Box 10631  
 Jackson, MS 39289-0631  
 (601)961-5210  
 (601)354-6938 (fax)

For Office Use Only:

Aquifer: \_\_\_\_\_

Well #: A-95

Elevation: \_\_\_\_\_

County: Jackson  
 Permit #: \_\_\_\_\_  
 Driller: Coast Waterwell  
 Date completed: 1-3-07

**This report should be prepared by the pump installer in detail and filed with the Department within 30 days of the installation of pump.**

Well Owner Information	Well Location
Owner Name: <u>Daniellawler, Jr.</u>	Latitude: <u>30°42'150"</u> Longitude: <u>088°44'550"</u>
Mailing Address: <u>Hwy 57</u>	Method of Lat/Long (circle one): <u>Hand-held GPS</u>
<u>Vanceleave, MS 39565</u>	USGS quad, <u>Hand-held GPS</u> , Survey-grade GPS
City State Zip Code	<u>NE 1/4 NW 1/4 Sec 13 Twn T4S Rng R8W</u>
Telephone No. <u>208-209-4895</u>	Distance Direction Nearest Town
	<u>13 Miles NNW of Vanceleave</u>

Pump Type Circle one	Power Type Circle one
Air Lift <input type="radio"/> Jet <input checked="" type="radio"/> Submersible	Diesel Engine Gasoline Engine Natural Gas
Bucket <input type="radio"/> Piston <input type="radio"/> Turbine	<input checked="" type="radio"/> Electric Motor <input type="radio"/> Hand <input type="radio"/> Tractor PTO
Centrifugal <input type="radio"/> Rotary <input type="radio"/> Flowing Well	Windmill Other (specify): _____
Other (specify): _____	Horse Power Rating of Motor: <u>2 HP</u>
Date Pump Installed: <u>2-19-07</u>	Setting Depth: <u>120 FT. Droppipe</u> feet
Rated Pump Capacity: <u>7.5</u> Gallons Per Minute	Number of Stages: <u>3</u>

Pump Test Data	Method of Measuring Water Level Circle one
Date Well Tested: <u>2-19-07</u>	<input checked="" type="radio"/> Air Line <input type="radio"/> Electric Measuring Line <input type="radio"/> Steel Tape
Static Water Level (A): <u>95</u> Feet Below Land Surface	Other (specify): _____
Pumping Water Level (B): <u>N/A</u> Feet Below Land Surface	For flowing well, measured shut in head: <u>N/A</u> feet
Drawdown [(B) - (A)]: <u>N/A</u> Feet Below Land Surface	Well yielded <u>7.5</u> GPM with a drawdown of
Test Pumping Rate: <u>7.5</u> Gallons Per Minute	<u>N/A</u> feet after <u>N/A</u> hours of pumping
Duration of Pump Test (minimum 4 hours): <u>5</u> hours	

I HEREBY CERTIFY that the above statements are true to the best of my knowledge.

Jack Ridgell 0-472  
 Print Name of Pump Installer and License No. (if applicable)

Jack Ridgell  
 Signature of Pump Installer

**RECEIVED**

MAR 12 2007

BY: OLWR