

6W 44140

Te: 22a # 2
State Well Report

For Office Use Only:

County: HUMPHREYS
Permit #: 6W 44140
Driller: J. NEWCOME 0-773
Date drilling completed: 5-12-10

Mississippi Department of Environmental Quality
Office of Land and Water Resources
P.O. Box 10631
Jackson, MS 39289-0631
(601)961-5210
(601)354-6938 (fax)

Aquifer: C 182
Well #: _____
L. S. Elevation: _____
E-log #: _____

State Law requires that this report be prepared by the driller in detail and filed with the Department within 30 days of completion of drilling of the well.

Well Owner Information	Well Location
Owner Name: <u>Tierra II</u>	Latitude: <u>33° 13' 37"</u> Longitude: <u>90° 30' 12"</u>
Mailing Address: <u>2921-B. So Kish Ave</u>	Method of Lat/Long (circle one): <u>Conventional Survey</u>
<u>Yuma</u> <u>AZ</u> <u>85365</u>	USGS quad, <u>Hand-held GPS</u> Survey-grade GPS
City State Zip Code	<u>SE</u> ¼ <u>SE</u> ¼ Sec <u>16</u> Twn <u>16N</u> Rng <u>3W</u>
Telephone No. <u>928 210-7794</u>	Distance <u>3.5</u> Miles Direction <u>NW</u> of Nearest Town <u>BEZONI</u>
<u>Jessie Couch</u>	

Well Data

Purpose of Well (circle one) Home Industrial Public Supply Irrigation Fish Culture Other: _____

Date well drilling started: 5-12-10 Date well drilling completed: 5-12-10

If flowing, method of flow regulation: Valve _____ Other (describe) _____

Static Water Level: _____ feet above or below (circle one) land surface Date measured: _____

Method of Measurement (circle one) steel tape electric tape air line other: _____

Hole depth: 103 Well depth: 100 Well grouted to a depth of 10 feet

Type of grout (circle one): Cement Bentonite Mix

Casing length: 75 feet Casing diameter: 10 inches Type of casing: PVC

Screen length: 25 feet Screen diameter: 10 inches Type of screen: PVC

Screen slot size: .050 inches Setting depth: From 70-85 feet to 890-100

Type of completion (circle all applicable): Gravel packed Underreamed Telescoped Open hole Natural Development

Other (describe): _____

Top of lap pipe or reduction in casing: _____ feet. If telescoped or more than one screen, describe on back of page

Logs run (circle all applicable): No log run Electric Gamma Ray Density Sonic Neutron Other: _____

Name of organization running log(s): _____

I certify that the well was drilled, constructed, and completed in accordance with all applicable requirements of the Mississippi Department of Environmental Quality and/or the Mississippi Department of Health regulations and state laws.

JOHN NEWCOME 0-773
Print Name of Water Well Contractor and License No.

John Newcome
Signature of Water Well Contractor

RECEIVED
JUL 06 2010
BY: OLWR

If well telescopes please sketch below and show depths.

Ground Level

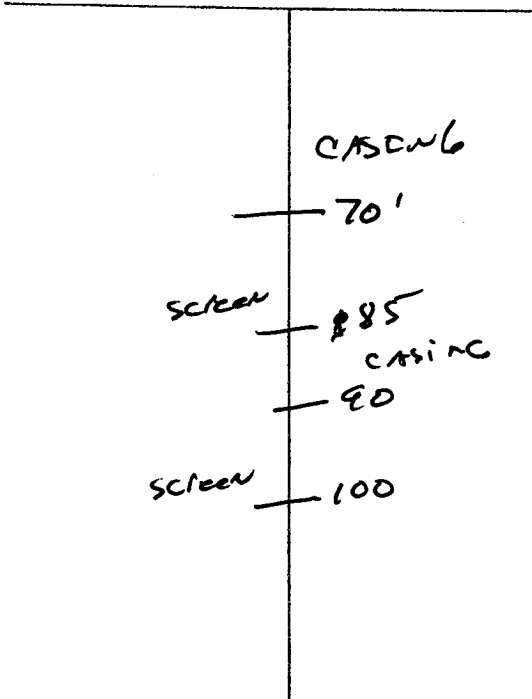

Description of Formations Encountered	From	To
TOP SOIL	0	10
MIX CLAY	10	40
Fine Sand	40	70
COARSE Sand	70	85
Fine Sand	85	90
COARSE Sand - gravel	90	100
GRAVEL	100	103

If more than one screen, show location of each on sketch

Sketch the property layout and include the following: 1) the well location; 2) any permanent structures on the property that may aid in locating the well; 3) any roads, power lines, or other items that may aid in locating the property and the well; 4) indicate direction.

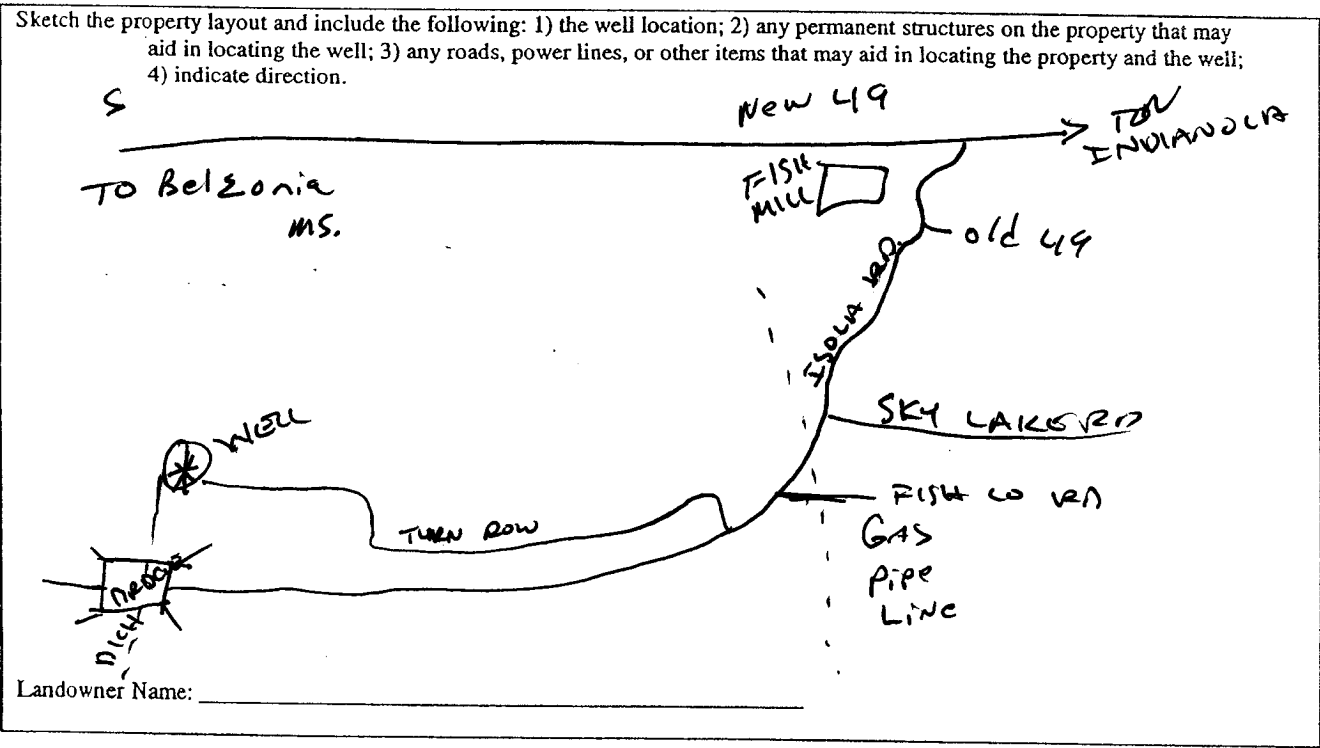

Landowner Name: _____

John Newcomer
Signature of Water Well Contractor

STATE WELL REPORT

C182

Part 2

Pump Installer's Completion Report
 Mississippi Department of Environmental Quality
 Office of Land and Water Resources
 P.O. Box 10631
 Jackson, MS 39289-0631
 (601)961-5210
 (601)354-6938 (fax)

For Office Use Only:

Aquifer: _____
 Well #: _____
 Elevation: _____

County: Humphreys
 Permit #: _____
 Driller: J. Newcome O-773
 Date completed: 5-12-10

This report should be prepared by the pump installer in detail and filed with the Department within 30 days of the installation of pump.

Well-Owner Information	Well Location
Owner Name: <u>Tierra Partners II</u>	Latitude: <u>33° 13' 37"</u> Longitude: <u>090° 30' 12"</u>
Mailing Address: <u>2921-B So. Kish Ave</u>	Method of Lat/Long (circle one): Conventional Survey, USGS quad <u>Hand-held GPS</u> , Survey-grade GPS
<u>Yuma</u> <u>AZ</u> <u>85365</u> City State Zip Code	<u>SE</u> ¼ <u>SE</u> ¼ Sec <u>16</u> Twn <u>16N</u> Rng <u>3W</u>
Telephone No: <u>928) 210-7794</u> <u>Jessie Couch</u>	Distance Direction Nearest Town <u>3.5</u> Miles <u>NW</u> of <u>Betzoni</u>

Pump Type Circle one	Power Type Circle one
Air Lift Jet <u>Submersible</u>	Diesel Engine Gasoline Engine Natural Gas
Bucket Piston Turbine	<u>Electric Motor</u> Hand Tractor PTO
Centrifugal Rotary Flowing Well	Windmill Other (specify): _____
Other (specify): _____	Horse Power Rating of Motor: <u>30</u>
Date Pump Installed: <u>5/12/10</u>	Setting Depth: <u>70</u> feet
Rated Pump Capacity: <u>1100</u> Gallons Per Minute	Number of Stages: <u>1</u>

Pump Test Data	Method of Measuring Water Level Circle one
Date Well Tested: _____	Air Line Electric Measuring Line Steel Tape
Static Water Level (A): _____ Feet Below Land Surface	Other (specify): _____
Pumping Water Level (B): _____ Feet Below Land Surface	For flowing well, measured shut in head: _____ feet
Drawdown [(B) - (A)]: _____ Feet Below Land Surface	Well yielded _____ GPM with a drawdown of _____ feet after _____ hours of pumping
Test Pumping Rate: _____ Gallons Per Minute	
Duration of Pump Test (minimum 4 hours): _____ hours	

I HEREBY CERTIFY that the above statements are true to the best of my knowledge.

Com Rowe O-711P [Signature]
 Print Name of Pump Installer and License No. (if applicable) Signature of Pump Installer

RECEIVED
 JUL 06 2010
 BY: OLWR