

County: Humphreys  
 Permit #: GW-47305  
 Driller: Irrigation equipment  
 Date drilling completed: 05/23/2013

# STATE WELL REPORT

## Part 1

### Driller's Log

Mississippi Department of Environmental Quality  
 Office of Land and Water Resources  
 P.O. Box 2309  
 Jackson, MS 39225-2309  
 (601) 961-5210  
 (601) 360-0535 (fax)

**For Office Use Only:**  
 Well #: B 319  
 Aquifer: \_\_\_\_\_  
 E-Log #: \_\_\_\_\_

*State Law requires that this report be prepared by the license holder responsible for the work and filed with the Department at the above address within 30 days of completion of drilling of the well or borehole.*

Well Owner Information <i>(Landowner if borehole is not for a water well)</i>			Well or Borehole Location	
Owner Name: <u>Edward Nerren Jr.</u>			Latitude: <u>33 14' 35.2 N</u>	Longitude: <u>90 41' 17.8 W</u>
Mailing Address: <u>4802 Beasley Bayou Road</u>			Method of Lat/Long (check one): <input type="checkbox"/> Conventional Survey,	
			<input type="checkbox"/> USGS quad, <input checked="" type="checkbox"/> Hand-held GPS, <input type="checkbox"/> Survey-grade GPS	
<u>Isola</u>	<u>Ms</u>	<u>38754</u>	<u>SE 1/4 SW 1/4, Sec 11 T 16 N R 5 W</u>	
City	State	Zip code		
Telephone No. ( ) -			<u>5</u> Miles <u>Southwest</u> of <u>Isola</u>	
			<i>(Distance)</i>	<i>(Direction)</i> <i>(Nearest Town)</i>

**Well / Borehole Data**

Date drilling started: 05/23/2013 Date drilling completed: 05/23/2013 Hole depth: 116 Hole diameter: 18"

Location of the source of any surface water used for drilling: Surface Water

Method of dosing and volume of Chlorine used in drilling and development: 50 PPM

Logs run (check all applicable):  No log run  Electric  Gamma Ray  Density  Sonic  Neutron  Other: \_\_\_\_\_

Name of organization running log(s): \_\_\_\_\_

Purpose of borehole (check one):  Water Well  Geotechnical/Geological Investigation  Ground Source Heat Pump  
 Seismic Survey  Other (describe): \_\_\_\_\_

*If drilling is not related to water well construction, skip the remainder of this block*

Purpose of Well (check all applicable):  Home  Industrial  Public Supply  Irrigation  Fish Culture  
 Other (describe): \_\_\_\_\_

If a flowing well, method of flow regulation: Valve \_\_\_\_\_ Other (describe) \_\_\_\_\_

Static Water Level: 33 feet [ above or  below] land surface Date measured: 05/24/2013  
*(check one)*

Method of Measurement (check one)  Steel tape  Electric tape  Air line  Other: (describe) \_\_\_\_\_

Well depth: 116 Well grouted to a depth of: 10 feet Type of grout (check one):  Neat Cement  Bentonite  Mix

Casing length: 76 feet Casing diameter: 10 inches Type of casing: PVC

Screen length: 40 feet Screen diameter: 10 inches Type of screen: PVC

Screen slot size: .050 inches Setting depth: From 74 feet to 113 feet

Type of completion (check all applicable):  Gravel packed  Underreamed  Open hole  Natural Development  
 Other (describe): \_\_\_\_\_

Top of lap pipe or reduction in casing: \_\_\_\_\_ Feet

*If telescoped or more than one screen, describe on next page*

RECEIVED

JUN 05 2013

Form: OLWR-SWR-1A (4/13)

BY: OLWR



B 319

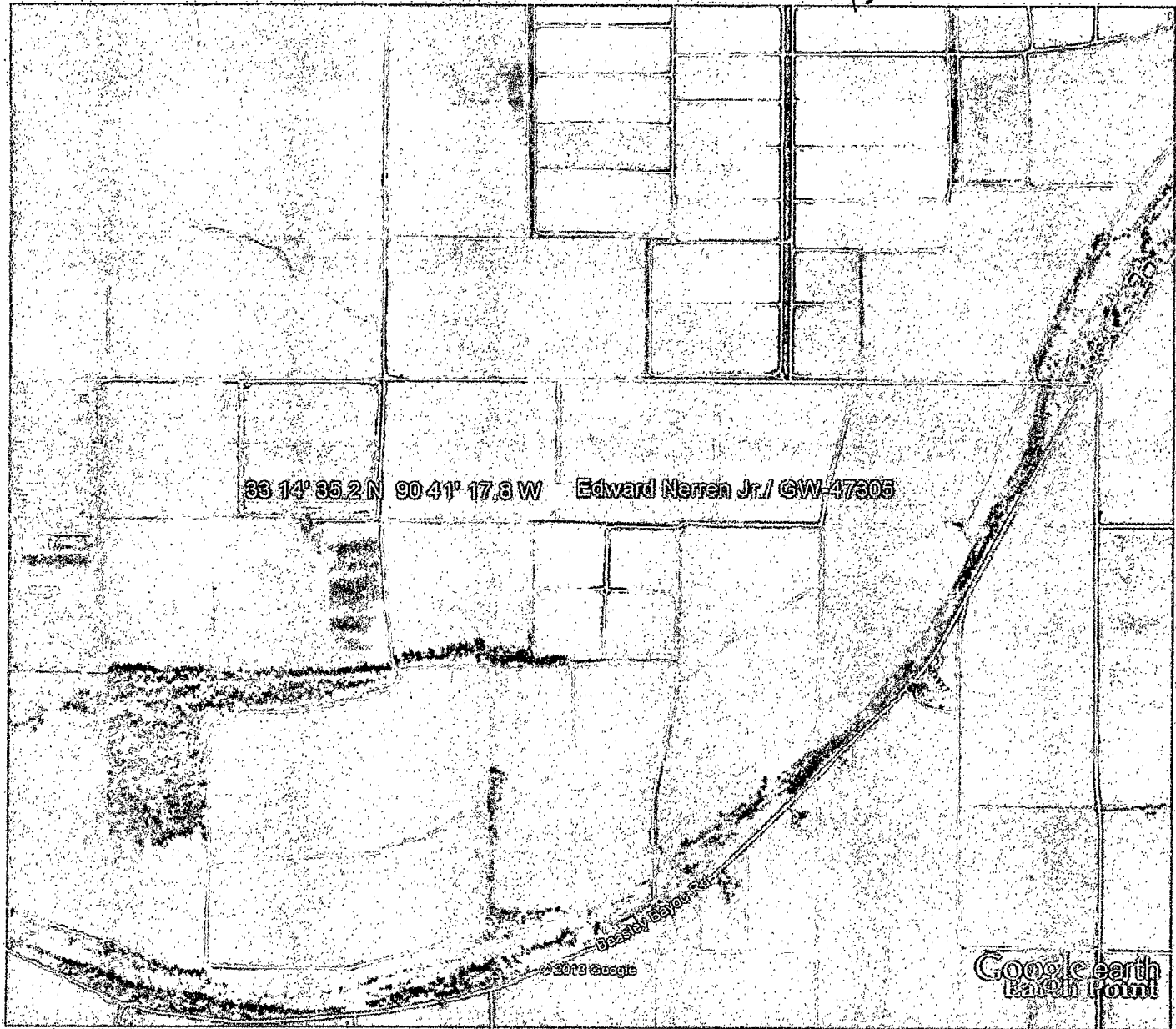

Google earth

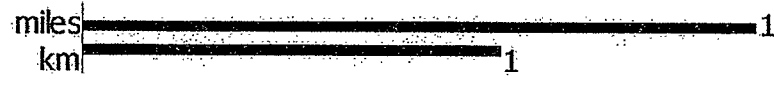

RECEIVED  
'JUN 05 2013  
BY: OLWR



B319

**Yazoo Mississippi Delta Joint Water Management District**

May 22, 2013

Edward Nerren Jr.  
Nerren & Son  
4802 Beasley Bayou Road  
Isola, MS 38754

**RE: Well Construction / Authorization to drill**

**Permit No: GW-47305**

Dear Mr. Nerren:

This authorization letter is for the construction of a new well that is to be drilled in the Mississippi River Valley Alluvial Aquifer. Your application has been received and is currently being processed.

**Location: SE1/4 of the SW1/4 Section 11 Township 16N Range 05W County Humphreys  
Latitude: 33 14 35 Longitude: 90 41 17**

A copy of this notice or a water use permit must be attached to the State Well Report submitted by your driller. This report is a requirement of the State Well Drillers Regulation. A copy of this report must be mail or faxed to YMD Joint Water Management District.

All application must meet the Mississippi Department of Environmental Quality rules and regulations. If no adverse comments are received the application will then be presented to the Mississippi Department of Environmental Quality State Permit Board for approval.

If you have any questions please call our office at 662/686-7712.

Sincerely,

*Dillard Melton Jr.*

Dillard Melton Jr.  
Permitting Director

RECEIVED

JUN 05 2013

BY: OLWR