

STATE WELL REPORT

Part 1

Driller's Log

Mississippi Department of Environmental Quality
Office of Land and Water Resources
P.O. Box 2309
Jackson, MS 39225-2309
(601)961-5210
(601)360-0535 (fax)

For Office Use Only:

Well #: J97
Aquifer: _____
E-Log #: _____

County: Holmes
Permit #: GW-47120
Driller: Willie Bryant
Date drilling completed: 7-29-13

State Law requires that this report be prepared by the license holder responsible for the work and filed with the Department at the above address within 30 days of completion of drilling of the well or borehole.

Well Owner Information <small>(Landowner if borehole is not for a water well)</small>	Well or Borehole Location
Owner Name: <u>Edmond Clark</u>	Latitude: <u>33° 07.53' N</u> Longitude: <u>90° 17.11' W</u> <u>33-07-53</u> <u>90-17-11</u>
Mailing Address: <u>Edmond Clark Farms</u> <u>2029 Marcella Rd.</u>	Method of Lat/Long (check one): Conventional Survey _____ USGS quad _____, Hand-held GPS <input checked="" type="checkbox"/> , Survey-grade GPS _____
<u>Belzoni</u> <u>MS</u> <u>39038</u>	<u>NW 1/4 SE 1/4, Sec 22 T 15 N R 1 W</u>
City State Zip Code	<u>9</u> Miles <u>SE</u> of <u>Tchula</u> (Distance) (Direction) (Nearest Town)
Telephone No. <u>(662) 336-6329</u>	

Well / Borehole Data
Date drilling started: <u>7-29-13</u> Date drilling completed: <u>7-29-13</u> Hole depth: <u>112'</u> Hole diameter: <u>12 3/4"</u>
Location of the source of any surface water used for drilling: <u>Nearby ditch</u>
Method of dosing and volume of Chlorine used in drilling and development: <u>-0-</u>
Logs run (circle all applicable): <input checked="" type="checkbox"/> No log run <input type="checkbox"/> Electric <input type="checkbox"/> Gamma Ray <input type="checkbox"/> Density <input type="checkbox"/> Sonic <input type="checkbox"/> Neutron Other: _____
Name of organization running log(s): _____
Purpose of borehole (circle one): <input checked="" type="checkbox"/> Water Well <input type="checkbox"/> Geotechnical/Geological Investigation <input type="checkbox"/> Ground Source Heat Pump <input type="checkbox"/> Seismic Survey Other (describe) _____
<i>If drilling is not related to water well construction, skip the remainder of this block</i>
Purpose of Well (circle all applicable): Home Industrial Public Supply <input checked="" type="checkbox"/> Irrigation Fish Culture
Other (describe): _____
If a flowing well, method of flow regulation: Valve _____ Other (describe) _____
Static Water Level: <u>12</u> feet [above or <input checked="" type="checkbox"/> below] land surface Date measured: _____ <small>(circle one)</small>
Method of measurement (circle one): Steel tape Electric tape Air line Other (describe): _____
Well depth: <u>112</u> Well grouted to a depth of: <u>10</u> feet Type of grout (circle one): Neat Cement <input checked="" type="checkbox"/> Bentonite Mix
Casing length: <u>72</u> feet Casing diameter: <u>6</u> inches Type of casing: <u>PVC</u>
Screen length: <u>40</u> feet Screen diameter: <u>6</u> inches Type of screen: <u>PVC slotted</u>
Screen slot size: <u>0.032</u> inches Setting depth: From <u>72</u> feet to <u>112</u> feet
Type of completion (circle all applicable): <input checked="" type="checkbox"/> Gravel packed <input type="checkbox"/> Underreamed <input type="checkbox"/> Open hole <input type="checkbox"/> Natural Development
Other (describe): _____
Top of lap pipe or reduction in casing: <u>-0-</u> feet
<i>If telescoped or more than one screen, describe on next page</i>

RECEIVED
SEP 04 2013
BY: OLWR

County: Holmes
Permit #: GW-47120

For Office Use Only:
Well #: J97

The sketch below only required for water wells
If well telescopes, show depths on sketch.

Ground Level →

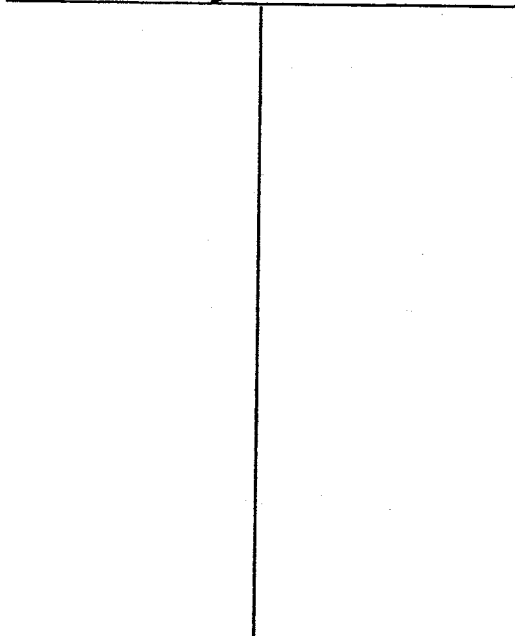

Description of formations encountered must be provided for all wells and boreholes, unless specifically exempted by regulations

Description of Formations Encountered	From (depth)	To (depth)
Clay	Ground level	10
Brown Sand	10	40
Med Sand	40	60
Coarse Sand	60	112

If more than one screen, show location of each on sketch

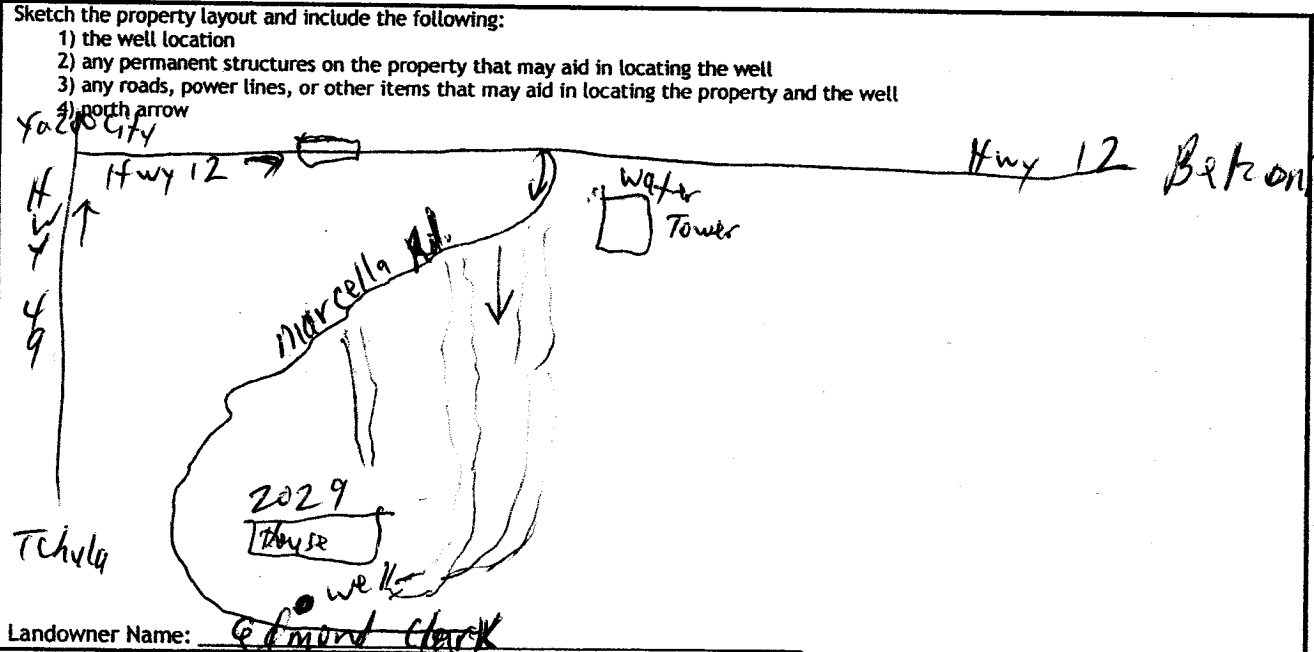

Landowner Name: Edmond Clark

I HEREBY CERTIFY that the well/borehole was drilled, constructed, and completed in accordance with all applicable requirements of the Mississippi Department of Environmental Quality and the Mississippi Department of Health regulations, if applicable, and state laws.

Willie L. Bryant 0-639 8-27-13 Willie L. Bryant
Print Name of Responsible Licensee and License No. Date Signature of Licensee

STATE WELL REPORT

Part 2

Pump Installer's Completion Report
 Mississippi Department of Environmental Quality
 Office of Land and Water Resources
 P.O. Box 2309
 Jackson, MS 39225-2309
 (601)961-5210
 (601) 360-0535 (fax)

For Office Use Only:

Well #: 597

Aquifer: _____

County: Holmes
 Permit #: GW-47120
 Driller: Willie Bryant
 Date completed: 8-24-13
Copy information from block on Part 1

This part of the report must be completed by a licensed water well contractor or a licensed pump installer. A copy of Part 1 of the report must be attached and both parts filed with the Department at the above address within 30 days of well completion.

Well Owner Information	Well Location
Owner Name: <u>Edmond Clark</u>	Latitude: <u>33° 07.53' N</u> Longitude: <u>90° 17.11' W</u>
Mailing Address: <u>Edmond Clark Farms</u> <u>2029 Marcella Rd.</u>	Method of Lat/Long (check one): Conventional Survey _____, USGS quad _____, Hand-held GPS <input checked="" type="checkbox"/> , Survey-grade GPS _____
<u>Belzoni</u> <u>MS</u> <u>39038</u>	<u>NW 1/4 SE 1/4, Sec 22 T.15N R.1W</u>
City State Zip Code	<u>9</u> Miles <u>SE</u> of <u>Tchula</u>
Telephone No. <u>662 336-6329</u>	(Distance) (Direction) (Nearest Town)

Pump Type (circle one)

Submersible Turbine Air Lift Centrifugal Flowing Well Jet Piston Rotary Other (describe): _____

Date Pump Installed: 8-10-13 Rated Pump Capacity: 150 Gallons Per Minute

Is This Pump (circle one): New Repaired Replacement

Power Type (circle one)

Electric Diesel Gasoline Natural Gas Tractor PTO Windmill Other (describe): _____

Horse Power Rating of Motor: 10 Setting Depth: 60 feet Number of Stages: 5

Pump Test Data for Non Flowing Well

Date Well Tested: 8-24-13 Duration of Pump Test (minimum 4 hours): 4 hours

Static Water Level (A): 12 Feet Below Land Surface Pumping Water Level (B): 28 Feet Below Land Surface

Drawdown [(B) - (A)]: 16 Feet Below Land Surface Test Pumping Rate: 160 Gallons Per Minute

Method of measurement (circle one): Steel tape Electric tape Air line Other (describe): Sonic Water Levelmeter

Pump Test Data for Flowing Well

Measured shut in head: _____ feet.

Well yielded 160 GPM with a drawdown of 16 feet after 4 hours of pumping

Meter Installation

Meter Manufacturer: _____ Meter Serial Number: RECEIVED

Meter Model Number/Name: _____ Type of Meter: _____

Totalizer Register Unit and Multiplier Factor (AF x .001, gal x 1000, etc): _____

Installation Date: _____ Meter installed by: BY OLWR

Is This Meter (circle one): New Repaired Replacement

Important: By submitting the above information you are certifying that this meter was installed to manufacturer standards. For agricultural wells, a list of approved meters is on the MDEQ website.

I HEREBY CERTIFY that the above statements are true to the best of my knowledge.

Willie L. Bryant 0-639 8-27-13 Willie L. Bryant
 Print Name of Pump Installer and License No. (if applicable) Date Signature of Pump Installer