

County: Holmes  
 Permit #: GW-49266  
 Driller: Irrigation Equipment, Inc.  
 Date drilling completed: 5-23-2016

**STATE WELL REPORT**  
**Part 1**  
**Driller's Log**  
 Mississippi Department of Environmental Quality  
 Office of Land and Water Resources  
 P.O. Box 2309  
 Jackson, MS 39225-2309  
 (601) 961-5210  
 (601) 360-0535 (fax)

**For Office Use Only:**

Well #: B761  
 Aquifer: \_\_\_\_\_  
 E-Log #: \_\_\_\_\_

*State Law requires that this report be prepared by the license holder responsible for the work and filed with the Department at the above address within 30 days of completion of drilling of the well or borehole.*

Well Owner Information <i>(Landowner if borehole is not for a water well)</i>	Well or Borehole Location
Owner Name: <u>MTB Land LLC</u>	Latitude: <u>33 20' 2.9"</u> Longitude: <u>90 10' 58.9"</u>
Mailing Address: <u>Attn: Lannie B Phillee</u>	Method of Lat/Long (check one): <input type="checkbox"/> Conventional Survey,
<u>P.O. Box 32</u>	<input type="checkbox"/> USGS quad, <input checked="" type="checkbox"/> Hand-held GPS, <input type="checkbox"/> Survey-grade GPS
<u>Mer Rouge</u> <u>LA</u> <u>71261</u>	
City                                      State                                      Zip code	<u>NE</u> 1/4 <u>SE</u> 1/4, Sec <u>15</u> T <u>17N</u> R <u>1E</u>
Telephone No.    (    )    -    _____	<u>SE</u> <u>SW</u>
	_____ Miles <u>East</u> of <u>Cruger</u>
	<i>(Distance)</i> <i>(Direction)</i> <i>(Nearest Town)</i>

**Well / Borehole Data**

Date drilling started: 5-23-16      Date drilling completed: 5-23-16      Hole depth: 127'      Hole diameter: 24"

Location of the source of any surface water used for drilling: Surface Water

Method of dosing and volume of Chlorine used in drilling and development: 50 PPM

Logs run (check all applicable):  No log run     Electric     Gamma Ray     Density     Sonic     Neutron     Other: \_\_\_\_\_

Name of organization running log(s): \_\_\_\_\_

Purpose of borehole (check one):  Water Well     Geotechnical/Geological Investigation     Ground Source Heat Pump  
 Seismic Survey     Other (*describe*) \_\_\_\_\_

*If drilling is not related to water well construction, skip the remainder of this block*

Purpose of Well (*check all applicable*):  Home     Industrial     Public Supply     Irrigation     Fish Culture  
 Other (*describe*): \_\_\_\_\_

If a flowing well, method of flow regulation: Valve \_\_\_\_\_ Other (*describe*) \_\_\_\_\_

Static Water Level: 20 feet [ above or  below] land surface      Date measured: 5-24-16  
*(check one)*

Method of Measurement (check one)  Steel tape     Electric tape     Air line     Other: (*describe*) \_\_\_\_\_

Well depth: 127'      Well grouted to a depth of: 10 feet      Type of grout (*check one*):  Neat Cement     Bentonite     Mix

Casing length: 87 feet      Casing diameter: 16 inches      Type of casing: PVC

Screen length: 40 feet      Screen diameter: 16 inches      Type of screen: PVC

Screen slot size: .050 inches      Setting depth: From 88 feet to 127 feet

Type of completion (check all applicable):  Gravel packed     Underreamed     Open hole     Natural Development  
 Other (*describe*): \_\_\_\_\_

Top of lap pipe or reduction in casing: \_\_\_\_\_ Feet

*If telescoped or more than one screen, describe on next page*

**Received**  
**JUL 08 2016**  
**By OLWR**

Form: OLWR-SWR-1A (4/13)



County: Holmes  
 Permit #: GW-49266  
 Driller: Irrigation Equipment, Inc.  
 Date drilling completed: 5-23-16  
*Copy information from block on Part 1*

**STATE WELL REPORT**  
**Part 2**  
**Pump Installer's Completion Report**  
 Mississippi Department of Environmental Quality  
 Office of Land and Water Resources  
 P.O. Box 2309  
 Jackson, MS 39225-2309  
 (601) 961-5210  
 (601) 360-0535 (fax)

**For Office Use Only:**

Well #: B61  
 Aquifer: \_\_\_\_\_

*This part of the report must be completed by a licensed water well contractor or a licensed pump installer. A copy of Part 1 of the report must be attached and both parts filed with the Department at the above address within 30 days of well completion.*

Well Owner Information	Well Location
Owner Name: <u>MTB Land LLC</u>	Latitude: <u>33 20' 2.9"</u> Longitude: <u>90 10' 58.9"</u>
Mailing Address: <u>Attn: Lannie B Philley</u>	Method of Lat/Long (check one): <input type="checkbox"/> Conventional Survey,
<u>P.O. Box 32</u>	<input type="checkbox"/> USGS quad, <input checked="" type="checkbox"/> Hand-held GPS, <input type="checkbox"/> Survey-grade GPS
<u>Mer Rouge</u> <u>LA</u> <u>71261</u>	<u>SE 1/4 SW 1/4, Sec 15 T 17N R 1E</u>
City State Zip code	<u>                    </u> Miles <u>East</u> of <u>Cruger</u>
Telephone No. <u>( ) -</u>	<i>(Distance) (Direction) (Nearest Town)</i>

**Pump Type (check one)**

Submersible  Turbine  Air Lift  Centrifugal  Flowing Well  Jet  Piston  Rotary  Other (describe): \_\_\_\_\_

Date Pump Installed 5-24-16 Rated Pump Capacity: 2100+/- Gallons Per Minute

Is This Pump (check one):  New  Repaired  Replacement

**Power Type (check one)**

Electric  Diesel  Gasoline  Natural Gas  Tractor PTO  Windmill  Other (describe): \_\_\_\_\_

Horse Power Rating of Motor: 100 Setting Depth: 70 feet Number of Stages: 1

**Pump Test Data for Non Flowing Well**

Date Well Tested: \_\_\_\_\_ Duration of Pump Test (minimum 4 hours): \_\_\_\_\_ Hours

Static Water Level (A): \_\_\_\_\_ Feet Below Land Surface Pumping Water Level (B): \_\_\_\_\_ Feet Below Land Surface

Drawdown [(B) - (A)]: \_\_\_\_\_ Feet Below Land Surface Test Pumping Rate: \_\_\_\_\_ Gallons Per Minute

Method of measurement (check one):  Steel tape  Electric tape  Air line  Other (describe): \_\_\_\_\_

**Pump Test Data for Flowing Well**

Measured shut in head: \_\_\_\_\_ Feet

Well yielded \_\_\_\_\_ GPM with a drawdown of \_\_\_\_\_ feet after \_\_\_\_\_ hours of pumping

**Meter Installation**

Meter Manufacturer: \_\_\_\_\_ Meter Serial Number: \_\_\_\_\_

Meter Model Number/Name: \_\_\_\_\_ Type of Meter: \_\_\_\_\_

Totalizer Register Unit and Multiplier Factor (AF x .001, gal x 1000, etc): \_\_\_\_\_

Installation Date: \_\_\_\_\_ Meter installed by: \_\_\_\_\_

Is This Meter (check one):  New  Repaired  Replacement

*Important: By submitting the above information you are certifying that this meter was installed to manufacturer standards. For agricultural wells, a list of approved meters is on the MDEQ website.*

I HEREBY CERTIFY that the above statements are true to the best of my knowledge.

0695 6-30-16  
 Print Name of Pump Installer and License No. (if applicable) Date

  
 Signature of Pump Installer  
 Form: OLWR-100-1B (2/13)

**Received**  
**JUL 08 2016**  
**By OLWR**

**STATE OF MISSISSIPPI**

B 61

Department of Environmental Quality

Office of Land and Water Resources

P. O. Box 2309

Jackson, Mississippi 39225

**PERMIT**

**TO DIVERT OR WITHDRAW FOR BENEFICIAL USE THE PUBLIC WATERS**

This permit is issued to the landowner named below in accordance with the provisions of the Mississippi Water Law, Mississippi Code Section 51-3-1, et seq. (1972, as amended), and the regulations and standards as promulgated thereunder. Whether or not specifically named in this permit or in the application for this permit, any water from the diversion/withdrawal point described below shall be such in compliance with the provisions of this permit. Neither this permit, nor any authority conferred hereby, may be sold, conveyed, encumbered, assigned, or otherwise aliened, for any period of time or under any conditions whatsoever. This permit may not be modified, transferred or revoked without prior action by the Permit Board. Any attempt to modify, transfer or revoke this permit, or to take any other action on this permit, shall be invalid and unenforceable and may result in immediate revocation or suspension of this permit. The holder of this permit shall at all times be responsible for adherence to the terms and conditions of this permit. An agreement between the permit holder and any other party shall affect the obligations and liabilities of the permit holder. Water use under this permit is allowed only when the streamflow, lake level elevation, or static ground water level (whichever if any, is applicable) is above the established minimum pursuant to Mississippi Code Section 51-3-7. Authorization is hereby granted to divert/withdraw water for the beneficial use designated herein, and for no other purpose, subject to the following terms, conditions, and limitations:

Permit Number: MS-OW-49268

Landowner Name: MFB LAND LLC

Landowner Address: APOE LAMIE B PHILLEY

PO BOX 52

MER Rouge

LA 71261

Source Of Water: MISSISSIPPI RIVER VALLEY BELOW THE BOULEVARD

Beneficial Use: IRRIGATION

Diversion/Withdrawal Location: SE 1/4 of the NE 1/4

Section: 15 Township: 7N

Range: 01E

County: EASTOPR

Quad: CRUCER

Maximum Volume: 150 Acre-Foot/Year equivalent 1.336 Billion Gallons/Day

Maximum Rate: 2500 Gallons/Minute

Applicant Name: MFB LAND LLC

Applicant Address: APOE LAMIE B PHILLEY

PO BOX 52

MER Rouge

LA 71261

Date Permit Issued: 03/03/2016

Date Permit Expires: 03/03/2021

Date Permit Modified:

Date Permit Re-issued:

This permit shall be closed until and void if construction has not begun within one (1) year of permit issue date.

SEE ATTACHMENT 1, WHICH IS HEREBY DECLARED TO BE PART OF THIS PERMIT.

GENERAL TERMS AND CONDITIONS N

Received

JUL 08 2016

Gary C. Elward, Executive Director  
Mississippi Department of Environmental Quality

By OLWR

B 61

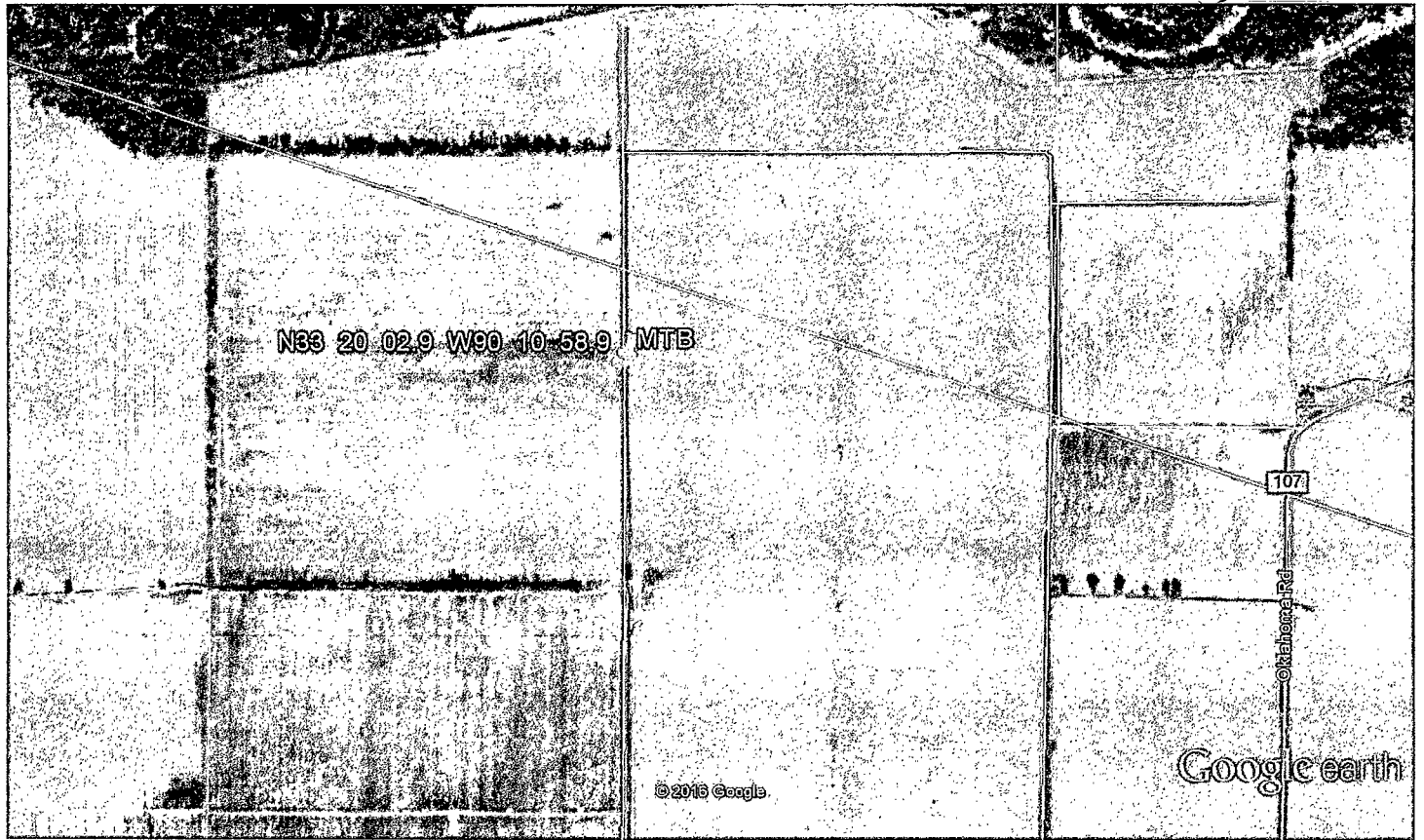

Google earth

feet  
km



Received

JUL 08 2016

By OLWR