

# State Well Report

## Part 1 - Driller's Log

Mississippi Department of Environmental Quality  
 Office of Land and Water Resources  
 P.O. Box 10631  
 Jackson, MS 39289-0631  
 (601)961-5210  
 (601)354-6938 (fax)

County: Holmes  
 Permit #: 61042739  
 Driller: Charles M. Nichols  
 Date drilling completed: 6-3-08

For Office Use Only:  
 Aquifer: \_\_\_\_\_  
 Well #: B-49  
 L. S. Elevation: \_\_\_\_\_  
 E-log #: \_\_\_\_\_

State Law requires that this report be prepared by the license holder responsible for the work and filed with the Department at the above address within 30 days of completion of drilling of the well or borehole.

<p><b>Information on Well Owner</b>          (Landowner if borehole is not for a water well)</p> <p>Owner Name: <u>MARILYN WALKER</u>          Mailing Address: <u>318 BALLEVARD</u>  <u>LEXINGTON MS 39095</u>          City State Zip Code          Telephone No. ( ) _____</p>	<p><b>Well or Borehole Location</b></p> <p>Latitude: <u>33° 17.5' N</u> Longitude: <u>090° 11.5' W</u>          Method of Lat/Long (circle one): Conventional Survey, <u>50</u>          USGS quad: <u>Hand-held GPS</u> Survey-grade GPS  <u>SW NW</u> Sec <u>34</u> Twn <u>17</u> Rng <u>1E</u>          Distance Direction Nearest Town  <u>3</u> Miles <u>SE</u> of <u>Gruger</u></p>
---	---

**Well / Borehole Data**

Date drilling started: 6-3-08 Date drilling completed: 6-3-08 Hole depth: 120 Hole diameter: 26

Location of the source of any surface water used for drilling: Farm Pond  
 Method of dosing and volume of Chlorine used in drilling and development: HTH

Logs run (circle all applicable): No log run Electric Gamma Ray Density Sonic Neutron Other: \_\_\_\_\_  
 Name of organization running log(s): \_\_\_\_\_

Purpose of borehole (check one): Water Well   Geotechnical/Geological Investigation  Ground Source Heat Pump   
 Seismic Survey  Other (describe) \_\_\_\_\_  
*If drilling is not related to water well construction, skip the remainder of this block*

Purpose of Well (check one): Home  Industrial  Public Supply  Irrigation  Fish Culture  Other: \_\_\_\_\_

If a flowing well, method of flow regulation: Valve \_\_\_\_\_ Other (describe) \_\_\_\_\_

Static Water Level: 7.4 feet above of below (circle one) land surface Date measured: 6-3-08

Method of Measurement (circle one) steel tape electric tape air line other: \_\_\_\_\_

Well depth: 120 Well grouted to a depth of 10 feet Type of grout (circle one): Neat Cement Bentonite Mix

Casing length: 80 feet Casing diameter: 16 inches Type of casing: pvc

Screen length: 40 feet Screen diameter: 16 inches Type of screen: pvc

Screen slot size: .035 inches Setting depth: From 80 feet to 120 feet

Type of completion (circle all applicable): Gravel packed Underreamed Telescoped Open hole Natural Development  
 Other (describe): \_\_\_\_\_

Top of lap pipe or reduction in casing: \_\_\_\_\_ feet. *If telescoped or more than one screen, describe on next page*

Delta Irrigation + Supply

Form: OLWR-SWR-1A

RECEIVED  
 JUL 28 2008  
 BY: OLWR

02042739

B-49

The sketch below only required for water wells

Description of formations encountered must be provided for all wells and boreholes, unless specifically exempted by regulations

If well telescopes, show depths on sketch.

Ground Level 

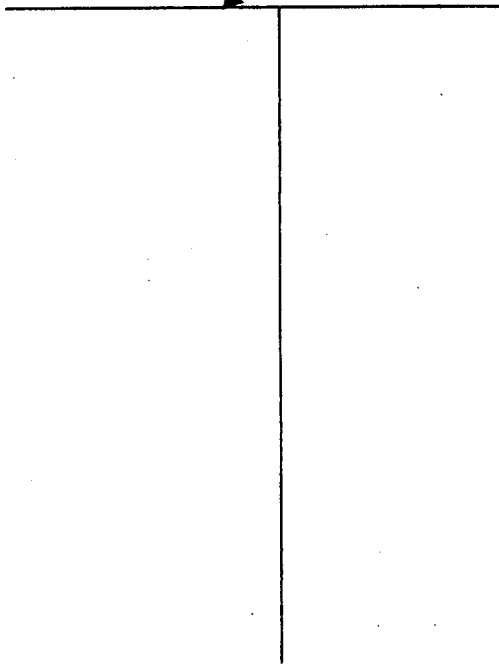

Description of Formations Encountered	From (depth)	To (depth)
Clay	Ground Level	75
Coarse sand + p-gravel	75	120

If more than one screen, show location of each on sketch

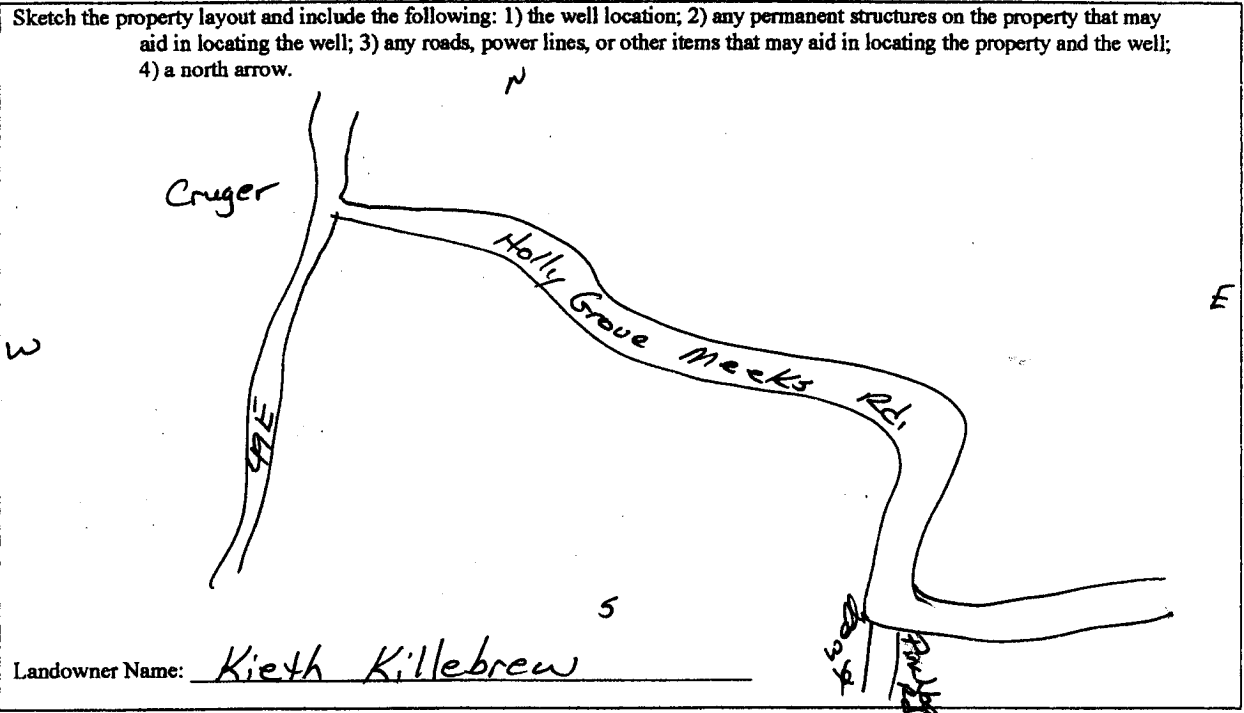

Form: OLWR-SWR-1A

I certify that the well/borehole was drilled, constructed, and completed in accordance with all applicable requirements of the Mississippi Department of Environmental Quality and the Mississippi Department of Health regulations, if applicable, and state laws.

Charles M. Nichols 0-0667 7-21-08  
Print Name of Responsible Licensee and License No. Date

  
Signature of Licensee

RECEIVED  
III 28 2008  
BY: OLWR

# STATE WELL REPORT

## Part 2

**Pump Installer's Completion Report**  
 Mississippi Department of Environmental Quality  
 Office of Land and Water Resources  
 P.O. Box 10631  
 Jackson, MS 39289-0631  
 (601)961-5210  
 (601)354-6938 (fax)

County: Holmes  
 Permit #: GW42739  
 Driller: Charles M. Nichols  
 Date completed: 6-30-08  
*Copy information from block on Part 1*

**For Office Use Only:**

Aquifer: \_\_\_\_\_  
 Well #: B-49  
 Elevation: \_\_\_\_\_

*This part of the report must be completed by a licensed water well contractor or a licensed pump installer. A copy of Part 1 of the report must be attached and both parts filed with the Department at the above address within 30 days of well completion.*

Well Owner Information	Well Location
Owner Name: <u>MARILYN WALKER</u>	Latitude: <u>33°17.541N</u> Longitude: <u>090°11.591W</u>
Mailing Address: <u>318 BOULEVARD</u>	Method of Lat/Long (check one): Conventional Survey _____
<u>Lexington Ms 39095</u>	USGS quad _____, Hand-held GPS <input checked="" type="checkbox"/> , Survey-grade GPS _____
City State Zip Code	_____ ¼ _____ ¼ Sec _____ T _____ R _____
Telephone No. ( ) _____	Distance Direction Nearest Town
	<u>3</u> Miles <u>SE</u> of <u>Cruger</u>

Pump Type Circle one	Power Type Circle one
Air Lift Jet Submersible	Diesel Engine Gasoline Engine Natural Gas
Bucket Piston <u>Turbine</u>	<u>Electric Motor</u> Hand Tractor PTO
Centrifugal Rotary Flowing Well	Windmill Other (specify): _____
Other (specify): _____	Horse Power Rating of Motor: <u>50</u>
Date Pump Installed: <u>6-30-08</u>	Setting Depth: <u>60</u> feet
Rated Pump Capacity: <u>?</u> Gallons Per Minute	Number of Stages: <u>3 stages 10 in bowl</u>

Pump Test Data	Method of Measuring Water Level Circle one
Date Well Tested: _____	Air Line Electric Measuring Line <u>Steel Tape</u>
Static Water Level (A): _____ Feet Below Land Surface	Other (specify): _____
Pumping Water Level (B): _____ Feet Below Land Surface	For flowing well, measured shut in head: _____ feet
Drawdown [(B) - (A)]: _____ Feet Below Land Surface	Well yielded _____ GPM with a drawdown of
Test Pumping Rate: _____ Gallons Per Minute	_____ feet after _____ hours of pumping
Duration of Pump Test (minimum 4 hours): _____ hours	

I HEREBY CERTIFY that the above statements are true to the best of my knowledge.

Charles M. Nichols 0-0667 Charles M. Nichols  
 Print Name of Pump Installer and License No. (if applicable) Signature of Pump Installer

Form: OLWR-SWR-1B

RECEIVED

JUL 28 2008

BY: OLWR