

County: HINDS  
 Permit #: \_\_\_\_\_  
 Driller: STEUZ GARDNER  
 Date drilling completed: 3-25-08

**State Well Report**  
**Part 1 - Driller's Log**

Mississippi Department of Environmental Quality  
 Office of Land and Water Resources  
 P.O. Box 10631  
 Jackson, MS 39289-0631  
 (601)961-5210  
 (601)354-6938 (fax)

For Office Use Only:  
 Aquifer: \_\_\_\_\_  
 Well #: Q-112  
 L. S. Elevation: \_\_\_\_\_  
 E-log #: 0-0112

*State Law requires that this report be prepared by the license holder responsible for the work and filed with the Department at the above address within 30 days of completion of drilling of the well or borehole.*

Information on Well Owner (Landowner if borehole is not for a water well)	Well or Borehole Location
Owner Name: <u>JOHN M/EL HENNY</u>	Latitude: <u>32° 13' 10N</u> Longitude: <u>90° 34' 18W</u>
Mailing Address: <u>OLD PORT GIBSON RD</u>	Method of Lat/Long (circle one): Conventional Survey, USGS quad, Hand-held GPS, Survey-grade GPS
<u>HINDS</u> MS City State Zip Code	<u>SE 1/4 NE 1/4 Sec 2 Twn 4 N Rng 4 W</u>
Telephone No. <u>(601) 529 4952</u>	Distance Direction Nearest Town <u>12</u> Miles <u>S.W.</u> of <u>RAYMOND</u> <u>PORT GIBSON RD</u>
Well / Borehole Data	
Date drilling started: <u>3/3/08</u> Date drilling completed: <u>3/25/08</u> Hole depth: <u>215'</u> Hole diameter: <u>5.750"</u>	
Location of the source of any surface water used for drilling: <u>WELL WATER</u>	
Method of dosing and volume of Chlorine used in drilling and development: _____	
Logs run (circle all applicable): No log run Electric <u>Gamma Ray</u> Density Sonic Neutron Other: _____	
Name of organization running log(s): _____	
Purpose of borehole (check one): Water Well <input checked="" type="checkbox"/> Geotechnical/Geological Investigation _____ Ground Source Heat Pump _____	
Seismic Survey _____ Other (describe) _____	
<b><i>If drilling is not related to water well construction, skip the remainder of this block</i></b>	
Purpose of Well (check one): Home <input checked="" type="checkbox"/> Industrial _____ Public Supply _____ Irrigation _____ Fish Culture _____ Other: _____	
If a flowing well, method of flow regulation: Valve _____ Other (describe) _____	
Static Water Level: <u>30</u> feet above or below (circle one) land surface Date measured: <u>3-29-08</u>	
Method of Measurement (circle one) steel tape <u>electric tape</u> air line other: _____	
Well depth: <u>194</u> Well grouted to a depth of <u>21'</u> feet Type of grout (circle one): <u>Neat Cement</u> Bentonite Mix	
Casing length: <u>174</u> feet Casing diameter: <u>4</u> inches Type of casing: <u>P.V.C.</u>	
Screen length: <u>20'</u> feet Screen diameter: <u>4"</u> inches Type of screen: <u>P.V.C.</u>	
Screen slot size: <u>10</u> inches Setting depth: From <u>174</u> feet to <u>194</u> feet	
Type of completion (circle all applicable): Gravel packed Underreamed Telescoped Open hole Natural Development	
Other (describe): <u>BACK WASH VALVE</u>	
Top of lap pipe or reduction in casing: _____ feet. <i>If telescoped or more than one screen, describe on next page</i>	

Form: OLWR-SWR-1A

RECEIVED  
 APR 21 2008  
 BY: OLWR

The sketch below only required for water wells

If well telescopes, show depths on sketch.

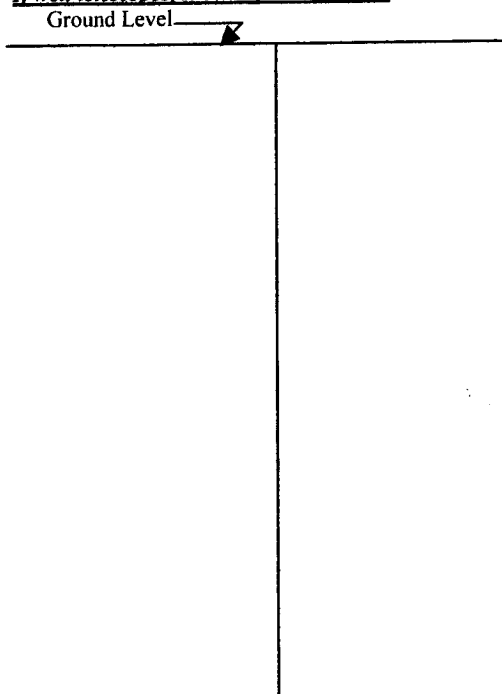

Description of formations encountered must be provided for all wells and boreholes, unless specifically exempted by regulations

Description of Formations Encountered	From (depth)	To (depth)
	Ground Level	
Buckshot Shale	0	30'
CLAY	30	52
ROCK	52	54
SHALL SAND-CLAY	54	100
SAND BLUE-CLAY	100	120
ROCK CLAY SAND	130	160
ROCK-	160	170
SAND	170	194
SAND - YELLOW CLAY	194	210

If more than one screen, show location of each on sketch

Sketch the property layout and include the following: 1) the well location; 2) any permanent structures on the property that may aid in locating the well; 3) any roads, power lines, or other items that may aid in locating the property and the well; 4) a north arrow.

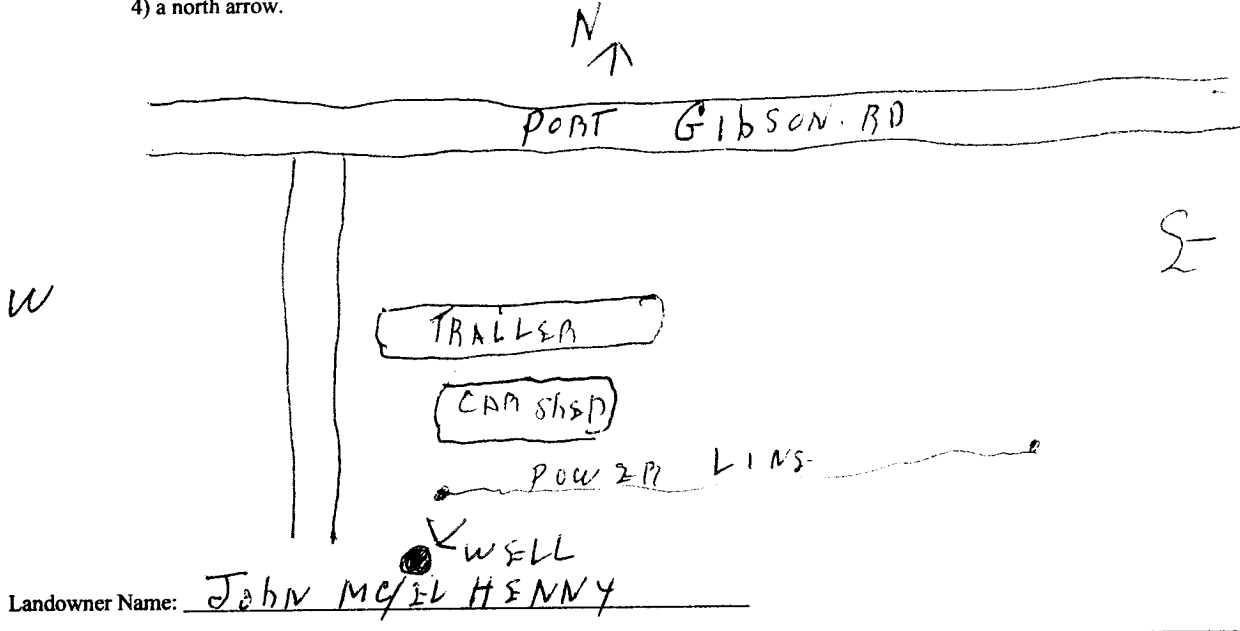

Form: OLWR-SWR-1A

I certify that the well/borehole was drilled, constructed, and completed in accordance with all applicable requirements of the Mississippi Department of Environmental Quality and the Mississippi Department of Health regulations, if applicable, and state laws.

STEPHEN GARDNER 4/21/08

Print Name of Responsible Licensee and License No. 245-7

Date

*Stephen M Gardner*

Signature of Licensee

RECEIVED

APR 21 2008

BY: OLWR

# STATE WELL REPORT

## Part 2

**Pump Installer's Completion Report**  
 Mississippi Department of Environmental Quality  
 Office of Land and Water Resources  
 P.O. Box 10631  
 Jackson, MS 39289-0631  
 (601)961-5210  
 (601)354-6938 (fax)

County: HINDS  
 Permit #: \_\_\_\_\_  
 Driller: STEVE GARDNER  
 Date completed: 3-25-08  
*Copy information from block on Part 1*

**For Office Use Only:**

Aquifer: \_\_\_\_\_  
 Well #: \_\_\_\_\_  
 Elevation: \_\_\_\_\_

*This part of the report must be completed by a licensed water well contractor or a licensed pump installer. A copy of Part 1 of the report must be attached and both parts filed with the Department at the above address within 30 days of well completion.*

Well Owner Information	Well Location
Owner Name: <u>JOHN McJEL HENNY</u>	Latitude: <u>32-13-10N</u> Longitude: <u>90-34-18W</u>
Mailing Address: <u>OLD PORT GIBSON RD</u>	Method of Lat/Long (check one): Conventional Survey _____
<u>HINDS</u> <u>MS</u> City                  State                  Zip Code	USGS quad _____, Hand-held GPS _____, Survey-grade GPS _____
Telephone No. <u>(601) 529-4952</u>	_____ 1/4 _____ 1/4 Sec <u>2</u> <u>T4N R4W</u>
	Distance          Direction          Nearest Town
	<u>12</u> Miles <u>SW</u> of <u>RAYMOND</u>
	<u>PORT GIBSON RD</u>

Pump Type Circle one	Power Type Circle one
Air Lift                  Jet <u>Submersible</u>	Diesel Engine          Gasoline Engine          Natural Gas
Bucket                  Piston                  Turbine	<u>Electric Motor</u> Hand                  Tractor PTO
Centrifugal <u>Rotary</u> Flowing Well	Windmill                  Other (specify): _____
Other (specify): _____	Horse Power Rating of Motor: <u>3/4</u>
Date Pump Installed: <u>4-8-08</u>	Setting Depth: <u>120</u> feet
Rated Pump Capacity: <u>10</u> Gallons Per Minute	Number of Stages: <u>4</u>

Pump Test Data	Method of Measuring Water Level Circle one
Date Well Tested: <u>4-8-08</u>	Air Line <u>Electric Measuring Line</u> Steel Tape
Static Water Level (A): <u>30</u> Feet Below Land Surface	Other (specify): _____
Pumping Water Level (B): <u>120</u> Feet Below Land Surface	For flowing well, measured shut in head: _____ feet
Drawdown [(B) - (A)]: <u>100'</u> Feet Below Land Surface	Well yielded <u>20</u> GPM with a drawdown of
Test Pumping Rate: <u>10</u> Gallons Per Minute	<u>50'</u> feet after <u>12</u> hours of pumping
Duration of Pump Test (minimum 4 hours): <u>12</u> hours	

I HEREBY CERTIFY that the above statements are true to the best of my knowledge.

STEPHEN GARDNER                                  Stephen M Gardner  
 Print Name of Pump Installer and License No. (if applicable)                  Signature of Pump Installer

**RECEIVED**  
 Form: OLWR-SWR-1B

APR 21 2008  
 BY: OLWR