

STATE WELL REPORT

Part 1

Driller's Log

Mississippi Department of Environmental Quality
Office of Land and Water Resources
P.O. Box 2309
Jackson, MS 39225-2309
(601)961-5210
(601)360-0535 (fax)

54

County: HARRISON
Permit #:
Driller: M. SCHWITZ
Date drilling completed: 9/5/16

For Office Use Only:
Well #: K 459
Aquifer:
E-Log #:

State Law requires that this report be prepared by the license holder responsible for the work and filed with the Department at the above address within 30 days of completion of drilling of the well or borehole.

Well Owner Information (Landowner if borehole is not for a water well)
Owner Name: CONJUNCTION
Mailing Address: 1011 STABLEWOOD CIR
PASS CHRISTIAN, MS
City State Zip Code
Telephone No.
Well or Borehole Location
Latitude: 30 23 39.77 Longitude: 89 14 21.22
Method of Lat/Long (check one): Conventional Survey
USGS quad, Hand-held GPS X, Survey-grade GPS
1R 1/4 1R 1/4, Sec 31 T 7S R 12W
2.4 Miles South of I-10
(Distance) (Direction) (Nearest Town)

Well / Borehole Data
Date drilling started: 9/5/16 Date drilling completed: 9/5/16 Hole depth: 260 Hole diameter: 5"
Location of the source of any surface water used for drilling:
Method of dosing and volume of Chlorine used in drilling and development:
Logs run (circle all applicable): No log run Electric Gamma Ray Density Sonic Neutron Other:
Name of organization running log(s):
Purpose of borehole (circle one): Water Well Geotechnical/Geological Investigation Ground Source Heat Pump
Seismic Survey Other (describe)
If drilling is not related to water well construction, skip the remainder of this block

Purpose of Well (circle all applicable): Home Industrial Public Supply Irrigation Fish Culture
Other (describe):
If a flowing well, method of flow regulation: Valve Other (describe)
Static Water Level: 30 feet [above or (below) land surface] Date measured: 9/5/16
Method of measurement (circle one): Steel tape Electric tape Air line Other (describe):
Well depth: 260 Well grouted to a depth of: 10 feet Type of grout (circle one): Neat Cement Bentonite Mix
Casing length: 240 feet Casing diameter: 3 inches Type of casing: PVC
Screen length: 20 feet Screen diameter: 2 inches Type of screen: PVC
Screen slot size: 006 inches Setting depth: From 241 feet to 260 feet
Type of completion (circle all applicable): Gravel packed Underreamed Open hole Natural Development
Other (describe):
Top of lap pipe or reduction in casing: feet
If telescoped or more than one screen, describe on next page

Received

SEP 26 2016

Form: OLWR-SWR-1A (4/13)

By OLWR

County: HARRISON
 Permit #: _____

For Office Use Only:
 Well #: K 459

The sketch below only required for water wells

If well telescopes, show depths on sketch.

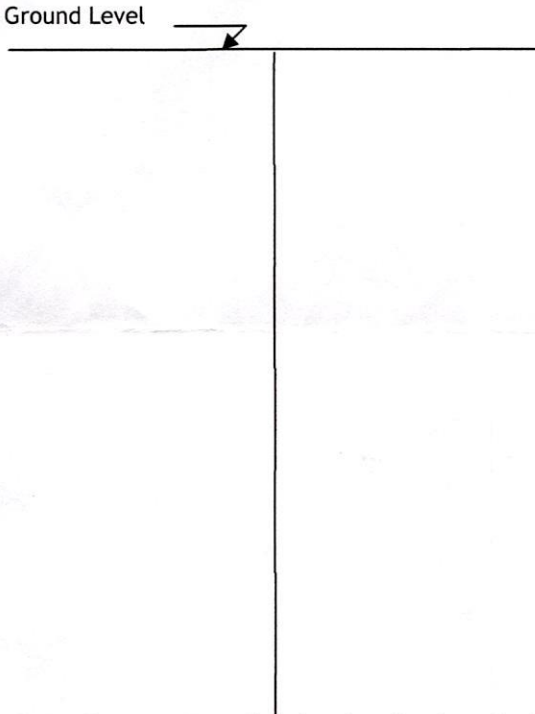

Description of formations encountered must be provided for all wells and boreholes, unless specifically exempted by regulations

Description of Formations Encountered	From (depth)	To (depth)
CLAY	Ground level	3
		4
SAND		
CLAY	14	22
SAND	22	28

If more than one screen, show location of each on sketch

Sketch the property layout and include the following:

- 1) the well location
- 2) any permanent structures on the property that may aid in locating the well
- 3) any roads, power lines, or other items that may aid in locating the property and the well
- 4) north arrow

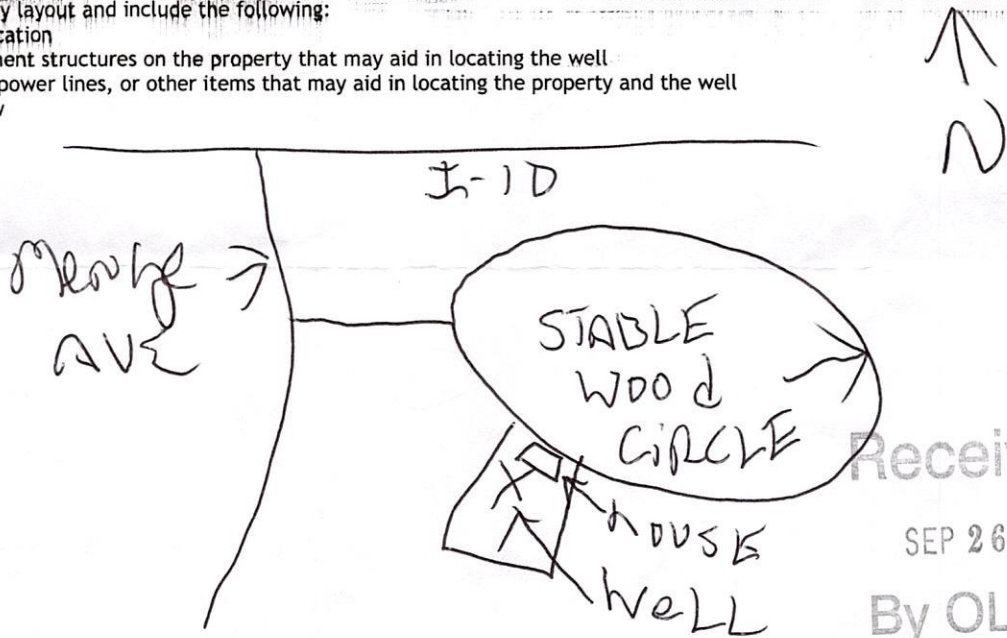

Received
 SEP 26 2016
 By OLWR

Landowner Name: _____

I HEREBY CERTIFY that the well/borehole was drilled, constructed, and completed in accordance with all applicable requirements of the Mississippi Department of Environmental Quality and the Mississippi Department of Health regulations, if applicable, and state laws.

MILLE SCHULTZ 0471 9/16/16

Print Name of Responsible Licensee and License No.

Date

Signature of Licensee