

Part 2 never received 3/13

County: HARRIS  
 Permit #: \_\_\_\_\_  
 Driller: 10-15-07  
 Date drilling completed: M. 3-2-07

### State Well Report

#### Part I - Driller's Log

Mississippi Department of Environmental Quality  
 Office of Land and Water Resources  
 P.O. Box 10631  
 Jackson, MS 39289-0631  
 (601)961-5210  
 (601)354-6938 (fax)

For Office Use Only:  
 Aquifer: \_\_\_\_\_  
 Well #: K-437  
 L. S. Elevation: \_\_\_\_\_  
 E-log #: \_\_\_\_\_

State Law requires that this report be prepared by the license holder responsible for the work and filed with the Department at the above address within 30 days of completion of drilling of the well or borehole.

<p><b>Information on Well Owner</b>          (Landowner if borehole is not for a water well)</p> <p>Owner Name: <u>D WOLF</u>          Mailing Address: <u>23499 STABLE WOOD</u>  <u>PASS CHRISTIAN MS 39502</u>          City State Zip Code          Telephone No. ( ) _____</p>	<p><b>Well or Borehole Location</b></p> <p>Latitude: <u>30.23.49N</u> Longitude: <u>89.14.19W</u>  <u>41</u> <u>11</u>          Method of Lat/Long (circle one): Conventional Survey, _____          USGS quad, <u>Hand-held GPS</u>, Survey-grade GPS _____  <u>N. 1/4 N. 1/4</u> Sec. <u>31</u> Twn. <u>75</u> Rng. <u>12W</u>          Distance Direction Nearest Town  <u>3</u> Miles <u>N.</u> of <u>Long Beach</u></p>
--	--

**Well / Borehole Data**

Date drilling started: 10/15/07 Date drilling completed: 10/15/07 Hole depth: 413' Hole diameter: 8"

Location of the source of any surface water used for drilling: \_\_\_\_\_  
 Method of dosing and volume of Chlorine used in drilling and development: \_\_\_\_\_

Logs run (circle all applicable):  No log run  Electric  Gamma Ray  Density  Sonic  Neutron Other: \_\_\_\_\_  
 Name of organization running log(s): \_\_\_\_\_

Purpose of borehole (check one): Water Well  Geotechnical/Geological Investigation \_\_\_\_\_ Ground Source Heat Pump \_\_\_\_\_  
 Seismic Survey \_\_\_\_\_ Other (describe) \_\_\_\_\_

*If drilling is not related to water well construction, skip the remainder of this block*

Purpose of Well (check one): Home  Industrial \_\_\_\_\_ Public Supply \_\_\_\_\_ Irrigation \_\_\_\_\_ Fish Culture \_\_\_\_\_ Other: \_\_\_\_\_

If a flowing well, method of flow regulation: Valve \_\_\_\_\_ Other (describe) \_\_\_\_\_

Static Water Level: 40 feet above or below (circle one) land surface Date measured: \_\_\_\_\_

Method of Measurement (circle one) Steel tape electric tape air line other: \_\_\_\_\_

Well depth: 413 Well grouted to a depth of 20 feet Type of grout (circle one): Neat Cement Bentonite Mix

Casing length: 393 feet Casing diameter: 4 1/2 inches Type of casing: PVC

Screen length: 20 feet Screen diameter: 2 inches Type of screen: PVC

Screen slot size: 006 inches Setting depth: From \_\_\_\_\_ feet to \_\_\_\_\_ feet

Type of completion (circle all applicable): Gravel packed Underreamed Telescoped Open hole Natural Development  
 Other (describe): \_\_\_\_\_

Top of lap pipe or reduction in casing: \_\_\_\_\_ feet. *If telescoped or more than one screen, describe on next page*

Form: OLWR-SWR-1A

RECEIVED  
 NOV 27 2007  
 BY: OLWR

K-

The sketch below only required for water wells

If well telescopes, show depths on sketch.

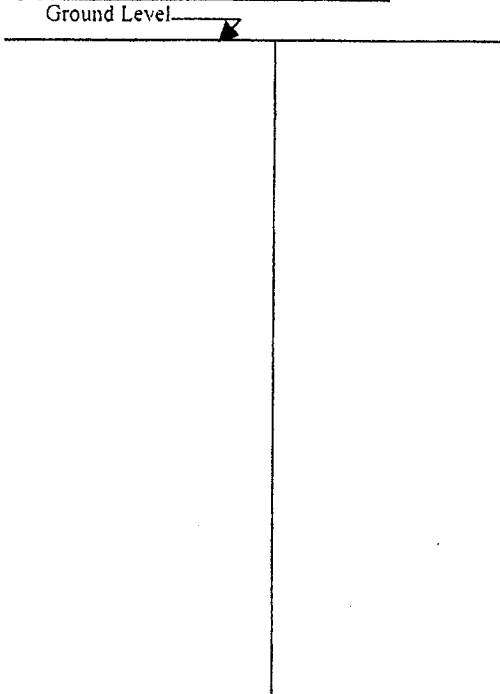

Description of formations encountered must be provided for all wells and boreholes, unless specifically exempted by regulations

Description of Formations Encountered	From (depth)	To (depth)
CLAY	Ground Level	3'
SAND & GRAVEL		
CLAY	140	140
SAND	360	
	415	

If more than one screen, show location of each on sketch

Sketch the property layout and include the following: 1) the well location; 2) any permanent structures on the property that may aid in locating the well; 3) any roads, power lines, or other items that may aid in locating the property and the well; 4) a north arrow.

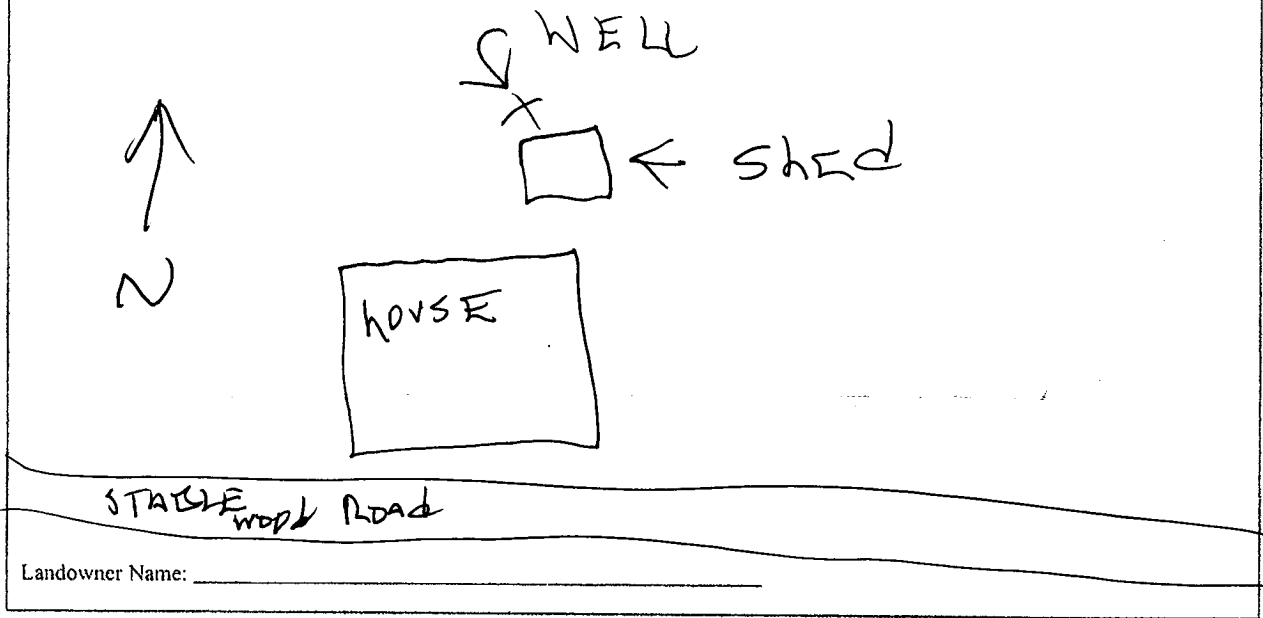

Landowner Name: \_\_\_\_\_

Form: OLWR-SWR-1A

I certify that the well/borehole was drilled, constructed, and completed in accordance with all applicable requirements of the Mississippi Department of Environmental Quality and the Mississippi Department of Health regulations, if applicable, and state laws.

Print Name of Responsible Licensee and License No. MIKE SCHWARTZ

Date 11/4/07

Signature of Licensee [Signature]