

STATE WELL REPORT

Part 1

Driller's Log

Mississippi Department of Environmental Quality
Office of Land and Water Resources
P.O. Box 2309
Jackson, MS 39225-2309
(601)961-5210
(601)360-0535 (fax)

For Office Use Only:

Well #: J427
Aquifer:
E-Log #:

County: Harrison
Permit #: 0239
Driller: Mc Gill Pump & Well
Date drilling completed: 2-14-17

State Law requires that this report be prepared by the license holder responsible for the work and filed with the Department at the above address within 30 days of completion of drilling of the well or borehole.

Well Owner Information (Landowner if borehole is not for a water well)
Owner Name: Gus Builders
Mailing Address: 25457 Dogwood Place
Pass Christian MS 39571
Telephone No. (228) 383-2043
Well or Borehole Location
Latitude: 30° 23' 37.03" Longitude: 89° 16' 11.73"
Method of Lat/Long (check one): Conventional Survey
USGS quad IR 1/4 IR 1/4, Sec 35 T85S R12W
1.4 Miles South of DeLisle

Well / Borehole Data
Date drilling started: 2-13-17 Date drilling completed: 2-14-17 Hole depth: 560 Hole diameter: 4x2
Location of the source of any surface water used for drilling: water well
Method of dosing and volume of Chlorine used in drilling and development: NA
Logs run (circle all applicable): No log run Electric Gamma Ray Density Sonic Neutron Other:
Name of organization running log(s): NA
Purpose of borehole (circle one): Water Well Geotechnical/Geological Investigation Ground Source Heat Pump
Seismic Survey Other (describe)

Purpose of Well (circle all applicable): Home Industrial Public Supply Irrigation Fish Culture
Other (describe):
If a flowing well, method of flow regulation: Valve Other (describe) Back Wash Valve
Static Water Level: 65 feet [above or below] land surface Date measured: 2-16-17
Method of measurement (circle one): Steel tape Electric tape Air line Other (describe):
Well depth: 560 Well grouted to a depth of: 10 feet Type of grout (circle one): Neat Cement Bentonite Mix
Casing length: 540 feet Casing diameter: 4+2 inches Type of casing: PVC
Screen length: 20 feet Screen diameter: 2 inches Type of screen: PVC
Screen slot size: .006 inches Setting depth: From 540 feet to 560 feet
Type of completion (circle all applicable): Gravel packed Underreamed Open hole Natural Development
Other (describe):
Top of lap pipe or reduction in casing: 220 feet

If telescoped or more than one screen, describe on next page

RECEIVED
FEB 17 2017
BY OLWR
Form: OLWR-SWR-1A (4/13)

# STATE WELL REPORT

## Part 2

**Pump Installer's Completion Report**  
 Mississippi Department of Environmental Quality  
 Well Office of Land and Water Resources  
 P.O. Box 2309  
 Jackson, MS 39225-2309  
 (601)961-5210  
 (601) 360-0535 (fax)

County: HARRISON  
 Permit #: 0239  
 Driller: ML Gill pump  
 Date completed: 0239  
*Copy information from block on Part 1*

**For Office Use Only:**

Well #: JAZ7  
 Aquifer: \_\_\_\_\_

*This part of the report must be completed by a licensed water well contractor or a licensed pump installer. A copy of Part 1 of the report must be attached and both parts filed with the Department at the above address within 30 days of well completion.*

Well Owner Information	Well Location
Owner Name: <u>Gas Bylders</u>	Latitude: <u>30° 23' 37.03"</u> Longitude: <u>89° 16' 11.73"</u>
Mailing Address: <u>25457 Dogwood</u> <u>place</u>	Method of Lat/Long (check one): Conventional Survey _____ USGS quad _____, Hand-held GPS <input checked="" type="checkbox"/> , Survey-grade GPS _____
<u>PASS Christian MS 3957</u> City State Zip Code	<u>1R 1/4 1R 1/4, Sec 32 35 T85 75 R 12W</u> 1.4 Miles South of De Lisle 13W (Distance) (Direction) (Nearest Town)
Telephone No. <u>(228) 383-2043</u>	

**Pump Type (circle one)**

Submersible  Turbine  Air Lift  Centrifugal  Flowing Well  Jet  Piston  Rotary  Other (describe): \_\_\_\_\_

Date Pump Installed: 2-16-17 Rated Pump Capacity: 20 Gallons Per Minute

Is This Pump (circle one):  New  Repaired  Replacement

**Power Type (circle one)**

Electric  Diesel  Gasoline  Natural Gas  Tractor PTO  Windmill  Other (describe): \_\_\_\_\_

Horse Power Rating of Motor: 1hp Setting Depth: 160 feet Number of Stages: 7

**Pump Test Data for Non Flowing Well**

Date Well Tested: 2-14-17 Duration of Pump Test (minimum 4 hours): 4 hours

Static Water Level (A): 65 Feet Below Land Surface Pumping Water Level (B): 160 Feet Below Land Surface

Drawdown [(B) - (A)]: 10 Feet Below Land Surface Test Pumping Rate: 50 Gallons Per Minute

Method of measurement (circle one):  Steel tape  Electric tape  Air line  Other (describe): \_\_\_\_\_

**Pump Test Data for Flowing Well** *NA*

Measured shut in head: \_\_\_\_\_ feet.

Well yielded \_\_\_\_\_ GPM with a drawdown of \_\_\_\_\_ feet after \_\_\_\_\_ hours of pumping

**Meter Installation** *NA*

Meter Manufacturer: \_\_\_\_\_ Meter Serial Number: \_\_\_\_\_

Meter Model Number/Name: \_\_\_\_\_ Type of Meter: \_\_\_\_\_

Totalizer Register Unit and Multiplier Factor (AF x .001, gal x 1000, etc): \_\_\_\_\_

Installation Date: \_\_\_\_\_ Meter installed by: \_\_\_\_\_

Is This Meter (circle one):  New  Repaired  Replacement

*Important: By submitting the above information you are certifying that this meter was installed to manufacturer standards. For agricultural wells, a list of approved meters is on the MDEQ website.*

I HEREBY CERTIFY that the above statements are true to the best of my knowledge.

Michelle P. Maudell 2/24/17 [Signature]  
 Print Name of Pump Installer and License No. (if applicable) Date Signature of Pump Installer

RECEIVED  
 Form: OLWR-SWR-28 (4/13) 2017  
 BY OLWR



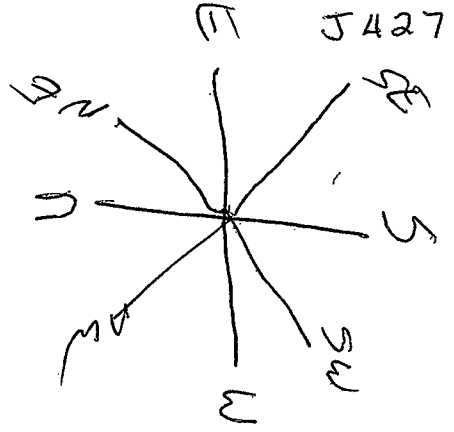

J427

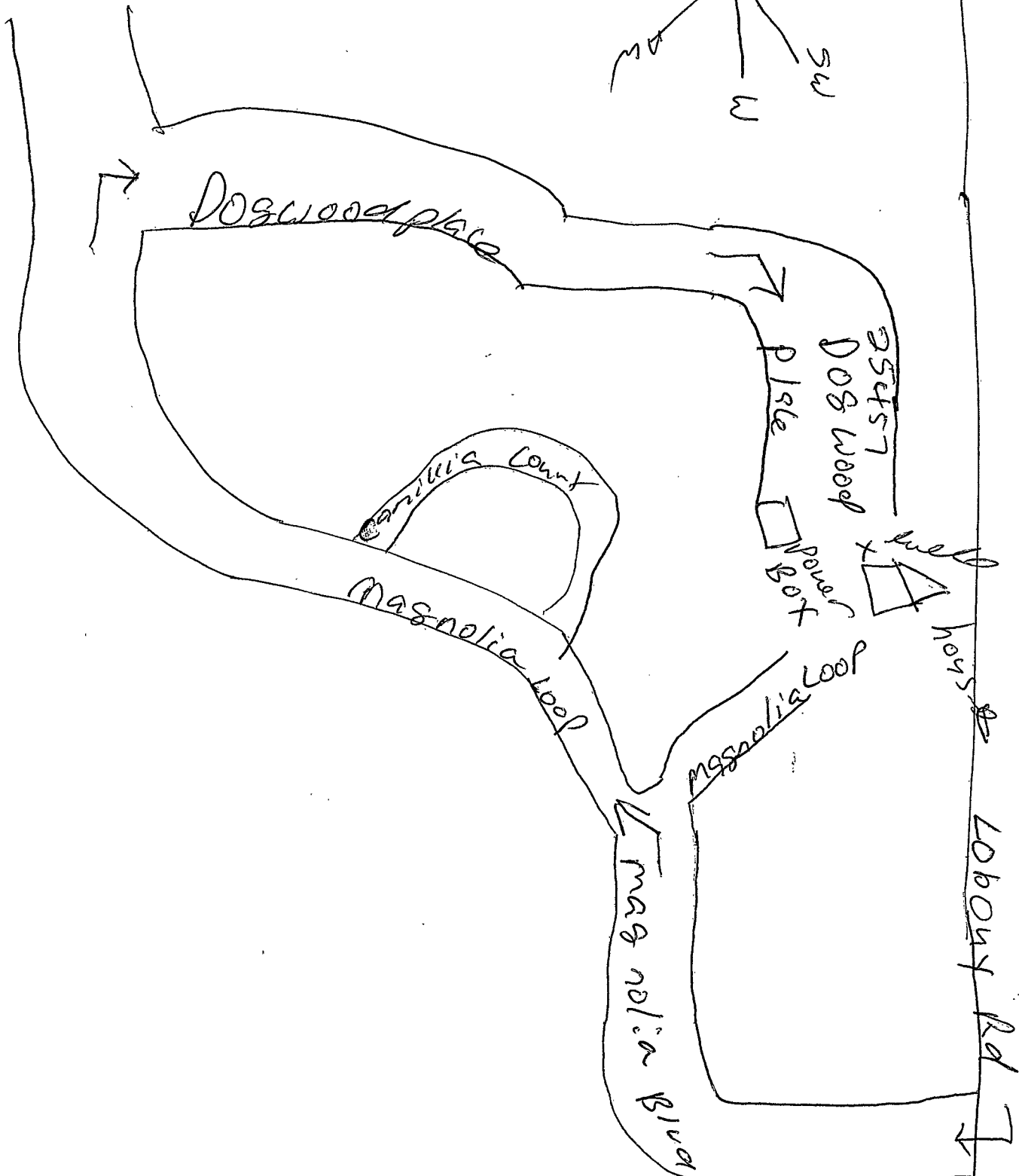

RECEIVED  
 FEB 27 2017  
 BY OLWR