

STATE WELL REPORT

Part 1

Driller's Log

Mississippi Department of Environmental Quality
Office of Land and Water Resources
P.O. Box 2309
Jackson, MS 39225-2309
(601)961-5210
(601)360-0535 (fax)

County: Harrison
Permit #: 0239
Driller: Mc Gill Pump & Well
Date drilling completed: 3-11-17

For Office Use Only:
Well #: J 422
Aquifer: _____
E-Log #: _____

State Law requires that this report be prepared by the license holder responsible for the work and filed with the Department at the above address within 30 days of completion of drilling of the well or borehole.

Well Owner Information (Landowner if borehole is not for a water well)	Well or Borehole Location
Owner Name: <u>David Harrison</u>	Latitude: <u>30°26'43.14" N</u> Longitude: <u>89°18'15.50" W</u>
Mailing Address: <u>1157 Hidden Valley Rd</u>	Method of Lat/Long (check one): Conventional Survey _____ Hand-held GPS <input checked="" type="checkbox"/> Survey-grade GPS _____
<u>Pass Christian MS 39571</u>	USGS quad <u>SW 1/4 SW 1/4 Sec 216 T 75 S R 13 W</u>
City State Zip Code	<u>6.7 Miles North of DeLisle</u> (Distance) (Direction) (Nearest Town)
Telephone No. <u>(228) 383-5895</u>	

Well / Borehole Data

Date drilling started: 3-10-17 Date drilling completed: 3-11-17 Hole depth: 360 Hole diameter: 4x2

Location of the source of any surface water used for drilling: Well water

Method of dosing and volume of Chlorine used in drilling and development: N/A

Logs run (circle all applicable): No log run Electric Gamma Ray Density Sonic Neutron Other: _____

Name of organization running log(s): N/A

Purpose of borehole (circle one): Water Well Geotechnical/Geological Investigation Ground Source Heat Pump
 Seismic Survey Other (describe) _____

If drilling is not related to water well construction, skip the remainder of this block

Purpose of Well (circle all applicable): Home Industrial Public Supply Irrigation Fish Culture

Other (describe): _____

If a flowing well, method of flow regulation: Valve _____ Other (describe) Back wash valve

Static Water Level: 120 feet [above or below] land surface Date measured: 3-13-17
(circle one)

Method of measurement (circle one): Steel tape Electric tape Air line Other (describe): _____

Well depth: 360 Well grouted to a depth of: 10 feet Type of grout (circle one): Neat Cement Bentonite Mix

Casing length: 340 feet Casing diameter: 4x2 inches Type of casing: PVC

Screen length: 20 feet Screen diameter: 2 inches Type of screen: PVC

Screen slot size: 1006 inches Setting depth: From 340 feet to 360 feet

Type of completion (circle all applicable): Gravel packed Underreamed Open hole Natural Development

Other (describe): _____

Top of lap pipe or reduction in casing: 220 feet

If telescoped or more than one screen, describe on next page

RECEIVED

APR 14 2017 Form: OLWR-SWR-1A (4/13)

OLWR

STATE WELL REPORT

Part 2

Pump Installer's Completion Report
 Mississippi Department of Environmental Quality
 Well Office of Land and Water Resources
 P.O. Box 2309
 Jackson, MS 39225-2309
 (601)961-5210
 (601) 360-0535 (fax)

County: HARRISON
 Permit #: 0239
 Driller: Mc Gill Pump
 Date completed: 0239
Copy information from block on Part 1

For Office Use Only:
 Well #: J422
 Aquifer: _____

This part of the report must be completed by a licensed water well contractor or a licensed pump installer. A copy of Part 1 of the report must be attached and both parts filed with the Department at the above address within 30 days of well completion.

Well Owner Information	Well Location
Owner Name: <u>David Harrison</u>	Latitude: <u>30° 26' 43.14" N</u> Longitude: <u>89° 18' 15.50" W</u>
Mailing Address: <u>1157 Hidden Valley Rd</u>	Method of Lat/Long (check one): Conventional Survey _____ USGS quad _____, Hand-held GPS <input checked="" type="checkbox"/> , Survey-grade GPS _____
<u>Pass Christian MS 39571</u>	<u>SW 1/4 SW 1/4, Sec 9 T 7S R 13W</u>
City State Zip Code	<u>6.7 Miles north of De Lisle</u>
Telephone No. (228) <u>383-5895</u>	(Distance) (Direction) (Nearest Town)

Pump Type (circle one)

Submersible Turbine Air Lift Centrifugal Flowing Well Jet Piston Rotary Other (describe): _____

Date Pump Installed: 5-13-17 Rated Pump Capacity: 20 Gallons Per Minute

Is This Pump (circle one): New Repaired Replacement

Power Type (circle one)

Electric Diesel Gasoline Natural Gas Tractor PTO Windmill Other (describe): _____

Horse Power Rating of Motor: 1 Setting Depth: 160 feet Number of Stages: 7

Pump Test Data for Non Flowing Well

Date Well Tested: 3-11-17 Duration of Pump Test (minimum 4 hours): 4 hours

Static Water Level (A): 120 Feet Below Land Surface Pumping Water Level (B): 160 Feet Below Land Surface

Drawdown [(B) - (A)]: 5 Feet Below Land Surface Test Pumping Rate: 30 Gallons Per Minute

Method of measurement (circle one): Steel tape Electric tape Air line Other (describe): _____

Pump Test Data for Flowing Well NA

Measured shut in head: _____ feet

Well yielded _____ GPM with a drawdown of _____ feet after _____ hours of pumping

Meter Installation NA

Meter Manufacturer: _____ Meter Serial Number: _____

Meter Model Number/Name: _____ Type of Meter: RECEIVED

Totalizer Register Unit and Multiplier Factor (AF x .001, gal x 1000, etc): _____ APR 14 2017

Installation Date: _____ Meter installed by: BY [Signature]

Is This Meter (circle one): New Repaired Replacement

Important: By submitting the above information you are certifying that this meter was installed to manufacturer standards. For agricultural wells, a list of approved meters is on the MDEQ website.

I HEREBY CERTIFY that the above statements are true to the best of my knowledge.

Michael McGill SR #0239 5/11/17 [Signature]
 Print Name of Pump Installer and License No. (if applicable) Date Signature of Pump Installer

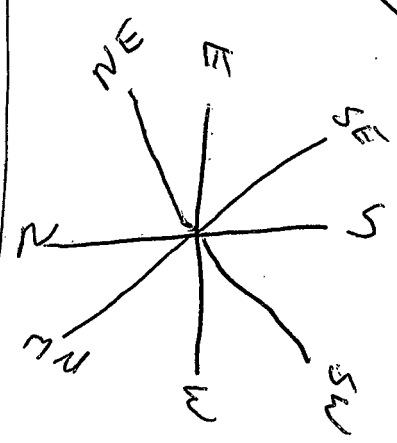
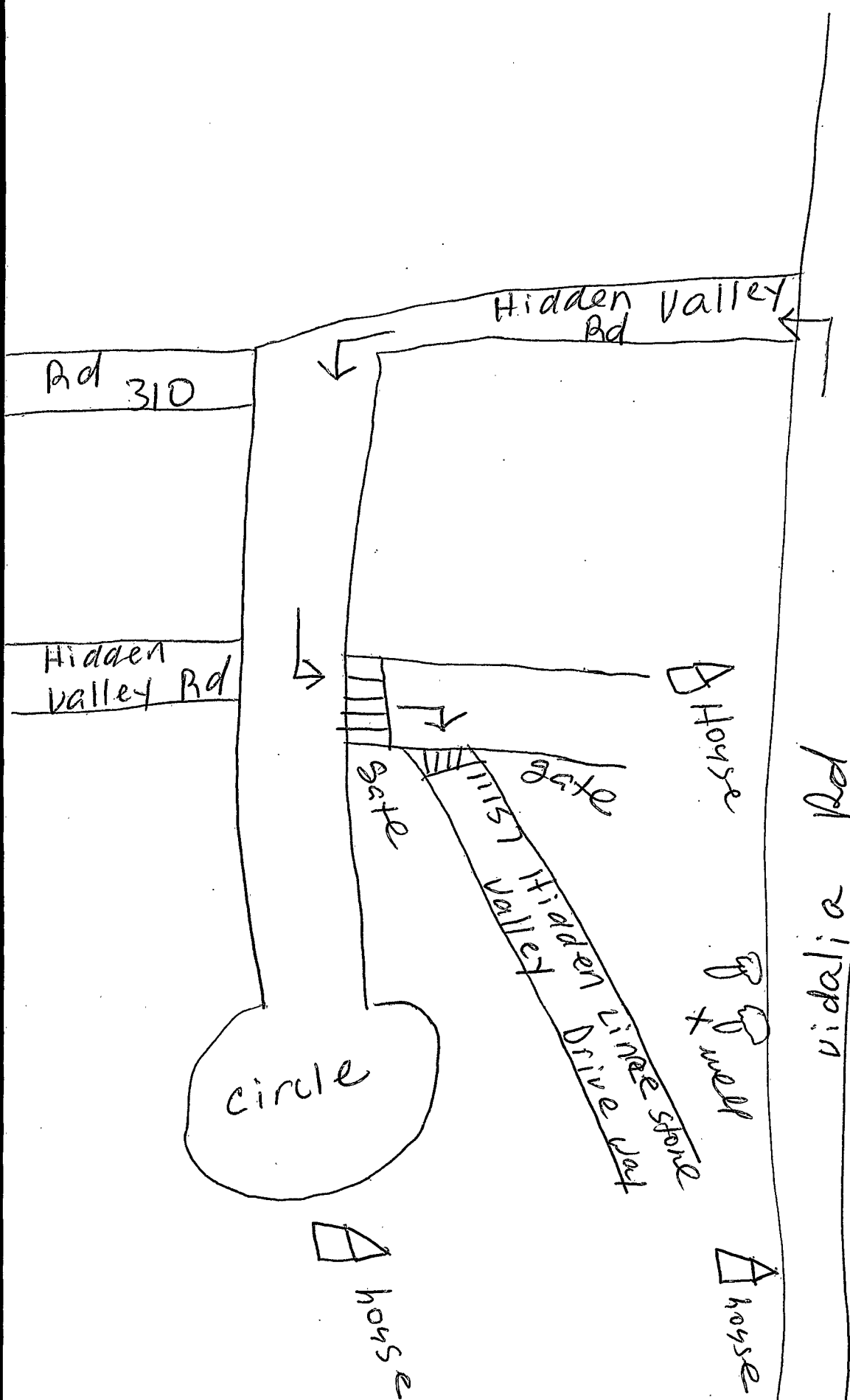

RECEIVED

RECEIVED
APR 14 2017
BY OLWR