

# State Well Report

## Part 1

Mississippi Department of Environmental Quality  
Office of Land and Water Resources  
P.O. Box 10631  
Jackson, MS 39289-0631  
(601) 961-5210  
(601) 354-6938 (fax)

### For Office Use Only:

Aquifer: H 602  
Well #: \_\_\_\_\_  
L. S. Elevation: \_\_\_\_\_  
E-log #: \_\_\_\_\_

County: Harrison

Permit #: \_\_\_\_\_

Driller: Coast Water Wells, Inc.

Date drilling completed: 7/21/12

State Law requires that this report be prepared by the driller in detail and filed with the Department within 30 days of completion of drilling of the well.

Well Owner Information	Well Location
Owner Name: <u>Bandy Oliver</u>	Latitude: <u>30° 30' 11.34"</u> Longitude: <u>088° 56' 54.30"</u>
Mailing Address: <u>15015 Hudson Krohn Rd</u>	Method of Lat/Long (circle one): Conventional Survey, USGS quad, <u>Hand-held GPS</u> Survey-grade GPS
<u>Biloxi, MS 39532</u>	<u>SW 1/4 SW 1/4 Sec 24 T6 S R16 W</u>
City State Zip Code	Distance Direction Nearest Town
Telephone No. <u>(228) 273-0619</u>	<u>3</u> Miles <u>North</u> of <u>Biloxi</u>

### Well Data

Purpose of Well (circle one): Home Industrial Public Supply Irrigation Fish Culture Other: \_\_\_\_\_

Date well drilling started: 7/18/12 Date well drilling completed: 7/21/12

If flowing, method of flow regulation: Valve N/A Other (describe) \_\_\_\_\_

Static Water Level: 90 feet above or below (circle one) land surface Date measured: 7/21/12

Method of Measurement (circle one) steel tape electric tape air line other: \_\_\_\_\_

Hole depth: 670 FT Well depth: 670 FT Well grouted to a depth of 10 feet

Type of grout (circle one): Cement Bentonite Mix

Casing length: 655 feet Casing diameter: 2 inches Type of casing: PVC

Screen length: 15 feet Screen diameter: 2 inches Type of screen: PVC

Screen slot size: .004 inches Setting depth: From 655 feet to 670 feet

Type of completion (circle all applicable): Gravel packed Underreamed Telescoped Open hole Natural Development

Other (describe): \_\_\_\_\_

Top of lap pipe or reduction in casing: N/A feet. If telescoped or more than one screen, describe on back of page

Logs run (circle all applicable): No log run Electric Gamma Ray Density Sonic Neutron Other: \_\_\_\_\_

Name of organization running log(s): N/A

I certify that the well was drilled, constructed, and completed in accordance with all applicable requirements of the Mississippi Department of Environmental Quality and/or the Mississippi Department of Health regulations and state laws.

Jack Ridgell 0-472  
Print Name of Water Well Contractor and License No.

Jack Ridgell  
Signature of Water Well Contractor

H602

If well telescopes please sketch below and show depths.

Ground Level

Description of Formations Encountered	From	To
Top Soil	0	2
Orange Clay	2	18
Orange Coarse Sand	18	35
Orange Clay	35	90
Orange Coarse Sand	90	105
Blue Clay w/ streaks of Sand	105	632
Gray Medium to Coarse Sand	632	670

If more than one screen, show location of each on sketch

Sketch the property layout and include the following: 1) the well location; 2) any permanent structures on the property that may aid in locating the well; 3) any roads, power lines, or other items that may aid in locating the property and the well; 4) indicate direction.

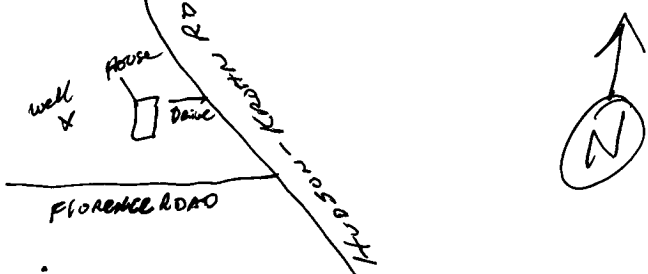

Landowner Name: Randy Oliver

Signature of Water Well Contractor: *Jane Ridgell*

# STATE WELL REPORT

## Part 2

**Pump Installer's Completion Report**  
 Mississippi Department of Environmental Quality  
 Office of Land and Water Resources  
 P.O. Box 10631  
 Jackson, MS 39289-0631  
 (601) 961-5210  
 (601) 354-6938 (fax)

### For Office Use Only:

Aquifer: \_\_\_\_\_  
 Well #: \_\_\_\_\_  
 Elevation: \_\_\_\_\_

County: Harrison  
 Permit #: \_\_\_\_\_  
 Driller: Coast Water Well Serv.  
 Date completed: 7/21/12

This report should be prepared by the pump installer in detail and filed with the Department within 30 days of the installation of pump.

Well Owner Information	Well Location
Owner Name: <u>Randy Oliver</u>	Latitude: <u>30° 30' 11.34"</u> Longitude: <u>088° 56' 54.30"</u>
Mailing Address: <u>15015 Hudson Krohn Rd</u>	Method of Lat/Long (circle one): Conventional Survey, USGS quad, <u>(Hand-held GPS)</u> Survey-grade GPS
<u>Biloxi, Ms 39532</u>	<u>SW 1/4 SW 1/4 Sec 24 Twn T6S Rng R10 W</u>
City State Zip Code	Distance Direction Nearest Town
Telephone No. <u>(228) 273-0619</u>	<u>3 Miles NORTH of Biloxi</u>

Pump Type Circle one	Power Type Circle one
Air Lift <input checked="" type="radio"/> Jet Submersible	Diesel Engine Gasoline Engine Natural Gas
Bucket <input type="radio"/> Piston <input type="radio"/> Turbine	<input checked="" type="radio"/> Electric Motor Hand Tractor PTO
Centrifugal <input type="radio"/> Rotary <input type="radio"/> Flowing Well	Windmill Other (specify): _____
Other (specify): _____	Horse Power Rating of Motor: <u>1/2 HP</u>
Date Pump Installed: <u>7/23/12</u>	Setting Depth: <u>110 FT. Drop Pipe</u> feet
Rated Pump Capacity: <u>6</u> Gallons Per Minute	Number of Stages: <u>2</u>

Pump Test Data	Method of Measuring Water Level Circle one
Date Well Tested: <u>7/23/12</u>	<input checked="" type="radio"/> Air Line Electric Measuring Line Steel Tape
Static Water Level (A): <u>90</u> Feet Below Land Surface	Other (specify): _____
Pumping Water Level (B): <u>N/A</u> Feet Below Land Surface	For flowing well, measured shut in head: <u>N/A</u> feet
Drawdown [(B) - (A)]: <u>N/A</u> Feet Below Land Surface	Well yielded <u>23</u> GPM with a drawdown of
Test Pumping Rate: <u>6</u> Gallons Per Minute	<u>N/A</u> feet after <u>N/A</u> hours of pumping
Duration of Pump Test (minimum 4 hours): <u>5</u> hours	

I HEREBY CERTIFY that the above statements are true to the best of my knowledge.

Jack Riddell 0-472  
 Print Name of Pump Installer and License No. (if applicable)

Jack Riddell  
 Signature of Pump Installer