

# State Well Report

Part 1

Mississippi Department of Environmental Quality  
Office of Land and Water Resources  
P.O. Box 10631  
Jackson, MS 39289-0631  
(601)961-5210  
(601)354-6938 (fax)

For Office Use Only:

Aquifer: \_\_\_\_\_  
Well #: H-578  
L. S. Elevation: \_\_\_\_\_  
E-log #: \_\_\_\_\_

County: Harrison  
Permit #: MS 6W-16395  
Driller: Lyman 16399  
Date drilling completed: 2/1/08

State Law requires that this report be prepared by the driller in detail and filed with the Department within 30 days of completion of drilling of the well.

Well Owner Information	Well Location
Owner Name: <u>Harrison County School Board</u>	Latitude: <u>30° 30' 48"</u> Longitude: <u>88° 56' 02"</u>
Mailing Address: <u>11072 Hwy 49 East</u> <u>'D' Morville High School'</u> <u>Gulfport MS 39503</u>	Method of Lat/Long (circle one): Conventional Survey, USGS quad, Hand-held GPS, Survey-grade GPS
City: <u>Gulfport</u> State: <u>MS</u> Zip Code: <u>39503</u>	1/4 Sec <u>18</u> Twn <u>05</u> Rng <u>9W</u>
Telephone No. <u>228) 538-6500</u>	Distance: <u>1</u> Miles Direction: <u>West</u> of Nearest Town: <u>Diberville</u>

**Well Data**

Purpose of Well (circle one) Home Industrial Public Supply Irrigation Fish Culture Other: Production well

Date well drilling started: 1/10/08 Date well drilling completed: 2/1/08

If flowing, method of flow regulation: Valve \_\_\_\_\_ Other (describe) \_\_\_\_\_

Static Water Level: 85 feet above or below (circle one) land surface Date measured: 2/4/08

Method of Measurement (circle one) steel tape electric tape air line other: \_\_\_\_\_

Hole depth: 752 Well depth: 750 Well grouted to a depth of 700 feet

Type of grout (circle one): Cement Bentonite Mix

Casing length: 700 feet Casing diameter: 10 inches Type of casing: steel

Screen length: 40 feet Screen diameter: 5X7 inches Type of screen: rod base muni pack

Screen slot size: 1.012 inches Setting depth: From 710 feet to 750 feet

Type of completion (circle all applicable): Gravel packed Underreamed Telescoped Open hole Natural Development  
Other (describe): \_\_\_\_\_

Top of lap pipe or reduction in casing: 610 feet. If telescoped or more than one screen, describe on back of page

Logs run (circle all applicable): No log run Electric Gamma Ray Density Sonic Neutron Other: \_\_\_\_\_

Name of organization running log(s): MDEQ

I certify that the well was drilled, constructed, and completed in accordance with all applicable requirements of the Mississippi Department of Environmental Quality and/or the Mississippi Department of Health regulations and state laws.

Josh Ladner 0-640  
Print Name of Water Well Contractor and License No. Signature of Water Well Contractor

MSDH # 0240262-01  
MSDH data shown 120 ppm

RECEIVED  
FEB 11 2008  
BY: OLWR

H-578

The sketch below only required for water wells

Description of formations encountered must be provided for all wells and boreholes, unless specifically exempted by regulations

If well telescopes, show depths on sketch.  
Ground Level

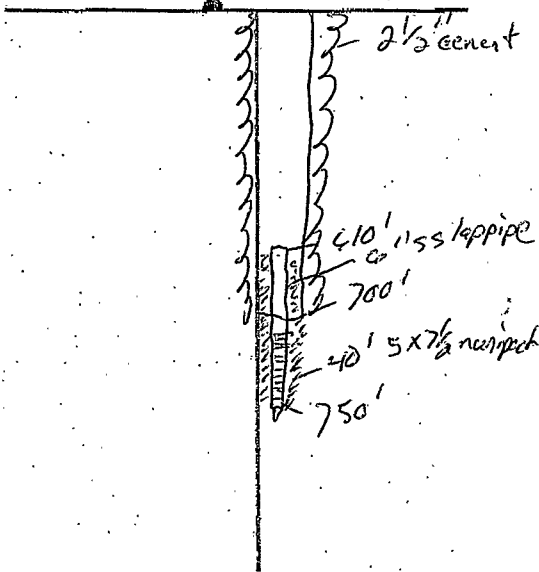

Description of Formations Encountered	From (depth)	To (depth)
	Ground Level	
top soil & sand	0	50
blue clay	50	160
sand	160	180
blue clay	180	270
silt	270	350
blue clay	350	680
sand	680	720

If more than one screen, show location of each on sketch

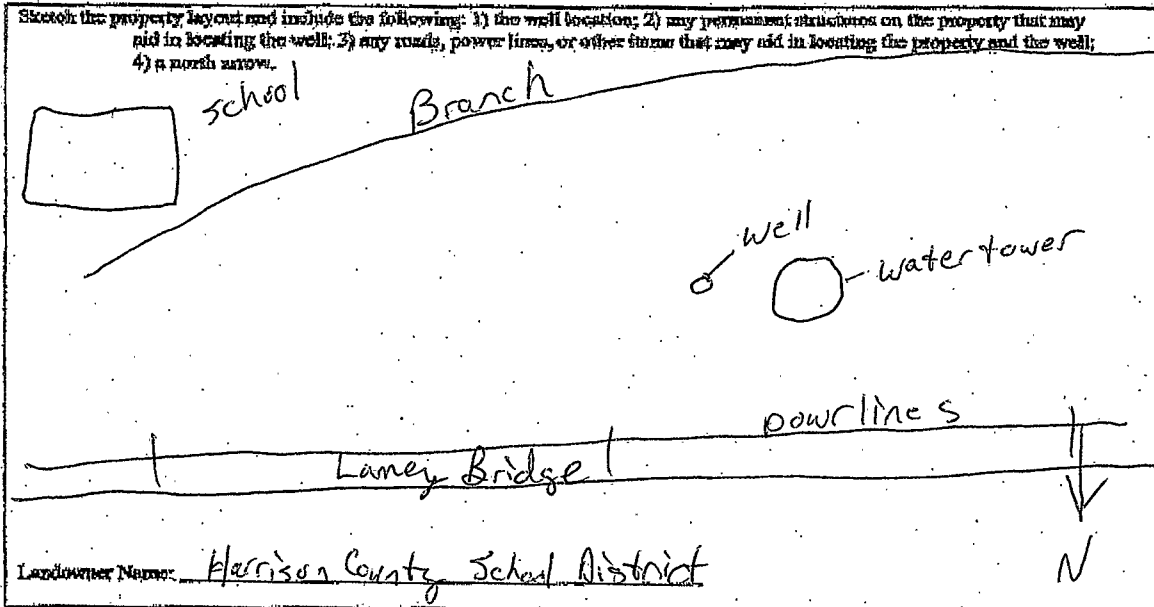

Form OLWR-SWR-1A

I certify that the well/borehole was drilled, constructed, and completed in accordance with all applicable requirements of the Mississippi Department of Environmental Quality and the Mississippi Department of Health regulations, if applicable, and state laws.

Print Name of Responsible Licensee and License No. Josh Kadner 0-640 Date 2/6/08

Signature of Licensee [Signature]

RECEIVED  
FEB 11 2008  
BY: OLWR