

Harrison  
F 93  
4-14-69

MISSISSIPPI  
 BOARD OF WATER COMMISSIONERS  
 416 North State Street  
 Jackson, Mississippi 39201

**CODED**

WATER WELL DRILLERS LOG

APRIL 14 1969 MCGILL HARRISON  
 date well completed firm name county well located

LANDOWNER: Alice  
FOWLER FOUNTAIN  
BOX 289 LYMAN  
 (mailing address)

description of formations encountered	from	to
<u>CLAY</u>	<u>0</u>	<u>105</u>
<u>BLUE CLAY</u>	<u>105</u>	<u>206</u>
<u>Shell</u>	<u>206</u>	<u>300</u>
<u>CLAY</u>	<u>300</u>	<u>340</u>
<u>SAWD</u>	<u>340</u>	<u>360</u>

WELL LOCATION:  
 sec. 19 T 12 N R 6 E  
5 miles W of LYMAN  
 (distance) (direction) (nearest town)

WELL PURPOSE: HOME  
 (home, irrigation, municipal, industrial)

WELL COMPLETION DATA:

(1) diameter (inches) 2"

(2) total depth (feet) 360

(3) static water level (feet) 28 below top of ground above

(4) casing galv (material) 360 (depth)  
 (size) if telescope see back.

(5) screen 10 (length) 350 (depth to top)  
2' (size) SS (material)

(6) pump 1 (HP) 14 (yield gpm) OK  
Elec (type power)

(7) electric log NO (yes or no)

(8) how well bottom plugged B.W  
 (organization running log)

**CODED**

JULY 30 1969

MISS. BD. OF  
 WATER COM.

DRILLERS REMARKS:

If well telescopes please sketch and show depths.

GROUND LEVEL

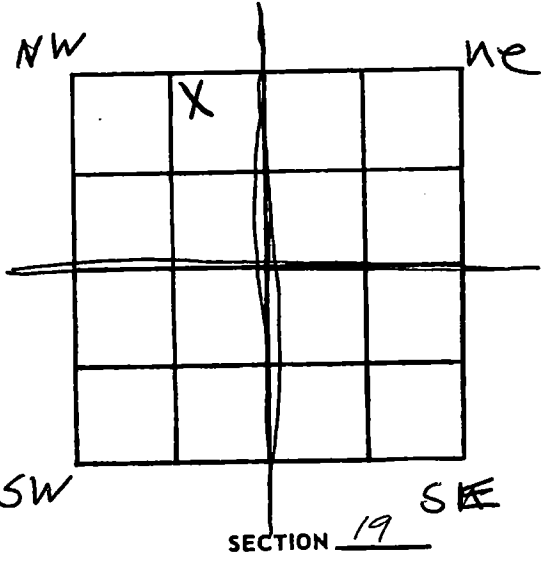

Please indicate well location X.

ADDITIONAL INFORMATION

If more than one screen, show locations of each on sketch.