

STATE WELL REPORT

Part 1

Driller's Log

Mississippi Department of Environmental Quality
Office of Land and Water Resources
P.O. Box 2309
Jackson, MS 39225-2309
(601)961-5555
(601)961-5228 (fax)

For Office Use Only:

Well #: E197
Aquifer: _____
E-Log #: _____

County: Harrison
Permit #: 0239
Driller: Mc Gill Pump + well
Date drilling completed: 7-26-18

State Law requires that this report be prepared by the license holder responsible for the work and filed with the Department at the above address within 30 days of completion of drilling of the well or borehole.

Well Owner Information <small>(Landowner if borehole is not for a water well)</small>	Well or Borehole Location
Owner Name: <u>Eddie Seward</u>	Latitude: <u>30° 29' 25.7" N</u> Longitude: <u>89° 16' 0.65" W</u>
Mailing Address: <u>New Dwelling</u>	Method of Lat/Long (check one): Conventional Survey _____, USGS quad _____, Hand-held GPS <input checked="" type="checkbox"/> , Survey-grade GPS _____
<u>No address Lot 78</u>	NE <input type="checkbox"/> SW <input type="checkbox"/> Sec <u>26</u> T <u>6S</u> R <u>13W</u>
<u>Gulfport MS 39503</u>	<u>0</u> Miles <u>0</u> of <u>0</u>
City State Zip Code	(Distance) (Direction) (Nearest Town)
Telephone No. <u>(288) 342-4100</u>	

Well / Borehole Data
Date drilling started: <u>7-25-18</u> Date drilling completed: <u>7-26-18</u> Hole depth: <u>420</u> Hole diameter: <u>3x2</u>
Location of the source of any surface water used for drilling: <u>well water</u>
Method of dosing and volume of Chlorine used in drilling and development: <u>NA</u>
Logs run (check all applicable): <input type="checkbox"/> log run <input type="checkbox"/> Electric <input type="checkbox"/> Gamma Ray <input type="checkbox"/> Density <input type="checkbox"/> Sonic <input type="checkbox"/> Neutron Other: <u>NO LOGS Rg</u>
Name of organization running log(s): _____
Purpose of borehole (check one): Water Well <input checked="" type="checkbox"/> Geotechnical/Geological Investigation <input type="checkbox"/> Ground Source Heat Pump <input type="checkbox"/> Seismic Survey <input type="checkbox"/> Other (describe) _____
<i>If drilling is not related to water well construction, skip the remainder of this block</i>
Purpose of Well (check all applicable): <input checked="" type="checkbox"/> Home <input type="checkbox"/> Industrial <input type="checkbox"/> Public Supply <input type="checkbox"/> Irrigation <input type="checkbox"/> Fish Culture
Other (describe): _____
If a flowing well, method of flow regulation: Valve _____ Other (describe) <u>Back wash valve</u>
Static Water Level: <u>60</u> feet <input type="checkbox"/> above or <input checked="" type="checkbox"/> below land surface Date measured: <u>7-26-18</u> <small>(check one)</small>
Method of measurement (check one) <input checked="" type="checkbox"/> Steel tape <input type="checkbox"/> Electric tape <input type="checkbox"/> Air line <input type="checkbox"/> Other (describe): _____
Well depth: <u>420</u> Well grouted to a depth of: <u>10</u> feet Type of grout (check one) <input checked="" type="checkbox"/> Neat Cement <input type="checkbox"/> Bentonite <input type="checkbox"/> Mix
Casing length: <u>400</u> feet Casing diameter: <u>3x2</u> inches Type of casing: <u>PVC</u>
Screen length: <u>20</u> feet Screen diameter: <u>2</u> inches Type of screen: <u>PVC</u>
Screen slot size: <u>.006</u> inches Setting depth: From <u>400</u> feet to <u>420</u> feet
Type of completion (check all applicable) <input type="checkbox"/> gravel packed <input type="checkbox"/> Underreamed <input type="checkbox"/> Open hole <input checked="" type="checkbox"/> Natural Development
Other (describe): _____
Top of lap pipe or reduction in casing: <u>200</u> feet
<i>If telescoped or more than one screen, describe on next page</i>

RECEIVED
AUG 20 2018
BY OLWR

Handwritten title or header text, possibly "Handwritten Document" or similar, located at the top center of the page.

Main body of handwritten text, consisting of several lines of cursive script. The text is highly illegible due to the quality of the scan and the cursive style. It appears to be a continuous paragraph or a list of items.

Handwritten text at the bottom left, possibly a signature or a date, such as "Handwritten text" or "1800".

Handwritten text at the bottom right, possibly a signature or a date, such as "Handwritten text" or "1800".

STATE WELL REPORT

Part 2

Pump Installer's Completion Report
Mississippi Department of Environmental Quality
Office of Land and Water Resources
P.O. Box 2309
Jackson, MS 39225-2309
(601)961-5210
(601) 360-0535 (fax)

For Office Use Only:

Well #: E197
Aquifer: _____

County: Harrison
Permit #: 0239
Driller: mc Gill Pump & Well
Date completed: 7-27-18
Copy information from block on Part 1

This part of the report must be completed by a licensed water well contractor or a licensed pump installer. A copy of Part 1 of the report must be attached and both parts filed with the Department at the above address within 30 days of well completion.

Well Owner Information	Well Location
Owner Name: <u>Eddie Seward</u>	Latitude: <u>30°29'25.74</u> Longitude: <u>89°16'0.65" W</u>
Mailing Address: <u>new Dwelling</u>	Method of Lat/Long (check one): Conventional Survey _____, USGS quad _____, Hand-held GPS <input checked="" type="checkbox"/> , Survey-grade GPS _____
<u>no address Lot 78</u>	<u>NE</u> ¼ <u>SW</u> ¼, Sec <u>26</u> T <u>6S</u> R <u>13W</u>
<u>Gulfport</u> City <u>ms</u> State <u>39503</u> Zip Code	<u>5</u> Miles <u>0</u> of <u>0</u> (Distance) (Direction) (Nearest Town)
Telephone No. <u>(228) 342-4100</u>	

Pump Type (check one)
Submersible Turbine Air Lift Centrifugal Flowing Well Jet Piston Rotary Other (describe): _____
Date Pump Installed: 7-27-18 Rated Pump Capacity: 22 Gallons Per Minute
Is This Pump (check one): New Repaired Replacement

Power Type (check one)
Electric Diesel Gasoline Natural Gas Tractor PTO Windmill Other (describe): _____
Horse Power Rating of Motor: 15.0 Setting Depth: 120 feet Number of Stages: 8

Pump Test Data for Non Flowing Well

Date Well Tested: 7-27-18 Duration of Pump Test (minimum 4 hours): 4 hours
Static Water Level (A): 60 Feet Below Land Surface Pumping Water Level (B): 120 Feet Below Land Surface
Drawdown [(B) - (A)]: 5 Feet Below Land Surface Test Pumping Rate: 20 Gallons Per Minute
Method of measurement (check one): Steel tape Electric tape Air line Other (describe): _____

Pump Test Data for Flowing Well NA

Measured shut in head: _____ feet.
Well yielded _____ GPM with a drawdown of _____ feet after _____ hours of pumping

Meter Installation NA

Meter Manufacturer: _____ Meter Serial Number: _____
Meter Model Number/Name: _____ Type of Meter: _____
Totalizer Register Unit and Multiplier Factor (AF x .001, gal x 1000, etc): _____
Installation Date: _____ Meter installed by: _____
Is This Meter (check one): New Repaired Replacement

Important: By submitting the above information you are certifying that this meter was installed to manufacturer standards. For agricultural wells, a list of approved meters is on the MDEQ website.

I HEREBY CERTIFY that the above statements are true to the best of my knowledge.

Michael McMillan # 0239 8/11/18
Print Name of Pump Installer and License No. (if applicable) Date Signature of Pump Installer

RECEIVED
AUG 20 2018
BY OLWR

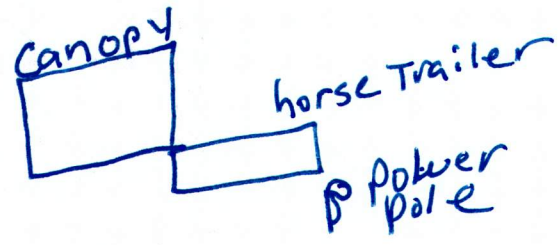
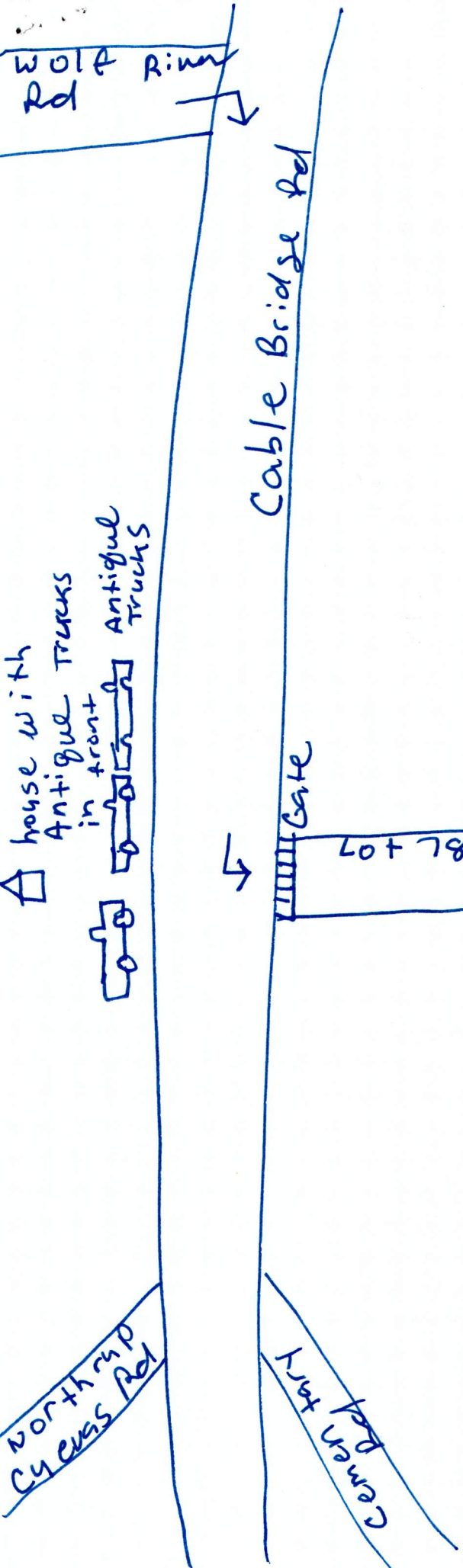
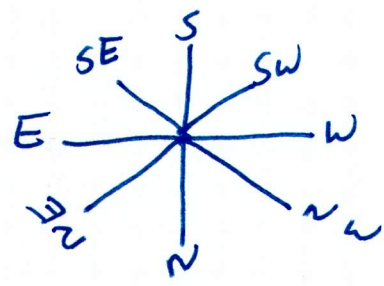

X new well

RECEIVED
AUG 20 2018
BY OLWR

