

# STATE WELL REPORT

## Part 1

### Driller's Log

Mississippi Department of Environmental Quality  
 Office of Land and Water Resources  
 P.O. Box 2309  
 Jackson, MS 39225-2309  
 (601)961-5210  
 (601)360-0535 (fax)

#### For Office Use Only:

Well #: D 117  
 Aquifer: \_\_\_\_\_  
 E-Log #: \_\_\_\_\_

County: Harrison  
 Permit #: \_\_\_\_\_  
 Driller: Coast Water Well Svc.  
 Date drilling completed: 7/2/19

*State Law requires that this report be prepared by the license holder responsible for the work and filed with the Department at the above address within 30 days of completion of drilling of the well or borehole.*

Well Owner Information <i>(Landowner if borehole is not for a water well)</i>	Well or Borehole Location
Owner Name: <u>Kevin Romero</u>	Latitude: <u>30° 39' 30.84"</u> Longitude: <u>088° 55' 22.98"</u>
Mailing Address: <u>5165 Brandon Lane</u>	Method of Lat/Long (check one): Conventional Survey _____, USGS quad _____, Hand-held GPS <input checked="" type="checkbox"/> , Survey-grade GPS _____
<u>Saucier, MS 39574</u>	<u>N<sup>SW</sup> 1/4 N<sup>W</sup> 1/4, Sec 31 T 45 R 9 W</u>
City State Zip Code	<u>12</u> Miles <u>East</u> of <u>Saucier</u>
Telephone No. <u>228 297-8697</u>	(Distance) (Direction) (Nearest Town)

**Well / Borehole Data**

Date drilling started: 7/1/19 Date drilling completed: 7/2/19 Hole depth: 270 FT Hole diameter: 2"

Location of the source of any surface water used for drilling: N/A

Method of dosing and volume of Chlorine used in drilling and development: 1 gal Per 1000 Drilling 2 gal in well

Logs run (circle all applicable):  No log run  Electric  Gamma Ray  Density  Sonic  Neutron Other: \_\_\_\_\_

Name of organization running log(s): \_\_\_\_\_

Purpose of borehole (circle one)  Water Well  Geotechnical/Geological Investigation  Ground Source Heat Pump  
 Seismic Survey  Other (describe) \_\_\_\_\_

*If drilling is not related to water well construction, skip the remainder of this block*

Purpose of Well (circle all applicable):  Home  Industrial  Public Supply  Irrigation  Fish Culture

Other (describe): \_\_\_\_\_

If a flowing well, method of flow regulation: Valve \_\_\_\_\_ Other (describe) \_\_\_\_\_

Static Water Level: 80 feet [above or  below] land surface Date measured: 7/2/19  
 (circle one)

Method of measurement (circle one): Steel tape  Electric tape   Air line Other (describe): \_\_\_\_\_

Well depth: 270 FT Well grouted to a depth of: 10 feet Type of grout (circle one): Neat Cement   Bentonite Mix

Casing length: 255 feet Casing diameter: 2 inches Type of casing: PVC

Screen length: 15 feet Screen diameter: 2 inches Type of screen: PVC

Screen slot size: .006 inches Setting depth: From 255 feet to 270 feet

Type of completion (circle all applicable): Gravel packed  Underreamed  Open hole  Natural Development

Other (describe): \_\_\_\_\_

Top of lap pipe or reduction in casing: N/A feet

*If telescoped or more than one screen, describe on next page*

RECEIVED  
 JUL 5 2019  
 BY OLWR



County: Harrison  
 Permit #: \_\_\_\_\_

**For Office Use Only:**  
 Well #: \_\_\_\_\_

The sketch below only required for water wells  
If well telescopes, show depths on sketch.

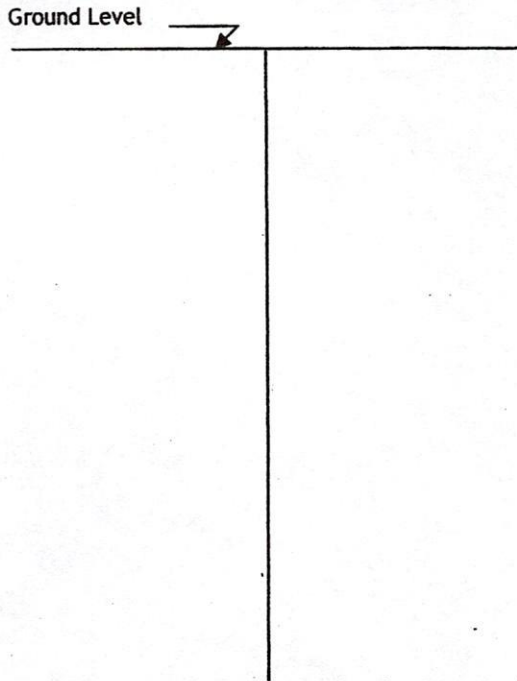

Description of formations encountered must be provided for all wells and boreholes, unless specifically exempted by regulations

Description of Formations Encountered	From (depth)	To (depth)
Top Soil	Ground level	2
Orange Clay	2	50
Brown coarse sand	50	90
Blue clay	90	250
Gray medium sand	250	270

If more than one screen, show location of each on sketch

Sketch the property layout and include the following:

- 1) the well location
- 2) any permanent structures on the property that may aid in locating the well
- 3) any roads, power lines, or other items that may aid in locating the property and the well
- 4) north arrow

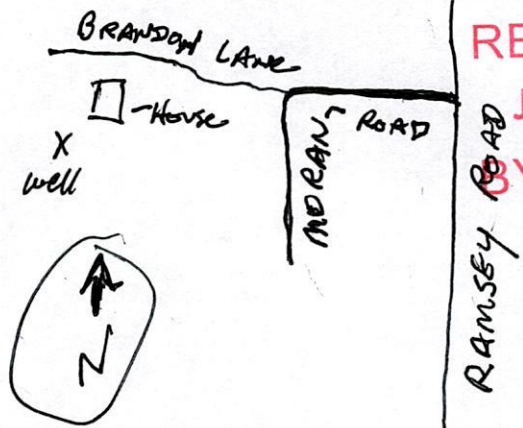

RECEIVED  
 JUL 15 2019  
 BY OLWR

Landowner Name: Kevin Romero

I HEREBY CERTIFY that the well/borehole was drilled, constructed, and completed in accordance with all applicable requirements of the Mississippi Department of Environmental Quality and the Mississippi Department of Health regulations, if applicable, and state laws.

Jack Riddell 0472 7/3/19  
 Print Name of Responsible Licensee and License No. Date

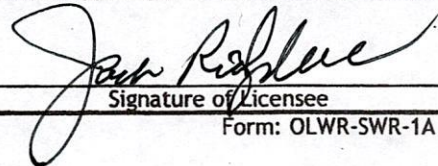
  
 Signature of Licensee



# STATE WELL REPORT

## Part 2

**Pump Installer's Completion Report**  
 Mississippi Department of Environmental Quality  
 Office of Land and Water Resources  
 P.O. Box 2309  
 Jackson, MS 39225-2309  
 (601)961-5210  
 (601) 360-0535 (fax)

County: Harrison  
 Permit #: \_\_\_\_\_  
 Driller: Coast Water Wells Inc  
 Date completed: 7/2/19  
 Copy information from block on Part 1

**For Office Use Only:**

Well #: D 117  
 Aquifer: \_\_\_\_\_

*This part of the report must be completed by a licensed water well contractor or a licensed pump installer. A copy of Part 1 of the report must be attached and both parts filed with the Department at the above address within 30 days of well completion.*

Well Owner Information	Well Location
Owner Name: <u>Kevin Romero</u>	Latitude: <u>30°39'30.84"</u> Longitude: <u>088°55'22.98"</u>
Mailing Address: <u>5165 Brandon Lane</u>	Method of Lat/Long (check one): Conventional Survey _____, <input checked="" type="checkbox"/> Hand-held GPS _____, Survey-grade GPS _____
<u>Saucier, MS 39574</u>	USGS quad _____, Hand-held GPS _____, Survey-grade GPS _____
City: _____ State: _____ Zip Code: _____	<u>NE SW</u> <u>NW NE</u> <u>31</u> T. <u>45</u> R. <u>9W</u>
Telephone No. <u>601-297-8697</u>	<u>12</u> Miles <u>E 800</u> of <u>Saucier</u>
	(Distance) (Direction) (Nearest Town)

**Pump Type (circle one)**

Submersible Turbine Air Lift Centrifugal Flowing Well  Jet  Piston  Rotary Other (describe): \_\_\_\_\_

Date Pump Installed: 7/2/19 Rated Pump Capacity: 6.5 Gallons Per Minute

Is This Pump (circle one):  New  Repaired  Replacement

**Power Type (circle one)**

Electric  Diesel  Gasoline  Natural Gas  Tractor PTO  Windmill Other (describe): \_\_\_\_\_

Horse Power Rating of Motor: 1HP Setting Depth: 90 FT feet Number of Stages: 2

**Pump Test Data for Non Flowing Well**

Date Well Tested: 7/2/19 Duration of Pump Test (minimum 4 hours): 6 hours

Static Water Level (A): 80 Feet Below Land Surface Pumping Water Level (B): N/A Feet Below Land Surface

Drawdown [(B) - (A)]: N/A Feet Below Land Surface Test Pumping Rate: 6.5 Gallons Per Minute

Method of measurement (circle one): Steel tape Electric tape  Air line Other (describe): \_\_\_\_\_

**Pump Test Data for Flowing Well**

Measured shut in head: \_\_\_\_\_ feet. N/A

Well yielded \_\_\_\_\_ GPM with a drawdown of \_\_\_\_\_ feet after \_\_\_\_\_ hours of pumping

**Meter Installation**

Meter Manufacturer: \_\_\_\_\_ N/A Meter Serial Number: \_\_\_\_\_

Meter Model Number/Name: \_\_\_\_\_ Type of Meter: \_\_\_\_\_

Totalizer Register Unit and Multiplier Factor (AF x .001, gal x 1000, etc): \_\_\_\_\_

Installation Date: \_\_\_\_\_ Meter installed by: \_\_\_\_\_

Is This Meter (circle one):  New  Repaired  Replacement

*Important: By submitting the above information you are certifying that this meter was installed to manufacturer standards. For agricultural wells, a list of approved meters is on the MDEQ website.*

I HEREBY CERTIFY that the above statements are true to the best of my knowledge

Jack Ridgell 0472 7/3/19 \_\_\_\_\_  
 Print Name of Pump Installer and License No. (if applicable) Date Signature of Pump Installer

RECEIVED  
 JUL 15 2019  
 BY OLWR