

State Well Report

Part 1

Mississippi Department of Environmental Quality
 Office of Land and Water Resources
 P.O. Box 10631
 Jackson, MS 39289-0631
 (601)961-5210
 (601)354-6938 (fax)

County: Harrison
 Permit #: 0239
 Driller: McGill Pump & Well
 Date drilling completed: 11-3-04

For Office Use Only:
 Aquifer: _____
 Well #: C-362 049
 L. S. Elevation: _____
 E-log #: _____

State Law requires that this report be prepared by the driller in detail and filed with the Department within 30 days of completion of drilling of the well.

Well Owner Information	Well Location
Owner Name: <u>Robert Bourdin</u>	Latitude: _____ Longitude: _____
Mailing Address: <u>535 E. Second St.</u>	Method of Lat/Long (circle one): Conventional Survey, USGS quad, Hand-held GPS, Survey-grade GPS
<u>P.C.</u> <u>MS.</u> <u>39571</u>	<u>1/4</u> <u>1/4</u> Sec <u>6</u> Twn <u>5S</u> Rng <u>11W</u>
City State Zip Code	Distance Direction Nearest Town
Telephone No. (____) _____	<u>1</u> Miles <u>E</u> of <u>P.C.</u>

Well Data

Purpose of Well (circle one) Home Industrial Public Supply Irrigation Fish Culture Other: _____

Date well drilling started: 11-2-04 Date well drilling completed: 11-3-04

If flowing, method of flow regulation: Valve _____ Other (describe) _____

Static Water Level: 70 feet above of below (circle one) land surface Date measured: 11-3-04

Method of Measurement (circle one) steel tape electric tape air line other: _____

Hole depth: 440' Well depth: 440' Well grouted to a depth of 10 feet

Type of grout (circle one): Cement Bentonite Mix

Casing length: 420' feet Casing diameter: 4 1/2" inches Type of casing: PVC

Screen length: 20' feet Screen diameter: 2" inches Type of screen: PVC

Screen slot size: 100006 inches Setting depth: From 420 feet to 440 feet

Type of completion (circle all applicable): Gravel packed Underreamed Telescoped Open hole Natural Development

Other (describe): _____

Top of lap pipe or reduction in casing: _____ feet. If telescoped or more than one screen, describe on back of page

Logs run (circle all applicable): No log run Electric Gamma Ray Density Sonic Neutron Other: _____

Name of organization running log(s): _____

RECEIVED
 DEC 28 2004
 BY: OLWR

I certify that the well was drilled, constructed, and completed in accordance with all applicable requirements of the Mississippi Department of Environmental Quality and/or the Mississippi Department of Health regulations and state laws.

McGill Pump & Well 0239 Michael McGill
 Print Name of Water Well Contractor and License No. Signature of Water Well Contractor

STATE WELL REPORT

Part 2

Pump Installer's Completion Report
 Mississippi Department of Environmental Quality
 Office of Land and Water Resources
 P.O. Box 10631
 Jackson, MS 39289-0631
 (601)961-5210
 (601)354-6938 (fax)

County: Starr
 Permit #: 0239
 Driller: McGill Pump & Well
 Date completed: 11-03-04

For Office Use Only:

Aquifer: _____
 Well #: C-362
 Elevation: _____

047

This report should be prepared by the pump installer in detail and filed with the Department within 30 days of the installation of pump.

Well Owner Information	Well Location
Owner Name: <u>Robert Bourdia</u>	Latitude: _____ Longitude: _____
Mailing Address: <u>535 E Second St.</u>	Method of Lat/Long (circle one): Conventional Survey, USGS quad, Hand-held GPS, Survey-grade GPS
<u>P.O. Box 39571</u>	_____ 1/4 _____ 1/4 Sec <u>6</u> Twn <u>55</u> Rng <u>114</u>
City State Zip Code	Distance Direction Nearest Town
Telephone No. (____) _____	<u>1</u> Miles <u>E</u> of <u>P.C.</u>

Pump Type Circle one	Power Type Circle one
Air Lift Jet <input type="radio"/> <u>Submersible</u> <input type="radio"/>	Diesel Engine Gasoline Engine Natural Gas
Bucket Piston <input type="radio"/> Turbine <input type="radio"/>	<u>Electric Motor</u> <input type="radio"/> Hand <input type="radio"/> Tractor PTO
Centrifugal Rotary <input type="radio"/> Flowing Well <input type="radio"/>	Windmill Other (specify): _____
Other (specify): _____	Horse Power Rating of Motor: <u>1</u>
Date Pump Installed: <u>11-3-04</u>	Setting Depth: <u>100</u> feet
Rated Pump Capacity: <u>18</u> Gallons Per Minute	Number of Stages: <u>8</u>

RECEIVED
 DEC 28 2004
 BY: OLWF

Pump Test Data	Method of Measuring Water Level Circle one
Date Well Tested: <u>11-3-04</u>	Air Line Electric Measuring Line <u>Steel Tape</u> <input type="radio"/>
Static Water Level (A): <u>60</u> Feet Below Land Surface	Other (specify): _____
Pumping Water Level (B): <u>100</u> Feet Below Land Surface	For flowing well, measured shut in head: _____ feet
Drawdown [(B) - (A)]: <u>20</u> Feet Below Land Surface	Well yielded <u>18</u> GPM with a drawdown of
Test Pumping Rate: <u>18</u> Gallons Per Minute	<u>20</u> feet after <u>2</u> hours of pumping
Duration of Pump Test (minimum 4 hours): <u>2</u> hours	

I HEREBY CERTIFY that the above statements are true to the best of my knowledge.

McGill Pump & Well 0239 Mike McNeil
 Print Name of Pump Installer and License No. (if applicable) Signature of Pump Installer

If well telescopes please sketch below and show depths.

Ground Level

C-362

047

4" = 200'
2" = 240'

Description of Formations Encountered	From	To
White Sand	0	80
Blue mud	80	240
Blue Sand	240	300
Blue mud	300	390
Blue Sand	390	440

If more than one screen, show location of each on sketch

Sketch the property layout and include the following: 1) the well location; 2) any permanent structures on the property that may aid in locating the well; 3) any roads, power lines, or other items that may aid in locating the property and the well; 4) indicate direction.

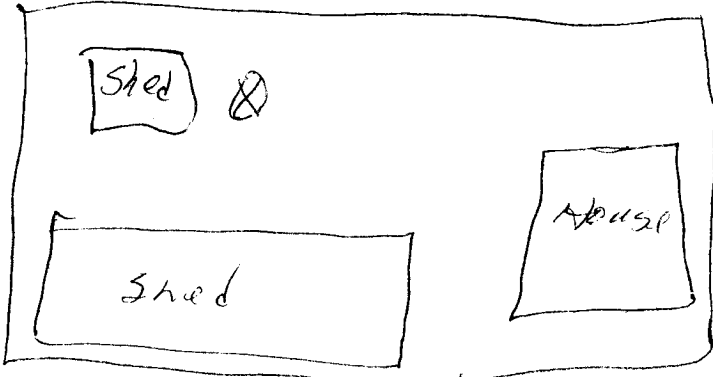

RECEIVED
DEC 28 2004
BY: OLWR

Landowner Name: Robert Bourde

Mike McBee
Signature of Water Well Contractor