

03/14/2008 14:04 FAX 228 832 8883

LENTZ WELL DRILLING INC

007
101

County: Hancock
 Permit #: _____
 Driller: Garry Lentz
 Date drilling completed: 1-19-08

State Well Report
Part 1 - Driller's Log

Mississippi Department of Environmental Quality
 Office of Land and Water Resources
 P.O. Box 10631
 Jackson, MS 39289-0631
 (601)961-5210
 (601)354-6938 (fax)

For Office Use Only:
 Aquifer: _____
 Well #: M-99
 L. S. Elevation: _____
 P-log #: _____

State Law requires that this report be prepared by the license holder responsible for the work and filed with the Department at the above address within 30 days of completion of drilling of the well or borehole.

Information on Well Owner (Landowner if borehole is not for a water well)	Well or Borehole Location
Owner Name: <u>Derby Homes</u>	Latitude: <u>30.17.09"</u> Longitude: <u>089.26.788"</u>
Mailing Address: <u>4758 Leonard Ave</u>	Method of L.A./Long (circle one): <u>Conventional Survey</u>
<u>L. L. High Acres FL 33973</u>	USGS quad: <u>Hand-held GPS</u> , Survey-grade GPS
City State Zip Code	<u>SE 1/4 Sec 1 Twn 9S Rng 15W</u>
Telephone No. <u>239 303-3580</u>	Distance Direction Nearest Town
	Miles of

Well / Borehole Data

Date drilling started: 1-15-08 Date drilling completed: 1-15-08 Hole depth: 17.8' Hole diameter: 7 1/2"

Location of the source of any surface water used for drilling: _____
 Method of dosing and volume of Chlorine used in drilling and development: Woodland City Water

Logs run (circle all applicable): No log run Electric Gamma Ray Density Sonic Neutron Other: _____
 Name of organization running log(s): _____

Purpose of borehole (check one): Water Well Geotechnical/Geological Investigation _____ Ground Source Heat Pump _____
 Seismic Survey _____ Other (describe) _____
If drilling is not related to water well construction, skip the remainder of this block

Purpose of Well (check one): Home Industrial _____ Public Supply _____ Irrigation _____ Fish Culture _____ Other: _____

If a flowing well, method of flow regulation: Valve _____ Other (describe) _____

Static Water Level: _____ feet above or below (circle one) land surface Date measured: _____

Method of Measurement (circle one) steel tape electric tape air line other: _____

Well depth: 175 Well grouted to a depth of 10 feet Type of grout (circle one): Neat Cement Bentonite Mix

Casing length: 155 feet Casing diameter: 4 inches Type of casing: PVC

Screen length: 20 feet Screen diameter: 4 inches Type of screen: PVC

Screen slot size: 6 inches Setting depth: From 155 feet to 175 feet

Type of completion (circle all applicable): Gravel packed Underreamed Telescoped Open hole Natural Development
 Other (describe): _____

Top of lup pipe or reduction in casing: _____ feet. *If telescoped or more than one screen, describe on next page*

03/14/2008 14:04 FAX 228 832 8883

LENTZ WELL DRILLING INC

008

M-99

The sketch below only required for water wells

If well telescopes, show depths on sketch.

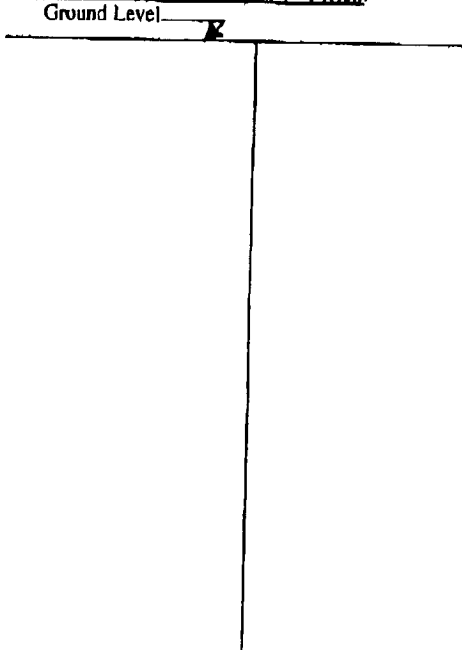

Description of formations encountered must be provided for all wells and boreholes, unless specifically exempted by regulations

Description of Formations Encountered	From (depth)	To (depth)
Clay	Ground Level	10
Sand & Clay	10	130
Clay	130	150
Sand Gravel	150	170

If more than one screen, show location of each on sketch

Sketch the property layout and include the following: 1) the well location; 2) any permanent structures on the property that may aid in locating the well; 3) any roads, power lines, or other items that may aid in locating the property and the well; 4) a north arrow.

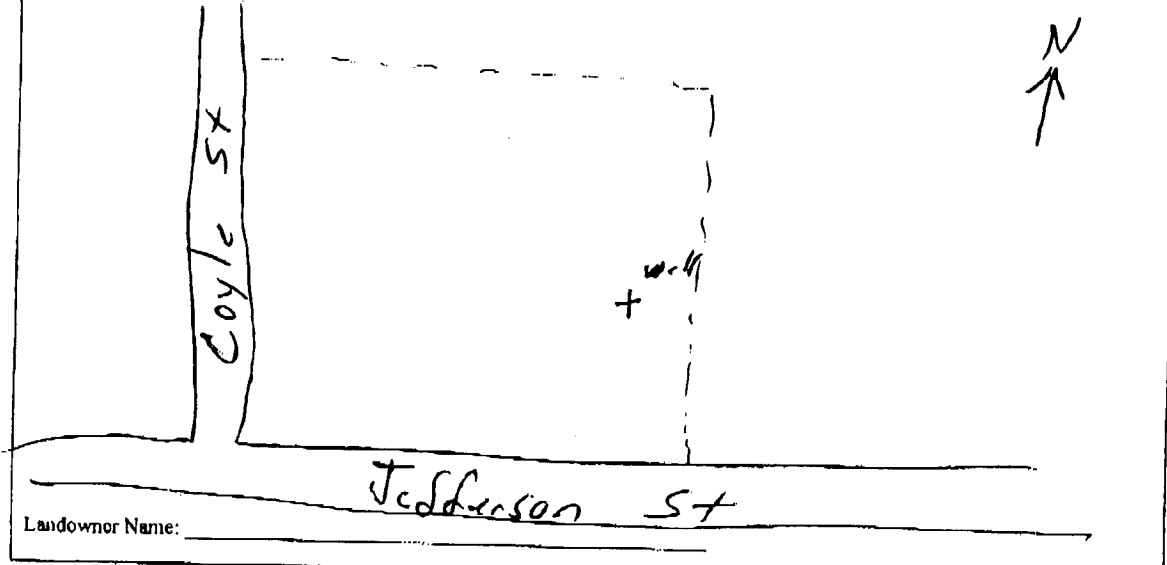

Landowner Name: _____

Form: OLWR-SWR-1A

I certify that the well/borehole was drilled, constructed, and completed in accordance with all applicable requirements of the Mississippi Department of Environmental Quality and the Mississippi Department of Health regulations, if applicable, and state laws.

Garry Lentz 0-794 1-22-08

Print Name of Responsible Licensee and License No.

Date

Signature of Licensee

03/18/2008 08:21 FAX 228 832 8883

LENTZ WELL DRILLING INC

002

#107

STATE WELL REPORT

Part 2

Pump Installer's Completion Report
 Mississippi Department of Environmental Quality
 Office of Land and Water Resources
 P.O. Box 10631
 Jackson, MS 39289-0631
 (601)961-5210
 (601)354-6938 (fax)

County: Hancock
 Permit #: _____
 Driller: Garry Lentz
 Date completed: 1-19-08
Copy information from block on Part 1

For Office Use Only:
 Aquifer: _____
 Well #: M-99
 Elevation: _____

This part of the report must be completed by a licensed water well contractor or a licensed pump installer. A copy of Part 1 of the report must be attached and both parts filed with the Department at the above address within 30 days of well completion.

Well Owner Information	Well Location
Owner Name: <u>Darby Homes</u>	Latitude: <u>30.17.019</u> Longitude: <u>89.26.788</u>
Mailing Address: <u>4758 Leonard Ave</u>	Method of Lat/Long (check one): Conventional Survey _____
<u>Lehigh Acres FL 33973</u>	USGS quad: <u>Hand-held GPS</u> , Survey-grade GPS _____
City State Zip Code	1/4 Sec T R
Telephone No. <u>239 303-3580</u>	Distance Direction Nearest Town
	<u>6</u> Miles <u>W</u> of <u>Waveland</u>

Pump Type Circle one	Power Type Circle one
Air Lift Jet <u>Submersible</u>	Diesel Engine Gasoline Engine Natural Gas
Bucket Piston Turbine	<u>Electric Motor</u> Hand Tractor PTO
Centrifugal Rotary Flowing Well	Windmill Other (specify): _____
Other (specify): _____	Horse Power Rating of Motor: <u>1</u>
Date Pump Installed: <u>3-14-08</u>	Setting Depth: <u>60</u> feet
Rated Pump Capacity: <u>20</u> Gallons Per Minute	Number of Stages: <u>7</u>

Pump Test Data	Method of Measuring Water Level Circle one
Date Well Tested: <u>3-14-08</u>	Air Line Electric Measuring Line <u>Steel Tube</u>
Static Water Level (A): <u>10</u> Feet Below Land Surface	Other (specify): _____
Pumping Water Level (B): <u>40</u> Feet Below Land Surface	For flowing well, measured shut in head: _____ feet
Drawdown [(B) - (A)]: <u>30</u> Feet Below Land Surface	Well yielded <u>20</u> GPM with a drawdown of
Test Pumping Rate: <u>20</u> Gallons Per Minute	<u>30</u> feet after <u>4</u> hours of pumping
Duration of Pump Test (minimum 4 hours): <u>4</u> hours	

I HEREBY CERTIFY that the above statements are true to the best of my knowledge.

Garry Lentz 0-794 _____
 Print Name of Pump Installer and License No. (if applicable) Signature of Pump Installer