

County: Hancock
 Permit #: _____
 Driller: Reece Penton
 Date drilling completed: 5-21-07

State Well Report
Part 1 – Driller's Log

Mississippi Department of Environmental Quality
 Office of Land and Water Resources
 P.O. Box 10631
 Jackson, MS 39289-0631
 (601)961-5210
 (601)354-6938 (fax)

For Office Use Only:
 Aquifer: _____
 Well #: A-53
 L. S. Elevation: _____
 E-log #: _____

State Law requires that this report be prepared by the license holder responsible for the work and filed with the Department at the above address within 30 days of completion of drilling of the well or borehole.

Information on Well Owner (Landowner if borehole is not for a water well)	Well or Borehole Location
Owner Name: <u>Clay Stockstill Builders</u>	Latitude: <u>089° 27' 649"</u> Longitude: <u>30° 33' 918"</u>
Mailing Address: <u>Hwy. 11</u>	Method of Lat/Long (circle one): Conventional Survey, <u>Hand-held GPS</u>
City: <u>Carriere</u> State: <u>Ms.</u> Zip Code: <u>39426</u>	USGS quad, <u>NE SE</u> 1/4 Sec <u>35</u> Twn <u>55</u> Rng <u>15W</u>
Telephone No. <u>(601) 798-1636</u>	Distance _____ Miles _____ Direction _____ of _____ Nearest Town _____

Well / Borehole Data

Date drilling started: 5-20-07 Date drilling completed: 5-21-07 Hole depth: 330 Hole diameter: 5

Location of the source of any surface water used for drilling: _____
 Method of dosing and volume of Chlorine used in drilling and development: _____

Logs run (circle all applicable): No log run Electric Gamma Ray Density Sonic Neutron Other: _____
 Name of organization running log(s): _____

Purpose of borehole (check one): Water Well Geotechnical/Geological Investigation _____ Ground Source Heat Pump _____
 Seismic Survey _____ Other (describe) _____

If drilling is not related to water well construction, skip the remainder of this block

Purpose of Well (check one): Home Industrial _____ Public Supply _____ Irrigation _____ Fish Culture _____ Other: _____

If a flowing well, method of flow regulation: Valve _____ Other (describe) _____

Static Water Level: 75 feet above or below (circle one) land surface Date measured: 6-21-07

Method of Measurement (circle one) steel tape electric tape air line other: _____

Well depth: 330 Well grouted to a depth of 10 feet Type of grout (circle one): Neat Cement Bentonite Mix

Casing length: 320 feet Casing diameter: 2 inches Type of casing: PVC

Screen length: 10 feet Screen diameter: 2 inches Type of screen: PVC

Screen slot size: .010 inches Setting depth: From 320 feet to 330 feet

Type of completion (circle all applicable): Gravel packed Underreamed Telescoped Open hole Natural Development
 Other (describe): _____

Top of lap pipe or reduction in casing: _____ feet. *If telescoped or more than one screen, describe on next page*

Form: OLWR-SWR-1A

RECEIVED
JUN 28 2007
BY: OI W/R

The sketch below only required for water wells

Description of formations encountered must be provided for all wells and boreholes, unless specifically exempted by regulations

If well telescopes, show depths on sketch.

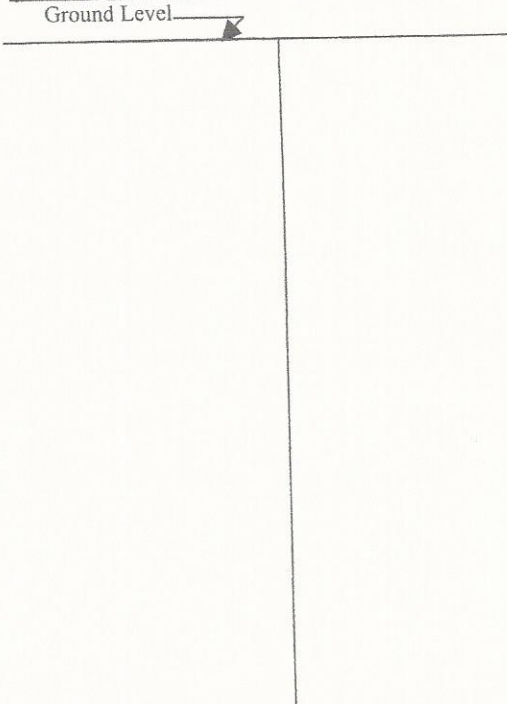

Description of Formations Encountered	From (depth)	To (depth)
ClAY	Ground Level	15
SANd	15	160
Clay	160	175
SANd	175	212
ClAY	212	290
SANd	290	330

If more than one screen, show location of each on sketch

Sketch the property layout and include the following: 1) the well location; 2) any permanent structures on the property that may aid in locating the well; 3) any roads, power lines, or other items that may aid in locating the property and the well; 4) a north arrow.

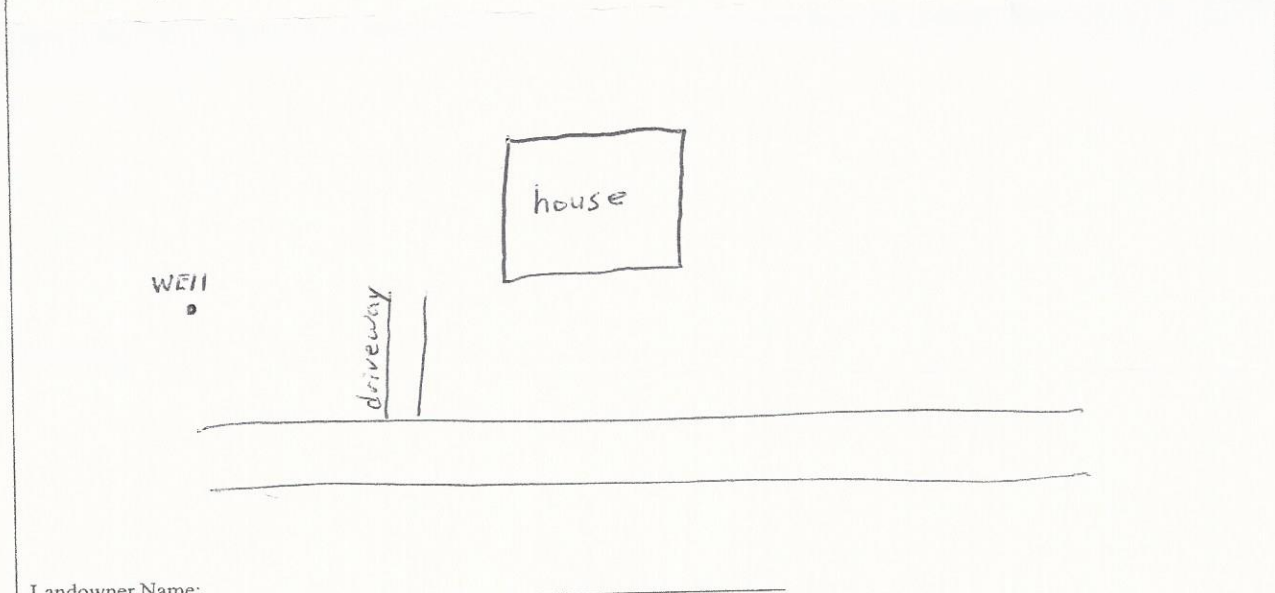

Landowner Name: _____

Form: OLWR-SWR-1A

I certify that the well/borehole was drilled, constructed, and completed in accordance with all applicable requirements of the Mississippi Department of Environmental Quality and the Mississippi Department of Health regulations, if applicable, and state laws.

Reece Penton 0-561
 Print Name of Responsible Licensee and License No.

6-19-07
 Date

Reece Penton
 Signature of Licensee

RECEIVED
 JUN 28 2007
 BY: OLWR

STATE WELL REPORT

Part 2

Pump Installer's Completion Report
 Mississippi Department of Environmental Quality
 Office of Land and Water Resources
 P.O. Box 10631
 Jackson, MS 39289-0631
 (601)961-5210
 (601)354-6938 (fax)

County: Hancock
 Permit #: _____
 Driller: Reece Penton
 Date completed: 5-21-07
Copy information from block on Part 1

For Office Use Only:

Aquifer: _____
 Well #: A-53
 Elevation: _____

This part of the report must be completed by a licensed water well contractor or a licensed pump installer. A copy of Part 1 of the report must be attached and both parts filed with the Department at the above address within 30 days of well completion.

Well Owner Information	Well Location
Owner Name: <u>Clay Stockstill</u>	Latitude: <u>089° 27.649</u> Longitude: <u>30° 33.918</u> <u>39</u> <u>55</u>
Mailing Address: <u>Hwy 11</u>	Method of Lat/Long (check one): Conventional Survey _____, USGS quad _____, Hand-held GPS <input checked="" type="checkbox"/> , Survey-grade GPS _____
<u>Carriere Ms 39426</u> City State Zip Code	1/4 _____ 1/4 Sec _____ T _____ R _____
Telephone No. <u>(601) 798-1626</u>	Distance _____ Direction _____ Nearest Town _____ _____ Miles _____ of _____

Pump Type Circle one	Power Type Circle one
Air Lift <input type="checkbox"/> Jet <input checked="" type="checkbox"/> Submersible <input type="checkbox"/>	Diesel Engine <input type="checkbox"/> Gasoline Engine <input type="checkbox"/> Natural Gas <input type="checkbox"/>
Bucket <input type="checkbox"/> Piston <input type="checkbox"/> Turbine <input type="checkbox"/>	<input checked="" type="checkbox"/> Electric Motor <input type="checkbox"/> Hand <input type="checkbox"/> Tractor PTO <input type="checkbox"/>
Centrifugal <input type="checkbox"/> Rotary <input type="checkbox"/> Flowing Well <input type="checkbox"/>	Windmill <input type="checkbox"/> Other (specify): _____
Other (specify): _____	Horse Power Rating of Motor: <u>1</u>
Date Pump Installed: <u>5-21-07</u>	Setting Depth: <u>85</u> feet
Rated Pump Capacity: <u>10</u> Gallons Per Minute	Number of Stages: <u>2</u>

Pump Test Data	Method of Measuring Water Level Circle one
Date Well Tested: <u>5-21-07</u>	Air Line <input type="checkbox"/> Electric Measuring Line <input type="checkbox"/> <input checked="" type="checkbox"/> Steel Tape
Static Water Level (A): <u>75</u> Feet Below Land Surface	Other (specify): _____
Pumping Water Level (B): <u>85</u> Feet Below Land Surface	For flowing well, measured shut in head: _____ feet
Drawdown [(B) - (A)]: <u>3</u> Feet Below Land Surface	Well yielded <u>10</u> GPM with a drawdown of
Test Pumping Rate: <u>10</u> Gallons Per Minute	<u>3</u> feet after <u>6</u> hours of pumping
Duration of Pump Test (minimum 4 hours): <u>6</u> hours	

I HEREBY CERTIFY that the above statements are true to the best of my knowledge.

Reece Penton
 Print Name of Pump Installer and License No. (if applicable)

Reece Penton
 Signature of Pump Installer

Form: OLWR-SWR-1B
RECEIVED
 JUN 28 2007
 BY: OLWR