

State Well Report

Part 1 - Driller's Log

Mississippi Department of Environmental Quality
Office of Land and Water Resources
P.O. Box 2309
Jackson, MS 39225
(601)961- 5210
(601)961- 5228 (fax)

For Office Use Only:

Aquifer: _____
Well #: T83
L. S. Elevation: _____
E-log #: _____

County: Greene
Permit #: 0-280
Driller: J. Piew
Date drilling completed: 6-30-13

State Law requires that this report be prepared by the license holder responsible for the work and filed with the Department at the above address within 30 days of completion of drilling of the well or borehole.

Information on Well Owner (Landowner if borehole is not for a water well)	Well or Borehole Location
Owner Name: <u>Tom Ryals</u>	Latitude: <u>30° 52' 41"</u> Longitude: <u>88° 41' 32"</u>
Mailing Address: <u>111 J.C. Rice Rd</u>	Method of Lat/Long (circle one): <u>Conventional Survey</u>
<u>Cookville, MS 39562</u>	USGS quad, <u>Hand-held GPS</u> , Survey-grade GPS
City State Zip Code	<u>SW 1/4 Sec 16 Twn 1 N Rng 6 W</u>
Telephone No. <u>(601) 394-3864</u>	Distance <u>3</u> Miles Direction <u>North of Vernal, MS</u>

Well / Borehole Data

Date drilling started: 6-30-13 Date drilling completed: 6-30-13 Hole depth: 115 Hole diameter: 4

Location of the source of any surface water used for drilling: Aquola, MS

Method of dosing and volume of Chlorine used in drilling and development: 2000 water 4 gal chlorine

Logs run (circle all applicable): No log run Electric Gamma Ray Density Sonic Neutron Other: _____

Name of organization running log(s): _____

Purpose of borehole (check one): Water Well Geotechnical/Geological Investigation _____ Ground Source Heat Pump _____

Seismic Survey _____ Other (describe) _____

If drilling is not related to water well construction, skip the remainder of this block

Purpose of Well (check one): Home Industrial _____ Public Supply _____ Irrigation _____ Fish Culture _____ Other: _____

If a flowing well, method of flow regulation: Valve _____ Other (describe) _____

Static Water Level: 5 feet above or below (circle one) land surface Date measured: 5-25-13

Method of Measurement (circle one) steel tape electric tape air line other: _____

Well depth: 115 Well grouted to a depth of 10 feet Type of grout (circle one): Neat Cement Bentonite Mix

Casing length: 100 feet Casing diameter: 4 inches Type of casing: Sch 40 Plastic

Screen length: 15 feet Screen diameter: 4 inches Type of screen: Sch 40 Plastic

Screen slot size: 10 inches Setting depth: From 0 feet to 115 feet

Type of completion (circle all applicable): Gravel packed Underreamed Telescoped Open hole Natural Development

Other (describe): _____

Top of lap pipe or reduction in casing: _____ feet. *If telescoped or more than one screen, describe on next page*

Form: OLWR-SWFA 01/10/10 RECEIVED

JUL 08 2013

BY: OLWR

The sketch below only required for water wells

If well telescopes, show depths on sketch.

Ground Level →

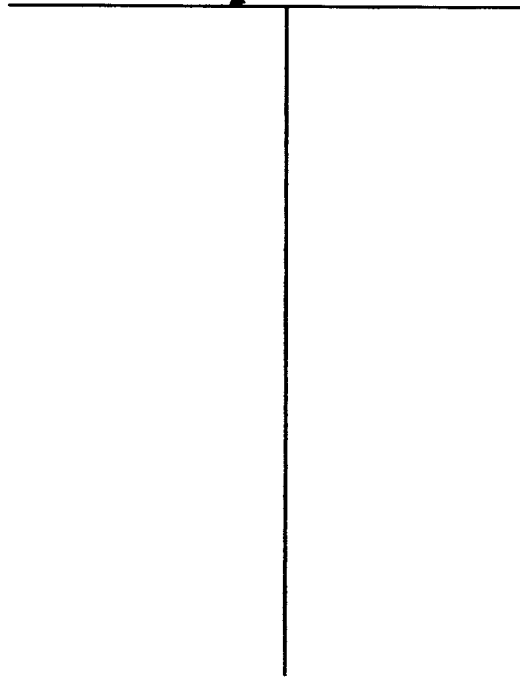

Description of formations encountered must be provided for all wells and boreholes, unless specifically exempted by regulations

Description of Formations Encountered	From (depth)	To (depth)
	Ground Level	
white sand	0	15
green clay	15	70
green sand	70	115

If more than one screen, show location of each on sketch

Sketch the property layout and include the following: 1) the well location; 2) any permanent structures on the property that may aid in locating the well; 3) any roads, power lines, or other items that may aid in locating the property and the well; 4) a north arrow.

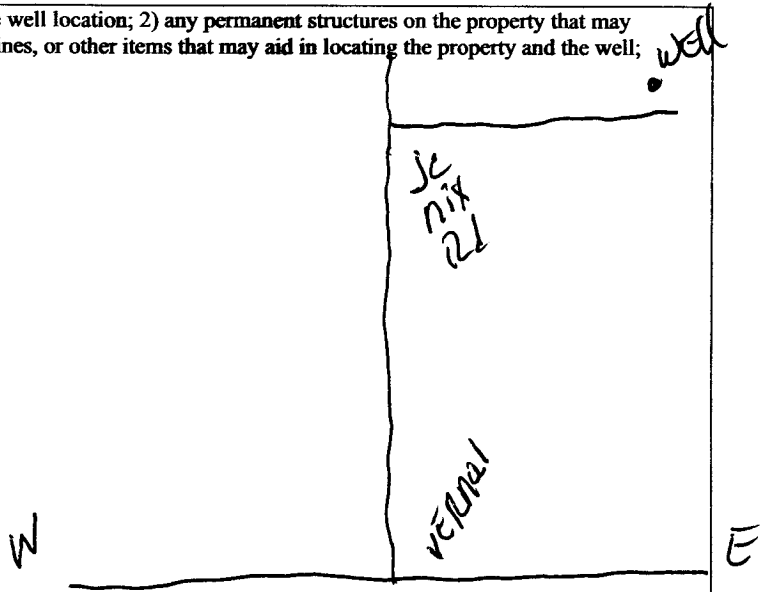

Landowner Name: Tom Ryals

HW 98

Form: OLWR-SWR-1A (04/08)

I certify that the well/borehole was drilled, constructed, and completed in accordance with all applicable requirements of the Mississippi Department of Environmental Quality and the Mississippi Department of Health regulations, if applicable, and state laws.

Joel Pierce 0-780 6-30-13

Joel Pi

RECEIVED

JUL 08 2013

Print Name of Responsible Licensee and License No.

Date

Signature of Licensee

BY: OLWR

STATE WELL REPORT

Part 2

Pump Installer's Completion Report
 Mississippi Department of Environmental Quality
 Office of Land and Water Resources
 P.O. Box 2309
 Jackson, MS 39225
 (601)961-5210
 (601)961-5228 (fax)

For Office Use Only:

Aquifer: _____
 Well #: T83
 Elevation: _____

County: Greene
 Permit #: 0-780
 Driller: J-Piwe
 Date completed: 5-30-13
Copy information from block on Part 1

This part of the report must be completed by a licensed water well contractor or a licensed pump installer. A copy of Part 1 of the report must be attached and both parts filed with the Department at the above address within 30 days of well completion.

Well Owner Information	Well Location
Owner Name: <u>Tom Ryals</u>	Latitude: <u>30 52-41</u> Longitude: <u>88-41-32</u>
Mailing Address: <u>111 J.C. Riv Rd</u>	Method of Lat/Long (check one): Conventional Survey _____
<u>Leaksville MS 39562</u>	USGS quad _____, Hand-held GPS <input checked="" type="checkbox"/> , Survey-grade GPS _____
City State Zip Code	<u>SW 1/4 SE 1/4 Sec 16 T 1N R 6W</u>
Telephone No. <u>(601) 394-3864</u>	Distance Direction Nearest Town <u>3</u> Miles <u>north</u> of <u>Vandal, MS</u>

Pump Type Circle one	Power Type Circle one
Air Lift <input type="checkbox"/> Jet <input type="checkbox"/> <u>Submersible</u>	Diesel Engine <input type="checkbox"/> Gasoline Engine <input type="checkbox"/> Natural Gas <input type="checkbox"/>
Bucket <input type="checkbox"/> Piston <input type="checkbox"/> Turbine <input type="checkbox"/>	<u>Electric Motor</u> <input type="checkbox"/> Hand <input type="checkbox"/> Tractor PTO <input type="checkbox"/>
Centrifugal <input type="checkbox"/> Rotary <input type="checkbox"/> Flowing Well <input type="checkbox"/>	Windmill <input type="checkbox"/> Other (specify): _____
Other (specify): _____	Horse Power Rating of Motor: _____
Date Pump Installed: <u>5-30-13</u>	Setting Depth: <u>60 Drop Pipe</u> feet
Rated Pump Capacity: <u>20</u> Gallons Per Minute	Number of Stages: <u>10</u>

Pump Test Data	Method of Measuring Water Level Circle one
Date Well Tested: <u>5-30-13</u>	<u>Air Line</u> <input type="checkbox"/> Electric Measuring Line <input type="checkbox"/> Steel Tape <input type="checkbox"/>
Static Water Level (A): <u>5</u> Feet Below Land Surface	Other (specify): _____
Pumping Water Level (B): <u>30</u> Feet Below Land Surface	For flowing well, measured shut in head: _____ feet
Drawdown [(B) - (A)]: <u>2</u> Feet Below Land Surface	Well yielded <u>20</u> GPM with a drawdown of
Test Pumping Rate: <u>20</u> Gallons Per Minute	<u>2</u> feet after <u>48</u> hours of pumping
Duration of Pump Test (minimum 4 hours): <u>48</u> hours	

This is for (circle one): New Well Replacement of Existing Pump Repair of Existing Pump

RECEIVED

JUL 08 2013

I HEREBY CERTIFY that the above statements are true to the best of my knowledge.

Joel Piwe 0-780 Joel Piwe
 Print Name of Pump Installer and License No. (if applicable) Signature of Pump Installer

BY: OLWR

T83



Address Lucedale, MS 39452

Get Google Maps on your phone
 Text the word "GMAPS" to 466453

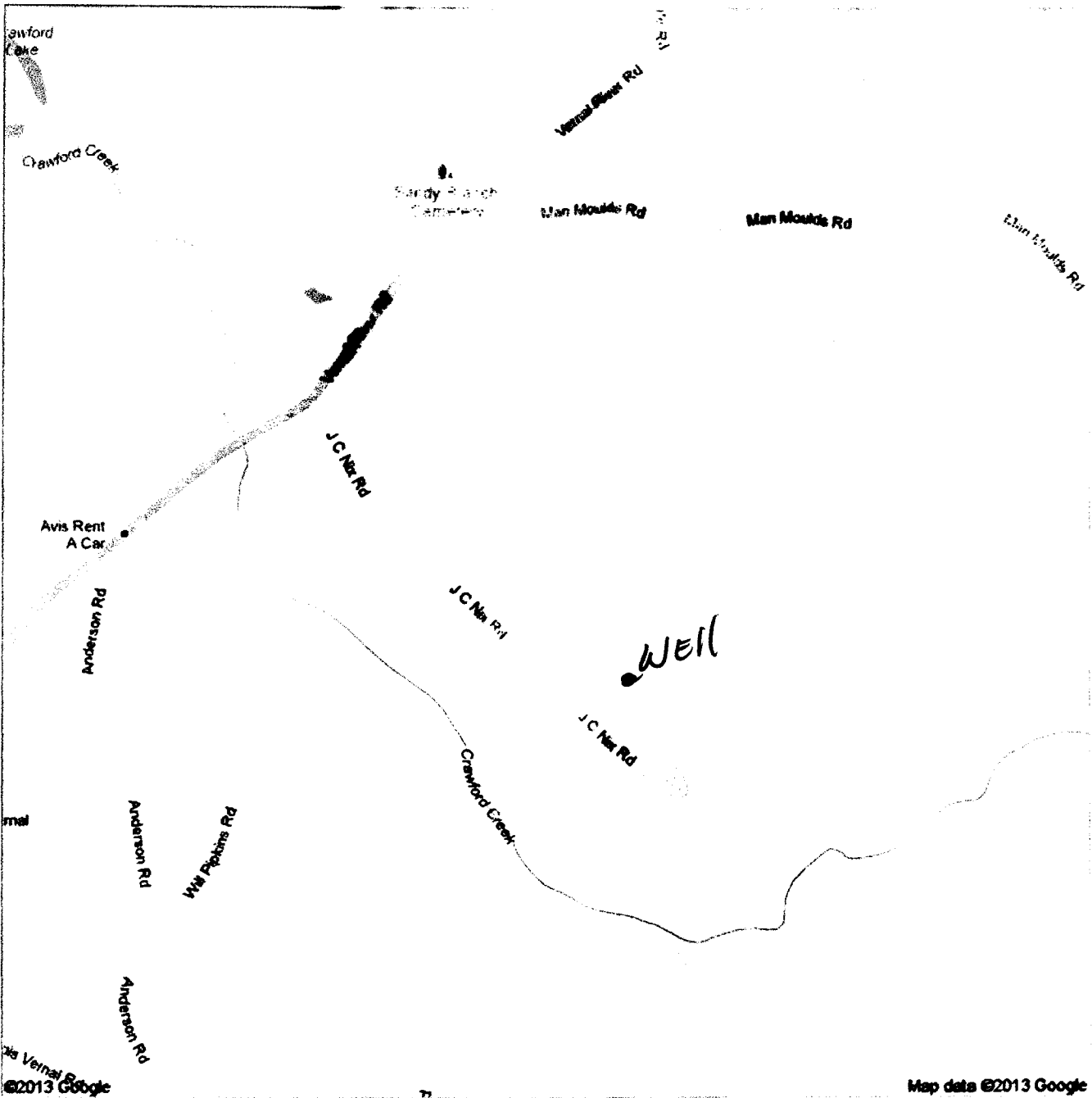
Map data ©2013 Google

RECEIVED

JUL 08 2013

BY: OLWR