

# STATE WELL REPORT

178

County: George  
 Permit #: \_\_\_\_\_  
 Driller: Michael S. Havard  
 Date drilling completed: 1-07-2021

**Part 1**  
**Driller's Log**  
 Mississippi Department of Environmental Quality  
 Office of Land and Water Resources  
 P.O. Box 2309  
 Jackson, MS 39225-2309  
 (601)961-5555  
 (601)961-5228 (fax)

**For Office Use Only:**

Well #: L 257  
 Aquifer: \_\_\_\_\_  
 E-Log #: \_\_\_\_\_

*State Law requires that this report be prepared by the license holder responsible for the work and filed with the Department at the above address within 30 days of completion of drilling of the well or borehole.*

Well Owner Information <small>(Landowner if borehole is not for a water well)</small>	Well or Borehole Location
Owner Name: <u>Eubanks Produce E41 E2</u>	Latitude: <u>30°48'1.62" W</u> Longitude: <u>88°34'58.74" W</u>
Mailing Address: <u>331 Produce Road</u>	Method of Lat/Long (check one): Conventional Survey _____, USGS quad _____, Hand-held GPS _____, Survey-grade GPS _____
<u>Lucedale</u> MS <u>39452</u>	<u>SE</u> ¼ <u>NE</u> ¼, Sec <u>9</u> T <u>T3S</u> R <u>R6W</u>
City State Zip Code	<u>8.3</u> Miles <u>South</u> of <u>Lucedale</u>
Telephone No. (601) <u>947-9661</u>	(Distance) (Direction) (Nearest Town)

**Well / Borehole Data**

Date drilling started: 1-07-2021 Date drilling completed: 1-07-2021 Hole depth: \_\_\_\_\_ Hole diameter: 7.5

Location of the source of any surface water used for drilling: \_\_\_\_\_

Method of dosing and volume of Chlorine used in drilling and development: \_\_\_\_\_

Logs run (check all applicable):  log run  Electric  Gamma Ray  Density  Sonic  Neutron Other: \_\_\_\_\_

Name of organization running log(s): \_\_\_\_\_

Purpose of borehole (check one): Water Well  Geotechnical/Geological Investigation  Ground Source Heat Pump  Seismic Survey Other (describe) \_\_\_\_\_

*If drilling is not related to water well construction, skip the remainder of this block*

Purpose of Well (check all applicable):  Home  Industrial  Public Supply  Irrigation  Fish Culture

Other (describe): \_\_\_\_\_

If a flowing well, method of flow regulation: Valve \_\_\_\_\_ Other (describe) \_\_\_\_\_

Static Water Level: 56 feet  above or  below land surface Date measured: 1-07-2021  
(check one)

Method of measurement (check one)  Steel tape  Electric tape  Air line  Other (describe): \_\_\_\_\_

Well depth: 135 Well grouted to a depth of: 15 feet Type of grout (check one)  Neat Cement  Bentonite  Mix

Casing length: 115 feet Casing diameter: 4 inches Type of casing: PVC 540 BE

Screen length: 20' feet Screen diameter: 4 inches Type of screen: PVC WOP

Screen slot size: .010 inches Setting depth: From 115 feet to 135 feet

Type of completion (check all applicable)  gravel packed  Underreamed  Open hole  Natural Development

Other (describe): \_\_\_\_\_

Top of lap pipe or reduction in casing: \_\_\_\_\_ feet

*If telescoped or more than one screen, describe on next page*

RECEIVED  
 MAR 24 2021  
 BY OLWR

County: George  
Permit #: \_\_\_\_\_

**For Office Use Only:**  
Well #: \_\_\_\_\_

The sketch below only required for water wells  
If well telescopes, show depths on sketch.

Description of formations encountered must be provided for all wells and boreholes, unless specifically exempted by regulations

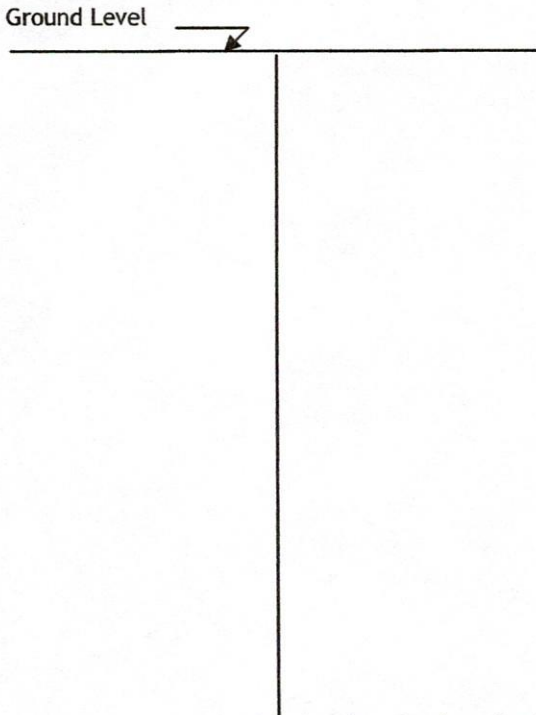

Description of Formations Encountered	From (depth)	To (depth)
Topsand	Ground level	10
Silt	10	25
Clay	25	55
Sand	55	75
Clay	75	105
Sand	105	135

If more than one screen, show location of each on sketch

Sketch the property layout and include the following:

- 1) the well location
- 2) any permanent structures on the property that may aid in locating the well
- 3) any roads, power lines, or other items that may aid in locating the property and the well
- 4) north arrow

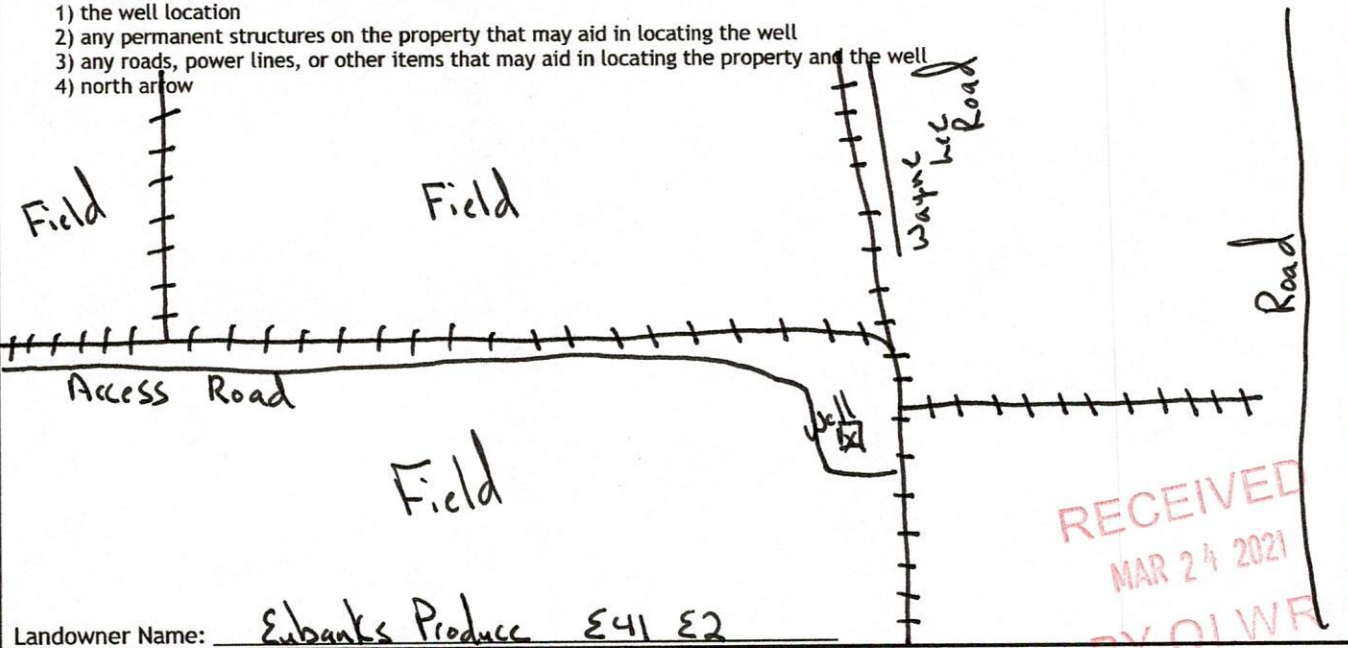

Landowner Name: Ebanks Produce E41 E2

RECEIVED  
MAR 24 2021  
BY OLWF

I HEREBY CERTIFY that the well/borehole was drilled, constructed, and completed in accordance with all applicable requirements of the Mississippi Department of Environmental Quality and the Mississippi Department of Health regulations, if applicable, and state laws.

Michael S. Havard 0-693

1-08-2021

Print Name of Responsible Licensee and License No.

Date

Signature of Licensee

# STATE WELL REPORT

## Part 2

**Pump Installer's Completion Report**  
 Mississippi Department of Environmental Quality  
 Office of Land and Water Resources  
 P.O. Box 2309  
 Jackson, MS 39225-2309  
 (601)961-5210  
 (601) 360-0535 (fax)

**For Office Use Only:**

Well #: L 257  
 Aquifer: \_\_\_\_\_

County: George  
 Permit #: \_\_\_\_\_  
 Driller: Michael S. Havard  
 Date completed: 1-08-2021  
*Copy information from block on Part 1*

*This part of the report must be completed by a licensed water well contractor or a licensed pump installer. A copy of Part 1 of the report must be attached and both parts filed with the Department at the above address within 30 days of well completion.*

Well Owner Information	Well Location
Owner Name: <u>Eubanks Produce 241 E 2</u>	Latitude: <u>30°48'1.62"N</u> Longitude: <u>88°34'58.74"W</u>
Mailing Address: <u>331 Produce Road</u>	Method of Lat/Long (check one): Conventional Survey _____, USGS quad _____, Hand-held GPS _____, Survey-grade GPS _____
<u>Bucadale</u> <u>MS</u> <u>39452</u>	<u>SE</u> ¼ <u>NE</u> ¼, Sec <u>9</u> T <u>T35</u> R <u>R6W</u>
City State Zip Code	<u>8.3</u> Miles <u>South</u> of <u>Bucadale</u>
Telephone No. (601) <u>947-9661</u>	(Distance) (Direction) (Nearest Town)

**Pump Type (check one)**

Submersible  Turbine  Air Lift  Centrifugal  Flowing Well  Jet  Piston  Rotary  Other (describe): \_\_\_\_\_

Date Pump Installed: 1-08-2021 Rated Pump Capacity: 85 Gallons Per Minute

Is This Pump (check one):  New  Repaired  Replacement

**Power Type (check one)**

Electric  Diesel  Gasoline  Natural Gas  Tractor PTO  Windmill  Other (describe): \_\_\_\_\_

Horse Power Rating of Motor: 5 Setting Depth: 105 feet Number of Stages: 14

**Pump Test Data for Non Flowing Well**

Date Well Tested: 1-08-2021 Duration of Pump Test (minimum 4 hours): \_\_\_\_\_ hours

Static Water Level (A): 56 Feet Below Land Surface Pumping Water Level (B): 68 Feet Below Land Surface

Drawdown [(B) - (A)]: 12 Feet Below Land Surface Test Pumping Rate: 75 Gallons Per Minute

Method of measurement (check one): Steel tape  Electric tape  Air line  Other (describe): \_\_\_\_\_

**Pump Test Data for Flowing Well**

Measured shut in head: \_\_\_\_\_ feet.

Well yielded \_\_\_\_\_ GPM with a drawdown of \_\_\_\_\_ feet after \_\_\_\_\_ hours of pumping

**Meter Installation**

Meter Manufacturer: \_\_\_\_\_ Meter Serial Number: \_\_\_\_\_

Meter Model Number/Name: \_\_\_\_\_ Type of Meter: \_\_\_\_\_

Totalizer Register Unit and Multiplier Factor (AF x .001, gal x 1000, etc): \_\_\_\_\_

Installation Date: \_\_\_\_\_ Meter installed by: \_\_\_\_\_

Is This Meter (check one):  New  Repaired  Replacement

*Important: By submitting the above information you are certifying that this meter was installed to manufacturer standards. For agricultural wells, a list of approved meters is on the MDEQ website.*

RECEIVED  
 MAR 24 2021  
 BY OLWR

I HEREBY CERTIFY that the above statements are true to the best of my knowledge.

Michael S. Havard 0-673 1-08-2021 [Signature]  
 Print Name of Pump Installer and License No. (if applicable) Date Signature of Pump Installer

# Eubanks Produce

E41 East

Legend  
R28

E41 E2

Waynelee Rd  
E41 E1

Google Earth

© 2021 Google

500 ft

