

STATE WELL REPORT

178

County: George
 Permit #: _____
 Driller: Michael S. Havard
 Date drilling completed: 1-04-2021

Part 1
Driller's Log
 Mississippi Department of Environmental Quality
 Office of Land and Water Resources
 P.O. Box 2309
 Jackson, MS 39225-2309
 (601)961-5555
 (601)961-5228 (fax)

For Office Use Only:

Well #: L 256
 Aquifer: _____
 E-Log #: _____

State Law requires that this report be prepared by the license holder responsible for the work and filed with the Department at the above address within 30 days of completion of drilling of the well or borehole.

Well Owner Information <small>(Landowner if borehole is not for a water well)</small>	Well or Borehole Location
Owner Name: <u>Eubanks Produce E41 E1</u>	Latitude: <u>30°48'2.44"N</u> Longitude: <u>88°34'58.81"W</u>
Mailing Address: <u>331 Produce Road</u>	Method of Lat/Long (check one): Conventional Survey _____ USGS quad _____, Hand-held GPS _____, Survey-grade GPS _____
<u>Lucedale</u> MS <u>39452</u>	<u>SE</u> ¼ <u>NE</u> ¼, Sec <u>9</u> T <u>T3S</u> R <u>R6W</u>
City State Zip Code	<u>8.3</u> Miles <u>South</u> of <u>Lucedale</u>
Telephone No. (601) <u>947-9461</u>	(Distance) (Direction) (Nearest Town)

Well / Borehole Data

Date drilling started: 1-04-2021 Date drilling completed: 1-04-2021 Hole depth: 136' Hole diameter: 7.5

Location of the source of any surface water used for drilling: _____

Method of dosing and volume of Chlorine used in drilling and development: _____

Logs run (check all applicable): log run Electric Gamma Ray Density Sonic Neutron Other: _____

Name of organization running log(s): _____

Purpose of borehole (check one): Water Well Geotechnical/Geological Investigation Ground Source Heat Pump
 Seismic Survey Other (describe) _____

If drilling is not related to water well construction, skip the remainder of this block

Purpose of Well (check all applicable): Home Industrial Public Supply Irrigation Fish Culture
 Other (describe): _____

If a flowing well, method of flow regulation: Valve _____ Other (describe) _____

Static Water Level: 55 feet above or below land surface Date measured: 1-05-2021

RECEIVED
MAR 24 2021
BY OLWR

Method of measurement (check one) Steel tape Electric tape Air line Other (describe): _____

Well depth: 136' Well grouted to a depth of: 15' feet Type of grout (check one) Neat Cement Bentonite Mix

Casing length: 116' feet Casing diameter: 4" inches Type of casing: PVC 540 BE

Screen length: 20' feet Screen diameter: 4" inches Type of screen: PVC WOP

Screen slot size: .010 inches Setting depth: From 116' feet to 136' feet

Type of completion (check all applicable) gravel packed Underreamed Open hole Natural Development
 Other (describe): _____

Top of lap pipe or reduction in casing: _____ feet

If telescoped or more than one screen, describe on next page

County: George
Permit #: _____

For Office Use Only:
Well #: _____

The sketch below only required for water wells
If well telescopes, show depths on sketch.

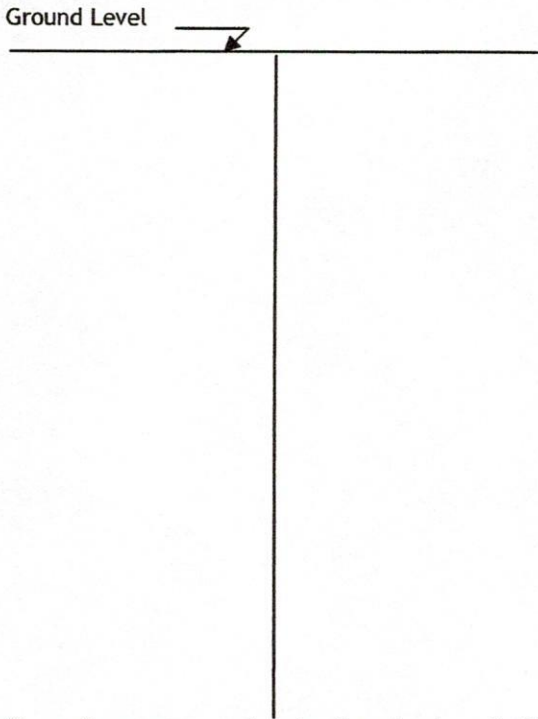

Description of formations encountered must be provided for all wells and boreholes, unless specifically exempted by regulations

Description of Formations Encountered	From (depth)	To (depth)
Topsand	Ground level	10
Silt	10	25
Clay	25	55
Sand	55	75
Clay	75	105
Sand	105	136

If more than one screen, show location of each on sketch

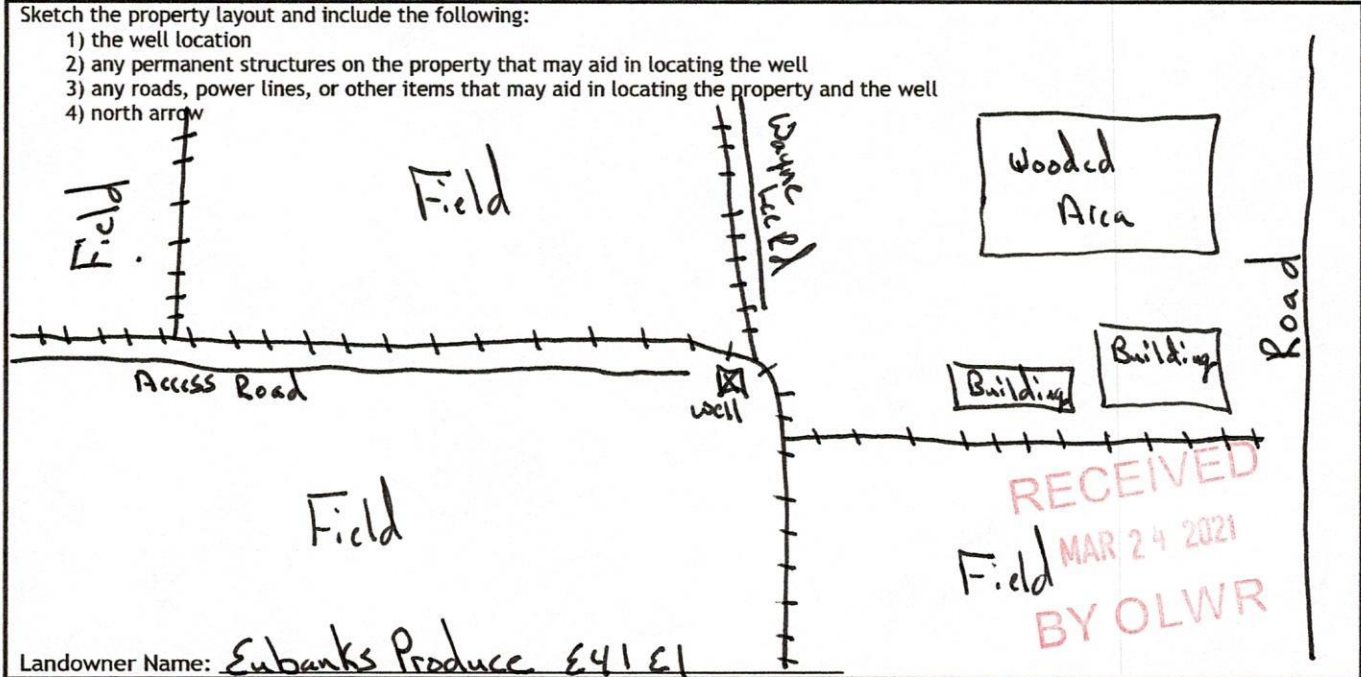

I HEREBY CERTIFY that the well/borehole was drilled, constructed, and completed in accordance with all applicable requirements of the Mississippi Department of Environmental Quality and the Mississippi Department of Health regulations, if applicable, and state laws.

Michael S. Harvard 0-673 1-08-2021 [Signature]
Print Name of Responsible Licensee and License No. Date Signature of Licensee

STATE WELL REPORT

Part 2

Pump Installer's Completion Report
 Mississippi Department of Environmental Quality
 Office of Land and Water Resources
 P.O. Box 2309
 Jackson, MS 39225-2309
 (601)961-5210
 (601) 360-0535 (fax)

For Office Use Only:

Well #: L 256
 Aquifer: _____

County: George
 Permit #: _____
 Driller: Michael S. Havard
 Date completed: 1-05-2021
Copy information from block on Part 1

This part of the report must be completed by a licensed water well contractor or a licensed pump installer. A copy of Part 1 of the report must be attached and both parts filed with the Department at the above address within 30 days of well completion.

Well Owner Information	Well Location
Owner Name: <u>Eubanks Produce E41 E1</u>	Latitude: <u>30°48'2.44"N</u> Longitude: <u>88°34'58.81"W</u>
Mailing Address: <u>331 Produce Road</u>	Method of Lat/Long (check one): Conventional Survey _____, USGS quad _____, Hand-held GPS _____, Survey-grade GPS _____
<u>Lucedale</u> <u>MS</u> <u>39452</u>	<u>SE</u> ¼ <u>NE</u> ¼, Sec <u>9</u> T <u>T3S</u> R <u>R6W</u>
City State Zip Code	<u>8.3</u> Miles <u>South</u> of <u>Lucedale</u>
Telephone No. <u>(601) 949-9461</u>	(Distance) (Direction) (Nearest Town)

Pump Type (check one)

Submersible Turbine Air Lift Centrifugal Flowing Well Jet Piston Rotary Other (describe): _____

Date Pump Installed: 1-05-2021 Rated Pump Capacity: 85 Gallons Per Minute

Is This Pump (check one): New Repaired Replacement

Power Type (check one)

Electric Diesel Gasoline Natural Gas Tractor PTO Windmill Other (describe): _____

Horse Power Rating of Motor: 5 Setting Depth: 105 feet Number of Stages: 14

Pump Test Data for Non Flowing Well

Date Well Tested: 105-2021 Duration of Pump Test (minimum 4 hours): _____ hours

Static Water Level (A): 55 Feet Below Land Surface Pumping Water Level (B): 68 Feet Below Land Surface

Drawdown [(B) - (A)]: 13 Feet Below Land Surface Test Pumping Rate: 75 Gallons Per Minute

Method of measurement (check one): Steel tape Electric tape Air line Other (describe): _____

Pump Test Data for Flowing Well

Measured shut in head: _____ feet.

Well yielded _____ GPM with a drawdown of _____ feet after _____ hours of pumping

Meter Installation

Meter Manufacturer: _____ Meter Serial Number: _____

Meter Model Number/Name: _____ Type of Meter: _____

Totalizer Register Unit and Multiplier Factor (AF x .001, gal x 1000, etc): _____

Installation Date: _____ Meter installed by: _____

Is This Meter (check one): New Repaired Replacement

RECEIVED
MAR 24 2021
BY OLWR

Important: By submitting the above information you are certifying that this meter was installed to manufacturer standards. For agricultural wells, a list of approved meters is on the MDEQ website.

I HEREBY CERTIFY that the above statements are true to the best of my knowledge.

Michael S. Havard 0-623 1-08-2021 [Signature]

Print Name of Pump Installer and License No. (if applicable) Date Signature of Pump Installer

Eubanks Produce

E41 East

Legend
R28

Wayne Lee Rd
E41 E1
E41 E2

500 ft



Google Earth

© 2021 Google