

State Well Report

Part 1

Mississippi Department of Environmental Quality
Office of Land and Water Resources
P.O. Box 10631
Jackson, MS 39289-0631
(601) 961-5210
(601) 354-6938 (fax)

County: GEORGE
Permit #: _____
Driller: Coast Water Well Serv.
Date drilling completed: 8/31/10

For Office Use Only:
Aquifer: L 209
Well #: _____
L. S. Elevation: _____
E-log #: _____

State Law requires that this report be prepared by the driller in detail and filed with the Department within 30 days of completion of drilling of the well.

Well Owner Information	Well Location
Owner Name: <u>Alesa Kline</u>	Latitude: <u>30.44</u> Longitude: <u>88.32</u>
Mailing Address: <u>Folkston Rd.</u>	Method of Lat/Long (circle one): Conventional Survey, <u>Hand-held GPS</u>
<u>Dean Nursery Road</u>	USGS quad: <u>5W 5N 36</u> Sec <u>36</u> Twn <u>T35</u> Rng <u>R6W</u>
<u>Lucedale, MS 39452</u>	Distance: <u>5</u> Miles Direction: <u>South</u> of Nearest Town: <u>Agarcola</u>
City: _____ State: _____ Zip Code: _____	
Telephone No. <u>601-217-6916</u>	

Well Data

Purpose of Well (circle one) Home Industrial Public Supply Irrigation Fish Culture Other: _____

Date well drilling started: 8/31/10 Date well drilling completed: 8/31/10

If flowing, method of flow regulation: Valve N/A Other (describe) _____

Static Water Level: 40 feet above or below (circle one) land surface Date measured: 8/31/10

Method of Measurement (circle one) steel tape electric tape air line other: _____

Hole depth: 75 FT. Well depth: 75 FT. Well grouted to a depth of 10 feet

Type of grout (circle one): Cement Bentonite Mix

Casing length: 65 feet Casing diameter: 2 inches Type of casing: PVC

Screen length: 10 feet Screen diameter: 2 inches Type of screen: PVC

Screen slot size: .006 inches Setting depth: From 65 feet to 75 feet

Type of completion (circle all applicable): Gravel packed Underreamed Telescoped Open hole Natural Development

Other (describe): _____

Top of lap pipe or reduction in casing: N/A feet. If telescoped or more than one screen, describe on back of page

Logs run (circle all applicable): No log run Electric Gamma Ray Density Sonic Neutron Other: _____

Name of organization running log(s): N/A

I certify that the well was drilled, constructed, and completed in accordance with all applicable requirements of the Mississippi Department of Environmental Quality and/or the Mississippi Department of Health regulations and state laws.

Jack Ridgdell 0-472
Print Name of Water Well Contractor and License No.

Jack Ridgdell
Signature of Water Well Contractor

BY: GINP

If well telescopes please sketch below and show depths.

Ground Level

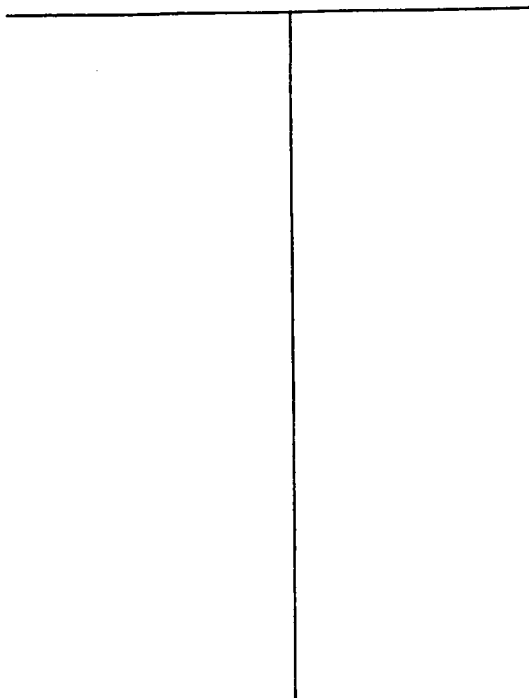

Description of Formations Encountered	From	To
Brown Coarse Sand	0	30
Orange and Blue Clay	30	58
Gray Medium Sand	58	75

If more than one screen, show location of each on sketch

Sketch the property layout and include the following: 1) the well location; 2) any permanent structures on the property that may aid in locating the well; 3) any roads, power lines, or other items that may aid in locating the property and the well; 4) indicate direction.

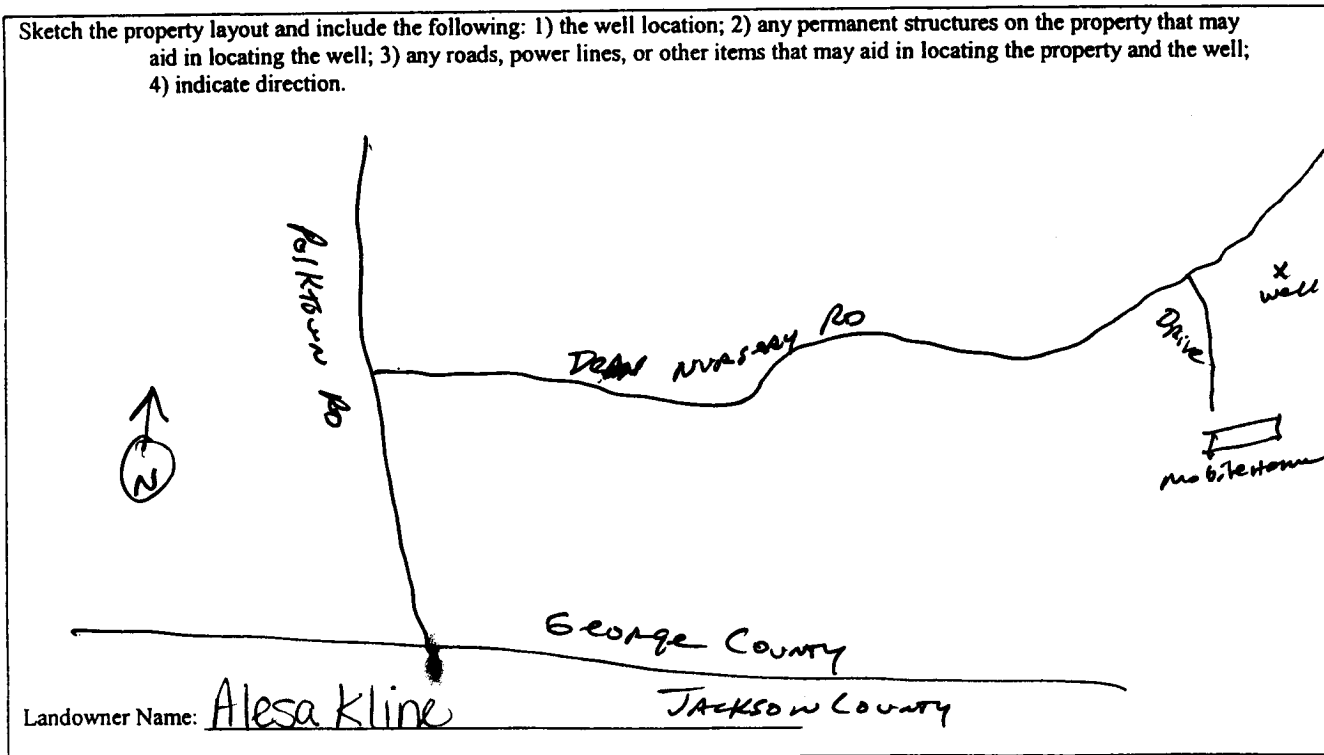

Jack Ripple
Signature of Water Well Contractor

RECEIVED
SEP 22 2013
BY: ONAF

STATE WELL REPORT

Part 2

Pump Installer's Completion Report
Mississippi Department of Environmental Quality
Office of Land and Water Resources
P.O. Box 10631
Jackson, MS 39289-0631
(601) 961-5210
(601) 354-6938 (fax)

For Office Use Only:

Aquifer: L209
Well #: _____
Elevation: _____

County: George
Permit #: _____
Driller: Coast Water Wells Serv.
Date completed: 8/31/10

This report should be prepared by the pump installer in detail and filed with the Department within 30 days of the installation of pump.

Well Owner Information	Well Location
Owner Name: <u>Alesa Kline</u>	Latitude: <u>30° 44' 14.22</u> Longitude: <u>088° 32' 28.02"</u>
Mailing Address: <u>Folkston Rd.</u> <u>Dean Nursery Rd</u> <u>Lucedale, Ms 39452</u> City State Zip Code	Method of Lat/Long (circle one): Conventional Survey, USGS quad, <u>Hand-held GPS</u> Survey-grade GPS <u>SE 1/4 SW 1/4 Sec 36 Twn T35 Rng R6W</u>
Telephone No. <u>(228) 217-6916</u>	Distance Direction Nearest Town <u>5</u> Miles <u>South</u> of <u>Agriola</u>

Pump Type Circle one	Power Type Circle one
Air Lift <u>Jet</u> Submersible	Diesel Engine Gasoline Engine Natural Gas
Bucket Piston Turbine	<u>Electric Motor</u> Hand Tractor PTO
Centrifugal Rotary Flowing Well	Windmill Other (specify): _____
Other (specify): _____	Horse Power Rating of Motor: <u>1 HP</u>
Date Pump Installed: <u>9/18/10</u>	Setting Depth: <u>60 FT. Drop Pipe</u> feet
Rated Pump Capacity: <u>8</u> Gallons Per Minute	Number of Stages: <u>2</u>

Pump Test Data	Method of Measuring Water Level Circle one
Date Well Tested: <u>9/18/10</u>	<u>Air Line</u> Electric Measuring Line Steel Tape
Static Water Level (A): <u>40</u> Feet Below Land Surface	Other (specify): _____
Pumping Water Level (B): <u>N/A</u> Feet Below Land Surface	For flowing well, measured shut in head: <u>N/A</u> feet
Drawdown [(B) - (A)]: <u>N/A</u> Feet Below Land Surface	Well yielded <u>18</u> GPM with a drawdown of
Test Pumping Rate: <u>8</u> Gallons Per Minute	<u>N/A</u> feet after <u>N/A</u> hours of pumping
Duration of Pump Test (minimum 4 hours): <u>5</u> hours	

I HEREBY CERTIFY that the above statements are true to the best of my knowledge.
Jack Ridgell 0-472
Print Name of Pump Installer and License No. (if applicable)
[Signature]
Signature of Pump Installer

RECEIVED
SEP 22 2010
EVALUATION