

County: George
 Permit #: _____
 Driller: Mrs J Ward
 Date drilling completed: 8-29-08

State Well Report
Part I - Driller's Log
 Mississippi Department of Environmental Quality
 Office of Land and Water Resources
 P.O. Box 10631
 Jackson, MS 39289-0631
 (601)961-5210
 (601)354-6938 (fax)

For Office Use Only:
 Aquifer: _____
 Well #: L-191
 L. S. Elevation: _____
 E-log #: _____

State Law requires that this report be prepared by the license holder responsible for the work and filed with the Department at the above address within 30 days of completion of drilling of the well or borehole.

Information on Well Owner (Landowner if borehole is not for a water well)	Well or Borehole Location
Owner Name: <u>Mark Colman</u>	Latitude: <u>30° 47' 17"</u> Longitude: <u>88° 36' 14"</u>
Mailing Address: <u>11187 Dewey Lawrence Ct</u>	Method of Lat/Long (circle one): Conventional Survey, USGS quad, Hand-held GPS, Survey-grade GPS
<u>DeBervilly Ms 39540</u>	<u>SW 1/4 NE 1/4 Sec 17 Twn T35 Rng R6W</u>
City State Zip Code	Distance Direction Nearest Town
Telephone No. () _____	<u>8</u> Miles <u>S</u> of <u>Lucedal</u>

Well / Borehole Data

Date drilling started: 8-29-08 Date drilling completed: 8-29-08 Hole depth: 90 Hole diameter: 7 1/2

Location of the source of any surface water used for drilling: NONE

Method of dosing and volume of Chlorine used in drilling and development: _____

Logs run (circle all applicable): No log run Electric Gamma Ray Density Sonic Neutron Other: _____

Name of organization running log(s): _____

Purpose of borehole (check one): Water Well Geotechnical/Geological Investigation _____ Ground Source Heat Pump _____

Seismic Survey _____ Other (describe) _____

If drilling is not related to water well construction, skip the remainder of this block

Purpose of Well (check one): Home Industrial _____ Public Supply _____ Irrigation _____ Fish Culture _____ Other: _____

If a flowing well, method of flow regulation: Valve _____ Other (describe) _____

Static Water Level: 45 feet above or below (circle one) land surface Date measured: _____

Method of Measurement (circle one) steel tape electric tape air line other: _____

Well depth: 90 Well grouted to a depth of 10 feet Type of grout (circle one): Neat Cement Bentonite Mix

Casing length: 80 feet Casing diameter: 4 inches Type of casing: PVC 40

Screen length: 10 feet Screen diameter: 4 inches Type of screen: PVC wrapped

Screen slot size: 10 inches Setting depth: From 80 feet to 90 feet

Type of completion (circle all applicable): Gravel packed Underreamed Telescoped Open hole Natural Development

Other (describe): _____

Top of tap pipe or reduction in casing: _____ feet. *If telescoped or more than one screen, describe on next page*

Form: OLWR-SWR-1A

RECEIVED
 OCT 03 2008
 BY: OLWR

The sketch below only required for water wells

If well telescopes, show depths on sketch

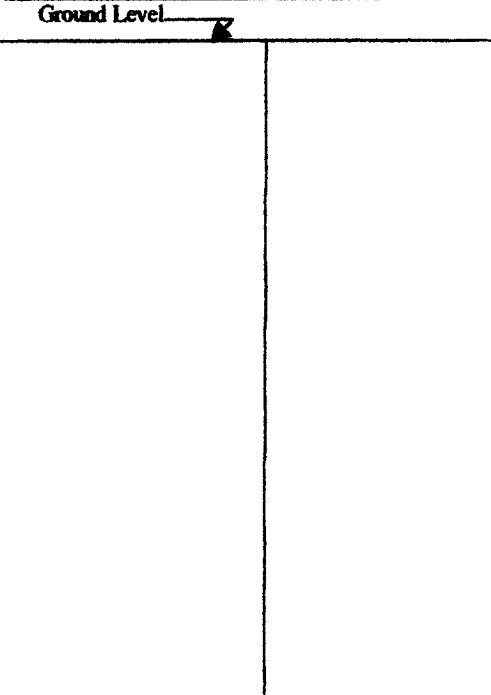

Description of formations encountered must be provided for all wells and boreholes, unless specifically exempted by regulations

Description of Formations Encountered	From (depth)	To (depth)
	Ground Level	
Clay	0	25
Sand	25	48
Clay	48	52
sand	52	90

If more than one screen, show location of each on sketch

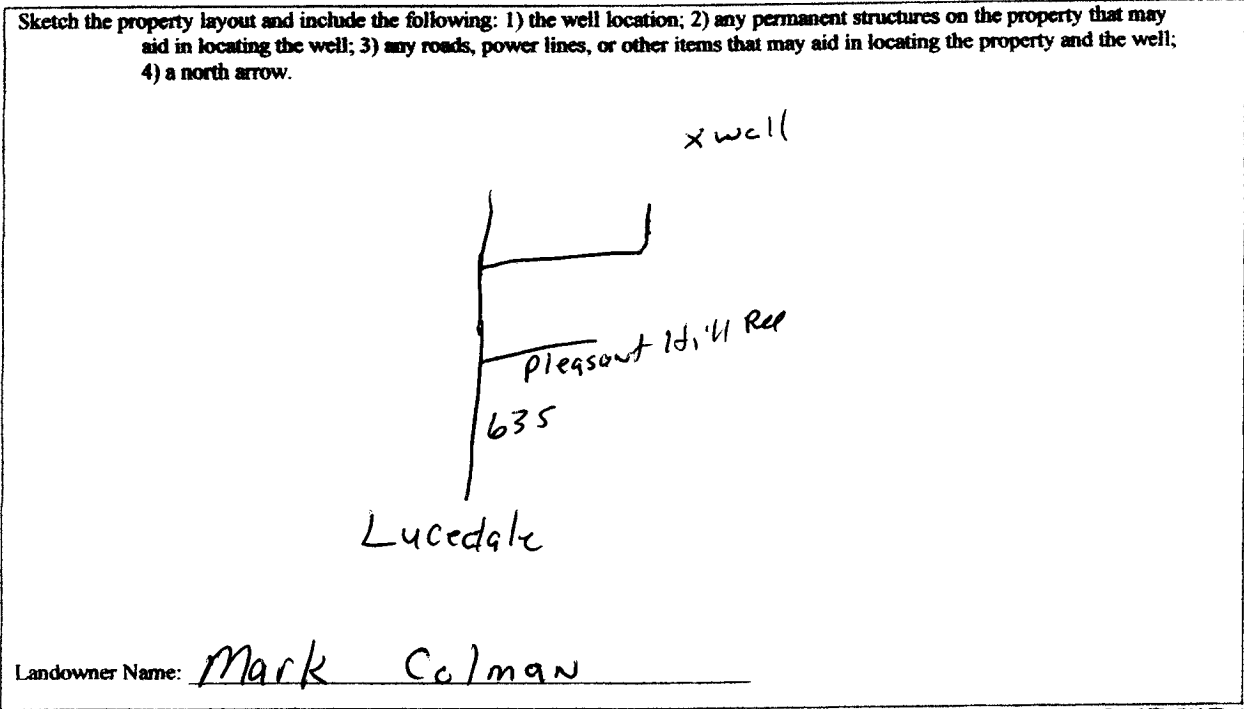

Form: OLWR-SWR-1A

I certify that the well/borehole was drilled, constructed, and completed in accordance with all applicable requirements of the Mississippi Department of Environmental Quality and the Mississippi Department of Health regulations, if applicable, and state laws.

Michael R Fry Fogel 0408 8-29-08
Print Name of Responsible Licensee and License No. Date

Michael R Fryfogel
Signature of Licensee

RECEIVED
OCT 03 2008
BY: OLWR

STATE WELL REPORT

Part 2

Pump Installer's Completion Report
 Mississippi Department of Environmental Quality
 Office of Land and Water Resources
 P.O. Box 10631
 Jackson, MS 39289-0631
 (601)961-5210
 (601)354-6938 (fax)

For Office Use Only:

Aquifer: _____
 Well #: L-191
 Elevation: _____

County: DeSoto
 Permit #: _____
 Driller: Mike + Wade
 Date completed: 8-29-08
Copy information from block on Part 1

This part of the report must be completed by a licensed water well contractor or a licensed pump installer. A copy of Part 1 of the report must be attached and both parts filed with the Department at the above address within 30 days of well completion.

Well Owner Information	Well Location
Owner Name: <u>Mark Colman</u>	Latitude: _____ Longitude: _____
Mailing Address: <u>11187 Dewey Lawrence Cir</u>	Method of Lat/Long (check one): Conventional Survey _____
<u>DeBerville Ms 39540</u>	USGS quad _____, Hand-held GPS _____, Survey-grade GPS _____
City State Zip Code	_____ 1/4 _____ 1/4 Sec <u>17</u> T <u>T35</u> R <u>R6W</u>
Telephone No. () _____	Distance Direction Nearest Town
	<u>8</u> Miles <u>5</u> of <u>Lucedale</u>

Pump Type Circle one	Power Type Circle one
Air Lift Jet <input type="radio"/> <input checked="" type="radio"/> <u>Submersible</u>	Diesel Engine Gasoline Engine Natural Gas
Bucket Piston <input type="radio"/> Turbine <input type="radio"/>	<input checked="" type="radio"/> <u>Electric Motor</u> Hand <input type="radio"/> Tractor PTO
Centrifugal Rotary <input type="radio"/> Flowing Well <input type="radio"/>	Windmill Other (specify): _____
Other (specify): _____	Horse Power Rating of Motor: <u>1</u>
Date Pump Installed: <u>8-29-08</u>	Setting Depth: <u>90</u> feet
Rated Pump Capacity: <u>19</u> Gallons Per Minute	Number of Stages: <u>9</u>

Pump Test Data	Method of Measuring Water Level Circle one
Date Well Tested: <u>8-29-08</u>	Air Line Electric Measuring Line Steel Tape
Static Water Level (A): <u>45</u> Feet Below Land Surface	Other (specify): _____
Pumping Water Level (B): <u>65</u> Feet Below Land Surface	For flowing well, measured shut in head: _____ feet
Drawdown [(B) - (A)]: <u>20</u> Feet Below Land Surface	Well yielded <u>30</u> GPM with a drawdown of
Test Pumping Rate: <u>30</u> Gallons Per Minute	<u>20</u> feet after <u>1 1/2</u> hours of pumping
Duration of Pump Test (minimum 4 hours): <u>4</u> hours	

I HEREBY CERTIFY that the above statements are true to the best of my knowledge.

Michael R Fry Taylor 10408 Michael R Fry Taylor
 Print Name of Pump Installer and License No. (if applicable) Signature of Pump Installer

Form: OLWR-SWR-1B

RECEIVED
 OCT 03 2008
 BY: OLWR