

State Well Report

Part 1 - Driller's Log

Mississippi Department of Environmental Quality
Office of Land and Water Resources
P.O. Box 2309
Jackson, MS 39225
(601)961- 5210
(601)961- 5228 (fax)

For Office Use Only:

Aquifer: _____
Well #: G193
L. S. Elevation: _____
E-log #: _____

County: DeWitt
Permit #: 0-780
Driller: Joel Peul
Date drilling completed: 6-22-12

State Law requires that this report be prepared by the license holder responsible for the work and filed with the Department at the above address within 30 days of completion of drilling of the well or borehole.

Information on Well Owner (Landowner if borehole is not for a water well)	Well or Borehole Location
Owner Name: <u>Frank Howell</u>	Latitude: <u>30° 51' 28.17"</u> Longitude: <u>88° 34' 20.12"</u>
Mailing Address: <u>263 E Vernon Howell Rd</u>	Method of Lat/Long (circle one): <u>Conventional Survey</u>
<u>Lumbia</u> MS <u>39452</u>	USGS quad, Hand-held GPS, Survey-grade GPS
City State Zip Code	<u>SE 1/4 NW 1/4 Sec 27 Twn 25 Rng 6W</u>
Telephone No. <u>(601) 508-2091</u>	Distance <u>5</u> Miles <u>NW</u> of <u>Agua, MS</u>

Well / Borehole Data

Date drilling started: 6-22 Date drilling completed: 6-22 Hole depth: 100 Hole diameter: 4

Location of the source of any surface water used for drilling: Agua, MS
Method of dosing and volume of Chlorine used in drilling and development: 2000 water 4gal chlor

Logs run (circle all applicable): No log run Electric Gamma Ray Density Sonic Neutron Other: _____
Name of organization running log(s): _____

Purpose of borehole (check one): Water Well Geotechnical/Geological Investigation Ground Source Heat Pump
Seismic Survey Other (describe) _____

If drilling is not related to water well construction, skip the remainder of this block

Purpose of Well (check one): Home Industrial Public Supply Irrigation Fish Culture Other: _____

If a flowing well, method of flow regulation: Valve _____ Other (describe) _____

Static Water Level: 2 feet above or below (circle one) land surface Date measured: 6-22-12

Method of Measurement (circle one) steel tape electric tape air line other: _____

Well depth: 100 Well grouted to a depth of 10 feet Type of grout (circle one): Neat Cement Bentonite Mix

Casing length: 90 feet Casing diameter: 4 inches Type of casing: Plastic

Screen length: 10 feet Screen diameter: 4 inches Type of screen: Plastic

Screen slot size: 10 inches Setting depth: From 0 feet to 100 feet

Type of completion (circle all applicable): Gravel packed Underreamed Telescoped Open hole Natural Development
Other (describe): _____

Top of lap pipe or reduction in casing: _____ feet. **If telescoped or more than one screen, describe on next page**

Form: OLWR-SW-11A (01/08)

RECEIVED

JUL 03 2012

BY: OLWR

STATE WELL REPORT

Part 2

Pump Installer's Completion Report
 Mississippi Department of Environmental Quality
 Office of Land and Water Resources
 P.O. Box 10631
 Jackson, MS 39289-0631
 (601)961-5210
 (601)354-6938 (fax)

County: Dezade
 Permit #: 0-780
 Driller: W. Joel Pierce
 Date completed: 6-22-12
Copy information from block on Part 1

For Office Use Only:

Aquifer: _____
 Well #: G193
 Elevation: _____

This part of the report must be completed by a licensed water well contractor or a licensed pump installer. A copy of Part 1 of the report must be attached and both parts filed with the Department at the above address within 30 days of well completion.

Well Owner Information	Well Location
Owner Name: <u>Frank Houll</u>	Latitude: <u>30-51-283</u> Longitude: <u>88-34-205</u>
Mailing Address: <u>263 C Vernon Houll Rd</u>	<u>18-30.6 169.8</u> <u>528-204-123</u>
<u>Lucedah</u> <u>MS</u> <u>39562</u>	Method of Lat/Long (check one): Conventional Survey _____
City State Zip Code	USGS quad _____, Hand-held GPS _____, Survey-grade GPS _____
Telephone No. <u>(601) 508-2091</u>	SE <u>SW</u> <u>SE</u> 1/4 Sec <u>22</u> T <u>25</u> R <u>6W</u>
	Distance _____ Direction _____ Nearest Town _____
	<u>5</u> Miles <u>NW</u> of <u>Apuka, MS</u>

Pump Type Circle one	Power Type Circle one
Air Lift Jet <u>Submersible</u>	Diesel Engine Gasoline Engine Natural Gas
Bucket Piston Turbine	<u>Electric Motor</u> Hand Tractor PTO
Centrifugal Rotary Flowing Well	Windmill Other (specify): _____
Other (specify): _____	Horse Power Rating of Motor: <u>1 1/2 hp</u>
Date Pump Installed: <u>6-22-12</u>	Setting Depth: <u>60 drop pipe</u> feet
Rated Pump Capacity: <u>20</u> Gallons Per Minute	Number of Stages: <u>10</u>

Pump Test Data	Method of Measuring Water Level Circle one
Date Well Tested: <u>6-22-12</u>	<u>Air Line</u> Electric Measuring Line Steel Tape
Static Water Level (A): <u>2</u> Feet Below Land Surface	Other (specify): _____
Pumping Water Level (B): <u>60</u> Feet Below Land Surface	For flowing well, measured shut in head: _____ feet
Drawdown [(B) - (A)]: <u>5</u> Feet Below Land Surface	Well yielded <u>20</u> GPM with a drawdown of
Test Pumping Rate: <u>20</u> Gallons Per Minute	<u>5</u> feet after <u>48</u> hours of pumping
Duration of Pump Test (minimum 4 hours): <u>48</u> hours	

I HEREBY CERTIFY that the above statements are true to the best of my knowledge.

Joel Pierce 0-780 Joel Pierce
 Print Name of Pump Installer and License No. (if applicable) Signature of Pump Installer

Form: OLWR-SWR-1B

RECEIVED

JUL 03 2012

BY: OLWR



Address Agricola, MS 39452

Get Google Maps on your phone
 Text the word "GMAPS" to 466453

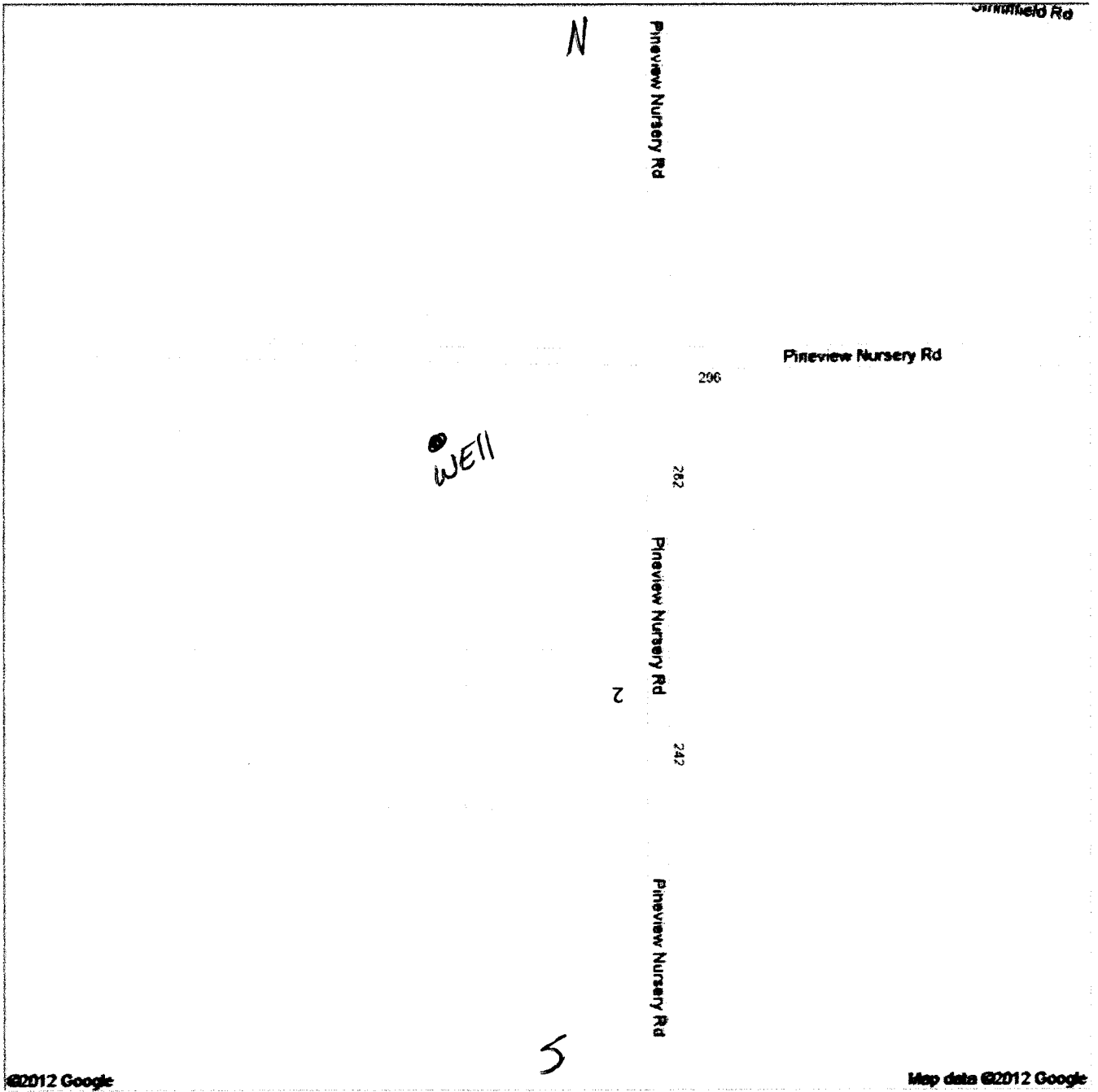
RECEIVED

JUL 03 2012

BY: OLWR