

County: George
 Permit #: _____
 Driller: Michael S. Howard
 Date drilling completed: 7-21-08

State Well Report
Part 1 – Driller's Log

Mississippi Department of Environmental Quality
 Office of Land and Water Resources
 P.O. Box 10631
 Jackson, MS 39289-0631
 (601)961-5210
 (601)354-6938 (fax)

For Office Use Only:
 Aquifer: _____
 Well #: C-156
 L. S. Elevation: _____
 E-log #: _____

State Law requires that this report be prepared by the license holder responsible for the work and filed with the Department at the above address within 30 days of completion of drilling of the well or borehole.

Information on Well Owner <i>(Landowner if borehole is not for a water well)</i>	Well or Borehole Location
Owner Name: <u>Paul Thompson</u>	Latitude: <u>30° 57' 25"</u> Longitude: <u>88° 34' 23"</u>
Mailing Address: <u>1017 Winter Street</u>	Method of Lat/Long (circle one): <u>15</u> Conventional Survey, <u>14</u>
<u>Lucedale MS 39452</u>	USGS quad: <u>Hand-held GPS</u> Survey-grade GPS _____
City State Zip Code	<u>SW 1/4 SE 1/4 Sec 22</u> Twn <u>T15</u> Rng <u>R6W</u>
Telephone No. <u>(601) 947-8070</u>	Distance <u>1</u> Miles Direction <u>NE</u> of Nearest Town <u>Lucedale</u>

Well / Borehole Data

Date drilling started: 7-21-08 Date drilling completed: 7-21-08 Hole depth: _____ Hole diameter: 7.25

Location of the source of any surface water used for drilling: _____
 Method of dosing and volume of Chlorine used in drilling and development: _____

Logs run (circle all applicable): No log run Electric Gamma Ray Density Sonic Neutron Other: _____
 Name of organization running log(s): _____

Purpose of borehole (check one): Water Well Geotechnical/Geological Investigation _____ Ground Source Heat Pump _____
 Seismic Survey _____ Other (describe) _____

If drilling is not related to water well construction, skip the remainder of this block

Purpose of Well (check one): Home _____ Industrial _____ Public Supply _____ Irrigation Fish Culture _____ Other: _____

If a flowing well, method of flow regulation: Valve _____ Other (describe) _____

Static Water Level: 54 feet above or below (circle one) land surface Date measured: _____

Method of Measurement (circle one) steel tape electric tape air line other: _____

Well depth: 15 Well grouted to a depth of _____ feet Type of grout (circle one): Neat Cement Bentonite Mix

Casing length: 76 feet Casing diameter: 4 inches Type of casing: 540 PVC BE

Screen length: 20 feet Screen diameter: 4 inches Type of screen: 540 WOP

Screen slot size: .010 inches Setting depth: From 76 feet to 96 feet

Type of completion (circle all applicable): Gravel packed Underreamed Telescoped Open hole Natural Development
 Other (describe): _____

Top of lap pipe or reduction in casing: _____ feet. *If telescoped or more than one screen, describe on next page*

Form: OLWR-SWR-1A

RECEIVED
 AUG 21 2008
 BY: OLWR

The sketch below only required for water wells

If well telescopes, show depths on sketch.

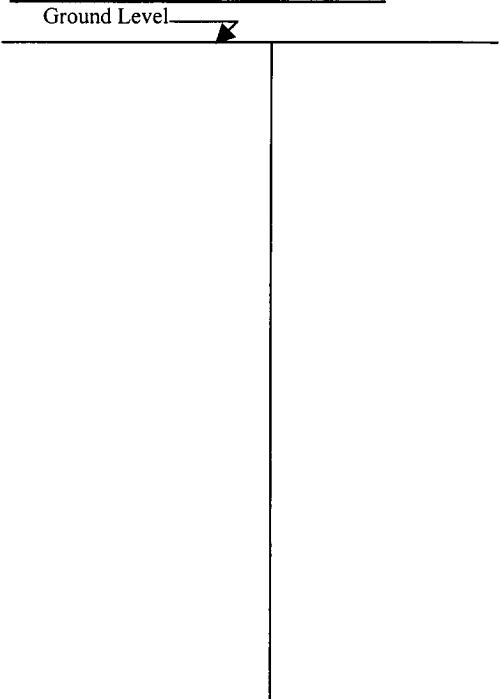

Description of formations encountered must be provided for all wells and boreholes, unless specifically exempted by regulations

Description of Formations Encountered	From (depth)	To (depth)
Top-Sand	Ground Level	6
Clay	6	18
Sand	18	32
Clay	32	56
Sand (med)	56	96

If more than one screen, show location of each on sketch

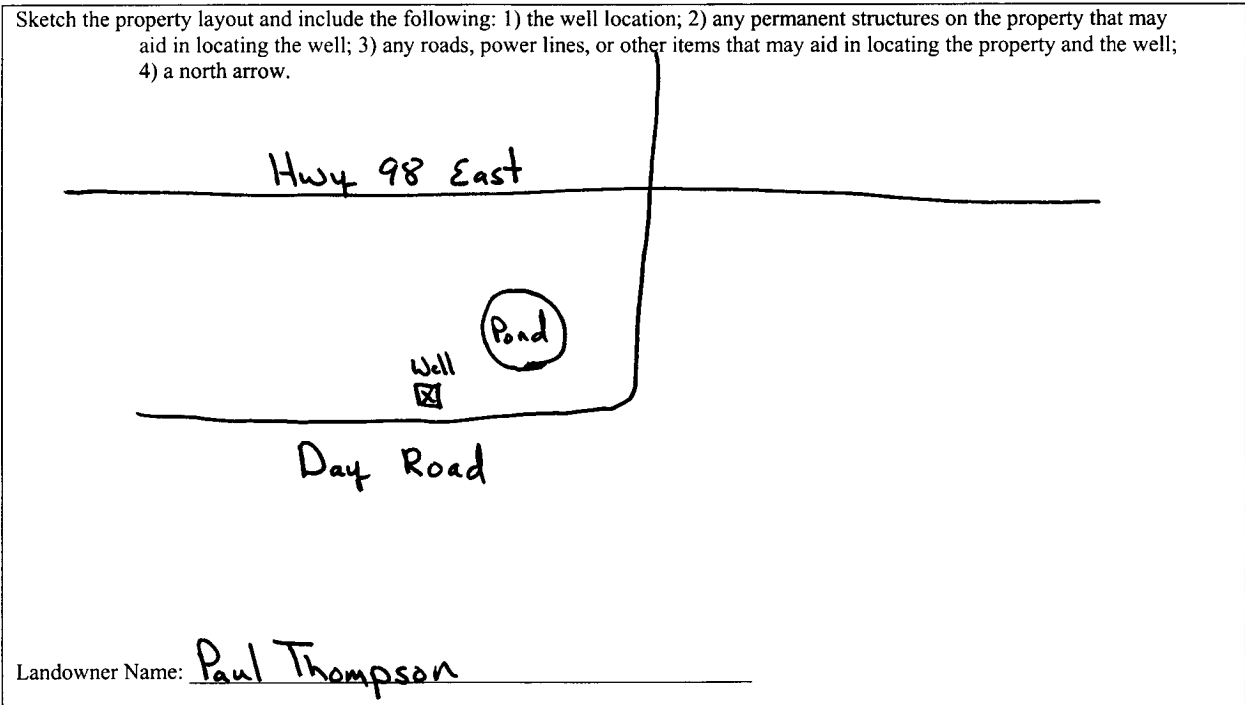

Form: OLWR-SWR-1A

I certify that the well/borehole was drilled, constructed, and completed in accordance with all applicable requirements of the Mississippi Department of Environmental Quality and the Mississippi Department of Health regulations, if applicable, and state laws.

Michael S. Havard 0-673 8-18-08
Print Name of Responsible Licensee and License No. Date

Signature of Licensee

RECEIVED
AUG 21 2008
BY: OLWR

STATE WELL REPORT

Part 2

Pump Installer's Completion Report
 Mississippi Department of Environmental Quality
 Office of Land and Water Resources
 P.O. Box 10631
 Jackson, MS 39289-0631
 (601)961-5210
 (601)354-6938 (fax)

County: George
 Permit #: _____
 Driller: Michael S. Harvard
 Date completed: 7-22-08
Copy information from block on Part 1

For Office Use Only:

Aquifer: _____
 Well #: C-156
 Elevation: _____

This part of the report must be completed by a licensed water well contractor or a licensed pump installer. A copy of Part 1 of the report must be attached and both parts filed with the Department at the above address within 30 days of well completion.

Well Owner Information	Well Location
Owner Name: <u>Paul Thompson</u>	Latitude: <u>N30°57.25</u> Longitude: <u>W88°34.23</u>
Mailing Address: <u>1017 Winter Street</u>	Method of Lat/Long (check one): Conventional Survey _____
<u>Lucedale</u> <u>MS</u> <u>39452</u>	USGS quad _____, Hand-held GPS <input checked="" type="checkbox"/> , Survey-grade GPS _____
City State Zip Code	_____ ¼ _____ ¼ Sec <u>22</u> T <u>15</u> R <u>6W</u>
Telephone No. (<u>601</u>) <u>947-8070</u>	Distance Direction Nearest Town
	<u>1</u> Miles <u>NE</u> of <u>Lucedale</u>

Pump Type Circle one	Power Type Circle one
Air Lift Jet <input checked="" type="radio"/> <u>Submersible</u>	Diesel Engine Gasoline Engine Natural Gas
Bucket Piston Turbine	<input checked="" type="radio"/> <u>Electric Motor</u> Hand Tractor PTO
Centrifugal Rotary Flowing Well	Windmill Other (specify): _____
Other (specify): _____	Horse Power Rating of Motor: <u>3</u>
Date Pump Installed: <u>7-22-08</u>	Setting Depth: <u>85</u> feet
Rated Pump Capacity: <u>55</u> Gallons Per Minute	Number of Stages: <u>7</u>

Pump Test Data	Method of Measuring Water Level Circle one
Date Well Tested: <u>7-22-08</u>	Air Line <input checked="" type="radio"/> <u>Electric Measuring Line</u> Steel Tape
Static Water Level (A): <u>54</u> Feet Below Land Surface	Other (specify): _____
Pumping Water Level (B): <u>76</u> Feet Below Land Surface	For flowing well, measured shut in head: _____ feet
Drawdown [(B) - (A)]: <u>22</u> Feet Below Land Surface	Well yielded <u>70</u> GPM with a drawdown of
Test Pumping Rate: <u>70</u> Gallons Per Minute	<u>22</u> feet after <u>4</u> hours of pumping
Duration of Pump Test (minimum 4 hours): <u>4</u> hours	

I HEREBY CERTIFY that the above statements are true to the best of my knowledge.

Michael S. Harvard [Signature]
 Print Name of Pump Installer and License No. (if applicable) Signature of Pump Installer

Form: OLWR-SWR-1B
RECEIVED
 AUG 21 2008
 BY: OLWR