

# STATE WELL REPORT

Part I

Driller's Log

Mississippi Department of Environmental Quality  
Office of Land and Water Resources  
P.O. Box 2309  
Jackson, MS 39225-2309  
(601)961-5210  
(601)360-0535 (fax)

County: Franklin  
 Permit #: \_\_\_\_\_  
 GREEN WATER WELL & SUPPLY, Driller: INC.  
 Date drilling completed: 3-23-17

For Office Use Only:  
 Well #: N27  
 Aquifer: \_\_\_\_\_  
 E-Log #: \_\_\_\_\_

*State Law requires that this report be prepared by the license holder responsible for the work and filed with the Department at the above address within 30 days of completion of drilling of the well or borehole.*

Well Owner Information <small>(Landowner if borehole is not for a water well)</small>	Well or Borehole Location
Owner Name: <u>Jerrell Arnone</u>	Latitude: <u>31°35'22.6"</u> Longitude: <u>90°8'77.174"</u>
Mailing Address: <u>3990 David St</u>	Method of Lat/Long (check one): <input checked="" type="checkbox"/> Conventional Survey <input type="checkbox"/> <u>31-21-35</u> <u>90-52-38</u>
<u>Zachary</u> <u>LA</u> <u>70791</u>	USGS quad _____, Hand-held GPS <input checked="" type="checkbox"/> , Survey-grade GPS _____
City State Zip Code	<u>SW</u> $\frac{1}{4}$ <u>NE</u> $\frac{1}{4}$ , Sec <u>44</u> <u>T</u> <u>5N</u> <u>R</u> <u>3E</u>
Telephone No. <u>(225) 301-0527</u>	<u>8</u> Miles <u>S</u> of <u>Meadville</u> (Distance) (Direction) (Nearest Town)

Well / Borehole Data

Date drilling started: 3-22-17 Date drilling completed: 3-23-17 Hole depth: 290 Hole diameter: 7

Location of the source of any surface water used for drilling: \_\_\_\_\_

Method of dosing and volume of Chlorine used in drilling and development: Mudpit & gravel pack

Logs run (circle all applicable):  No log run  Electric  Gamma Ray  Density  Sonic  Neutron Other: \_\_\_\_\_

Name of organization running log(s): \_\_\_\_\_

Purpose of borehole (circle one):  Water Well  Geotechnical/Geological Investigation  Ground Source Heat Pump  
 Seismic Survey  Other (describe) \_\_\_\_\_

*If drilling is not related to water well construction, skip the remainder of this block*

Purpose of Well (circle all applicable):  Home  Industrial  Public Supply  Irrigation  Fish Culture

Other (describe): Camp

If a flowing well, method of flow regulation: Valve \_\_\_\_\_ Other (describe) \_\_\_\_\_

Static Water Level: 98 feet [above or  below] land surface Date measured: 3-23-17  
(circle one)

Method of measurement (circle one): Steel tape  Electric tape  Air line Other (describe) \_\_\_\_\_

Well depth: 280 Well grouted to a depth of: 10 feet Type of grout (circle one): Neat Cement  Bentonite  Mix

Casing length: 270 feet Casing diameter: 4 inches Type of casing: PVC

Screen length: 10 feet Screen diameter: 4 inches Type of screen: PVC

Screen slot size: .010 inches Setting depth: From 270 feet to 280 feet

Type of completion (circle all applicable):  Gravel packed  Underreamed  Open hole  Natural Development

Other (describe): \_\_\_\_\_

Top of lap pipe or reduction in casing: \_\_\_\_\_ feet

*If telescoped or more than one screen, describe on next page*

RECEIVED  
APR 12 2017  
BY OLWR

County: Franklin  
 Permit #: \_\_\_\_\_

For Office Use Only:  
 Well #: N27

The sketch below only; required for water wells

If well telescopes, show depths on sketch.

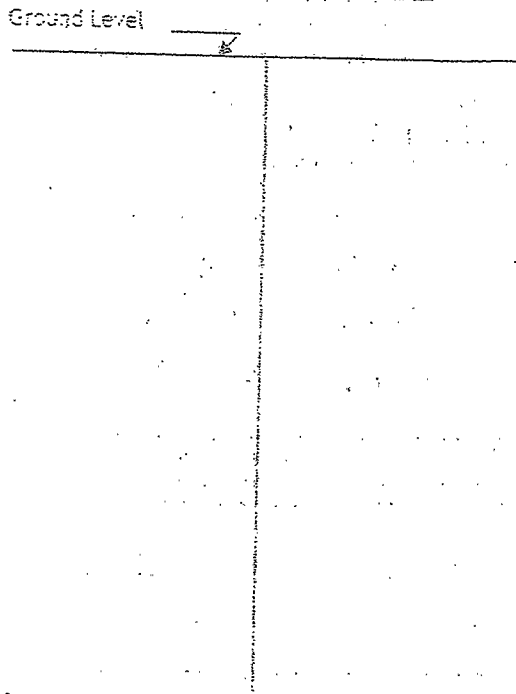

Description of formations encountered must be provided for all wells and boreholes, unless specifically exempted by regulations

Description of Formations Encountered	From (depth)	To (depth)
	Ground level	
<del>White Clay</del> White Clay	0	18
SAND	18	70
White Clay	70	75
Blue Clay	75	195
Streaky	195	220
Sand	220	240
<del>Blue Clay</del> Blue Clay	240	290

If more than one screen, show location of each on sketch.

Sketch the property layout and include the following:

- 1) the well location
- 2) any permanent structures on the property that may aid in locating the well
- 3) any roads, power lines, or other items that may aid in locating the property and the well
- 4) north arrow

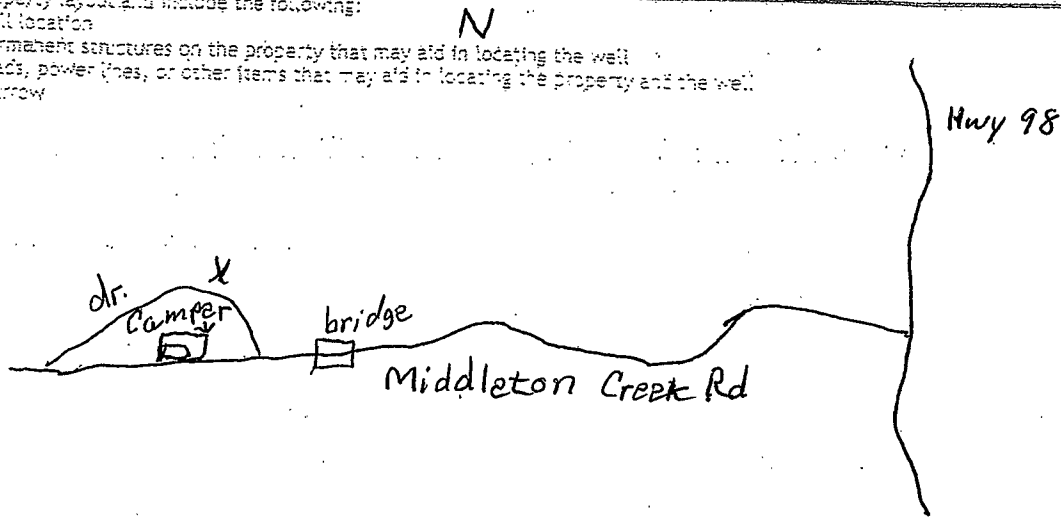

Landowner Name: Jerrell Arnone

I HEREBY CERTIFY that the well/borehole was drilled, constructed, and completed in accordance with all applicable requirements of the Mississippi Department of Environmental Quality and the Mississippi Department of Health regulations, if applicable, and state laws.

MICHAEL W. KEES UNR-00007737  
 Print Name of Responsible Licensee and License No.

3-24-17  
 Date

*Michael W. Kees*  
 Signature of Licensee

# STATE WELL REPORT

## Part 2

**Pump Installer's Completion Report**  
 Mississippi Department of Environmental Quality  
 Office of Land and Water Resources  
 P. O. Box 2309  
 Jackson, MS 39225-2309  
 (601)961-5210  
 (601) 360-0535 (fax)

**For Office Use Only:**

Well #: N27  
 Aquifer: \_\_\_\_\_

County: Franklin

Permit #: \_\_\_\_\_  
 Dripper: GREEN WATER WELL & SUPPLY, INC.  
 Date completed: 3-24-17

Copy information from block on Part 1

*This part of the report must be completed by a licensed water well contractor or a licensed pump installer. A copy of Part 1 of the report must be attached and both parts filed with the Department at the above address within 30 days of well completion.*

Well Owner Information	Well Location
Owner Name: <u>JERRELL AMONCE</u>	Latitude: <u>31°35'26"</u> Longitude: <u>90°8'77.74"</u>
Mailing Address: <u>3990 DAVID ST</u>	Method of Lat/Long (check one): <u>31-21-35</u> Conventional Survey <u>90-52-38</u>
<u>Zachary LA</u> <u>70791</u>	USGS quad _____, Hand-held GPS <u>K</u> , Survey-grade GPS _____
City _____ State _____ Zip Code _____	<u>SW</u> 1/4 <u>NE</u> 1/4, Sec. <u>44</u> T. <u>5N</u> R. <u>3E</u>
Telephone No. <u>(225) 241-1550</u>	<u>8</u> Miles <u>S</u> of <u>Mendville</u> (Distance) (Direction) (Nearest Town)

**Pump Type (circle one)**

Submersible  Turbine  Air Lift  Centrifugal  Flowing Well  Jet  Piston  Rotary  Other (describe): \_\_\_\_\_

Date Pump Installed: 3-24-17 Rated Pump Capacity: 10 Gallons Per Minute

Is This Pump (circle one):  New  Repaired  Replacement

**Power Type (circle one)**

Electric  Diesel  Gasoline  Natural Gas  Tractor PTO  Windmill  Other (describe): \_\_\_\_\_

Horse Power Rating of Motor: 3/4 Setting Depth: 125 feet Number of Stages: 12

**Pump Test Data for Non Flowing Well**

Date Well Tested: 3-24-17 Duration of Pump Test (minimum 4 hours): 4 hours

Static Water Level (A): 98 Feet Below Land Surface Pumping Water Level (B): 109 Feet Below Land Surface

Drawdown [(B) - (A)]: 11 Feet Below Land Surface Test Pumping Rate: 10 Gallons Per Minute

Method of measurement (circle one):  Steel tape  Electric tape  Air line  Other (describe): \_\_\_\_\_

**Pump Test Data for Flowing Well**

Measured shut in head: \_\_\_\_\_ feet

Well yielded \_\_\_\_\_ GPM with a drawdown of \_\_\_\_\_ feet after \_\_\_\_\_ hours of pumping

**Meter Installation**

Meter Manufacturer: \_\_\_\_\_ Meter Serial Number: \_\_\_\_\_

Meter Model Number/Name: \_\_\_\_\_ Type of Meter: \_\_\_\_\_

Totalizer Register Unit and Multiplier Factor (AF x .001, gal x 1000, etc.): \_\_\_\_\_

Installation Date: \_\_\_\_\_ Meter installed by: \_\_\_\_\_

Is This Meter (circle one):  New  Repaired  Replacement

**RECEIVED**  
**APR 12 2017**  
**BY OLWR**

*Important: By submitting the above information you are certifying that this meter was installed to manufacturer standards. For agricultural wells, a list of approved meters is on the MDEQ website.*

I HEREBY CERTIFY that the above statements are true to the best of my knowledge.

MICHAEL W. KEES UNR-00007737 3-24-17 [Signature]

Print Name of Pump Installer and License No. (if applicable) Date Signature of Pump Installer