

State Well Report

Part 1

Mississippi Department of Environmental Quality
Office of Land and Water Resources
P.O. Box 10631
Jackson, MS 39289-0631
(601)961-5210
(601)354-6938 (fax)

County: Franklin
Permit #: _____
Driller: GREEN WATER WELL & SUPPLY, INC.
Date drilling completed: 6/21/12

For Office Use Only:
Aquifer: K93
Well #: _____
L. S. Elevation: _____
E-log #: _____

State Law requires that this report be prepared by the driller in detail and filed with the Department within 30 days of completion of drilling of the well.

Well Owner Information	Well Location
Owner Name: <u>Frank Linton</u>	Latitude: <u>31° 27' 09"</u> Longitude: <u>90° 38' 21"</u>
Mailing Address: <u>3580 Murray Rd.</u>	Method of Lat/Long (circle one): <u>Conventional Survey</u>
<u>McCall Creek, Ms.</u>	USGS quad: <u>Hand-held GPS</u> , Survey-grade GPS
City: _____ State: _____ Zip Code: _____	<u>SE 1/4 SE 1/4</u> Sec <u>30</u> Twn <u>5N</u> Rng <u>6E</u>
Telephone No. <u>(601) 248-5909</u>	Distance <u>5</u> Miles Direction <u>SE</u> of <u>McCall Creek</u>

Well Data

Purpose of Well (circle one): Home Industrial Public Supply Irrigation Fish Culture Other: _____

Date well drilling started: 6/21/12 Date well drilling completed: 6/21/12

If flowing, method of flow regulation: Valve _____ Other (describe): _____

Static Water Level: 56 feet above or below (circle one) land surface Date measured: 6/21/12

Method of Measurement (circle one): steel tape electric tape air line other: _____

Hole depth: 78 Well depth: 76 Well grouted to a depth of 10 feet

Type of grout (circle one): Cement Bentonite Mix

Casing length: 66 feet Casing diameter: 4 inches Type of casing: PVC

Screen length: 10 feet Screen diameter: 4 inches Type of screen: PVC

Screen slot size: .010 inches Setting depth: From 66 feet to 76 feet

Type of completion (circle all applicable): Gravel packed Underreamed Telescoped Open hole Natural Development

Other (describe): _____

Top of lap pipe or reduction in casing: _____ feet. If telescoped or more than one screen, describe on back of page

Logs run (circle all applicable): No log run Electric Gamma Ray Density Sonic Neutron Other: _____

Name of organization running log(s): _____

I certify that the well was drilled, constructed, and completed in accordance with all applicable requirements of the Mississippi Department of Environmental Quality and/or the Mississippi Department of Health regulations and state laws.

GREEN WATER WELL & SUPPLY, INC.
BRIAN D. McCLENDON, UNR-0000664

Print Name of Water Well Contractor and License No. Brian McCleander
Signature of Water Well Contractor

RECEIVED
JUN 20 2012
BY: OLWR

If well telescopes please sketch below and show depths.

Ground Level

Description of Formations Encountered	From	To
red clay	0	44
sand	44	68
gravel	68	75
white clay	75	78

If more than one screen, show location of each on sketch

Sketch the property layout and include the following: 1) the well location; 2) any permanent structures on the property that may aid in locating the well; 3) any roads, power lines, or other items that may aid in locating the property and the well; 4) indicate direction.

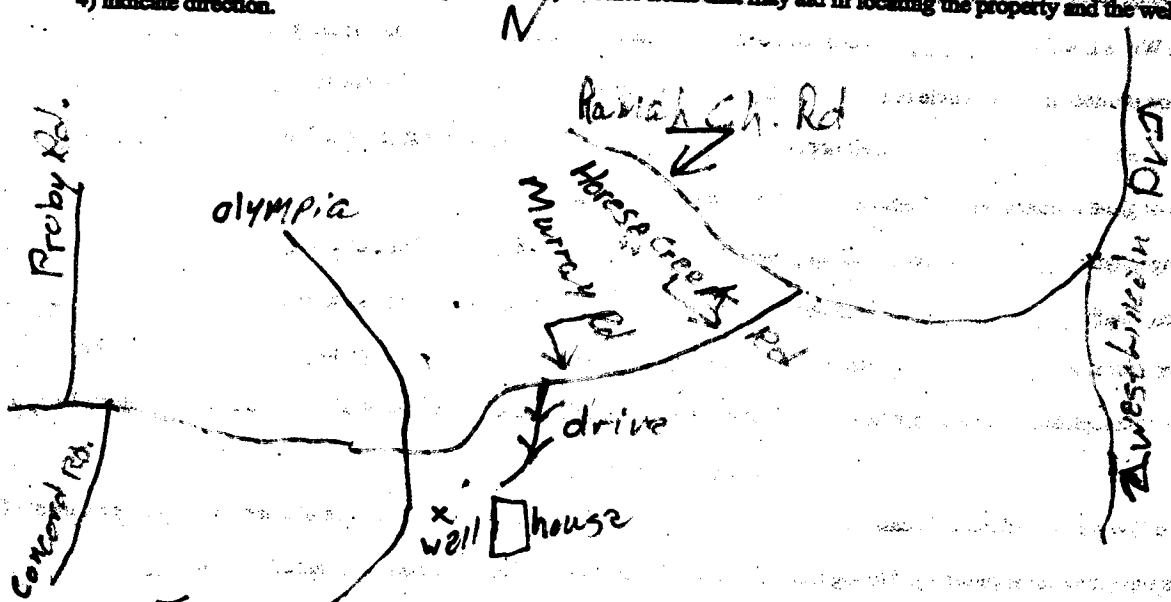

Landowner Name: Frank Linton

Brian Mc Clelland 664
Signature of Water Well Contractor

1K93

STATE WELL REPORT

Part 2

Pump Installer's Completion Report
 Mississippi Department of Environmental Quality
 Office of Land and Water Resources
 P.O. Box 10631
 Jackson, MS 39289-0631
 (601)961-5210
 (601)354-6938 (fax)

County: Franklin
 Permit #: _____
 Driller: GRENN WATER WELL & SUPPLY, INC.
 Date completed: 6/22/12

For Office Use Only:
 Aquifer: _____
 Well #: _____
 Elevation: _____

This report should be prepared by the pump installer in detail and filed with the Department within 30 days of the installation of pump.

Well Owner Information	Well Location
Owner Name: <u>Frank Linton</u>	Latitude: <u>31° 27' 097"</u> Longitude: <u>90° 38' 213"</u>
Mailing Address: <u>3580 Murray Rd</u>	Method of Lat/Long (circle one): Conventional Survey,
<u>McCall Creek MS</u>	USGS quad: <u>Hand-held GPS</u> Survey-grade GPS
City State Zip Code	<u>SE 1/4 SE 1/4 Sec 30 Twn 5N Rng 6E</u>
Telephone No. <u>(601) 248-5909</u>	Distance Direction Nearest Town
	<u>5 Miles SE of McCall Creek</u>

Pump Type Circle one	Power Type Circle one
Air Lift Jet <u>Submersible</u>	Diesel Engine Gasoline Engine Natural Gas
Bucket Piston Turbine	<u>Electric Motor</u> Hand Tractor PTO
Centrifugal Rotary Flowing Well	Windmill Other (specify): _____
Other (specify): _____	Horse Power Rating of Motor: <u>1/2</u>
Date Pump Installed: <u>6/22/12</u>	Setting Depth: <u>75</u> feet
Rated Pump Capacity: <u>10</u> Gallons Per Minute	Number of Stages: <u>9</u>

Pump Test Data	Method of Measuring Water Level Circle one
Date Well Tested: <u>6/22/12</u>	Air Line <u>Electric Measuring Line</u> Steel Tape
Static Water Level (A): <u>56</u> Feet Below Land Surface	Other (specify): _____
Pumping Water Level (B): <u>62</u> Feet Below Land Surface	For flowing well, measured shut in head: _____ feet
Drawdown [(B) - (A)]: <u>6</u> Feet Below Land Surface	Well yielded <u>12</u> GPM with a drawdown of
Test Pumping Rate: <u>12</u> Gallons Per Minute	<u>6</u> feet after <u>4</u> hours of pumping
Duration of Pump Test (minimum 4 hours): <u>4</u> hours	

I HEREBY CERTIFY that the above statements are true to the best of my knowledge.

WILLIAM L. HARDIN, V, UNR-00000802
 Print Name of Pump Installer and License No. (if applicable)

William Lee Hardin
 Signature of Pump Installer

RECEIVED

JUN 28 2012

BY: OLWR