

STATE WELL REPORT

Part I

Driller's Log

Mississippi Department of Environmental Quality
Office of Land and Water Resources
P.O. Box 2309
Jackson, MS 39225-2309
(601)961-5210
(601)360-0535 (fax)

County: Franklin
Permit #: _____
Driller: GREEN WATER WELL & SUPPLY, INC.
Date drilling completed: 9-24-15

For Office Use Only:
Well #: J 80
Aquifer: _____
E-Log #: _____

State Law requires that this report be prepared by the license holder responsible for the work and filed with the Department at the above address within 30 days of completion of drilling of the well or borehole.

Well Owner Information (Landowner if borehole is not for a water well) Owner Name: <u>Bryant Murray</u> Mailing Address: <u>776 New Hope Rd.</u> <u>Meadville, Ms.</u> City State Zip Code Telephone No. (601) <u>431-4607</u>	31 30 13 Well or Borehole Location <u>90 50 7</u> Latitude: <u>31 30.226</u> Longitude: <u>90 50.126</u> Method of Lat/Long (check one): Conventional Survey _____ USGS quad _____ Hand-held GPS <input checked="" type="checkbox"/> Survey-grade GPS _____ <u>SW 1/4</u> <u>5th</u> <u>NW</u> 1/4, Sec <u>8</u> T <u>6N</u> R <u>4E</u> <u>2.5</u> Miles <u>W</u> of <u>Eddiceton</u> (Distance) (Direction) (Nearest Town)
---	--

Well / Borehole Data
Date drilling started: 9-24-15 Date drilling completed: 9-24-15 Hole depth: 99 Hole diameter: 7
Location of the source of any surface water used for drilling: _____
Method of dosing and volume of Chlorine used in drilling and development: Mudpiet gravel pack
Logs run (circle all applicable): No log run Electric Gamma Ray Density Sonic Neutron Other: _____
Name of organization running log(s): _____
Purpose of borehole (circle one): Water Well Geotechnical/Geological Investigation Ground Source Heat Pump
 Seismic Survey Other (describe) _____
If drilling is not related to water well construction, skip the remainder of this block

Purpose of Well (circle all applicable): Home Industrial Public Supply Irrigation Fish Culture
Other (describe): Cattle Supply
If a flowing well, method of flow regulation: Valve _____ Other (describe) _____
Static Water Level: 40 feet [above or below] land surface Date measured: 9-24-15
(circle one)
Method of measurement (circle one): Steel tape Electric tape Air line Other (describe): _____
Well depth: 96 Well grouted to a depth of: 10 feet Type of grout (circle one): Neat Cement Bentonite Mix
Casing length: 86 feet Casing diameter: 4 inches Type of casing: PVC
Screen length: 10 feet Screen diameter: 4 inches Type of screen: PVC
Screen slot size: .010 inches Setting depth: From 86 feet to 96 feet
Type of completion (circle all applicable): Gravel packed Underreamed Open hole Natural Development
Other (describe): _____
Top of lap pipe or reduction in casing: _____ feet
If telescoped or more than one screen, describe on next page

Form: OLWR-SWR-1A (4/13)

OCT 23 2015

County: Franklin

Permit #: _____

For Office Use Only:

Well #: _____

The sketch below only required for water wells

If well telescopes, show depths on sketch.

Ground Level: _____

Description of formations encountered must be provided for all wells and boreholes, unless specifically exempted by regulations

Description of Formations Encountered	From (depth)	To (depth)
clay w/ sand streaks	Ground level	17
sand & clay streaks to gravel	17	60
sand & pea gravel	60	96
white clay	96	99

If more than one screen, show location of each on sketch

Sketch the property layout and include the following:

- 1) the well location
- 2) any permanent structures on the property that may aid in locating the well
- 3) any roads, power lines, or other items that may aid in locating the property and the well
- 4) north arrow

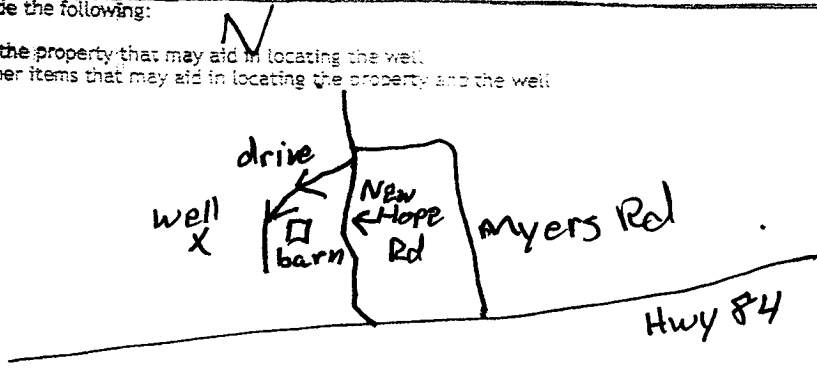

Landowner Name: Bryant Murray

I HEREBY CERTIFY that the well/borehole was drilled, constructed, and completed in accordance with all applicable requirements of the Mississippi Department of Environmental Quality and the Mississippi Department of Health regulations, if applicable, and state laws.

BRIAN D. McCLENDON UNR-00000664
Print Name of Responsible Licensee and License No.

9-24-15
Date

Brian McCleendon
Signature of Licensee

STATE WELL REPORT

Part 2

Pump Installer's Completion Report
Mississippi Department of Environmental Quality
Office of Land and Water Resources
P.O. Box 2309
Jackson, MS 39225-2309
(601)961-5210
(601) 360-0535 (fax)

For Office Use Only:

Well #: J 80

Aquifer: _____

County: Franklin
Permit #: _____
Driller: GRENN WATER WELL & SUPPLY, INC.
Date completed: 9-25-15
Copy information from block on Part 1

This part of the report must be completed by a licensed water well contractor or a licensed pump installer. A copy of Part 1 of the report must be attached and both parts filed with the Department at the above address within 30 days of well completion.

Well Owner Information	Well Location
Owner Name: <u>BRYANT MURRAY</u>	Latitude: _____ Longitude: _____
Mailing Address: _____	Method of Lat/Long (check one): Conventional Survey _____
<u>776 NEW HOPE Rd</u>	USGS quad _____, Hand-held GPS _____, Survey-grade GPS _____
<u>MEADWILLE MS</u>	_____ 1/4 _____ 1/4, Sec _____ T _____ R _____
City State Zip Code	_____ Miles _____ of _____
Telephone No. <u>(601) 431-4607</u>	(Distance) (Direction) (Nearest Town)

Pump Type (circle one)
 Submersible Turbine Air Lift Centrifugal Flowing Well Jet Piston Rotary Other (describe): _____
Date Pump Installed: 9-25-15 Rated Pump Capacity: 10 Gallons Per Minute
Is This Pump (circle one): New Repaired Replacement

Power Type (circle one)
 Electric Diesel Gasoline Natural Gas Tractor PTO Windmill Other (describe): _____
Horse Power Rating of Motor: 1/2 Setting Depth: 60 feet Number of Stages: 9

Pump Test Data for Non Flowing Well
Date Well Tested: 9-25-15 Duration of Pump Test (minimum 4 hours): 4 hours
Static Water Level (A): 40 Feet Below Land Surface Pumping Water Level (B): 44 Feet Below Land Surface
Drawdown [(B) - (A)]: 4 Feet Below Land Surface Test Pumping Rate: 10 Gallons Per Minute
Method of measurement (circle one): Steel tape Electric tape Air line Other (describe): _____

Pump Test Data for Flowing Well
Measured shut in head: _____ feet.
Well yielded _____ GPM with a drawdown of _____ feet after _____ hours of pumping

Meter Installation
Meter Manufacturer: _____ Meter Serial Number: _____
Meter Model Number/Name: _____ Type of Meter: _____
Totalizer Register Unit and Multiplier Factor (AF x .001, gal x 1000, etc): _____
Installation Date: _____ Meter installed by: _____
Is This Meter (circle one): New Repaired Replacement
Important: By submitting the above information you are certifying that this meter was installed to manufacturer standards. For agricultural wells, a list of approved meters is on the MDEQ website.

I HEREBY CERTIFY that the above statements are true to the best of my knowledge.
MICHAEL W. KEES RPO-0000801 9-25-15 Michael Kees
Print Name of Pump Installer and License No. (if applicable) Date Signature of Pump Installer 9-25-15