

STATE WELL REPORT

Part 1

Driller's Log

Mississippi Department of Environmental Quality
Office of Land and Water Resources
P.O. Box 2309
Jackson, MS 39225-2309
(601)961-5210
(601)360-0535 (fax)

County: Franklin
Permit #: _____
Driller: Gary Rayborn
Date drilling completed: 8/2/16

For Office Use Only:
Well #: E 47
Aquifer: _____
E-Log #: _____

State Law requires that this report be prepared by the license holder responsible for the work and filed with the Department at the above address within 30 days of completion of drilling of the well or borehole.

<p>Well Owner Information (Landowner if borehole is not for a water well)</p> <p>Owner Name: <u>D & D Drilling Inc.</u> Mailing Address: <u>(for Stroud Petroleum)</u> <u>P.O. Box 1634</u> <u>Ferriday LA 71334</u> City State Zip Code Telephone No. <u>(318) 757-3274</u></p>	<p>Well or Borehole Location</p> <p>Latitude: <u>31°29'5.7" N</u> Longitude: <u>91°1'19.6" W</u> Method of Lat/Long (check one): Conventional Survey _____ USGS quad _____, Hand-held GPS _____, Survey-grade GPS _____ <u>NW ¼ SW ¼, Sec 25 T 6N R 2E</u> <u>3</u> Miles <u>SE</u> of <u>Roxie</u> (Distance) (Direction) (Nearest Town)</p>
---	--

Well / Borehole Data

Date drilling started: 8/1/16 Date drilling completed: 8/2/16 Hole depth: 150' Hole diameter: 4"
Location of the source of any surface water used for drilling: _____
Method of dosing and volume of Chlorine used in drilling and development: _____
Logs run (circle all applicable): No log run Electric Gamma Ray Density Sonic Neutron Other: _____
Name of organization running log(s): _____
Purpose of borehole (circle one): Water Well Geotechnical/Geological Investigation Ground Source Heat Pump
Seismic Survey Other (describe) _____
If drilling is not related to water well construction, skip the remainder of this block

Purpose of Well (circle all applicable): Home Industrial Public Supply Irrigation Fish Culture
Other (describe): Rig Supply
If a flowing well, method of flow regulation: Valve _____ Other (describe) _____
Static Water Level: 80 feet [above or below land surface Date measured: 8/2/16
(circle one)
Method of measurement (circle one): Steel tape Electric tape Air line Other (describe): _____
Well depth: 150' Well grouted to a depth of: 10 feet Type of grout (circle one): Neat Cement Bentonite Mix
Casing length: 130 feet Casing diameter: 4 inches Type of casing: PVC
Screen length: 20 feet Screen diameter: 4 inches Type of screen: PVC
Screen slot size: .020 inches Setting depth: From 130 feet to 150 feet
Type of completion (circle all applicable): Gravel packed Underreamed Open hole Natural Development
Other (describe): _____
Top of lap pipe or reduction in casing: _____ feet
If telescoped or more than one screen, describe on next page

Received

AUG 04 2016

By OLWR

County: Franklin
 Permit #: _____

Graves USA 25-12 No. 1
For Office Use Only:
 Well #: _____

The sketch below only required for water wells
If well telescopes, show depths on sketch.

Description of formations encountered must be provided for all wells and boreholes, unless specifically exempted by regulations

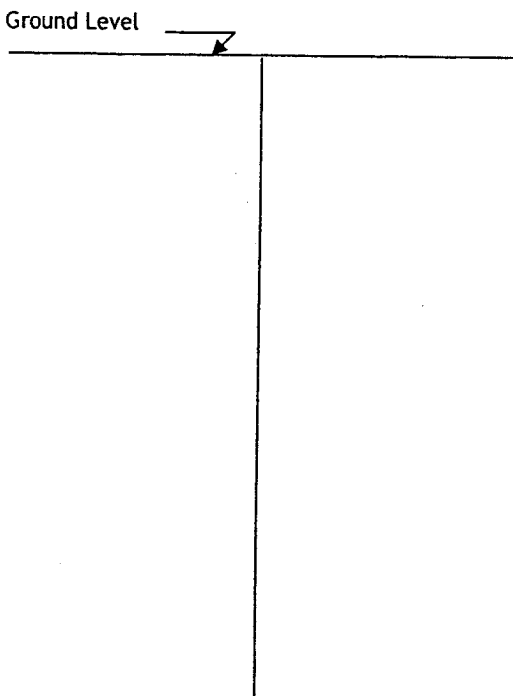

Description of Formations Encountered	From (depth)	To (depth)
Sand	Ground level	10
Chalk	10	100
Medium Sand	100	150

If more than one screen, show location of each on sketch

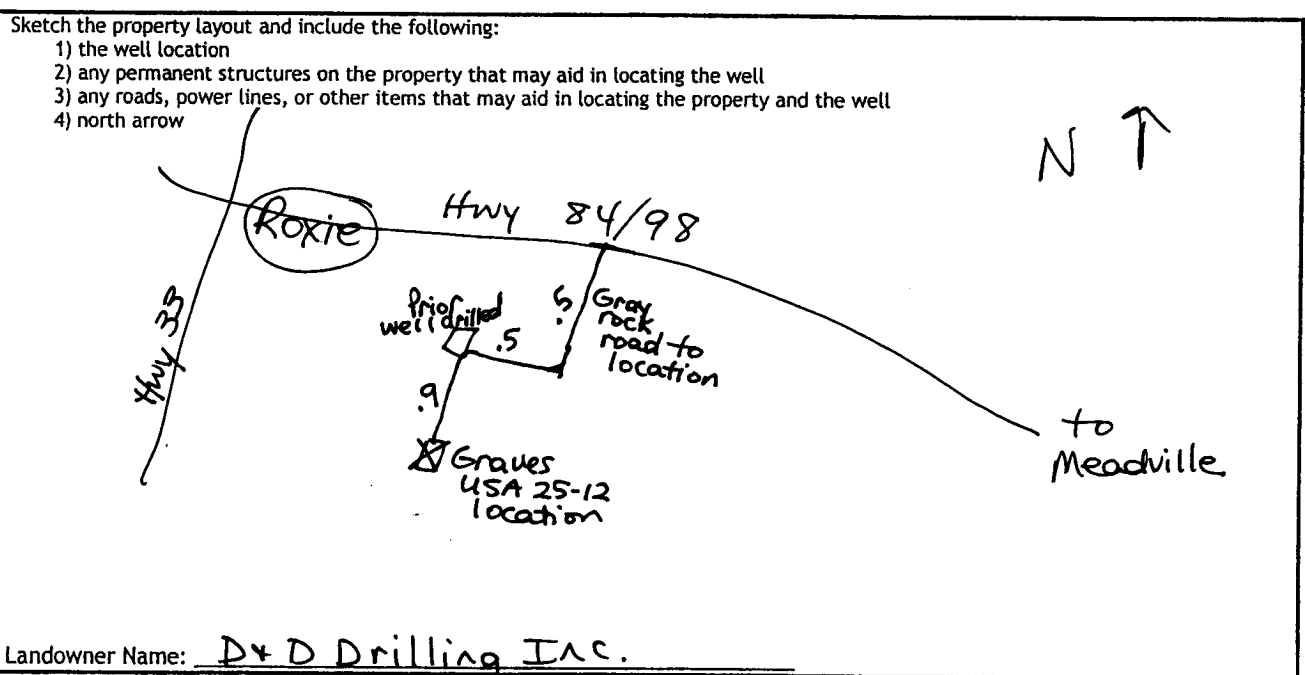

Landowner Name: D+D Drilling Inc.

I HEREBY CERTIFY that the well/borehole was drilled, constructed, and completed in accordance with all applicable requirements of the Mississippi Department of Environmental Quality and the Mississippi Department of Health regulations, if applicable, and state laws.

Rayborn Drilling Inc. 0-60 8/3/16
 Print Name of Responsible Licensee and License No. Date Signature of Licensee

STATE WELL REPORT

Graves USA 25-12 No. 1

County: Franklin
 Permit #: _____
 Driller: Gary Rayborn
 Date completed: 8/2/16
Copy information from block on Part 1

Part 2
Pump Installer's Completion Report
 Mississippi Department of Environmental Quality
 Office of Land and Water Resources
 P.O. Box 2309
 Jackson, MS 39225-2309
 (601)961-5210
 (601) 360-0535 (fax)

For Office Use Only:

Well #: 641
 Aquifer: _____

This part of the report must be completed by a licensed water well contractor or a licensed pump installer. A copy of Part 1 of the report must be attached and both parts filed with the Department at the above address within 30 days of well completion.

Well Owner Information	Well Location
Owner Name: <u>D & D Drilling, Inc.</u>	Latitude: <u>31°29'5.7"N</u> Longitude: <u>91°1'19.6"W</u>
Mailing Address: <u>(For Stroud Petroleum)</u>	Method of Lat/Long (check one): Conventional Survey _____
<u>P.O. Box 1634</u>	USGS quad _____, Hand-held GPS _____, Survey-grade GPS _____
<u>Ferriday</u> <u>LA</u> <u>71334</u>	_____ 1/4 _____ 1/4, Sec <u>25</u> T. <u>6N</u> R. <u>2E</u>
City State Zip Code	<u>3</u> Miles <u>SE</u> of <u>ROXIE</u>
Telephone No. <u>(318) 757-3274</u>	(Distance) (Direction) (Nearest Town)

Pump Type (circle one)

Submersible Turbine Air Lift Centrifugal Flowing Well Jet Piston Rotary Other (describe): _____

Date Pump Installed: 8/2/16 Rated Pump Capacity: 60 Gallons Per Minute

Is This Pump (circle one): New Repaired Replacement

Power Type (circle one)

Electric Diesel Gasoline Natural Gas Tractor PTO Windmill Other (describe): _____

Horse Power Rating of Motor: 5 Setting Depth: 126 feet Number of Stages: 13

Pump Test Data for Non Flowing Well

Date Well Tested: 8/2/16 Duration of Pump Test (minimum 4 hours): _____ hours

Static Water Level (A): 80 Feet Below Land Surface Pumping Water Level (B): _____ Feet Below Land Surface

Drawdown [(B) - (A)]: _____ Feet Below Land Surface Test Pumping Rate: 60 Gallons Per Minute

Method of measurement (circle one): Steel tape Electric tape Air line Other (describe): _____

Pump Test Data for Flowing Well

Measured shut in head: _____ feet.

Well yielded _____ GPM with a drawdown of _____ feet after _____ hours of pumping

Meter Installation

Meter Manufacturer: _____ Meter Serial Number: _____

Meter Model Number/Name: _____ Type of Meter: _____

Totalizer Register Unit and Multiplier Factor (AF x .001, gal x 1000, etc): _____

Installation Date: _____ Meter installed by: _____

Is This Meter (circle one): New Repaired Replacement

Important: By submitting the above information you are certifying that this meter was installed to manufacturer standards. For agricultural wells, a list of approved meters is on the MDEQ website.

I HEREBY CERTIFY that the above statements are true to the best of my knowledge.

Rayborn Drilling Inc. 0-60 8/3/16 [Signature]
 Print Name of Pump Installer and License No. (if applicable) Date Signature of Pump Installer **Received**
 Form: OLWR-SWR-1B (4/13) **By OLWR**