

County: Forrest  
 Permit #: \_\_\_\_\_  
 Driller: R. Cain  
 Date drilling completed: ~~11-23-12~~  
11-23-12

**State Well Report**  
**Part 1 - Driller's Log**  
 Mississippi Department of Environmental Quality  
 Office of Land and Water Resources  
 P.O. Box 2309  
 Jackson, MS 39225  
 (601)961-5210  
 (601)961-5228 (fax)

**For Office Use Only:**

Aquifer: \_\_\_\_\_  
 Well #: K 58  
 L. S. Elevation: \_\_\_\_\_  
 E-log #: \_\_\_\_\_

*State Law requires that this report be prepared by the license holder responsible for the work and filed with the Department at the above address within 30 days of completion of drilling of the well or borehole.*

Information on Well Owner <small>(Landowner if borehole is not for a water well)</small>	Well or Borehole Location
Owner Name: <u>RK Farms</u>	Latitude: <u>31-04-48"</u> Longitude: <u>89-19-37"</u>
Mailing Address: <u>181 Rockhill to</u> <u>Lumberton Rd</u>	Method of Lat/Long (circle one): Conventional Survey, USGS quad, <u>Hand-held GPS</u> Survey-grade GPS
<u>Purvis</u> MS <u>39475</u>	N $\frac{1}{4}$ W $\frac{1}{4}$ Sec <u>5</u> Twn <u>1N</u> Rng <u>13W</u>
City State Zip Code	NE NW Direction Nearest Town
Telephone No. <u>601, 704-6039</u>	<u>0</u> Miles <u>W</u> of <u>Brooklyn MS</u>

**Well / Borehole Data**

Date drilling started: 11-19-12 Date drilling completed: 11-23-12 Hole depth: 480 Hole diameter: 4"

Location of the source of any surface water used for drilling: \_\_\_\_\_  
 Method of dosing and volume of Chlorine used in drilling and development: \_\_\_\_\_

Logs run (circle all applicable): No log run Electric Gamma Ray Density Sonic Neutron Other: \_\_\_\_\_  
 Name of organization running log(s): \_\_\_\_\_

Purpose of borehole (check one): Water Well  Geotechnical/Geological Investigation \_\_\_\_\_ Ground Source Heat Pump \_\_\_\_\_  
 Seismic Survey \_\_\_\_\_ Other (describe) \_\_\_\_\_

*If drilling is not related to water well construction, skip the remainder of this block*

Purpose of Well (check one): Home \_\_\_\_\_ Industrial \_\_\_\_\_ Public Supply \_\_\_\_\_ Irrigation \_\_\_\_\_ Fish Culture \_\_\_\_\_ Other: Chicken Farm

If a flowing well, method of flow regulation: Valve \_\_\_\_\_ Other (describe) \_\_\_\_\_

Static Water Level: 180 feet above or below (circle one) land surface Date measured: 11-22-12

Method of Measurement (circle one) steel tape electric tape air line other: String

Well depth: 480 Well grouted to a depth of 10 feet Type of grout (circle one): Neat Cement Bentonite Mix

Casing length: 450 feet Casing diameter: 4x2 inches Type of casing: PVC

Screen length: 30 feet Screen diameter: 2" inches Type of screen: PVC

Screen slot size: # 10 inches Setting depth: From 450 feet to 480 feet

Type of completion (circle all applicable): Gravel packed Underreamed Telescoped Open hole Natural Development

Other (describe): \_\_\_\_\_

Top of lap pipe or reduction in casing: 20 feet. *If telescoped or more than one screen, describe on next page*

*MS Water Well Drilling*  
*Randall Cain*

*0-374*  
*12-13-2012*

Form: OLWR-SWR-1A (04/08)

REMOVED  
 BY: OLWR

The sketch below only required for water wells

Description of formations encountered must be provided for all wells and boreholes, unless specifically exempted by regulations

If well telescopes, show depths on sketch

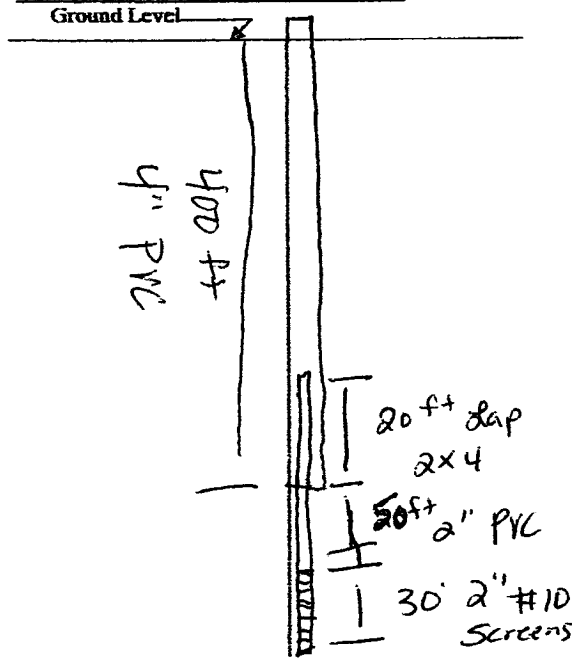

If more than one screen, show location of each on sketch

Description of Formations Encountered	From (depth)	To (depth)
Top Soil	Ground Level	
Clay	0	10
Sand & Ben Gravel	10	20
Clay	20	120
Sand	120	220
Ben Shell sand	220	240
Clay	240	250
sand	250	320
Clay	320	330
sand	330	450
	450	480

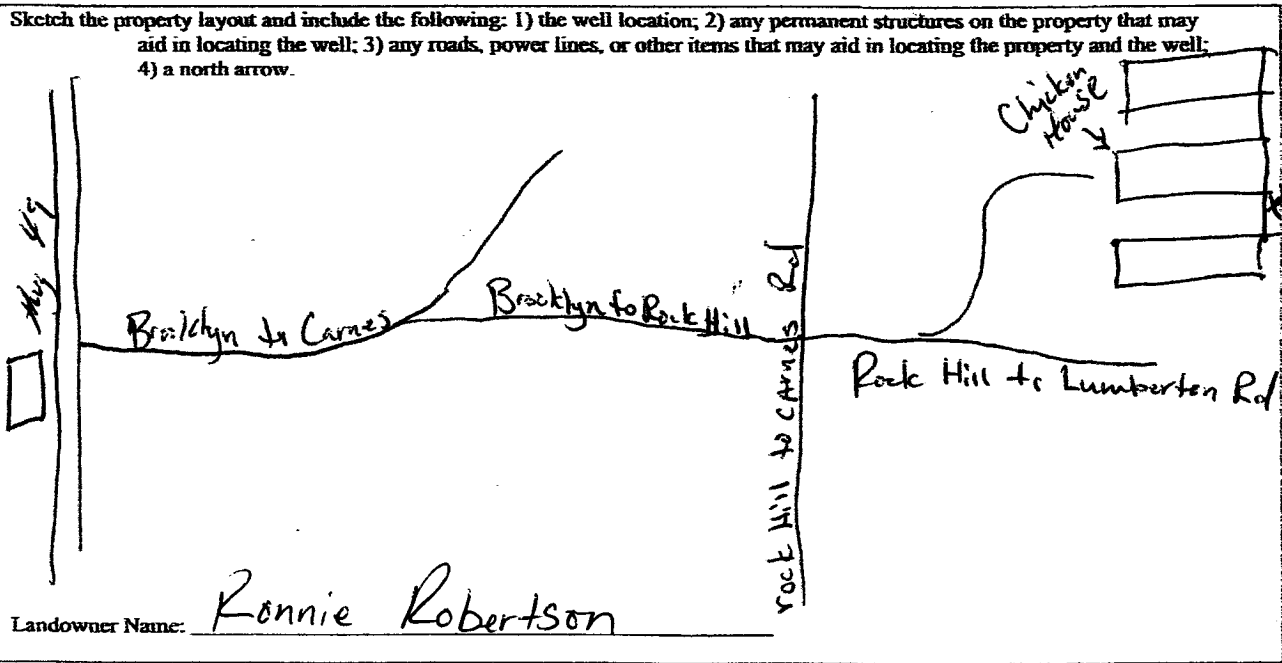

Form: OLWR-SWR-1A (04/08)

I certify that the well/borehole was drilled, constructed, and completed in accordance with all applicable requirements of the Mississippi Department of Environmental Quality and the Mississippi Department of Health regulations, if applicable, and state laws.

*N/S Water Well Driller, 12-13-2012*  
Print Name of Responsible Licensee and License No. *0-374* Date *12-13-2012* Signature of Licensee *Randall*

RECEIVED  
DEC 17 2012  
BY: OLWR

# STATE WELL REPORT

## Part 2

**Pump Installer's Completion Report**  
 Mississippi Department of Environmental Quality  
 Office of Land and Water Resources  
 P.O. Box 2309  
 Jackson, MS 39225  
 (601)961-5210  
 (601)961-5228 (fax)

County: Forrest  
 Permit #: \_\_\_\_\_  
 Driller: R. Cain  
 Date completed: 11-23-12  
*Copy information from block on Part 1*

**For Office Use Only:**

Aquifer: \_\_\_\_\_  
 Well #: K58  
 Elevation: \_\_\_\_\_

*This part of the report must be completed by a licensed water well contractor or a licensed pump installer. A copy of Part 1 of the report must be attached and both parts filed with the Department at the above address within 30 days of well completion.*

Well Owner Information	Well Location
Owner Name: <u>RK Farms</u>	Latitude: <u>31° 04' 48"</u> Longitude: <u>89° 19' 37"</u>
Mailing Address: <u>181 Rockhill to</u> <u>Lumberton Rd</u> <u>Purvis Ms 39475</u>	Method of Lat/Long (check one): Conventional Survey _____ USGS quad _____ Hand-held GPS <input checked="" type="checkbox"/> Survey-grade GPS _____
City: _____ State: _____ Zip Code: _____	<u>N</u> $\frac{1}{4}$ <u>W</u> $\frac{1}{4}$ Sec <u>5</u> T <u>1</u> N R <u>13</u> W
Telephone No. ( <u>601</u> ) <u>704-6039</u>	Distance <u>6</u> Miles Direction <u>W</u> of Nearest Town <u>Brooklyn MS</u>

Pump Type Circle one	Power Type Circle one
Air Lift <input type="checkbox"/> Jet <input type="checkbox"/> <u>Submersible</u>	Diesel Engine <input type="checkbox"/> Gasoline Engine <input type="checkbox"/> Natural Gas <input type="checkbox"/>
Bucket <input type="checkbox"/> Piston <input type="checkbox"/> Turbine <input type="checkbox"/>	<u>Electric Motor</u> <input checked="" type="checkbox"/> Hand <input type="checkbox"/> Tractor PTO <input type="checkbox"/>
Centrifugal <input type="checkbox"/> Rotary <input type="checkbox"/> Flowing Well <input type="checkbox"/>	Windmill <input type="checkbox"/> Other (specify): _____
Other (specify): _____	Horse Power Rating of Motor: <u>5</u> hp
Date Pump Installed: <u>11-23-12</u>	Setting Depth: <u>260</u> feet
Rated Pump Capacity: <u>50</u> Gallons Per Minute	Number of Stages: <u>15</u>

Pump Test Data	Method of Measuring Water Level Circle one
Date Well Tested: <u>11-23-12</u>	Air Line <input type="checkbox"/> Electric Measuring Line <input type="checkbox"/> Steel Tape <input type="checkbox"/>
Static Water Level (A): <u>180</u> Feet Below Land Surface	Other (specify): <u>String</u>
Pumping Water Level (B): <u>220</u> Feet Below Land Surface	For flowing well, measured shut in head: _____ feet
Drawdown [(B) - (A)]: <u>40</u> Feet Below Land Surface	Well yielded <u>70</u> GPM with a drawdown of
Test Pumping Rate: <u>70</u> Gallons Per Minute	<u>40</u> feet after <u>5</u> hours of pumping
Duration of Pump Test (minimum 4 hours): <u>5</u> hours	

This is for (circle one): New Well Replacement of Existing Pump Repair of Existing Pump

I HEREBY CERTIFY that the above statements are true to the best of my knowledge.

MS Water Well Drilling Randall Cain 12-13-2012  
 Print Name of Pump Installer and License No. (if applicable) Signature of Pump Installer

D-374

Form: OLWR-SWR-1C (07-09)

RECEIVED  
 DEC 17 2012  
 BY: OLWR